

2007 Cache Creek Analysis

RS = 139636 STA 1396+36

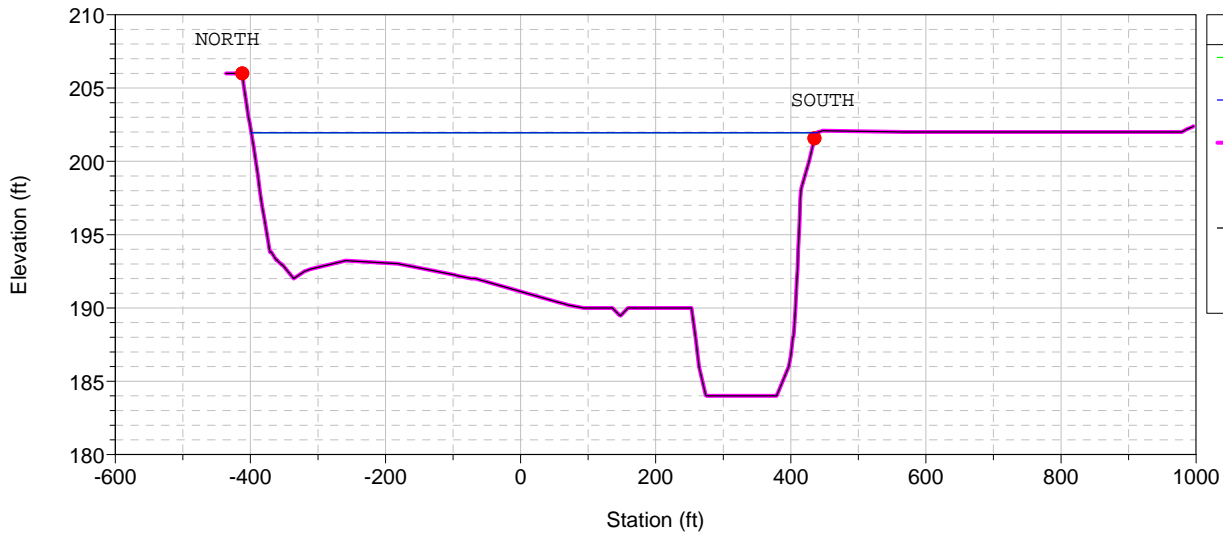

Legend	
	WS 100 yr - 2007_Exist
	WS 100 yr - 2007_Pro
	Ground - 2007_Exist
	Bank Sta - 2007_Exist
	Ground - 2007_Pro
	Bank Sta - 2007_Pro

2007 Cache Creek Analysis

RS = 139135 STA 1391+35 (1392+00)

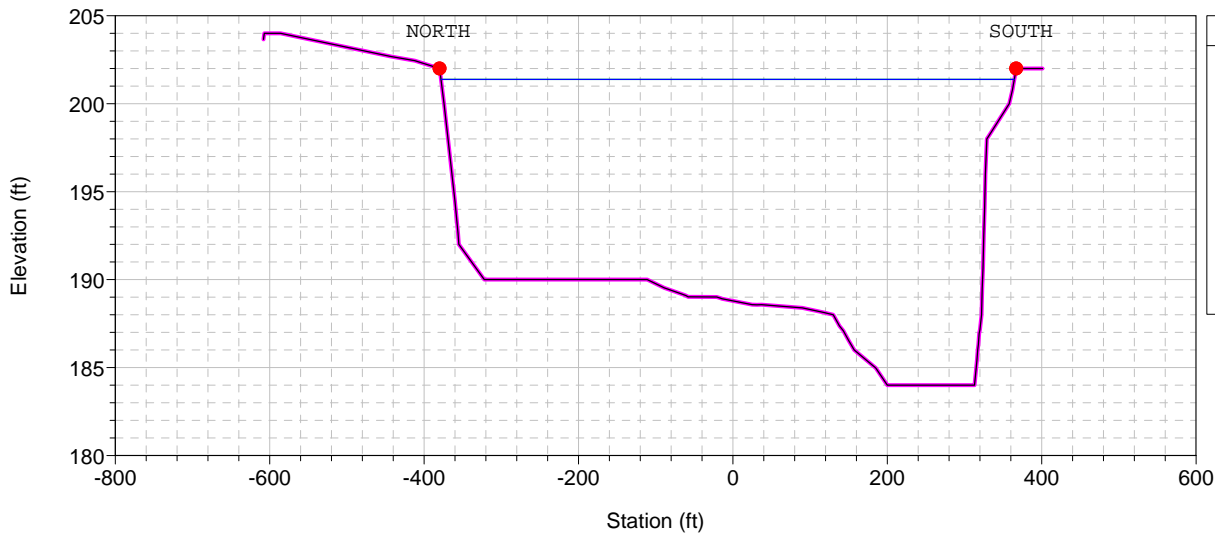

Legend	
	WS 100 yr - 2007_Exist
	WS 100 yr - 2007_Pro
	Ground - 2007_Exist
	Bank Sta - 2007_Exist
	Ground - 2007_Pro
	Bank Sta - 2007_Pro

2007 Cache Creek Analysis

RS = 138760 STA 1387+60

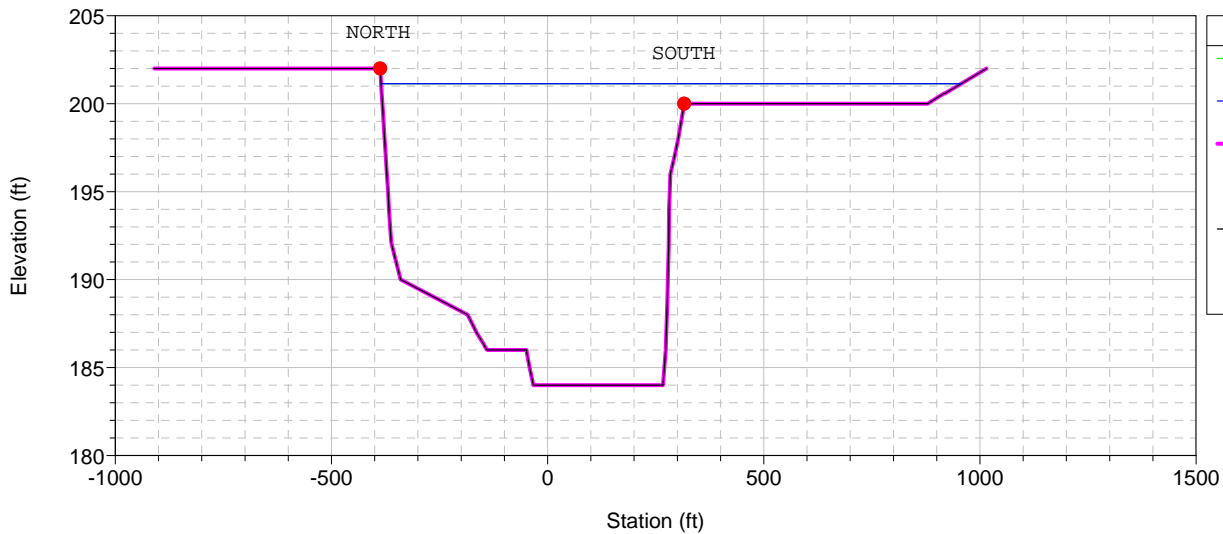

Legend	
	WS 100 yr - 2007_Exist
	WS 100 yr - 2007_Pro
	Ground - 2007_Exist
	Bank Sta - 2007_Exist
	Ground - 2007_Pro
	Bank Sta - 2007_Pro

2007 Cache Creek Analysis

RS = 138635 STA 1386+35

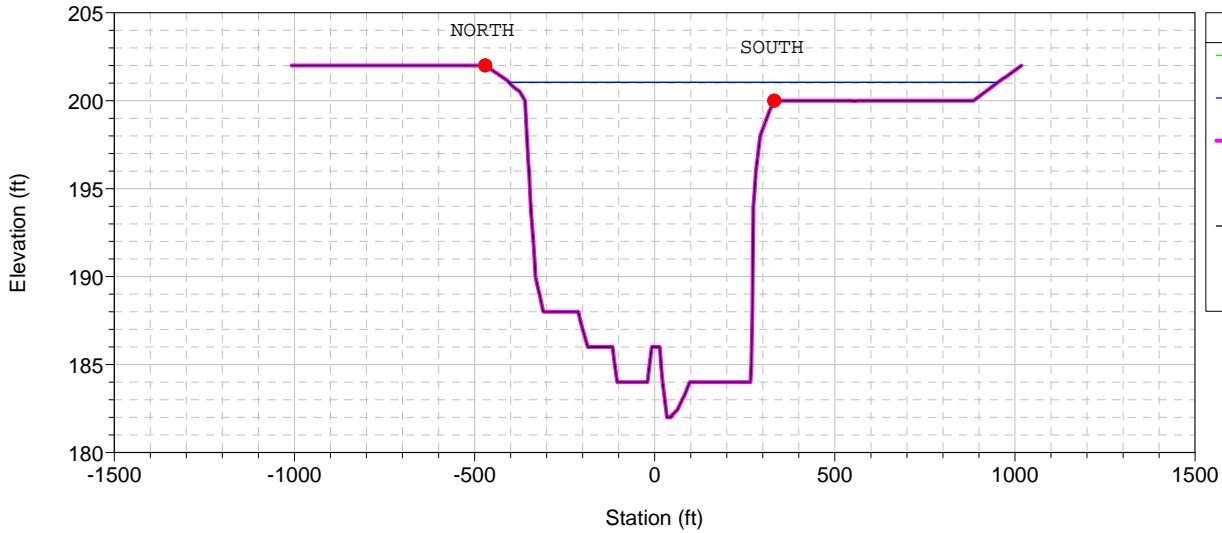

Legend	
WS 100 yr - 2007_Exist	
WS 100 yr - 2007_Pro	
Ground - 2007_Exist	
Bank Sta - 2007_Exist	
Ground - 2007_Pro	
Bank Sta - 2007_Pro	

2007 Cache Creek Analysis

RS = 138335 STA 1383+35

Note: Hatched area represents ineffective flow area

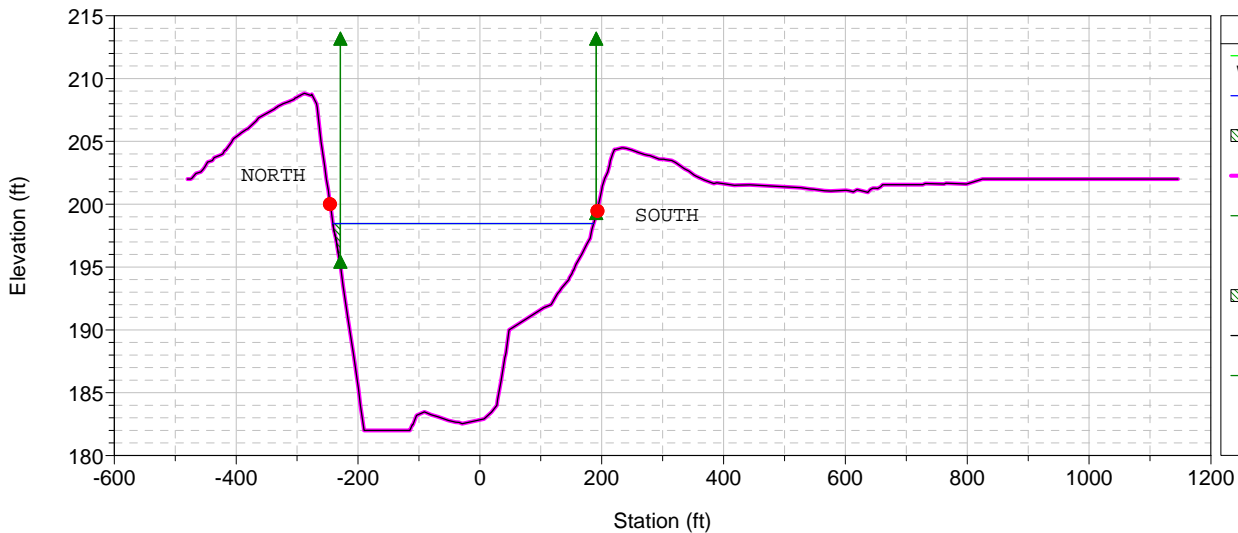

Legend	
WS 100 yr - 2007_Exist	
WS 100 yr - 2007_Pro	
- 2007_Exist	
Ground - 2007_Exist	
Ineff - 2007_Exist	
Bank Sta - 2007_Exist	
- 2007_Pro	
Ground - 2007_Pro	
Ineff - 2007_Pro	
Bank Sta - 2007_Pro	

2007 Cache Creek Analysis

RS = 138282 STA 1382+82

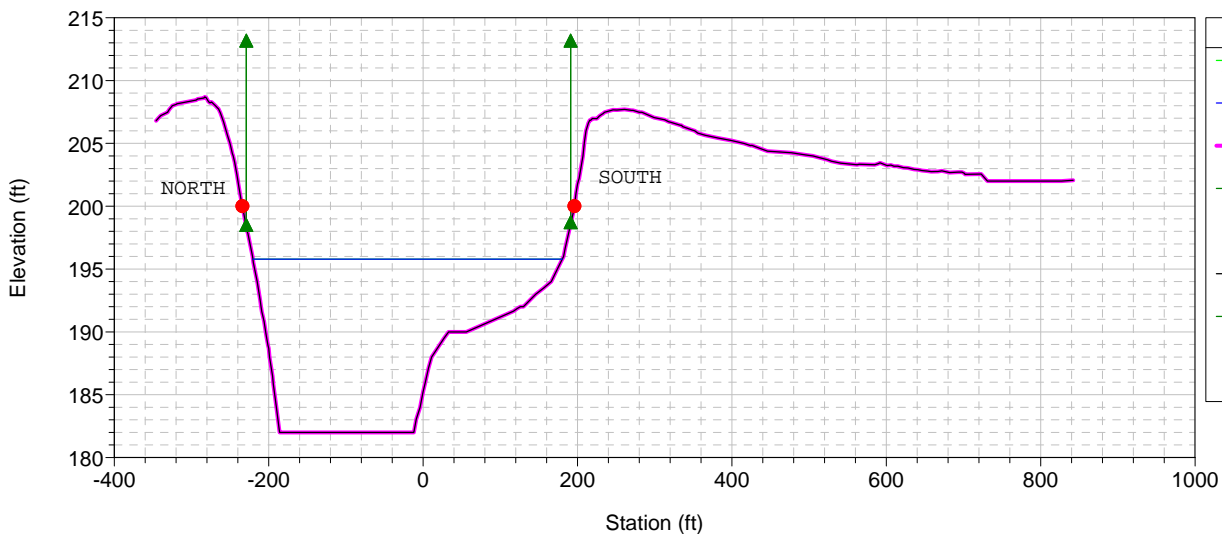

Legend	
WS 100 yr - 2007_Exist	
WS 100 yr - 2007_Pro	
Ground - 2007_Exist	
Ineff - 2007_Exist	
Bank Sta - 2007_Exist	
Ground - 2007_Pro	
Ineff - 2007_Pro	
Bank Sta - 2007_Pro	

2007 Cache Creek Analysis

RS = 138042 STA 1380+42

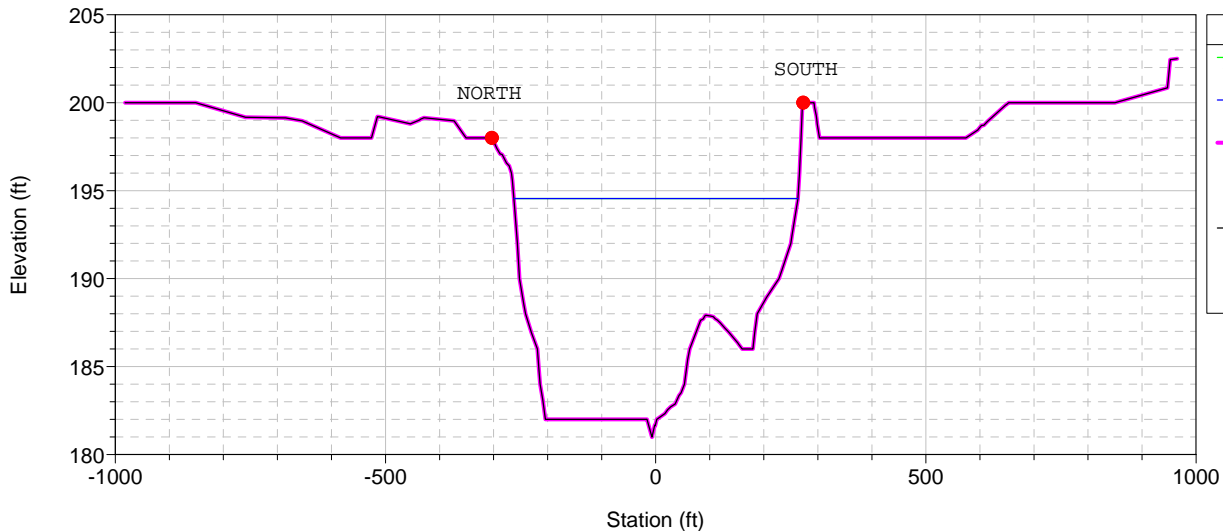

Legend	
	WS 100 yr - 2007_Exist
	WS 100 yr - 2007_Pro
	Ground - 2007_Exist
	Bank Sta - 2007_Exist
	Ground - 2007_Pro
	Bank Sta - 2007_Pro

2007 Cache Creek Analysis

RS = 137800 STA 1378+00

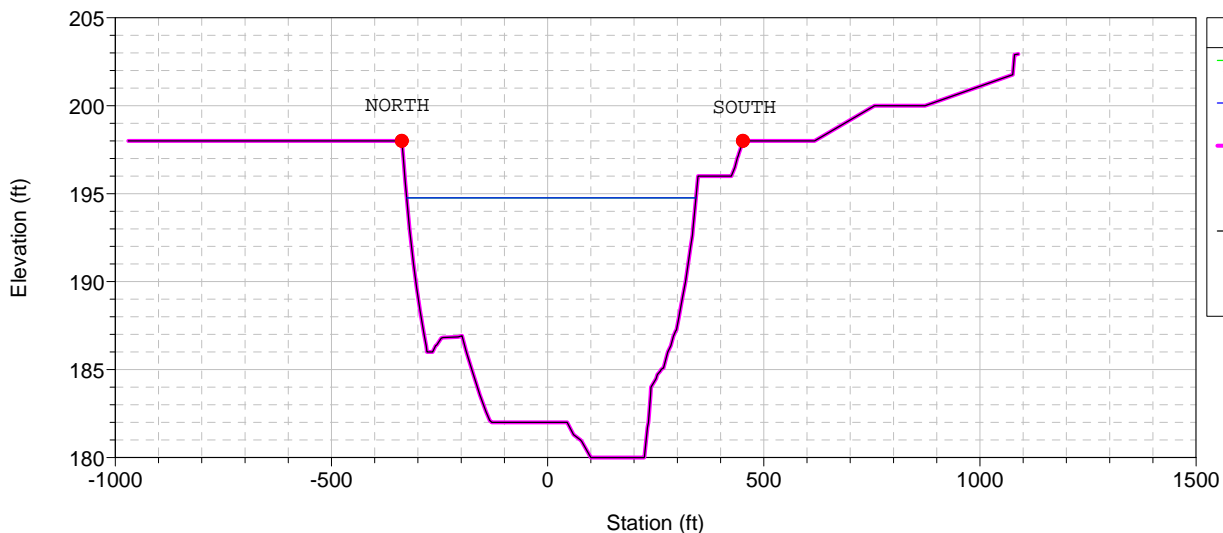

Legend	
	WS 100 yr - 2007_Exist
	WS 100 yr - 2007_Pro
	Ground - 2007_Exist
	Bank Sta - 2007_Exist
	Ground - 2007_Pro
	Bank Sta - 2007_Pro

2007 Cache Creek Analysis

RS = 137270 STA 1372+70

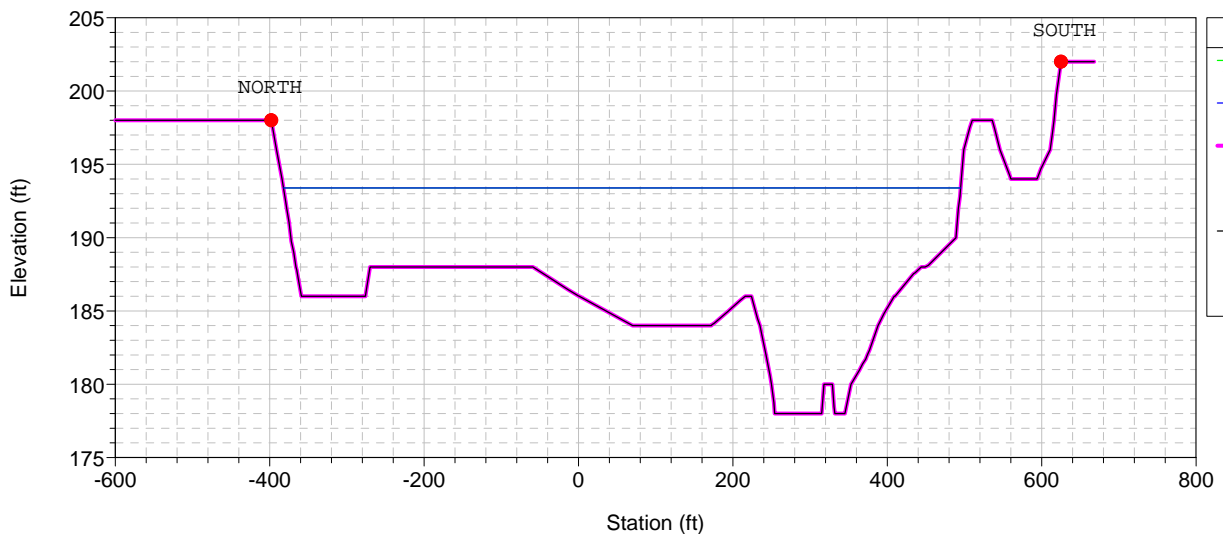

Legend	
	WS 100 yr - 2007_Exist
	WS 100 yr - 2007_Pro
	Ground - 2007_Exist
	Bank Sta - 2007_Exist
	Ground - 2007_Pro
	Bank Sta - 2007_Pro

2007 Cache Creek Analysis

RS = 136740 STA 1367+40

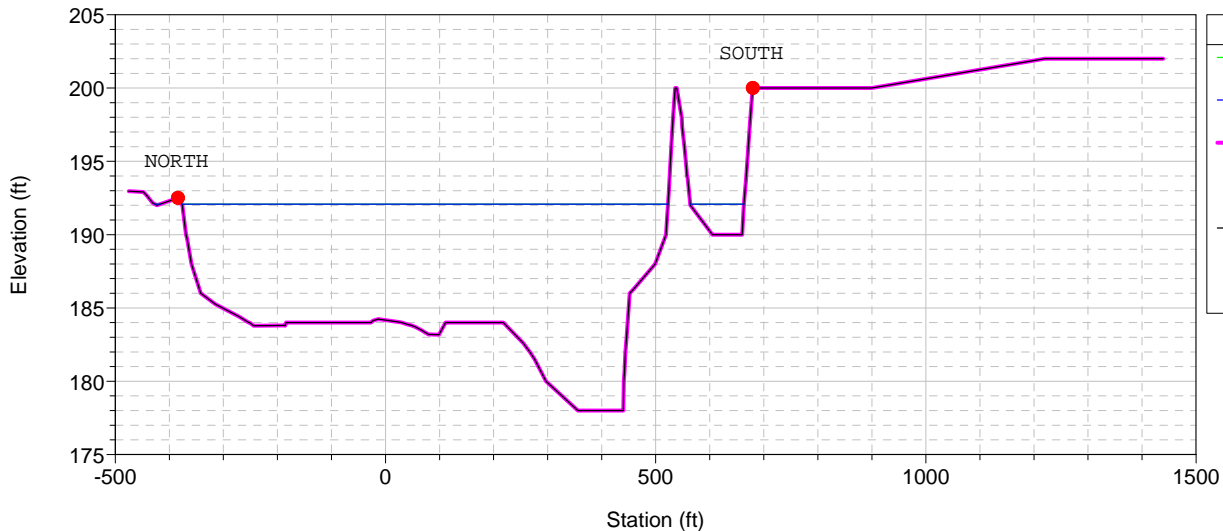

Legend	
	WS 100 yr - 2007_Exist
	WS 100 yr - 2007_Pro
	Ground - 2007_Exist
	Bank Sta - 2007_Exist
	Ground - 2007_Pro
	Bank Sta - 2007_Pro

2007 Cache Creek Analysis

RS = 136440 STA 1364+40

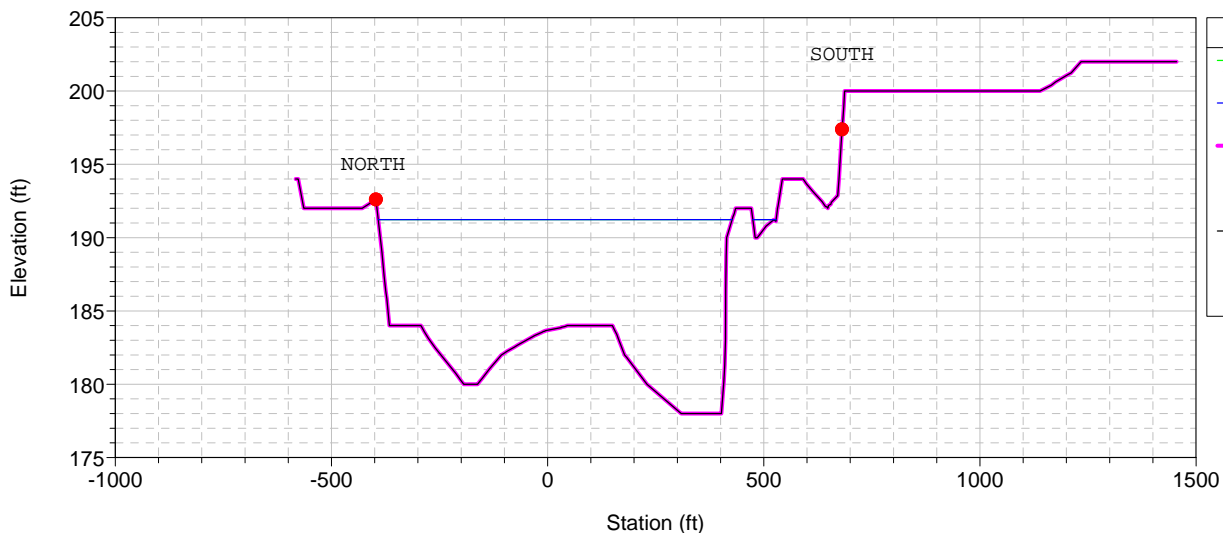

Legend	
	WS 100 yr - 2007_Exist
	WS 100 yr - 2007_Pro
	Ground - 2007_Exist
	Bank Sta - 2007_Exist
	Ground - 2007_Pro
	Bank Sta - 2007_Pro

2007 Cache Creek Analysis

RS = 135820 STA 1358+20

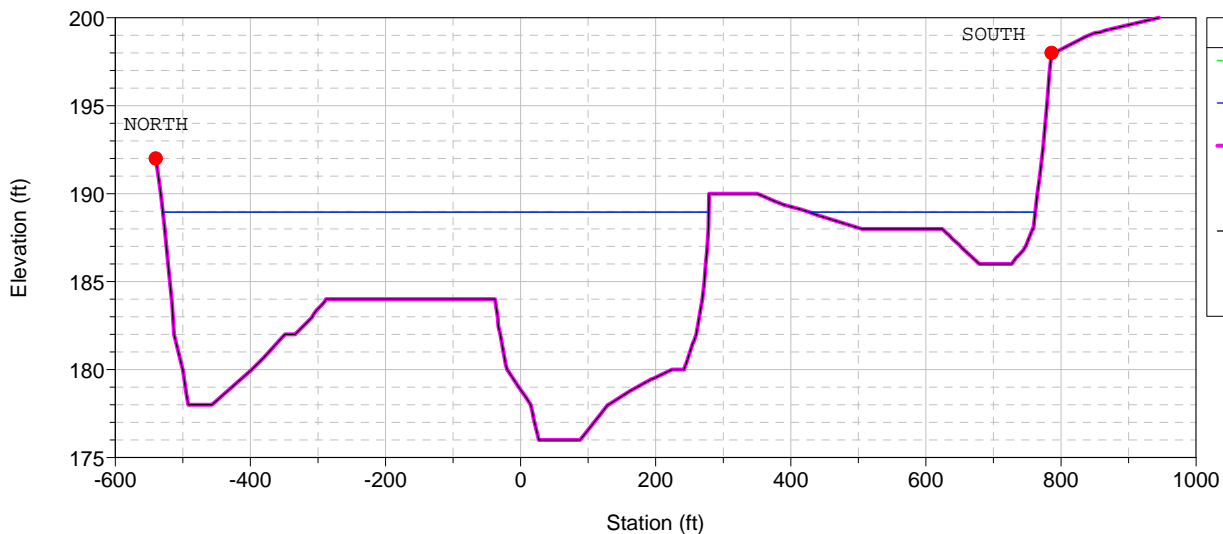

Legend	
	WS 100 yr - 2007_Exist
	WS 100 yr - 2007_Pro
	Ground - 2007_Exist
	Bank Sta - 2007_Exist
	Ground - 2007_Pro
	Bank Sta - 2007_Pro

2007 Cache Creek Analysis

RS = 135380 STA 1353+80

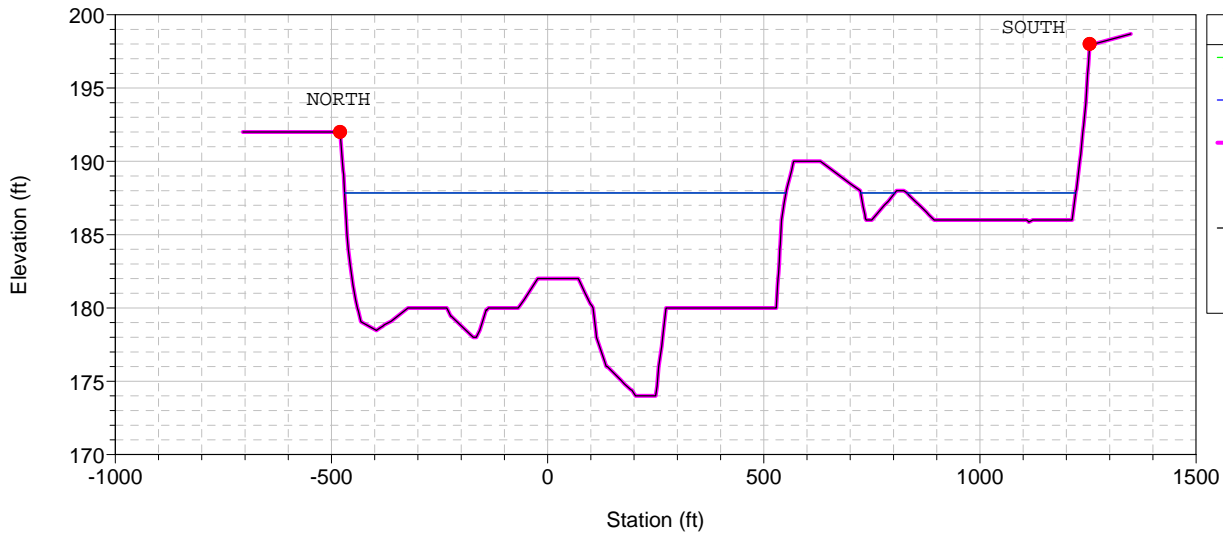

2007 Cache Creek Analysis

RS = 135050 STA 1350+50

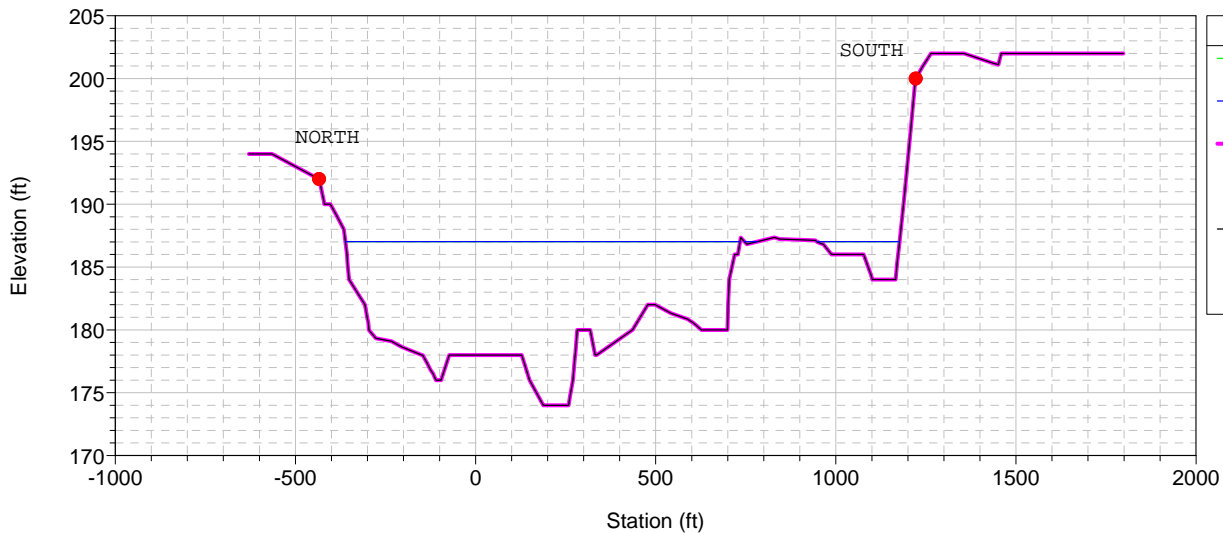

2007 Cache Creek Analysis

RS = 134810 STA 1348+10

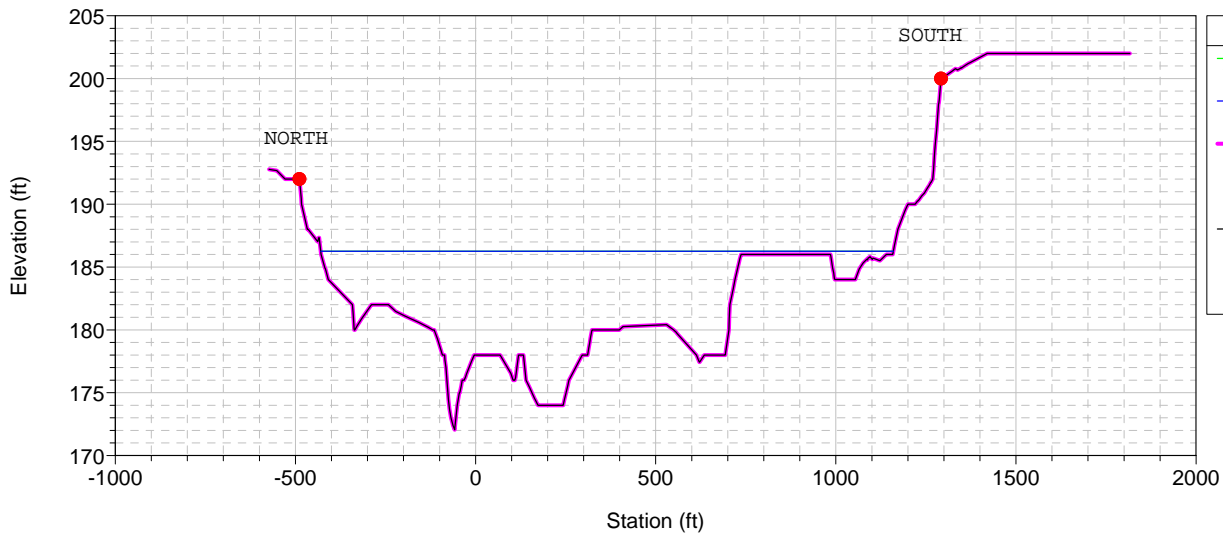

2007 Cache Creek Analysis

RS = 134350 STA 1343+50

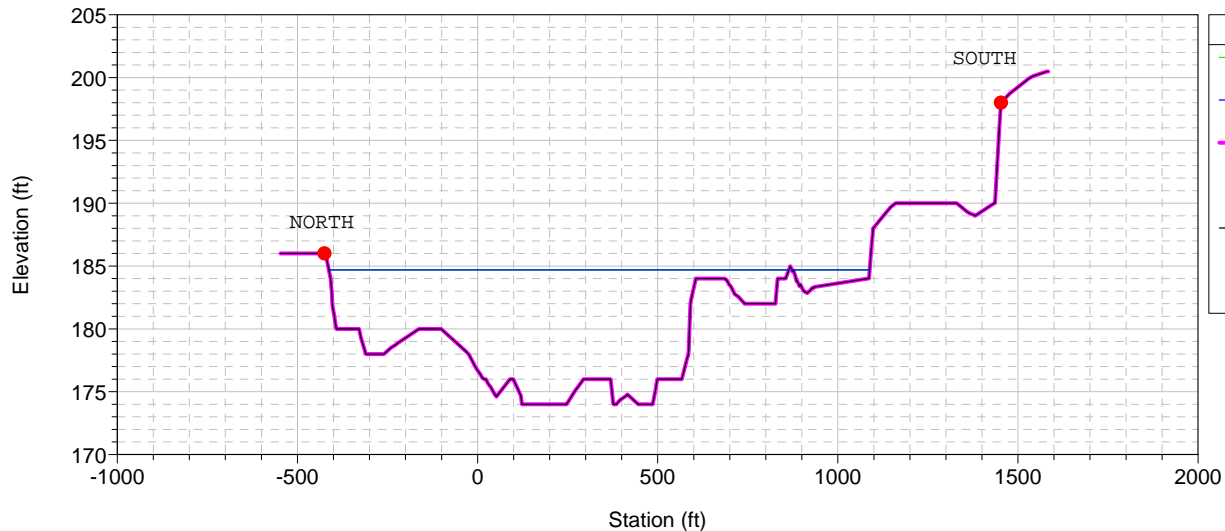

Legend	
	WS 100 yr - 2007_Exist
	WS 100 yr - 2007_Pro
	Ground - 2007_Exist
	Bank Sta - 2007_Exist
	Ground - 2007_Pro
	Bank Sta - 2007_Pro

2007 Cache Creek Analysis

RS = 133990 STA 1339+90

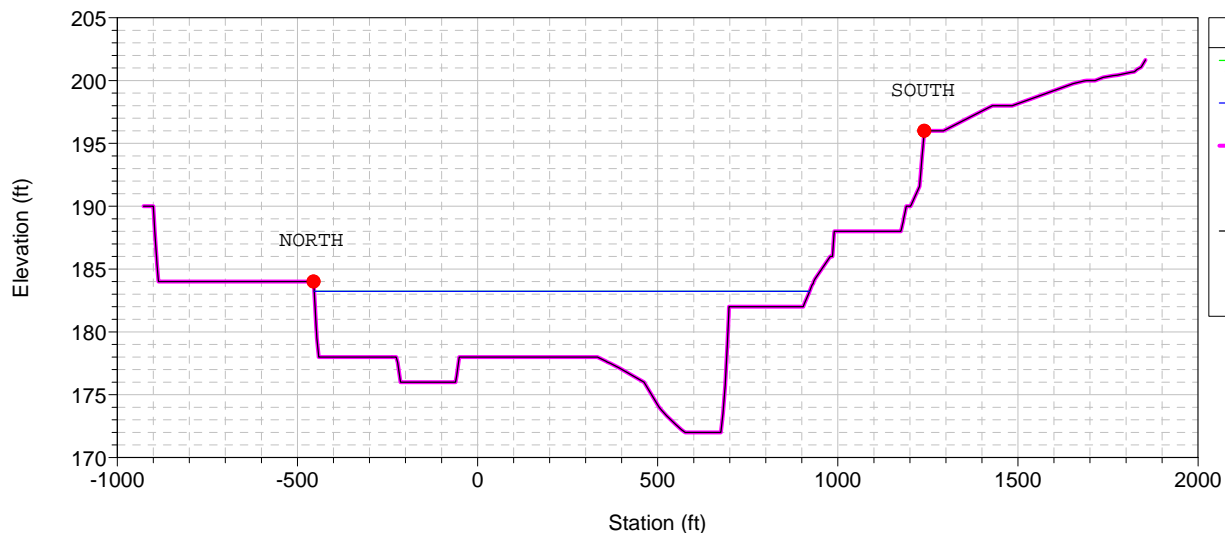

Legend	
	WS 100 yr - 2007_Exist
	WS 100 yr - 2007_Pro
	Ground - 2007_Exist
	Bank Sta - 2007_Exist
	Ground - 2007_Pro
	Bank Sta - 2007_Pro

2007 Cache Creek Analysis

RS = 133420 STA 1334+20

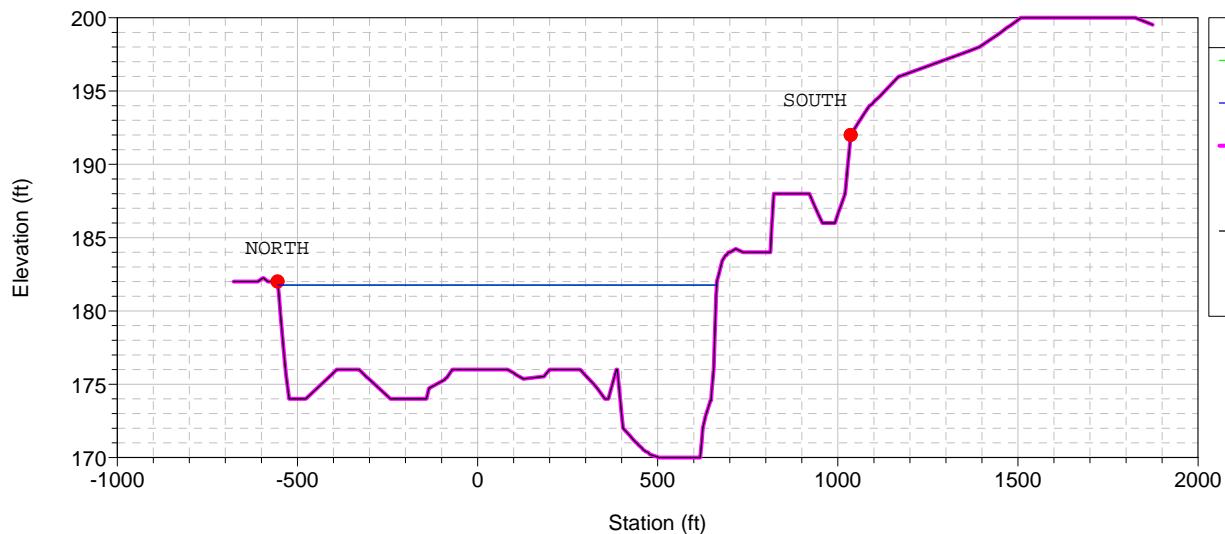

Legend	
	WS 100 yr - 2007_Exist
	WS 100 yr - 2007_Pro
	Ground - 2007_Exist
	Bank Sta - 2007_Exist
	Ground - 2007_Pro
	Bank Sta - 2007_Pro

2007 Cache Creek Analysis

RS = 132870 STA 1328+70

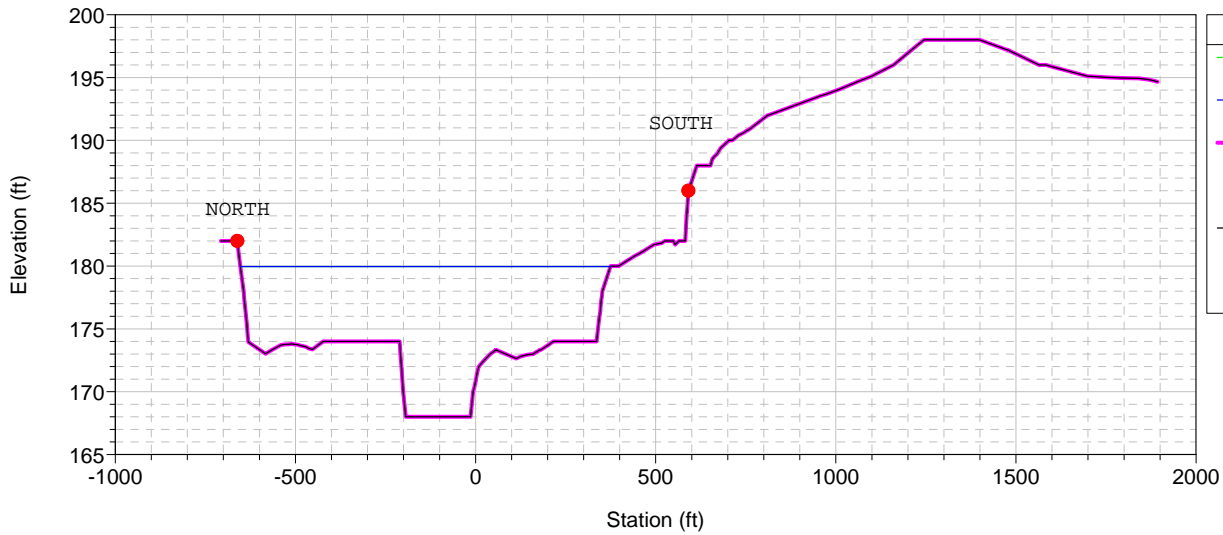

2007 Cache Creek Analysis

RS = 132260 STA 1322+60

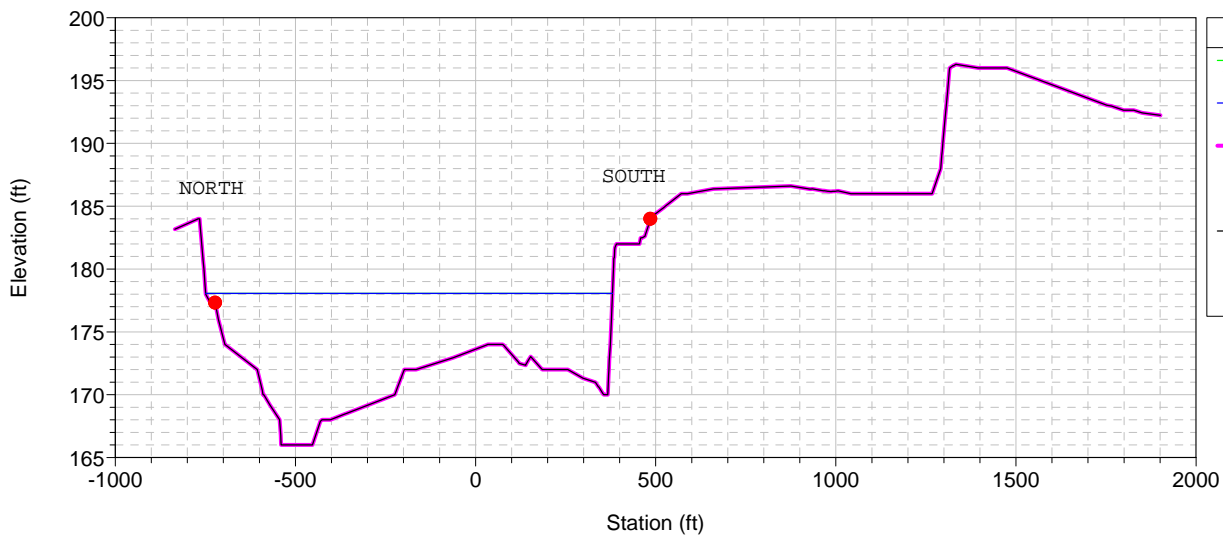

2007 Cache Creek Analysis

RS = 131710 STA 1317+10

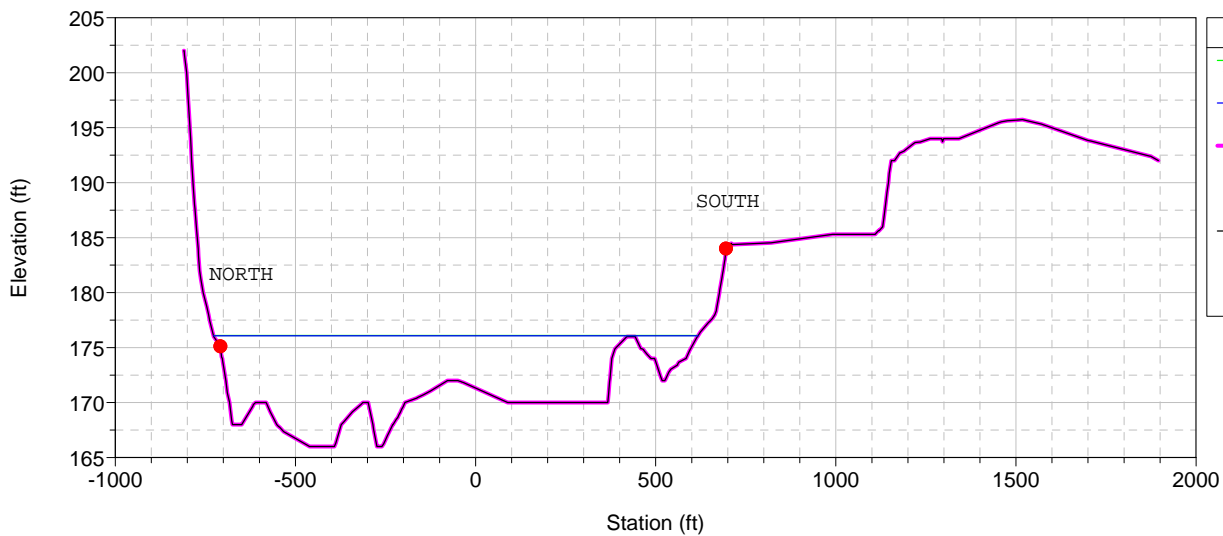

2007 Cache Creek Analysis

RS = 130450 STA 1304+50

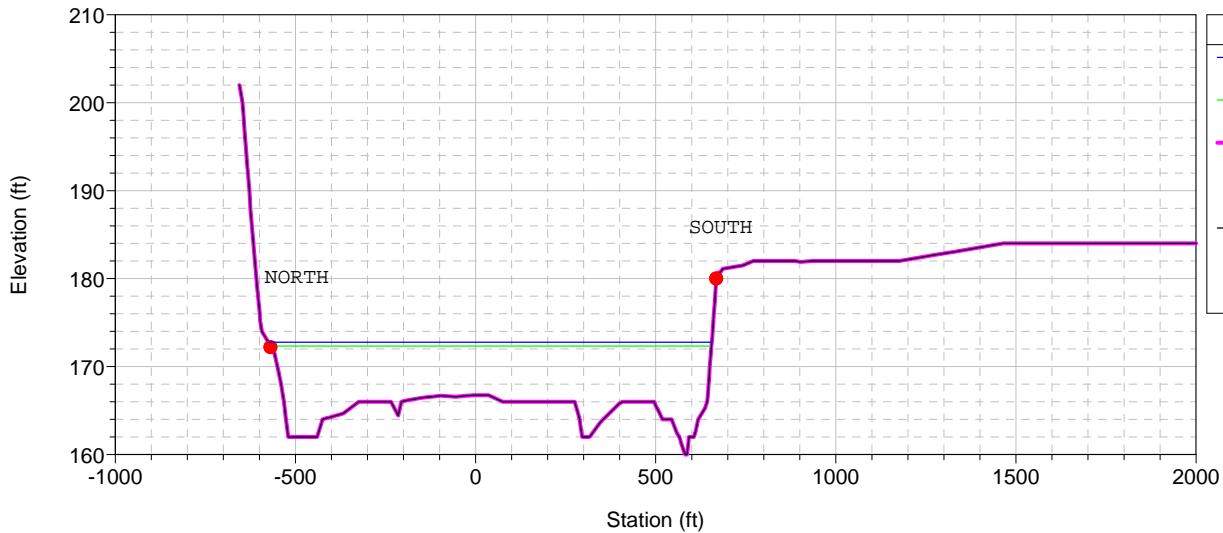

Legend	
WS 100 yr - 2007_Pro	
WS 100 yr - 2007_Exist	
Ground - 2007_Exist	
Bank Sta - 2007_Exist	
Ground - 2007_Pro	
Bank Sta - 2007_Pro	

2007 Cache Creek Analysis

RS = 129600 STA 1296+00

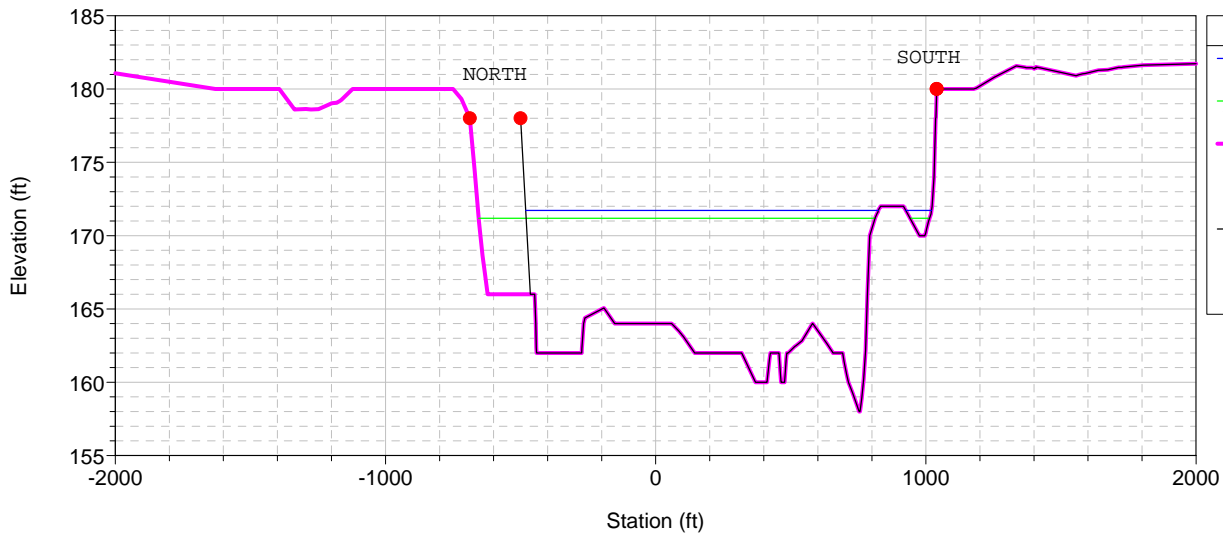

Legend	
WS 100 yr - 2007_Pro	
WS 100 yr - 2007_Exist	
Ground - 2007_Exist	
Bank Sta - 2007_Exist	
Ground - 2007_Pro	
Bank Sta - 2007_Pro	

2007 Cache Creek Analysis

RS = 128945 STA 1289+45

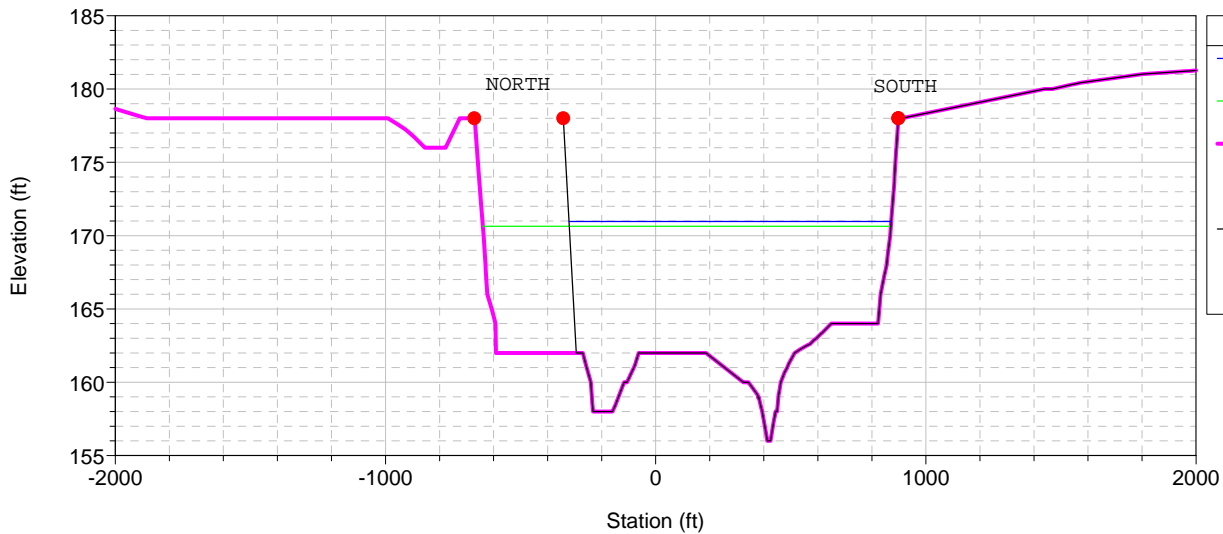

Legend	
WS 100 yr - 2007_Pro	
WS 100 yr - 2007_Exist	
Ground - 2007_Exist	
Bank Sta - 2007_Exist	
Ground - 2007_Pro	
Bank Sta - 2007_Pro	

2007 Cache Creek Analysis

RS = 128256 STA 1282+56

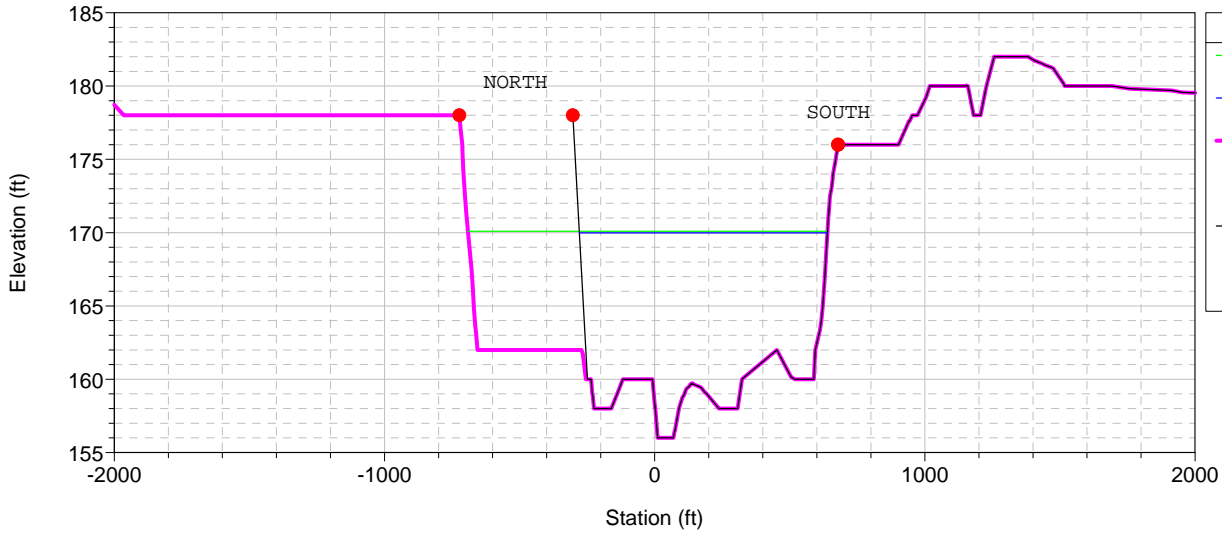

Legend	
	WS 100 yr - 2007_Exist
	WS 100 yr - 2007_Pro
	Ground - 2007_Exist
	Bank Sta - 2007_Exist
	Ground - 2007_Pro
	Bank Sta - 2007_Pro

2007 Cache Creek Analysis

RS = 127940 STA 1279+40

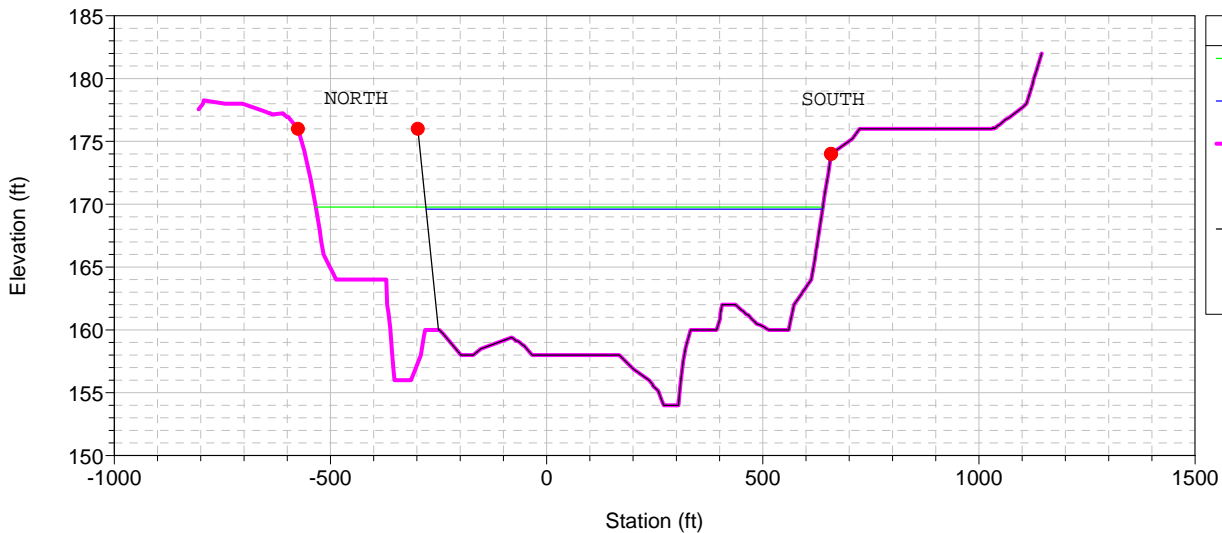

Legend	
	WS 100 yr - 2007_Exist
	WS 100 yr - 2007_Pro
	Ground - 2007_Exist
	Bank Sta - 2007_Exist
	Ground - 2007_Pro
	Bank Sta - 2007_Pro

2007 Cache Creek Analysis

RS = 127730 STA 1277+30

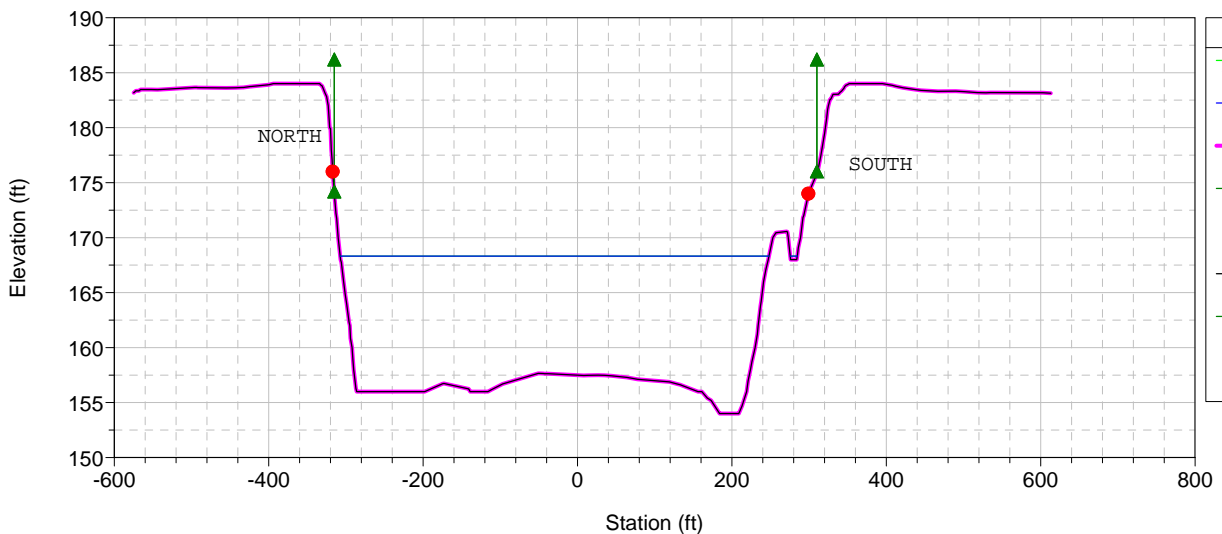

Legend	
	WS 100 yr - 2007_Exist
	WS 100 yr - 2007_Pro
	Ground - 2007_Exist
	Ineff - 2007_Exist
	Bank Sta - 2007_Exist
	Ground - 2007_Pro
	Ineff - 2007_Pro
	Bank Sta - 2007_Pro

2007 Cache Creek Analysis

RS = 127685 STA 1276+85

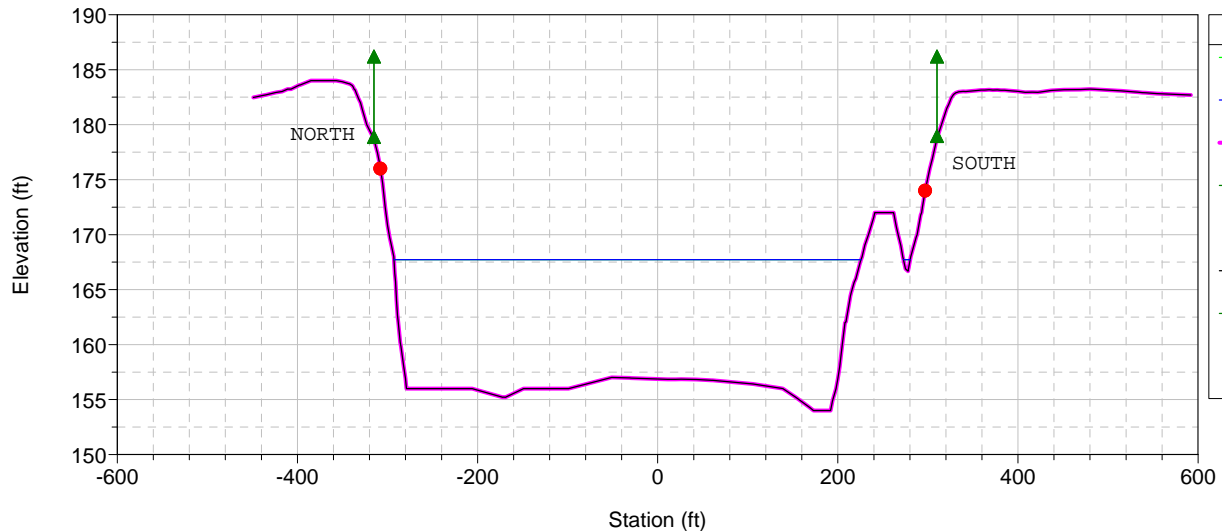

Legend	
	WS 100 yr - 2007_Exist
	WS 100 yr - 2007_Pro
	Ground - 2007_Exist
	Ineff - 2007_Exist
	Bank Sta - 2007_Exist
	Ground - 2007_Pro
	Ineff - 2007_Pro
	Bank Sta - 2007_Pro

2007 Cache Creek Analysis

RS = 127445 STA 1274+45

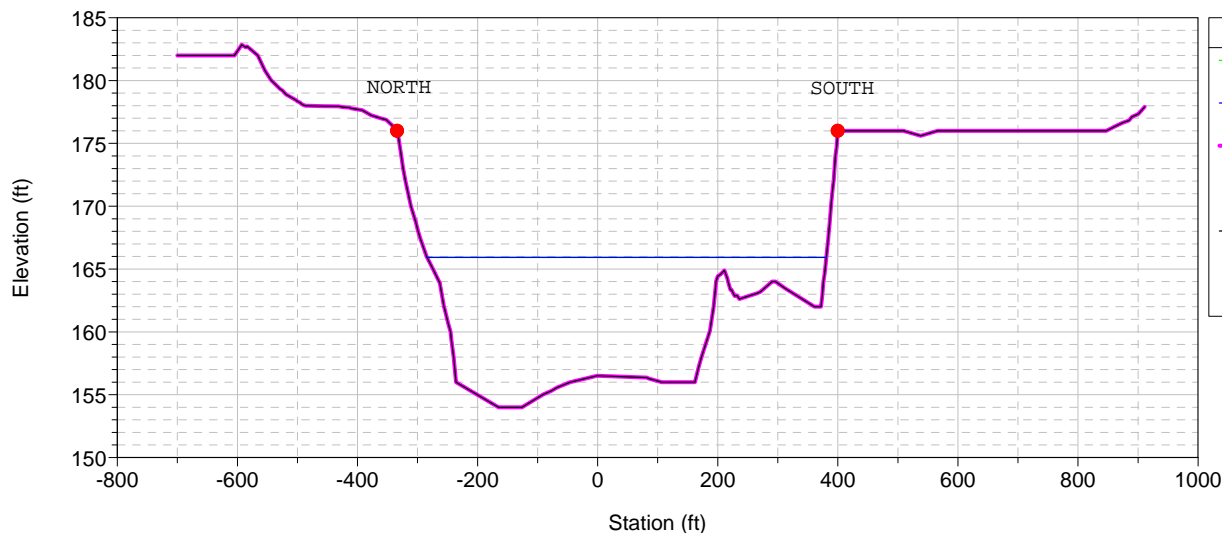

Legend	
	WS 100 yr - 2007_Exist
	WS 100 yr - 2007_Pro
	Ground - 2007_Exist
	Bank Sta - 2007_Exist
	Ground - 2007_Pro
	Bank Sta - 2007_Pro

2007 Cache Creek Analysis

RS = 127155 STA 1271+55

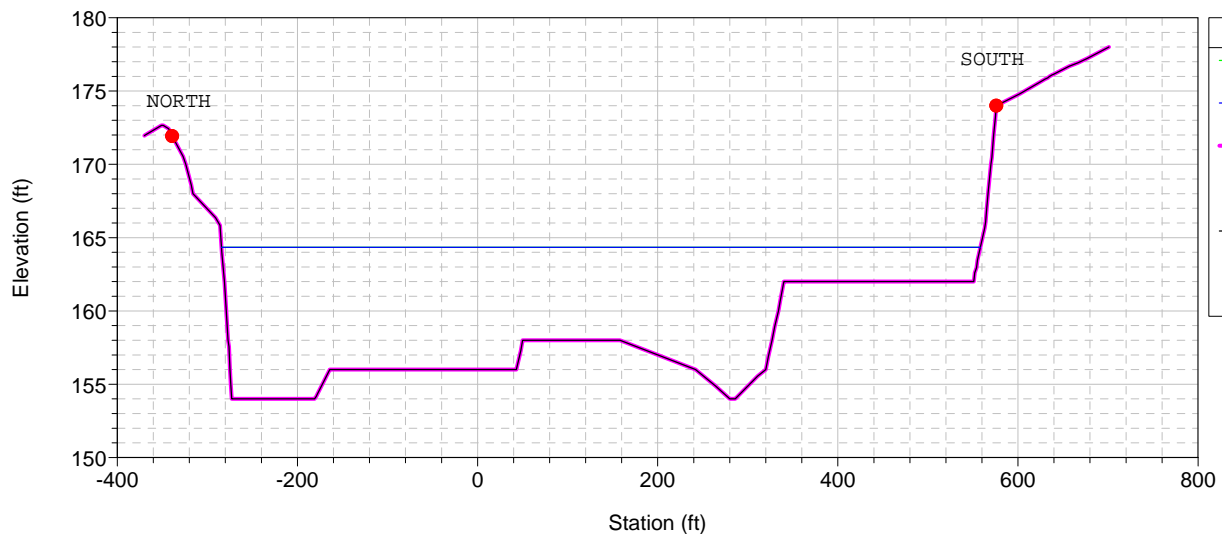

Legend	
	WS 100 yr - 2007_Exist
	WS 100 yr - 2007_Pro
	Ground - 2007_Exist
	Bank Sta - 2007_Exist
	Ground - 2007_Pro
	Bank Sta - 2007_Pro

2007 Cache Creek Analysis

RS = 126655 STA 1266+55

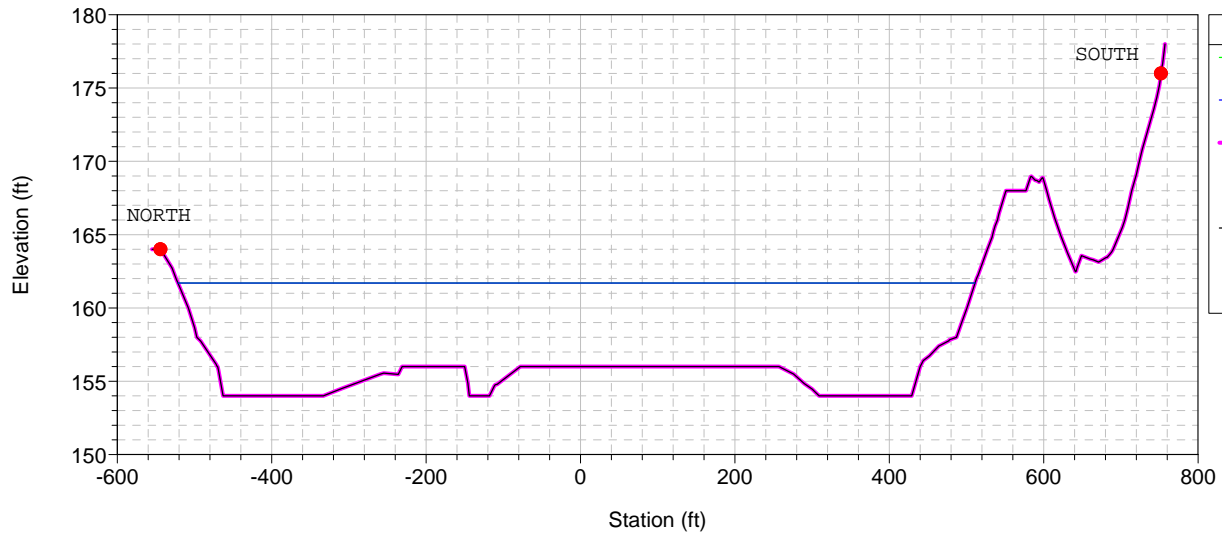

Legend	
	WS 100 yr - 2007_Exist
	WS 100 yr - 2007_Pro
	Ground - 2007_Exist
	Bank Sta - 2007_Exist
	Ground - 2007_Pro
	Bank Sta - 2007_Pro

2007 Cache Creek Analysis

RS = 126155 STA 1261+55

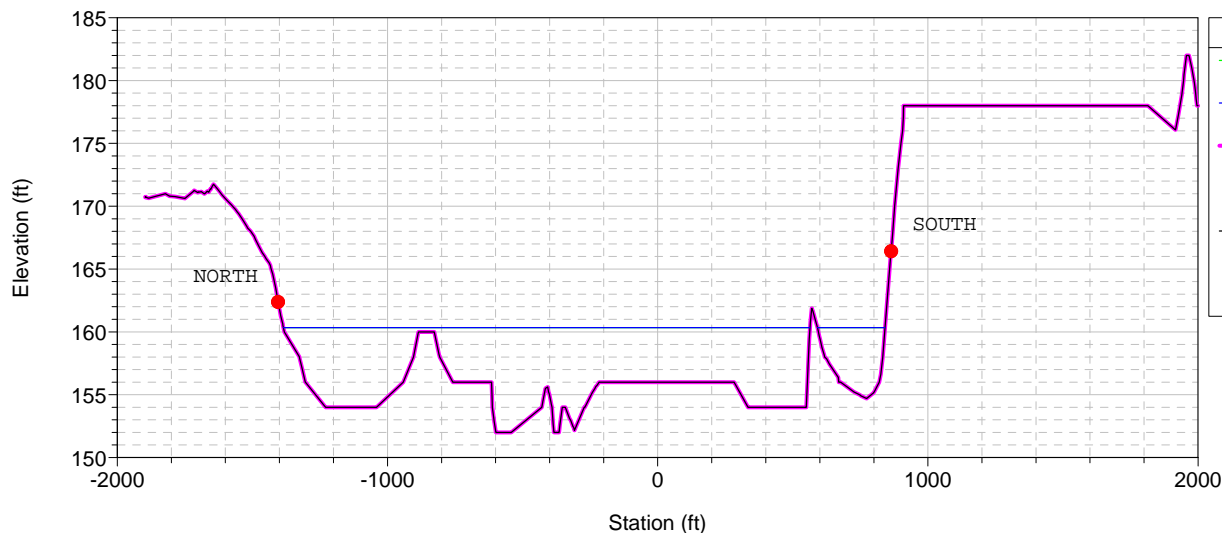

Legend	
	WS 100 yr - 2007_Exist
	WS 100 yr - 2007_Pro
	Ground - 2007_Exist
	Bank Sta - 2007_Exist
	Ground - 2007_Pro
	Bank Sta - 2007_Pro