

LEGEND

- Existing Runway
- FAR Part 77 Surfaces
- Threshold Sitting Surface (TSS)
- Runway Protection Zone (RPZ)
- Airport Property Boundary
- Object Penetrates Approach/Primary Surface
- Object Penetrates Transitional Surface
- Object Does Not Penetrate Transitional Surface
- Terrain Contours
- 15' vertical clearance added to road elevations
- Estimated
- (e)

MAP SOURCE:
USGS Topographic Survey Map coordinates: NAD27. Terrain contours: NGVD29

NOTES:

- Part 77 surface contours and obstruction elevations are shown in NAVD88.
- All Elevations are in feet above mean sea level.
- Obstruction points 80-113 on data table and plan view are not shown on profile view. These objects are greater than 25' below critical Part 77 surfaces.

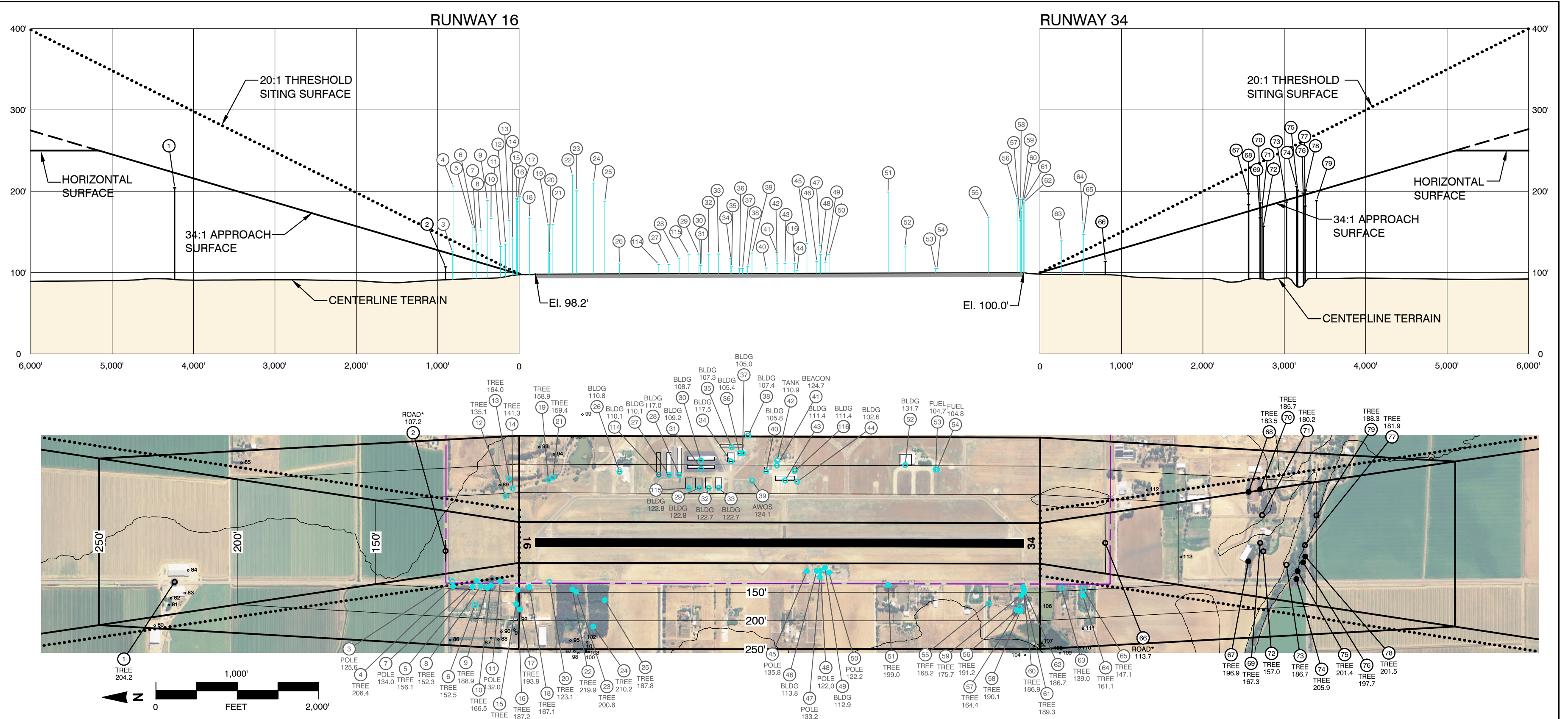

OBSTRUCTION DATA								
POINT #	DESCRIPTION	TOP ELEVATION IN FEET (MSL)	AFFECTED PART 77 SURFACE	PART 77 SURFACE ELEVATION	PART 77 SURFACE PENETRATION	THRESHOLD SITING SURFACE ELEVATION	THRESHOLD SITING SURFACE PENETRATION	DISPOSITION
1	TREE	204.2	RUNWAY 16 APPROACH	222.6	-18.4	305.7	-105.5	NO ACTION
2	ROAD*	127.0	RUNWAY 34 APPROACH	124.8	-11.8	143.3	-36.4	NO ACTION
3	POWER POLE	125.6	TRANSITIONAL	137.5	-11.9	139.2	-13.5	NO ACTION
4	TREE	206.4	TRANSITIONAL	166.4	60.0	N/A	N/A	CUT / TRIM
5	TREE	156.1	TRANSITIONAL	145.1	11.0	N/A	N/A	CUT / TRIM
6	TREE	152.5	TRANSITIONAL	177.0	-24.5	N/A	N/A	NO ACTION
7	POLE	134.0	TRANSITIONAL	134.3	-0.3	N/A	N/A	NO ACTION
8	TREE	152.3	TRANSITIONAL	143.3	9.0	N/A	N/A	CUT / TRIM
9	TREE	188.9	TRANSITIONAL	145.3	43.6	N/A	N/A	CUT / TRIM
10	TREE	166.5	TRANSITIONAL	141.0	25.5	N/A	N/A	CUT / TRIM
11	POWER POLE	132.0	TRANSITIONAL	132.8	-0.8	N/A	N/A	NO ACTION
12	TREE	135.1	TRANSITIONAL	145.9	-10.8	N/A	N/A	NO ACTION
13	TREE	164.0	TRANSITIONAL	178.0	-12.0	N/A	N/A	NO ACTION
14	TREE	141.3	TRANSITIONAL	158.0	-16.7	N/A	N/A	NO ACTION
15	TREE	190.8	TRANSITIONAL	170.9	20.0	N/A	N/A	CUT / TRIM
16	TREE	187.2	TRANSITIONAL	145.8	41.4	N/A	N/A	CUT / TRIM
17	TREE	193.9	TRANSITIONAL	180.0	13.9	N/A	N/A	CUT / TRIM
18	TREE	167.1	TRANSITIONAL	140.3	26.8	N/A	N/A	CUT / TRIM
19	TREE	158.9	TRANSITIONAL	173.0	-14.1	N/A	N/A	NO ACTION
20	TREE	125.1	TRANSITIONAL	151.9	-4.8	N/A	N/A	NO ACTION
21	TREE	159.4	TRANSITIONAL	176.7	-17.3	N/A	N/A	NO ACTION
22	TREE	219.9	TRANSITIONAL	144.9	75.0	N/A	N/A	CUT / TRIM
23	TREE	200.6	TRANSITIONAL	149.3	51.3	N/A	N/A	CUT / TRIM
24	TREE	210.2	TRANSITIONAL	210.0	0.2	N/A	N/A	CUT / TRIM
25	TREE	187.8	TRANSITIONAL	163.7	24.1	N/A	N/A	CUT / TRIM
26	BUILDING	115.8	TRANSITIONAL	187.1	-71.3	N/A	N/A	NO ACTION
27	BUILDING	110.1	TRANSITIONAL	182.1	-72.0	N/A	N/A	NO ACTION
28	BUILDING	117.0	TRANSITIONAL	182.1	-65.1	N/A	N/A	NO ACTION
29	BUILDING	122.8	TRANSITIONAL	189.0	-66.2	N/A	N/A	NO ACTION
30	BUILDING	108.7	TRANSITIONAL	208.1	-99.3	N/A	N/A	NO ACTION
31	BUILDING	106.2	TRANSITIONAL	183.7	-84.5	N/A	N/A	NO ACTION
32	BUILDING	125.7	TRANSITIONAL	185.7	-59.5	N/A	N/A	NO ACTION
33	BUILDING	122.9	TRANSITIONAL	159.4	-36.5	N/A	N/A	NO ACTION
34	BUILDING	117.5	TRANSITIONAL	206.1	-88.6	N/A	N/A	NO ACTION
35	BUILDING	107.3	TRANSITIONAL	231.1	-123.8	N/A	N/A	NO ACTION
36	BUILDING	105.4	TRANSITIONAL	220.4	-115.0	N/A	N/A	NO ACTION
37	BUILDING	105.0	TRANSITIONAL	220.4	-115.4	N/A	N/A	NO ACTION
38	BUILDING	107.4	TRANSITIONAL	220.0	-142.8	N/A	N/A	NO ACTION
39	AIRDS	124.1	TRANSITIONAL	172.3	-48.2	N/A	N/A	NO ACTION
40	BUILDING	105.8	TRANSITIONAL	189.1	-83.3	N/A	N/A	NO ACTION
41	BEACON	124.7	TRANSITIONAL	189.5	-74.7	N/A	N/A	NO ACTION
42	TANK	110.9	TRANSITIONAL	208.4	-97.5	N/A	N/A	NO ACTION
43	BUILDING	111.4	TRANSITIONAL	173.2	-61.9	N/A	N/A	NO ACTION
44	BUILDING	102.6	TRANSITIONAL	171.0	-68.4	N/A	N/A	NO ACTION
45	POLE	135.8	TRANSITIONAL	112.9	22.9	N/A	N/A	OBSTRUCTION LIGHT
46	BUILDING	113.8	TRANSITIONAL	112.4	1.3	N/A	N/A	OBSTRUCTION LIGHT
47	POLE	133.2	TRANSITIONAL	123.2	10.0	N/A	N/A	OBSTRUCTION LIGHT
48	POLE	122.0	TRANSITIONAL	112.7	9.3	N/A	N/A	OBSTRUCTION LIGHT
49	BUILDING	112.9	TRANSITIONAL	108.8	6.1	N/A	N/A	OBSTRUCTION LIGHT
50	POLE	122.2	TRANSITIONAL	115.2	7.0	N/A	N/A	OBSTRUCTION LIGHT
51	TREE	199.0	TRANSITIONAL	157.1	61.9	N/A	N/A	CUT / TRIM
52	BUILDING	131.7	TRANSITIONAL	200.8	-69.0	N/A	N/A	NO ACTION
53	FUEL	104.7	TRANSITIONAL	183.2	-88.5	N/A	N/A	NO ACTION
54	FUEL	104.8	TRANSITIONAL	183.4	-88.6	N/A	N/A	NO ACTION
55	TREE	168.2	TRANSITIONAL	169.8	-1.6	N/A	N/A	NO ACTION
56	TREE	191.2	TRANSITIONAL	181.7	9.5	N/A	N/A	CUT / TRIM
57	TREE	164.4	TRANSITIONAL	177.1	-12.7	N/A	N/A	NO ACTION
58	TREE	190.1	TRANSITIONAL	163.1	27.0	N/A	N/A	CUT / TRIM
59	TREE	175.7	TRANSITIONAL	155.6	20.1	N/A	N/A	CUT / TRIM
60	TREE	186.9	TRANSITIONAL	140.7	46.2	N/A	N/A	CUT / TRIM
61	TREE	189.3	TRANSITIONAL	160.0	29.3	N/A	N/A	CUT / TRIM
62	TREE	186.7	TRANSITIONAL	144.7	42.0	N/A	N/A	CUT / TRIM
63	TREE	139.0	TRANSITIONAL	143.9	-4.9	N/A	N/A	NO ACTION
64	TREE	161.1	TRANSITIONAL	159.8	1.3	N/A	N/A	CUT / TRIM
65	TREE	147.1	TRANSITIONAL	149.3	-2.2	N/A	N/A	NO ACTION
66	ROAD*	113.7	RUNWAY 34 APPROACH	123.6	-9.9	140.1	-26.4	NO ACTION
67	TREE	196.9	RUNWAY 34 APPROACH	175.3	21.6	228.0	-31.1	CUT / TRIM
68	TREE	183.5	RUNWAY 34 APPROACH	178.0	7.5	228.2	-44.7	CUT / TRIM
69	TREE	167.3	RUNWAY 34 APPROACH	178.6	-11.3	228.2	-60.9	NO ACTION
70	TREE	185.7	RUNWAY 34 APPROACH	181.3	-4.4	228.3	-42.6	CUT / TRIM

OBSTRUCTION DATA								
POINT #	DESCRIPTION	TOP ELEVATION IN FEET (MSL)	AFFECTED PART 77 SURFACE	PART 77 SURFACE ELEVATION	PART 77 SURFACE PENETRATION	THRESHOLD SITING SURFACE ELEVATION	THRESHOLD SITING SURFACE PENETRATION	DISPOSITION
71	TREE	180.9	RUNWAY 34 APPROACH	185.9	-5.0	228.4	-47.5	NO ACTION
72	TREE	127.0	RUNWAY 34 APPROACH	180.7	-53.7	227.2	-100.2	NO ACTION
73	TREE	186.7	RUNWAY 34 APPROACH	186.1	-0.4	251.4	-64.7	NO ACTION
74	TREE	205.9	RUNWAY 34 APPROACH	182.7	13.2	257.5	-51.6	CUT / TRIM
75	TREE	201.4	RUNWAY 34 APPROACH	183.1	8.3	258.3	-56.9	CUT / TRIM
76	TREE	197.7	RUNWAY 34 APPROACH	195.1	-2.5	261.7	-64.0	CUT / TRIM
77	TREE	181.9	RUNWAY 34 APPROACH	195.8	-13.9	262.8	-80.9	NO ACTION
78	TREE	201.5	RUNWAY 34 APPROACH	195.9	5.6	263.0	-61.5	CUT / TRIM
79	TREE	188.3	RUNWAY 34 APPROACH	199.9	-11.6	269.8	-81.5	NO ACTION
80	BUILDING	133.8	TRANSITIONAL	245.2	-111.5	322.0	-188.3	NO ACTION
81	TREE	142.5	RUNWAY 16 APPROACH	224.7	-82.2	313.3	-170.8	NO ACTION
82	TREE	158.0	RUNWAY 16 APPROACH	223.9	-65.9	312.0	-154.0	NO ACTION
83	BUILDING	127.4	RUNWAY 16 APPROACH	219.0	-91.5	303.6	-176.1	NO ACTION
84	BUILDING	128.1	RUNWAY 16 APPROACH	217.8	-89.7	301.5	-183.4	NO ACTION
85	TREE	146.2	TRANSITIONAL	228.6	-82.5	N/A	N/A	NO ACTION
86	TREE	136.2	TRANSITIONAL	240.7	-104.5	N/A	N/A	NO ACTION
87	TREE	146.9	TRANSITIONAL	233.5	-86.6	N/A	N/A	NO ACTION
88	TREE	158.7	TRANSITIONAL	234.9	-76.2	N/A	N/A	NO ACTION
89	TREE	134.4	TRANSITIONAL	184.7	-50.3	N/A	N/A	NO ACTION
90	TREE	134.0	TRANSITIONAL	220.8	-86.8	N/A	N/A	NO ACTION
91	TREE	150.5	TRANSITIONAL	215.9	-65.4	N/A	N/A	NO ACTION
92	TREE	153.1	TRANSITIONAL	198.5	-45.4	N/A	N/A	NO ACTION
93	TREE	181.0	TRANSITIONAL	229.8	-48.8	N/A	N/A	NO ACTION
94	TREE	160.3	TRANSITIONAL	217.2	-56.9	N/A	N/A	NO ACTION
95	TREE	172.4	TRANSITIONAL	234.8	-62.4	N/A	N/A	NO ACTION
96	TREE	181.4	TRANSITIONAL	247.6	-66.2	N/A	N/A	NO ACTION
97	TREE	167.7	TRANSITIONAL	250.0	-82.3	N/A	N/A	NO ACTION
98	TREE	177.8	TRANSITIONAL	250.0	-72.2	N/A	N/A	NO ACTION
99	TREE	172.9	TRANSITIONAL	250.0	-77.1	N/A	N/A	NO ACTION
100	TREE	170.4	TRANSITIONAL	250.0	-79.6	N/A	N/A	NO ACTION
101	TREE	171.1	TRANSITIONAL	250.0	-78.9	N/A	N/A	NO ACTION
102	TREE	180.7	TRANSITIONAL	237.7	-57.0	N/A	N/A	NO ACTION
103	TREE	172.4	TRANSITIONAL	250.0	-77.6	N/A	N/A	NO ACTION
104	TREE	162.5	TRANSITIONAL	250.0	-87.5	N/A	N/A	NO ACTION
105	TREE	170.5	TRANSITIONAL	244.9	-74.4	N/A	N/A	NO ACTION
106	TREE	133.9	TRANSITIONAL	175.8	-41.9	N/A	N/A	NO ACTION
107	TREE	148.8	TRANSITIONAL	239.1	-90.3	N/A	N/A	NO ACTION
108	TREE	164.4	TRANSITIONAL	250.0	-85.6	N/A	N/A	NO ACTION
109	TREE	155.7	TRANSITIONAL	250.0	-94.3	N/A	N/A	NO ACTION
110	TREE	161.9	TRANSITIONAL	250.0	-88.1	N/A	N/A	NO ACTION
111	TREE	161.1	TRANSITIONAL	218.4	-57.3	N/A	N/A	NO ACTION
112	TREE	142.7	TRANSITIONAL	169.1	-26.4	N/A	N/A	NO ACTION
113	TREE	171.1	RUNWAY 34 APPROACH	150.9	-20.2	186.5	-15.4	NO ACTION
114	BUILDING	110.1	TRANSITIONAL	181.6	-71.5	N/A	N/A	NO ACTION
115	BUILDING	122.8	TRANSITIONAL	158.7	-35.9	N/A	N/A	NO ACTION
116	BUILDING	111.4	TRANSITIONAL	189.6	-78.2	N/A	N/A	NO ACTION

Note: A negative penetration number indicates distance object is below indicated surface.

1	Update with new buildings and elevations	Mead & Hunt	October 2011
NO.	REVISION	SPONSOR	DATE
YOLO COUNTY AIRPORT DAVID/WOODLAND/WINTERS, CALIFORNIA AIRSPACE PLAN			
		133 Aviation Boulevard, Suite 100 Santa Rosa, California 95403 (707) 526-5010 Fax (707) 526-9721 www.meadhunt.com	
DESIGN:	TT/BM	DRAWN:	GJ
DATE:	August 2009	SHEET	4 OF 4