

**MAP SOURCE:**  
USGS Topographic Survey Map coordinates: NAD27. Terrain contours: NGVD29

**NOTES:**

- Part 77 surface contours and obstruction elevations are shown in NAVD88.
- All Elevations are in feet above mean sea level.
- Obstruction points 80-113 on data table and plan view are not shown on profile view. These objects are greater than 25' below critical Part 77 surfaces.

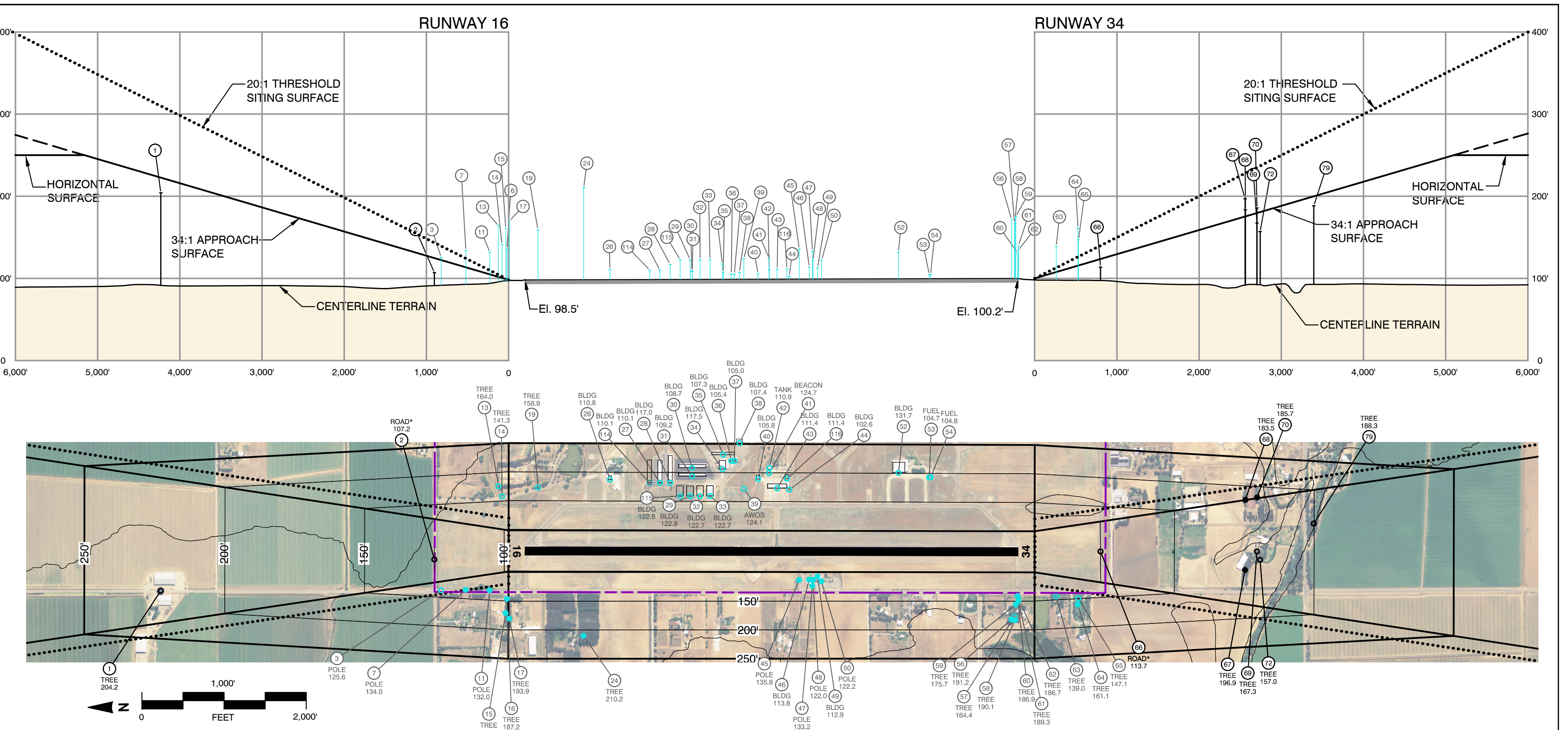

OBSTRUCTION DATA								
POINT #	DESCRIPTION	TOP ELEVATION IN FEET (MSL)	AFFECTED PART 77 SURFACE	PART 77 SURFACE ELEVATION	PART 77 SURFACE PENETRATION	THRESHOLD SITING SURFACE ELEVATION	THRESHOLD SITING SURFACE PENETRATION	DISPOSITION
1	TREE	204.2	RUNWAY 16 APPROACH	226.6	-18.4	268.7	-106.5	NO ACTION
2	ROAD*	107.0	RUNWAY 16 APPROACH	124.8	-17.8	143.3	-36.4	NO ACTION
3	POWER POLE	128.6	TRANSITIONAL	137.5	-11.9	139.2	-13.5	NO ACTION
4	REMOVED	N/A	TRANSITIONAL	146.4	N/A	N/A	N/A	NO ACTION
5	REMOVED	N/A	TRANSITIONAL	145.1	N/A	N/A	N/A	NO ACTION
6	REMOVED	N/A	TRANSITIONAL	177.0	N/A	N/A	N/A	NO ACTION
7	POLE	136.0	TRANSITIONAL	136.2	-0.2	N/A	N/A	NO ACTION
8	REMOVED	N/A	TRANSITIONAL	143.3	N/A	N/A	N/A	NO ACTION
9	REMOVED	N/A	TRANSITIONAL	145.3	N/A	N/A	N/A	NO ACTION
10	REMOVED	N/A	TRANSITIONAL	141.0	N/A	N/A	N/A	NO ACTION
11	POWER POLE	132.0	TRANSITIONAL	132.8	-0.8	N/A	N/A	NO ACTION
12	REMOVED	N/A	TRANSITIONAL	145.9	-10.8	N/A	N/A	NO ACTION
13	TREE	164.0	TRANSITIONAL	176.0	-12.0	N/A	N/A	NO ACTION
14	TREE	141.3	TRANSITIONAL	158.0	-16.7	N/A	N/A	NO ACTION
15	TREE	160.9	TRANSITIONAL	170.9	-10	N/A	N/A	NO ACTION
16	TREE	135.8	TRANSITIONAL	145.8	-10	N/A	N/A	NO ACTION
17	TREE	170.0	TRANSITIONAL	180.0	-10	N/A	N/A	NO ACTION
18	REMOVED	N/A	TRANSITIONAL	140.3	N/A	N/A	N/A	NO ACTION
19	TREE	158.9	TRANSITIONAL	173.0	-14.1	N/A	N/A	NO ACTION
20	REMOVED	N/A	TRANSITIONAL	151.9	N/A	N/A	N/A	NO ACTION
21	REMOVED	N/A	TRANSITIONAL	176.7	N/A	N/A	N/A	NO ACTION
22	REMOVED	N/A	TRANSITIONAL	144.9	N/A	N/A	N/A	NO ACTION
23	REMOVED	N/A	TRANSITIONAL	149.3	N/A	N/A	N/A	NO ACTION
24	TREE	210.2	TRANSITIONAL	210.0	0.2	N/A	N/A	CUT / TRIM
25	REMOVED	N/A	TRANSITIONAL	163.7	N/A	N/A	N/A	CUT / TRIM
26	BUILDING	116.8	TRANSITIONAL	167.1	-50.3	N/A	N/A	NO ACTION
27	BUILDING	110.1	TRANSITIONAL	162.1	-72.0	N/A	N/A	NO ACTION
28	BUILDING	117.0	TRANSITIONAL	162.1	-65.1	N/A	N/A	NO ACTION
29	BUILDING	122.8	TRANSITIONAL	169.0	-36.1	N/A	N/A	NO ACTION
30	BUILDING	108.7	TRANSITIONAL	208.1	-99.3	N/A	N/A	NO ACTION
31	BUILDING	109.2	TRANSITIONAL	193.7	-84.5	N/A	N/A	NO ACTION
32	BUILDING	122.7	TRANSITIONAL	162.7	-66.5	N/A	N/A	NO ACTION
33	BUILDING	122.9	TRANSITIONAL	199.4	-36.5	N/A	N/A	NO ACTION
34	BUILDING	117.5	TRANSITIONAL	206.1	-88.6	N/A	N/A	NO ACTION
35	BUILDING	107.3	TRANSITIONAL	231.1	-123.8	N/A	N/A	NO ACTION
36	BUILDING	105.4	TRANSITIONAL	220.4	-115.0	N/A	N/A	NO ACTION
37	BUILDING	105.0	TRANSITIONAL	220.4	-115.4	N/A	N/A	NO ACTION
38	BUILDING	107.4	TRANSITIONAL	250.0	-142.6	N/A	N/A	NO ACTION
39	AWDS	124.1	TRANSITIONAL	172.3	-48.2	N/A	N/A	NO ACTION
40	BUILDING	105.8	TRANSITIONAL	189.1	-83.3	N/A	N/A	NO ACTION
41	BEACON	124.7	TRANSITIONAL	199.5	-74.7	N/A	N/A	NO ACTION
42	TANK	110.9	TRANSITIONAL	208.4	-97.5	N/A	N/A	NO ACTION
43	BUILDING	111.4	TRANSITIONAL	173.2	-61.9	N/A	N/A	NO ACTION
44	BUILDING	102.8	TRANSITIONAL	171.0	-68.4	N/A	N/A	NO ACTION
45	POLE	135.8	TRANSITIONAL	112.9	22.9	N/A	N/A	OBSTRUCTION LIGHT
46	BUILDING	113.8	TRANSITIONAL	112.4	1.3	N/A	N/A	OBSTRUCTION LIGHT
47	POLE	133.2	TRANSITIONAL	123.2	10.0	N/A	N/A	OBSTRUCTION LIGHT
48	POLE	122.0	TRANSITIONAL	112.7	9.3	N/A	N/A	OBSTRUCTION LIGHT
49	BUILDING	112.9	TRANSITIONAL	108.8	6.1	N/A	N/A	OBSTRUCTION LIGHT
50	POLE	122.2	TRANSITIONAL	112.2	10	N/A	N/A	OBSTRUCTION LIGHT
51	REMOVED	N/A	TRANSITIONAL	137.1	N/A	N/A	N/A	NO ACTION
52	BUILDING	131.7	TRANSITIONAL	200.8	-69.0	N/A	N/A	NO ACTION
53	FUEL	104.7	TRANSITIONAL	193.2	-88.5	N/A	N/A	NO ACTION
54	FUEL	104.8	TRANSITIONAL	193.4	-88.6	N/A	N/A	NO ACTION
55	REMOVED	N/A	TRANSITIONAL	169.8	N/A	N/A	N/A	NO ACTION
56	TREE	171.7	TRANSITIONAL	181.7	-10	N/A	N/A	NO ACTION
57	TREE	167.1	TRANSITIONAL	177.1	-22.7	N/A	N/A	NO ACTION
58	TREE	173.1	TRANSITIONAL	183.1	-10	N/A	N/A	NO ACTION
59	TREE	145.6	TRANSITIONAL	155.6	-10	N/A	N/A	CUT / TRIM
60	TREE	130.7	TRANSITIONAL	140.7	-10	N/A	N/A	CUT / TRIM
61	TREE	140.0	TRANSITIONAL	150.0	-10	N/A	N/A	CUT / TRIM
62	TREE	134.7	TRANSITIONAL	144.7	-10	N/A	N/A	CUT / TRIM
63	REMOVED	139.0	TRANSITIONAL	143.9	N/A	N/A	N/A	NO ACTION
64	REMOVED	161.1	TRANSITIONAL	159.8	N/A	N/A	N/A	NO ACTION
65	REMOVED	147.1	TRANSITIONAL	149.3	N/A	N/A	N/A	NO ACTION
66	ROAD*	113.7	RUNWAY 34 APPROACH	123.6	-9.9	140.1	-26.4	NO ACTION
67	REMOVED	196.9	RUNWAY 34 APPROACH	175.3	N/A	228.0	-31.1	NO ACTION
68	REMOVED	183.5	RUNWAY 34 APPROACH	178.0	N/A	228.2	-44.7	NO ACTION
69	REMOVED	167.3	RUNWAY 34 APPROACH	179.6	N/A	228.2	-60.9	NO ACTION
70	REMOVED	185.7	RUNWAY 34 APPROACH	181.3	N/A	228.3	-42.6	NO ACTION

OBSTRUCTION DATA								
POINT #	DESCRIPTION	TOP ELEVATION IN FEET (MSL)	AFFECTED PART 77 SURFACE	PART 77 SURFACE ELEVATION	PART 77 SURFACE PENETRATION	THRESHOLD SITING SURFACE ELEVATION	THRESHOLD SITING SURFACE PENETRATION	DISPOSITION
71	REMOVED	N/A	RUNWAY 34 APPROACH	186.3	N/A	238.4	-52.2	NO ACTION
72	TREE	157.0	RUNWAY 34 APPROACH	183.7	-26.7	227.2	-70.2	NO ACTION
73	REMOVED	N/A	RUNWAY 34 APPROACH	189.1	N/A	251.4	-62.3	NO ACTION
74	REMOVED	N/A	RUNWAY 34 APPROACH	192.7	N/A	257.5	-64.8	CUT / TRIM
75	REMOVED	N/A	RUNWAY 34 APPROACH	193.1	N/A	258.3	-65.2	CUT / TRIM
76	REMOVED	N/A	RUNWAY 34 APPROACH	195.1	N/A	261.7	-66.6	CUT / TRIM
77	REMOVED	N/A	RUNWAY 34 APPROACH	195.8	N/A	262.8	-67.0	NO ACTION
78	REMOVED	N/A	RUNWAY 34 APPROACH	195.9	N/A	263.0	-67.1	CUT / TRIM
79	TREE	188.3	RUNWAY 34 APPROACH	199.9	-11.6	269.8	-81.5	NO ACTION
80	BUILDING	138.8	TRANSITIONAL	245.2	-111.5	322.0	-183.3	NO ACTION
81	TREE	142.5	RUNWAY 16 APPROACH	224.7	-82.2	313.3	-170.8	NO ACTION
82	TREE	158.0	RUNWAY 16 APPROACH	223.9	-65.9	312.0	-154.0	NO ACTION
83	BUILDING	127.4	RUNWAY 16 APPROACH	216.0	-88.6	303.6	-176.1	NO ACTION
84	TREE	138.1	RUNWAY 16 APPROACH	217.8	-79.7	301.5	-163.4	NO ACTION
85	TREE	146.2	TRANSITIONAL	229.6	-83.5	N/A	N/A	NO ACTION
86	TREE	136.2	TRANSITIONAL	240.7	-104.5	N/A	N/A	NO ACTION
87	TREE	146.9	TRANSITIONAL	233.5	-86.6	N/A	N/A	NO ACTION
88	TREE	158.7	TRANSITIONAL	234.9	-76.2	N/A	N/A	NO ACTION
89	TREE	135.4	TRANSITIONAL	164.7	-29.3	N/A	N/A	NO ACTION
90	TREE	154.0	TRANSITIONAL	220.8	-66.8	N/A	N/A	NO ACTION
91	TREE	150.5	TRANSITIONAL	215.9	-65.4	N/A	N/A	NO ACTION
92	TREE	153.1	TRANSITIONAL	198.5	-45.4	N/A	N/A	NO ACTION
93	TREE	161.0	TRANSITIONAL	229.8	-68.8	N/A	N/A	NO ACTION
94	TREE	160.3	TRANSITIONAL	217.2	-56.9	N/A	N/A	NO ACTION
95	TREE	172.4	TRANSITIONAL	234.8	-62.4	N/A	N/A	NO ACTION
96	TREE	181.4	TRANSITIONAL	247.6	-66.2	N/A	N/A	NO ACTION
97	TREE	167.7	TRANSITIONAL	250.0	-82.3	N/A	N/A	NO ACTION
98	TREE	177.8	TRANSITIONAL	250.0	-72.2	N/A	N/A	NO ACTION
99	TREE	172.9	TRANSITIONAL	250.0	-77.1	N/A	N/A	NO ACTION
100	TREE	170.4	TRANSITIONAL	250.0	-79.6	N/A	N/A	NO ACTION
101	TREE	171.1	TRANSITIONAL	250.0	-78.9	N/A	N/A	NO ACTION
102	TREE	180.4	TRANSITIONAL	237.7	-57.3	N/A	N/A	NO ACTION
103	TREE	172.4	TRANSITIONAL	250.0	-77.6	N/A	N/A	NO ACTION
104	TREE	162.5	TRANSITIONAL	250.0	-87.5	N/A	N/A	NO ACTION
105	TREE	170.5	TRANSITIONAL	244.9	-74.4	N/A	N/A	NO ACTION
106	TREE	133.9	TRANSITIONAL	175.8	-41.9	N/A	N/A	NO ACTION
107	TREE	148.8	TRANSITIONAL	239.1	-90.3	N/A	N/A	NO ACTION
108	TREE	159.8	TRANSITIONAL	250.0	-90.1	N/A	N/A	NO ACTION
109	TREE	155.7	TRANSITIONAL	250.0	-94.3	N/A	N/A	NO ACTION
110	TREE	161.9	TRANSITIONAL	250.0	-88.1	N/A	N/A	NO ACTION
111	TREE	161.1	TRANSITIONAL	218.4	-57.3	N/A	N/A	NO ACTION
112	TREE	142.7	TRANSITIONAL	169.1	-26.4	N/A	N/A	NO ACTION
113	TREE	117.6	RUNWAY 34 APPROACH	150.9	-33.3	186.5	-68.9	NO ACTION
114	BUILDING	110.1	TRANSITIONAL	181.8	-71.5	N/A	N/A	NO ACTION
115	BUILDING	122.8	TRANSITIONAL	159.7	-36.9	N/A	N/A	NO ACTION
116	BUILDING	111.4	TRANSITIONAL	189.6	-78.2	N/A	N/A	NO ACTION

Note: A negative penetration number indicates distance object is below indicated surface.

1	Update with new buildings and elevations	Mead & Hunt	October 2011
2	Update to meet 13A	Mead & Hunt	Feb. 2015
NO.	REVISION	SPONSOR	DATE
<b>YOLO COUNTY AIRPORT</b> <b>DAVID/WOODLAND/WINTERS, CALIFORNIA</b> <b>AIRSPACE PLAN</b>			
		133 Aviation Boulevard, Suite 100 Santa Rosa, California 95403 (707) 526-0010 Fax (707) 526-9721 www.meadhunt.com	
DESIGN:	TT/BM	DRAWN:	TE
DATE:	August 2009	SHEET	5 OF 7

DRAFT  
WORK IN PROGRESS