

**LEGEND**

- Existing Runway
- FAR Part 77 Surfaces
- Threshold Siting Surface (TSS)
- Runway Protection Zone (RPZ)
- Airport Property Boundary
- Object Penetrates Approach/Primary Surface
- Object Does Not Penetrate Approach/Primary Surface
- Object Penetrates Transitional Surface
- Object Does Not Penetrate Transitional Surface
- Terrain Contours
- 15' vertical clearance added to road elevations
- Estimated

**MAP SOURCE:**  
USGS Topographic Survey Map coordinates: NAD27. Terrain contours: NGVD29

- NOTES:**
- Part 77 surface contours and obstruction elevations are shown in NAVD88.
  - All Elevations are in feet above mean sea level.
  - Objects 25' or more below the critical airspace surfaces are not depicted in the data table or on the plan and profile views. Exception is buildings. All buildings are shown.
  - Obstruction lighted near-term; relocate long-term.

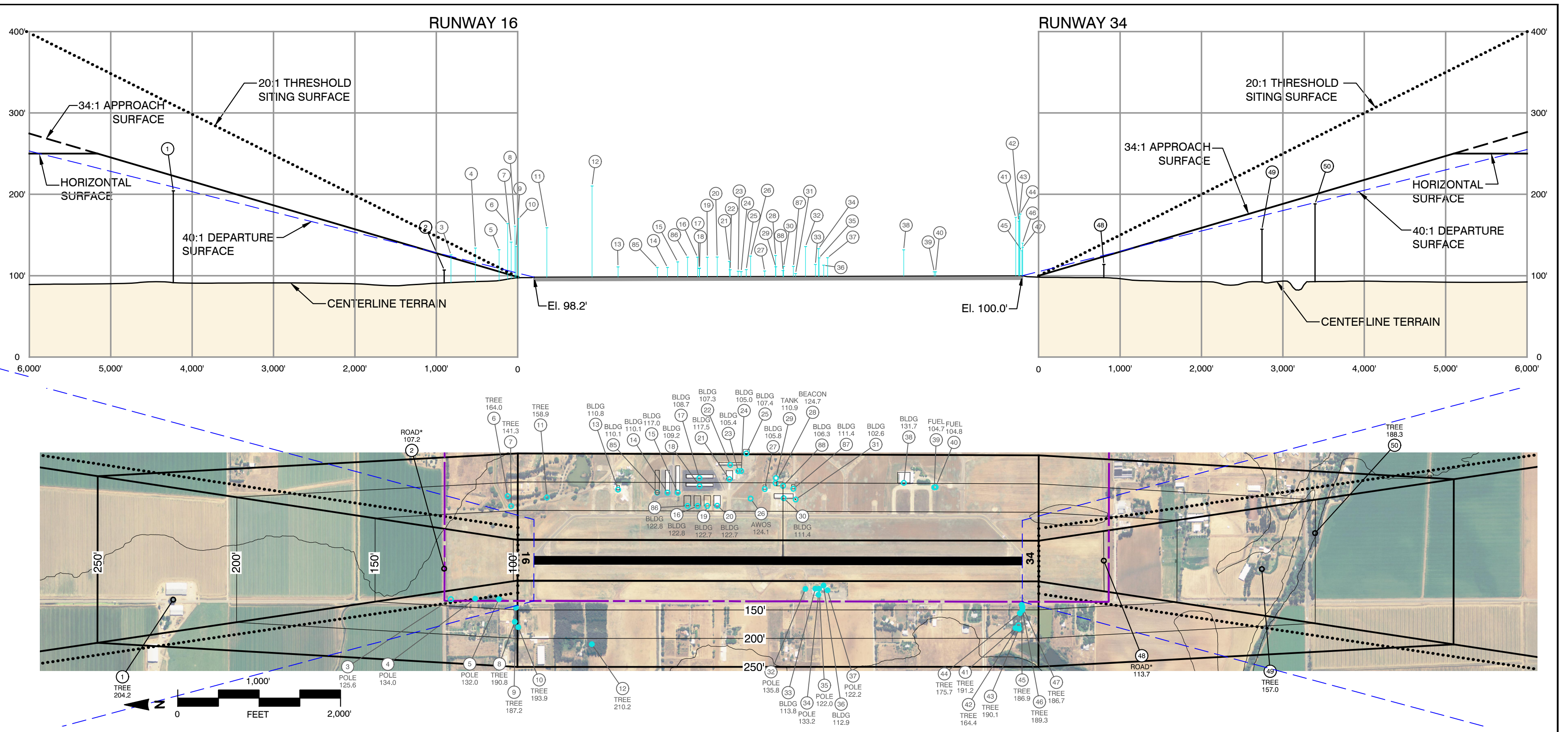

OBSTRUCTION DATA								
POINT #	DESCRIPTION	TOP ELEVATION IN FEET (MSL)	AFFECTED PART 77 SURFACE	PART 77 SURFACE ELEVATION	PART 77 SURFACE PENETRATION	THRESHOLD SITING SURFACE ELEVATION	THRESHOLD SITING SURFACE PENETRATION	DISPOSITION
1	TREE	204.2	RUNWAY 16 APPROACH	222.6	-18.4	306.7	105.5	NO ACTION
2	ROAD*	107.0	RUNWAY 16 APPROACH	124.8	-17.8	143.3	-36.4	NO ACTION
3	POWER POLE	125.6	TRANSITIONAL	137.5	-11.9	139.2	-13.5	NO ACTION
4	POLE	134.0	TRANSITIONAL	134.3	-0.3	N/A	N/A	NO ACTION
5	POWER POLE	132.0	TRANSITIONAL	132.8	-0.8	N/A	N/A	NO ACTION
6	TREE	164.0	TRANSITIONAL	176.0	-12.0	N/A	N/A	NO ACTION
7	TREE	141.3	TRANSITIONAL	158.0	-16.7	N/A	N/A	NO ACTION
8	TREE	160.9	TRANSITIONAL	170.9	-10.0	N/A	N/A	NO ACTION
9	TREE	135.8	TRANSITIONAL	145.8	-10.0	N/A	N/A	NO ACTION
10	TREE	170.0	TRANSITIONAL	190.0	-10.0	N/A	N/A	NO ACTION
11	TREE	158.9	TRANSITIONAL	173.0	-14.1	N/A	N/A	NO ACTION
12	TREE	210.2	TRANSITIONAL	210.0	0.2	N/A	N/A	CUT / TRIM
13	BUILDING	110.8	TRANSITIONAL	187.1	-76.3	N/A	N/A	NO ACTION
14	BUILDING	110.1	TRANSITIONAL	182.1	-72.0	N/A	N/A	NO ACTION
15	BUILDING	117.0	TRANSITIONAL	182.1	-65.1	N/A	N/A	NO ACTION
16	BUILDING	122.8	TRANSITIONAL	159.0	-36.1	N/A	N/A	NO ACTION
17	BUILDING	108.7	TRANSITIONAL	208.1	-99.3	N/A	N/A	NO ACTION
18	BUILDING	199.2	TRANSITIONAL	193.7	-6.5	N/A	N/A	NO ACTION
19	BUILDING	122.7	TRANSITIONAL	159.2	-36.5	N/A	N/A	NO ACTION
20	BUILDING	122.9	TRANSITIONAL	159.4	-36.5	N/A	N/A	NO ACTION
21	BUILDING	117.5	TRANSITIONAL	208.1	-88.6	N/A	N/A	NO ACTION
22	BUILDING	107.3	TRANSITIONAL	231.1	-123.8	N/A	N/A	NO ACTION
23	BUILDING	105.4	TRANSITIONAL	220.4	-115.0	N/A	N/A	NO ACTION
24	BUILDING	105.0	TRANSITIONAL	220.4	-115.4	N/A	N/A	NO ACTION
25	BUILDING	107.4	TRANSITIONAL	250.0	-142.6	N/A	N/A	NO ACTION
26	AWOS	124.1	TRANSITIONAL	172.3	-48.2	N/A	N/A	NO ACTION
27	BUILDING	105.8	TRANSITIONAL	189.1	-83.3	N/A	N/A	NO ACTION
28	BEACON	124.7	TRANSITIONAL	199.5	-74.7	N/A	N/A	NO ACTION
29	TANK	110.9	TRANSITIONAL	208.4	-97.5	N/A	N/A	NO ACTION

OBSTRUCTION DATA								
POINT #	DESCRIPTION	TOP ELEVATION IN FEET (MSL)	AFFECTED PART 77 SURFACE	PART 77 SURFACE ELEVATION	PART 77 SURFACE PENETRATION	THRESHOLD SITING SURFACE ELEVATION	THRESHOLD SITING SURFACE PENETRATION	DISPOSITION
30	BUILDING	111.4	TRANSITIONAL	173.2	-61.9	N/A	N/A	NO ACTION
31	BUILDING	102.6	TRANSITIONAL	171.0	-68.4	N/A	N/A	NO ACTION
32	POLE	125.6	TRANSITIONAL	112.9	22.9	N/A	N/A	SEE NOTE 4
33	BUILDING	113.8	TRANSITIONAL	112.4	1.3	N/A	N/A	SEE NOTE 4
34	POLE	133.2	TRANSITIONAL	123.2	10.0	N/A	N/A	SEE NOTE 4
35	POLE	122.0	TRANSITIONAL	112.7	9.3	N/A	N/A	SEE NOTE 4
36	BUILDING	112.9	TRANSITIONAL	106.8	6.1	N/A	N/A	SEE NOTE 4
37	POLE	122.2	TRANSITIONAL	115.2	7.0	N/A	N/A	SEE NOTE 4
38	BUILDING	131.7	TRANSITIONAL	200.8	-69.0	N/A	N/A	NO ACTION
39	FUEL	104.7	TRANSITIONAL	190.2	-85.5	N/A	N/A	NO ACTION
40	FUEL	104.8	TRANSITIONAL	190.4	-85.6	N/A	N/A	NO ACTION
41	TREE	171.7	TRANSITIONAL	181.7	-10.0	N/A	N/A	NO ACTION
42	TREE	167.1	TRANSITIONAL	177.1	-22.7	N/A	N/A	NO ACTION
43	TREE	173.1	TRANSITIONAL	183.1	-10.0	N/A	N/A	NO ACTION
44	TREE	145.6	TRANSITIONAL	155.6	-10.0	N/A	N/A	CUT / TRIM
45	TREE	130.7	TRANSITIONAL	140.7	-10.0	N/A	N/A	CUT / TRIM
46	TREE	120.0	TRANSITIONAL	130.0	-10.0	N/A	N/A	CUT / TRIM
47	TREE	134.7	TRANSITIONAL	144.7	-10.0	N/A	N/A	CUT / TRIM
48	ROAD*	113.7	RUNWAY 34 APPROACH	123.6	-9.9	140.1	-26.4	NO ACTION
49	TREE	157.0	RUNWAY 34 APPROACH	160.7	-23.7	237.2	-80.2	NO ACTION
50	TREE	186.3	RUNWAY 34 APPROACH	199.9	-11.6	269.8	-81.5	NO ACTION
51	BUILDING	133.8	TRANSITIONAL	245.2	-111.5	322.0	-188.3	NO ACTION
52	BUILDING	127.4	RUNWAY 16 APPROACH	219.0	-91.6	303.6	-176.1	NO ACTION
53	BUILDING	138.1	RUNWAY 16 APPROACH	217.8	-79.7	301.5	-163.4	NO ACTION
54	BUILDING	110.1	TRANSITIONAL	181.6	-71.5	N/A	N/A	NO ACTION
55	BUILDING	122.8	TRANSITIONAL	158.7	-35.9	N/A	N/A	NO ACTION
56	BUILDING	111.4	TRANSITIONAL	189.6	-78.2	N/A	N/A	NO ACTION
57	BUILDING	106.3	TRANSITIONAL	194.7	-88.4	N/A	N/A	NO ACTION

Note: A negative penetration number indicates distance object is below indicated surface.

1	Update with new buildings and elevations	Mead & Hunt	October 2011
2	Update to meet 13A	Mead & Hunt	April 2016
NO.	REVISION	BY	DATE
<b>YOLO COUNTY AIRPORT</b>			
DAVID/WOODLAND/WINTERS, CALIFORNIA			
<b>AIRSPACE PLAN</b>			
<b>Mead &amp; Hunt</b>		133 Aviation Boulevard, Suite 100 Santa Rosa, California 95403 (707) 526-5010 Fax (707) 526-9721 www.meadhunt.com	
DESIGN:	TT/BM	DRAWN:	TE
DATE:	August 2009	SHEET	5 OF 7