

# OFF-CHANNEL MINING PLAN FOR SHIFLER PROPERTY

YOLO COUNTY, CALIFORNIA  
FEBRUARY 2016

## GENERAL NOTES:

- ALL WORK SHALL CONFORM TO THE YOLO COUNTY OFF-CHANNEL MINING ORDINANCE (ORD. #1190), THE PROJECT SPECIFIC CONDITIONS OF APPROVAL, THE PROJECT STORM WATER POLLUTION PREVENTION PLAN (SWPPP), THE SURFACE MINING AND RECLAMATION ACT (SMARA), OSHA, MSHA, AND OTHER APPLICABLE LOCAL, STATE AND FEDERAL REGULATIONS.
- EXISTING TOPOGRAPHY BASED ON AERIAL TOPOGRAPHY FLOWN IN APRIL 2010 BY POINT CO. PHOTOGRAMMETRIC SERVICES; VERIFY EXISTING CONDITIONS PRIOR TO COMMENCING MINING.
- ANY WORK THAT NEEDS TO BE PERFORMED WITHIN PG&E'S OR ANY OTHER UTILITY COMPANY'S EASEMENT WILL REQUIRE A CONSENT AGREEMENT FROM THE APPROPRIATE UTILITY COMPANY. USE CAUTION WHEN OPERATING ANY VEHICLES OR EQUIPMENT NEAR OVERHEAD AND UNDERGROUND ELECTRIC FACILITIES. COMPLY WITH ALL CONDITIONS LISTED IN THE CONSENT AGREEMENT.
- THE DEPTH OF MINING AND THE LIMIT-OF-MINING LINES ARE ONLY APPROXIMATE, AND ARE SUBJECT TO CHANGE BASED ON THE AMOUNT AND QUALITY OF MATERIAL UNCOVERED, AND THE ABILITY OF THE PRODUCER TO MEET THE RECLAMATION REQUIREMENTS. THE FORESEEABLE ESTIMATE OF VARIATION IS +/- 10' IN MINING DEPTH; AND +/- 20% OF AREA FOR EACH TYPE OF RECLAMATION.
- HIGH AND LOW AVERAGE GROUNDWATER ELEVATIONS BASED ON "GROUNDWATER CONDITIONS IN THE VICINITY OF PLANNED WETPIT MINING OPERATIONS, SHIFLER PROPERTY" AND "CONTOURS OF PREDICTED GROUNDWATER ELEVATION, AVERAGE FALL LOW, POST-RECLAMATION", BY LUHDORFF & SCALMANINI CONSULTING ENGINEERS DATED DECEMBER 22, 2015, UPDATED FEBRUARY 2016.
- MAXIMUM INCLINATION OF MINING SLOPES ABOVE THE SUMMER LOW GROUNDWATER LEVEL TO BE 3/4:1 (H:V).
- PROVIDE PROTECTION TO WET PIT AREAS FROM STORMWATER AND/OR AGRICULTURAL RUNOFF THROUGH THE PLACEMENT OF BERMS AND/OR SWALES. (THIS NOTE MAY NOT APPLY OR BE REQUIRED IF EXISTING TOPOGRAPHY PREVENTS SURFACE RUNOFF FROM ENTERING ANY OF THE MINING EXCAVATIONS THAT EXPOSE GROUNDWATER.)
- IF HUMAN SKELETAL REMAINS ARE ENCOUNTERED DURING EXCAVATION, ALL WORK WITHIN SEVENTY-FIVE (75) FEET SHALL IMMEDIATELY STOP, AND THE COUNTY CORONER SHALL BE NOTIFIED WITHIN TWENTY-FOUR (24) HOURS. IF ANY CULTURAL RESOURCES, SUCH AS CHIPPED OR GROUND STONE, HISTORIC DEBRIS, BUILDING FOUNDATIONS, OR PALEONTOLOGICAL MATERIALS ARE ENCOUNTERED DURING EXCAVATION, THEN ALL WORK WITHIN SEVENTY-FIVE (75) FEET SHALL IMMEDIATELY STOP AND THE DIRECTOR SHALL BE NOTIFIED AT ONCE. ANY CULTURAL RESOURCES FOUND ON THE SITE SHALL BE RECORDED BY A QUALIFIED ARCHAEOLOGIST AND THE INFORMATION SHALL BE SUBMITTED TO THE COUNTY.
- DURING OPERATIONS, THE SITE SHALL BE KEPT FREE OF DEBRIS AND MAINTAINED IN A NEAT AND ORDERLY MANNER SO AS NOT TO CREATE ANY HAZARDOUS OR UNSIGHTLY CONDITIONS. OVERBURDEN SHALL BE STOCKPILED AND STUMPS, BRUSH, OR OTHER DEBRIS RESULTING FROM EXCAVATION AND/OR PROCESSING SHALL BE PROPERLY DISPOSED.
- UNNECESSARY PERSONNEL SHALL BE EXCLUDED FROM OFF-CHANNEL EXCAVATIONS. OPEN PITS SHALL BE FENCED WITH A FOUR STRAND BARBED WIRE FENCE OR THE EQUIVALENT, PRIOR TO THE COMMENCEMENT OF EXCAVATION. FENCING MAY ENCLOSE THE PROPERTY OF WHICH THE MINING SITE IS A PART, THE MINING SITE, OR BOTH. IN ADDITION, SIGNS SHALL BE INSTALLED AT THE PROJECT SITE BOUNDARIES AND ACCESS ROAD, INDICATING THAT THE EXCAVATION AREA IS A DANGER ZONE.

## ABBREVIATIONS:

AC	ACRES	IRR	IRRIGATION
AG	AGRICULTURAL	MSHA	MINE SAFETY AND HEALTH ADMINISTRATION
AGG	AGGREGATE	MW	MONITOR WELL
AMSL	ABOVE MEAN SEA LEVEL	N	NORTH
APN	ASSESSOR'S PARCEL NUMBER	N.I.C.	NOT IN CONTRACT
AVG	AVERAGE	OG	ORIGINAL GROUND ELEVATION
CFR	CODE OF FEDERAL REGULATIONS	OSHA	OCCUPATIONAL SAFETY AND HEALTH ADMINISTRATION
CL	CENTER LINE	PL	PROPERTY LINE
CY	CUBIC YARDS	R	RADIUS
E	EAST	R/W	RIGHT-OF-WAY
ELEV	ELEVATION	RECL.	RECLAMATION
FG	FINISH GRADE	S	SLOPE
FL	FLOW LINE	S&G	SAND AND GRAVEL
FT	FEET	TYP	TYPICAL
GB	GRADE BREAK	V	VERTICAL
GW	GROUND WATER	W	WEST
H	HORIZONTAL	YR	YEAR

## LEGEND:

FOUND MONUMENTS AS SHOWN	✕	EXISTING ELEV.	195.0
POWER POLE	⊖	PROPOSED ELEV.	30.0
EXISTING EDGE OF ROAD	—	HORIZONTAL TO VERTICAL SLOPE	2:1
WATER	—	WATER SURFACE	▽
EXISTING GROUND CONTOUR	100	PROPERTY BOUNDARY	—
PROPOSED CONTOUR	90	RIGHT-OF-WAY	—
CROSS SECTION NUMBER AND SHEET LOCATION	A C-03	EASEMENT	—
APPROXIMATE YOLO COUNTY TEST 3 LINE	—	FENCE	-x-x-x-x-x-
APPROXIMATE 100YR WATER SURFACE LIMITS	—		

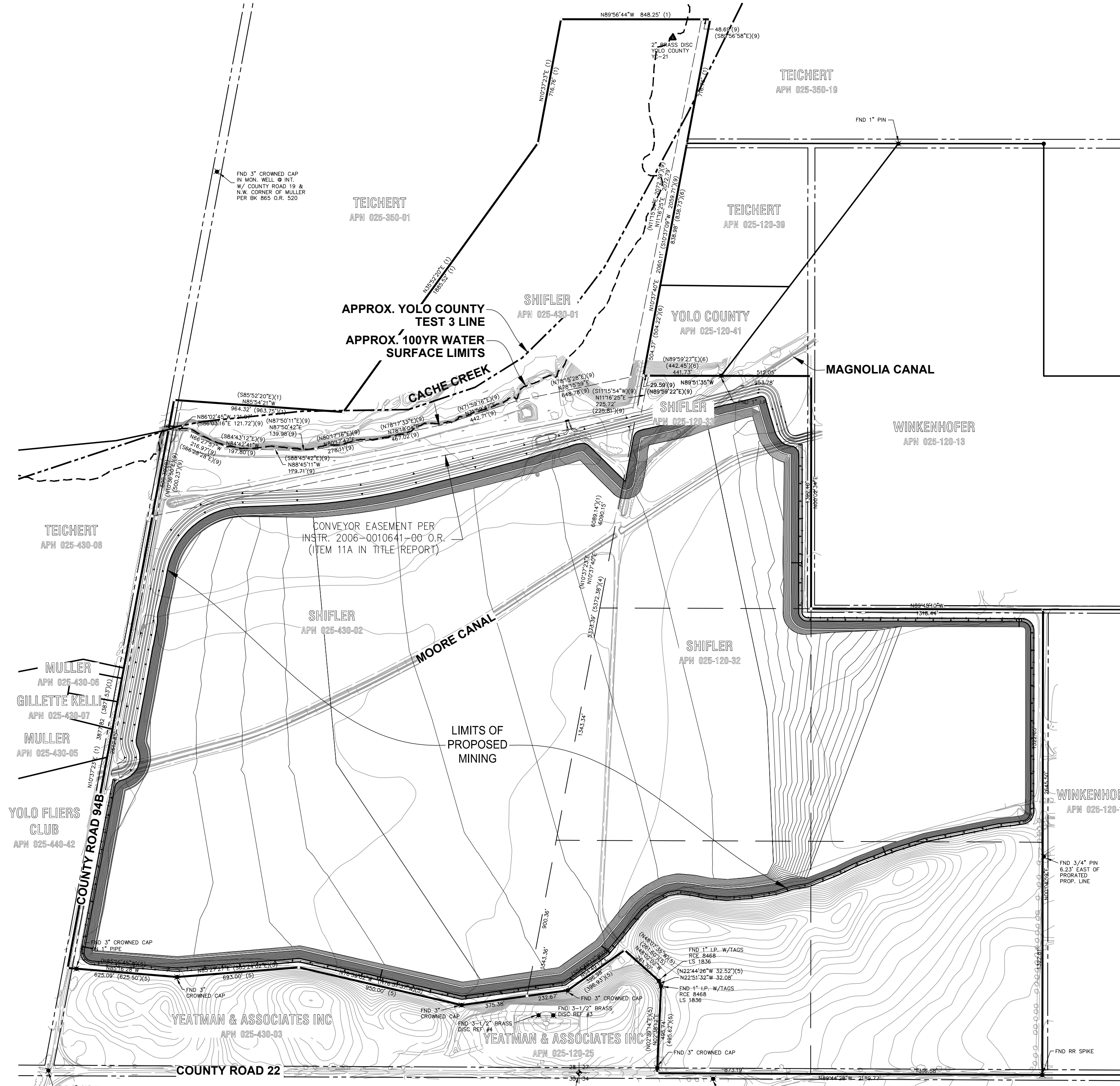

KEY MAP  
1"=400'

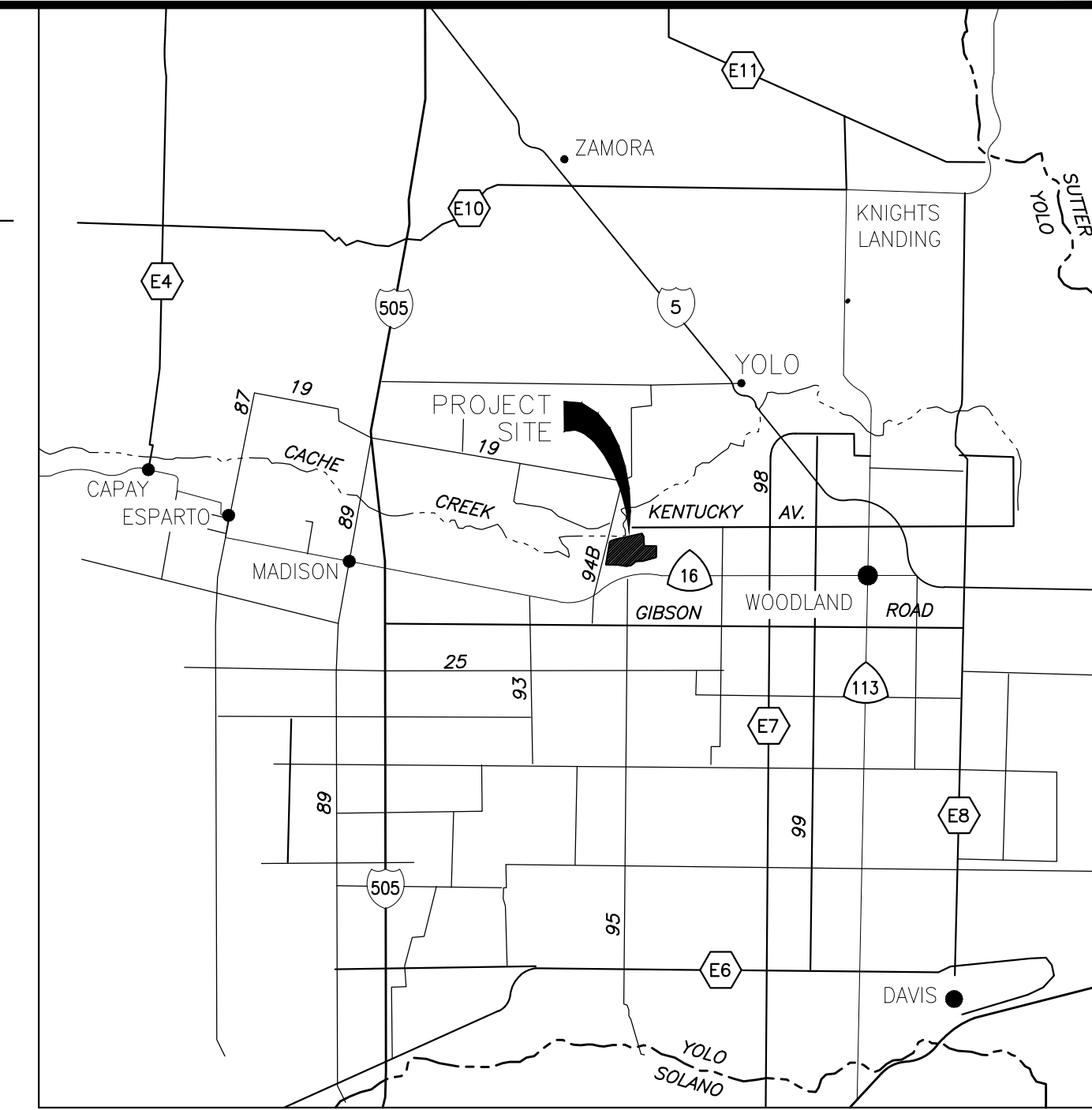

VICINITY MAP  
NOT TO SCALE

## SHEET INDEX:

- M-01 TITLE SHEET
- M-02 SITE PLAN
- M-03 CROSS SECTION A-A
- M-04 CROSS SECTION B-B
- M-05 CROSS SECTION C-C
- M-06 CROSS SECTION D-D
- M-07 CROSS SECTION E-E
- M-08 CROSS SECTION F-F
- M-09 CROSS SECTION G-G & H-H

## BENCHMARK:

EXISTING TOPOGRAPHY BASED ON AERIAL TOPOGRAPHY FLOWN IN APRIL 2010 BY POINT CO. PHOTOGRAMMETRIC SERVICES. AERIAL TARGETS SURVEYED BY LAUGENOUR AND MEIKLE, WOODLAND. HORIZONTAL DATUM: CA NAD83 ZONE 2 VERTICAL DATUM: NAVD 88

## ASSESSORS PARCEL NO.:

- 025-120-32
- 025-120-33
- 025-430-02
- 025-430-01

## PROPERTY OWNER:

SHIFLER LJ FAMILY TRUST INC.  
35030 COUNTY ROAD 20  
WOODLAND, CA 95851

## APPLICANT:

TEICHERT AGGREGATES  
P.O. BOX 15002  
SACRAMENTO, CA 95851  
(916) 484-3319

## CIVIL ENGINEER:

CUNNINGHAM ENGINEERING  
2940 SPAFFORD STREET, SUITE 200  
DAVIS, CALIFORNIA 95618  
(530) 758-2026

## DRAWING STATUS:

- PLAN REVIEW SET - NOT FOR CONSTRUCTION
- PERMIT SET



DESIGNED BY	NC	NO.	DATE	REVISIONS	BY	APPD.
DRAWN BY	NC/LR					
CHECKED BY	SG					
SCALE	AS SHOWN					

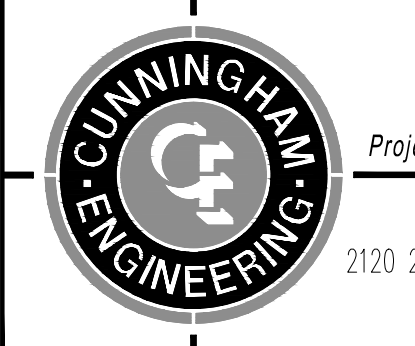

CECWEST.COM  
Project Planning ■ Civil Engineering ■ Landscape Architecture  
Sacramento Office: 2120 20th Street, Suite Three, Sacramento, CA 95818, (916) 455-2026  
Davis Office: 2940 Spafford Street, Suite 200, Davis, CA 95618, (530) 758-2026

# SHIFLER MINING PLAN TITLE SHEET

SHEET	M-01
OF	9
DATE:	02/11/16
JOB NO:	1129.20

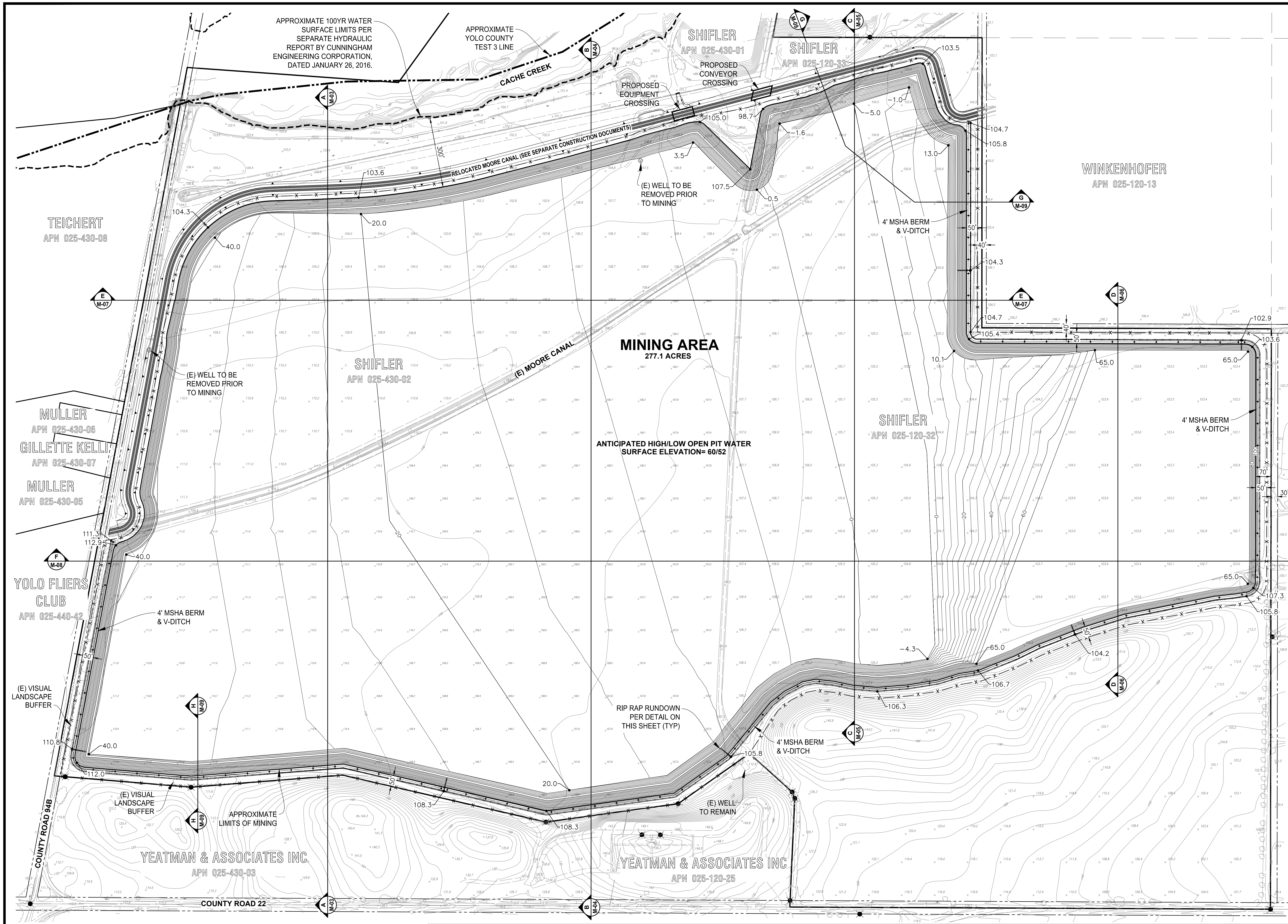

- NOTES:**
- ELEVATIONS AND DISTANCES ARE APPROXIMATE. EXISTING GROUND IS BASED ON AERIAL TOPOGRAPHY FLOWN IN APRIL 2010 BY POINT CO. PHOTOGRAMMETRIC SERVICES.
  - HIGH AND LOW AVERAGE GROUNDWATER ELEVATIONS BASED ON "GROUNDWATER CONDITIONS IN THE VICINITY OF PLANNED WETPIT MINING OPERATIONS, SHIFLER PROPERTY" AND "CONTOURS OF PREDICTED GROUNDWATER ELEVATION, AVERAGE FALL LOW, POST-RECLAMATION", BY LUHDORFF & SCALMANINI CONSULTING ENGINEERS DATED DECEMBER 22, 2015, UPDATED FEBRUARY 2016.
  - BERMS OR V-DITCHES (NOT SHOWN) TO BE ADDED ALONG THE TOP OF SLOPES AS NECESSARY TO KEEP SURFACE RUNOFF FROM ADJACENT AREAS FROM ENTERING INTO THE DESIGNATED OPEN WATER AREAS.
  - BOTTOM MINING ELEVATIONS ARE ±10' DEPENDING ON ACTUAL BOTTOM OF GRAVEL DEPTHS.
  - PROPOSED CONTOURS SHOWN AT 5' INTERVAL.
  - WELLS TO BE ABANDONED SHALL BE ABANDONED PER YOLO COUNTY DEPARTMENT OF ENVIRONMENTAL HEALTH STANDARDS.
  - TOPSOIL AND OVERBURDEN STOCKPILES SHALL BE SLOPED AND VEGETATED PER SECTION 10-4.433 OF THE MINING ORDINANCE.

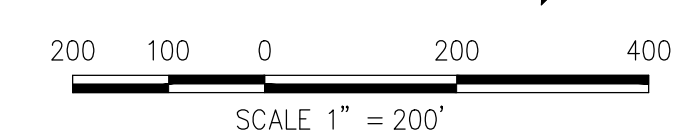
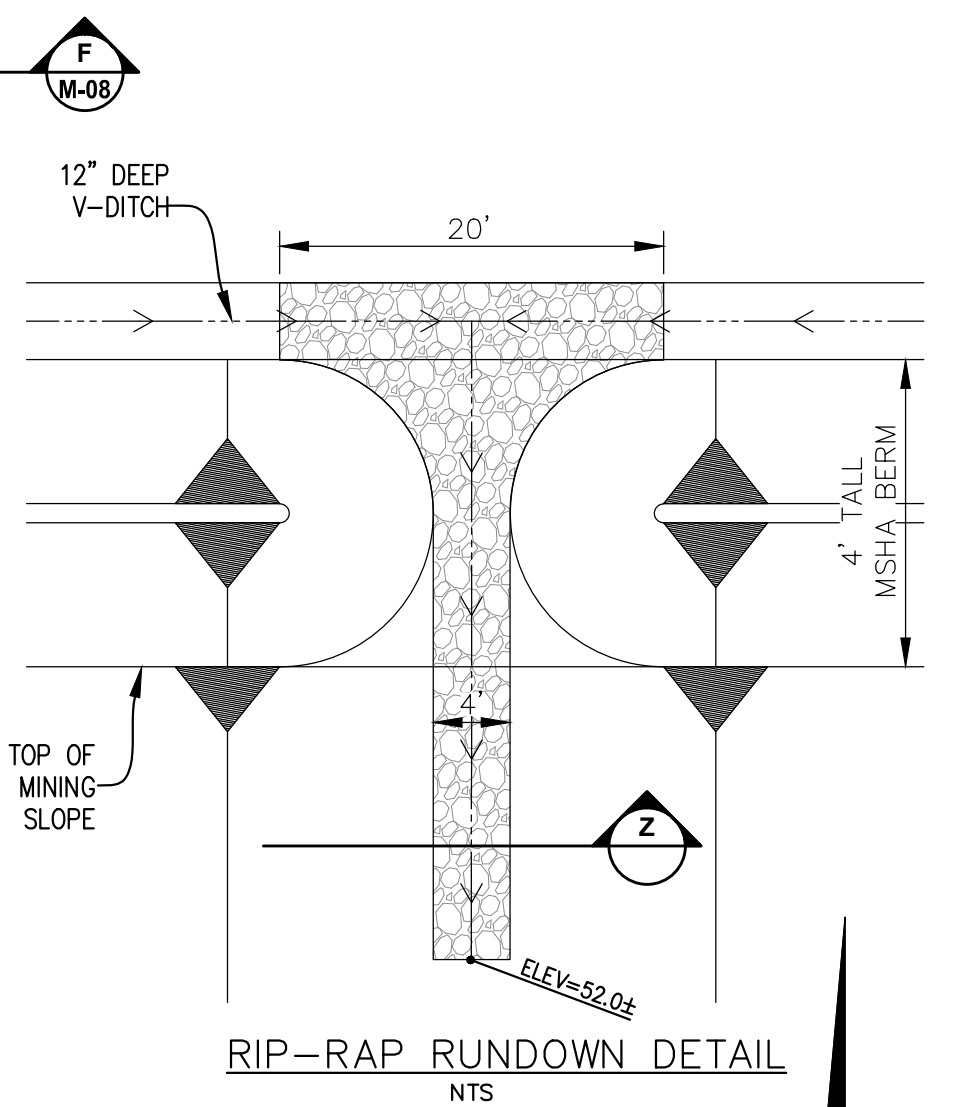
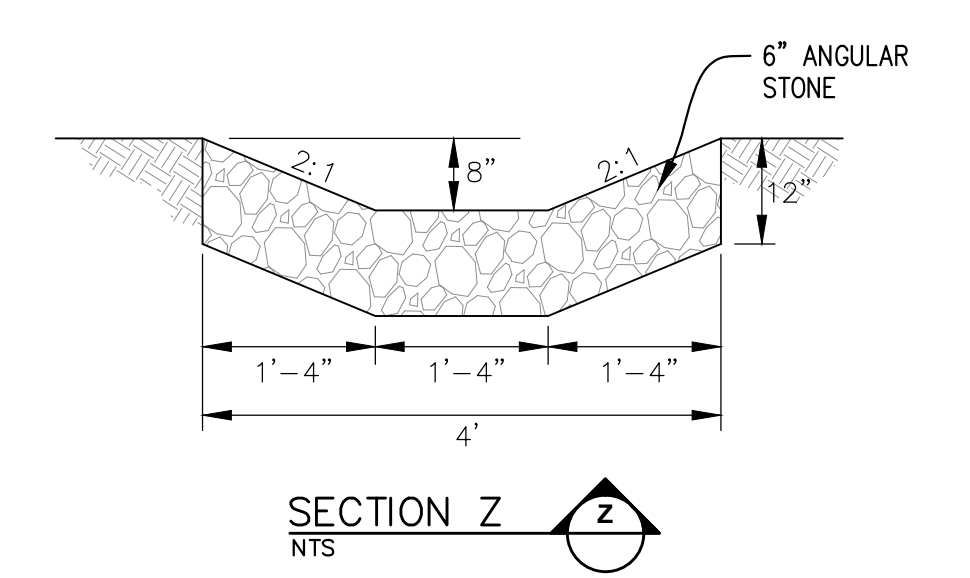

DESIGNED BY	NC	NO.	DATE	REVISIONS	BY	APPD.
DRAWN BY	NC/LR					
CHECKED BY	SG					
SCALE	AS SHOWN					

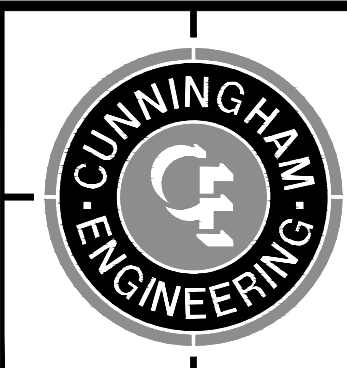
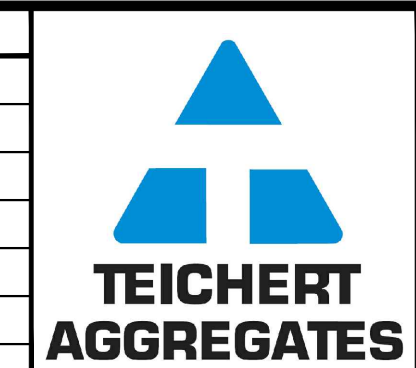

CECWEST.COM  
 Project Planning ■ Civil Engineering ■ Landscape Architecture  
 ■ Sacramento Office ■ Davis Office  
 2120 20th Street, Suite Three Sacramento, CA 95818 (916) 455-2026  
 2940 Spafford Street, Suite 200 Davis, CA 95618 (530) 758-2026

**SHIFLER MINING PLAN**  
**SITE PLAN**

SHEET  
**M-02**  
 OF  
**9**  
 DATE: 02/11/16  
 JOB NO: 1129.20

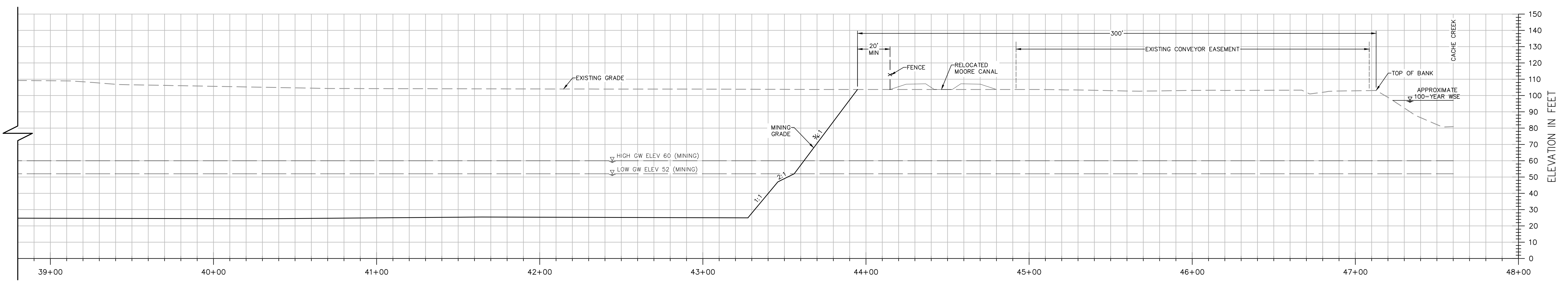
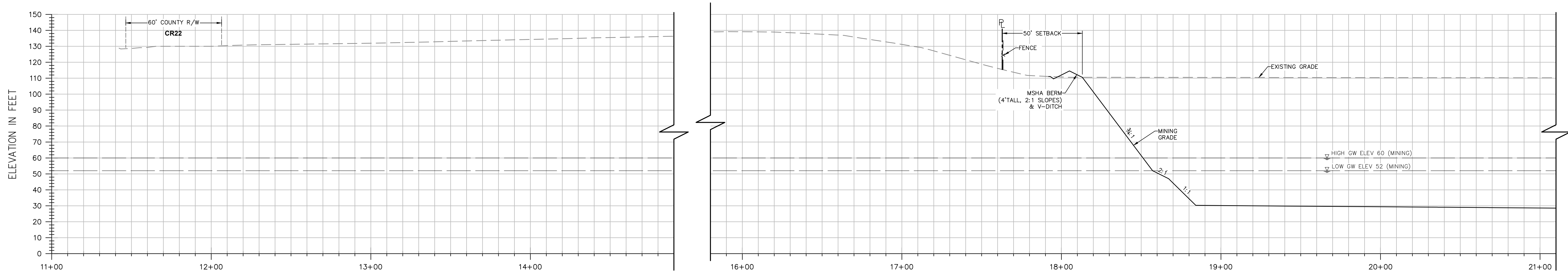

**SECTION A-A**

H: 1"=30'  
V: 1"=30'

**NOTES:**

- ELEVATIONS AND DISTANCES ARE APPROXIMATE. EXISTING GROUND IS BASED ON AERIAL TOPOGRAPHY FLOWN IN APRIL 2010 BY POINT CO. PHOTOGRAMMETRIC SERVICES.
- HIGH AND LOW AVERAGE GROUNDWATER ELEVATIONS BASED ON "GROUNDWATER CONDITIONS IN THE VICINITY OF PLANNED WETPIT MINING OPERATIONS, SHIFLER PROPERTY" AND "CONTOURS OF PREDICTED GROUNDWATER ELEVATION, AVERAGE FALL LOW, POST-RECLAMATION", BOTH BY LUHDORFF & SCALMANINI CONSULTING ENGINEERS DATED DECEMBER 22, 2015, UPDATED FEBRUARY 2016.
- BERMS OR V-DITCHES TO BE ADDED ALONG THE TOP OF SLOPES AS NECESSARY TO KEEP SURFACE RUNOFF FROM ADJACENT AREAS FROM ENTERING INTO THE DESIGNATED OPEN WATER AREAS.
- BOTTOM MINING ELEVATIONS ARE ±10' DEPENDING ON ACTUAL BOTTOM OF GRAVEL DEPTHS.

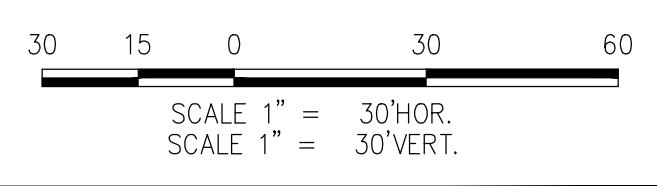

DESIGNED BY	NC	NO.	DATE	REVISIONS	BY	APPD.
DRAWN BY	NC/LR					
CHECKED BY	SG					
SCALE	AS SHOWN					



**CUNNINGHAM ENGINEERING**  
 Project Planning • Civil Engineering • Landscape Architecture  
 Sacramento Office: 2120 20th Street, Suite Three, Sacramento, CA 95818 (916) 455-2026  
 Davis Office: 2940 Spafford Street, Suite 200, Davis, CA 95618 (530) 758-2026  
 CECWEST.COM

**SHIFLER MINING PLAN**  
**CROSS SECTION A-A**

SHEET **M-03** OF **9**  
 DATE: 02/11/16  
 JOB NO: 1129.20

YOLO COUNTY

CALIFORNIA

S:\Projects\11029\1129 - Teichert - Aggregates\1129-20 - SHIFLER MINING PLAN\1129-20 - SHIFLER MINING PLAN - 02/11/16.dwg - 10:28AM - Printed by: User

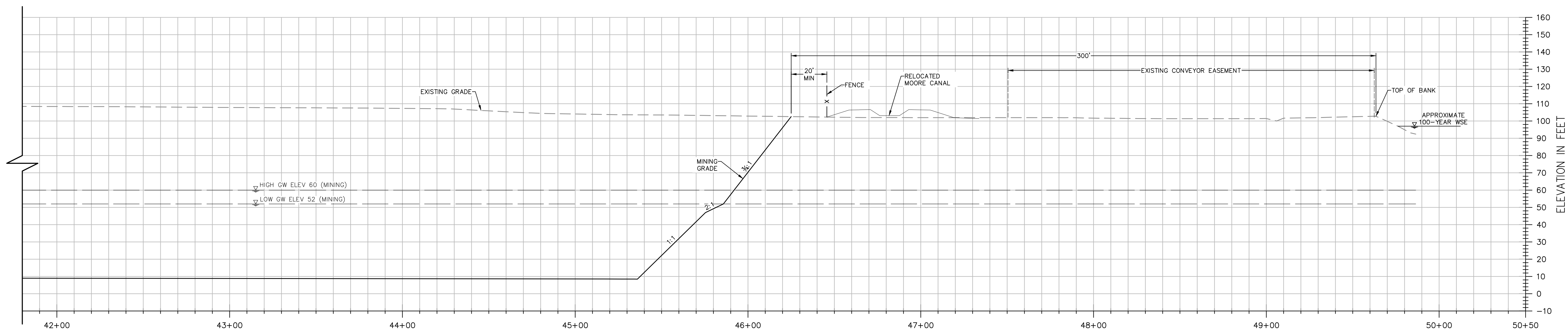
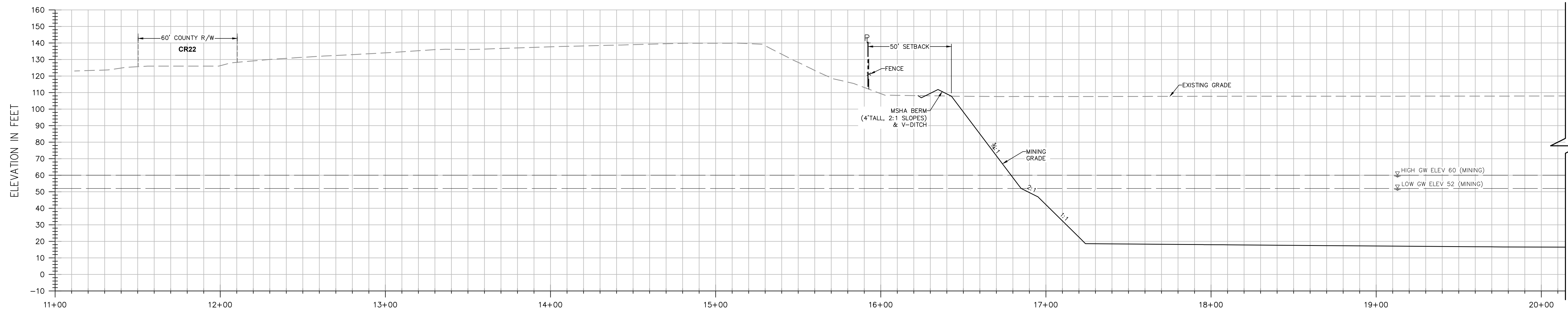

**SECTION B-B**

H: 1"=30'  
V: 1"=30'

**NOTES:**

- ELEVATIONS AND DISTANCES ARE APPROXIMATE. EXISTING GROUND IS BASED ON AERIAL TOPOGRAPHY FLOWN IN APRIL 2010 BY POINT CO. PHOTOGRAMMETRIC SERVICES.
- HIGH AND LOW AVERAGE GROUNDWATER ELEVATIONS BASED ON "GROUNDWATER CONDITIONS IN THE VICINITY OF PLANNED WETPIT MINING OPERATIONS, SHIFLER PROPERTY" AND "CONTOURS OF PREDICTED GROUNDWATER ELEVATION, AVERAGE FALL LOW, POST-RECLAMATION", BOTH BY LUHDORFF & SCALMANINI CONSULTING ENGINEERS DATED DECEMBER 22, 2015, UPDATED FEBRUARY 2016.
- BERMS OR V-DITCHES TO BE ADDED ALONG THE TOP OF SLOPES AS NECESSARY TO KEEP SURFACE RUNOFF FROM ADJACENT AREAS FROM ENTERING INTO THE DESIGNATED OPEN WATER AREAS.
- BOTTOM MINING ELEVATIONS ARE ±10' DEPENDING ON ACTUAL BOTTOM OF GRAVEL DEPTHS.

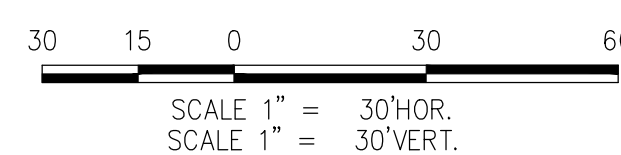

DESIGNED BY	NC	NO.	DATE	REVISIONS	BY	APPD.
DRAWN BY	NC/LR					
CHECKED BY	SG					
SCALE	AS SHOWN					

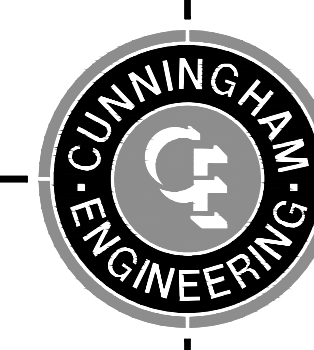

CECWEST.COM  
Project Planning ■ Civil Engineering ■ Landscape Architecture  
Sacramento Office: 2120 20th Street, Suite Three, Sacramento, CA 95818 (916) 455-2026  
Davis Office: 2940 Spafford Street, Suite 200, Davis, CA 95618 (530) 758-2026

**SHIFLER MINING PLAN**  
**CROSS SECTION B-B**

SHEET  
**M-04**  
OF  
**9**  
DATE: 02/11/16  
JOB NO: 1129.20

YOLO COUNTY

CALIFORNIA

S:\Projects\1102\1129 - Teichert Aggregates\1129-20 - SHIFLER MINING AND RECLAMATION PLAN\SHEETS\1129-20-MIN-104-ASCE-B.dwg - ASCE.B 7/27/2016 10:28AM Printed by: user

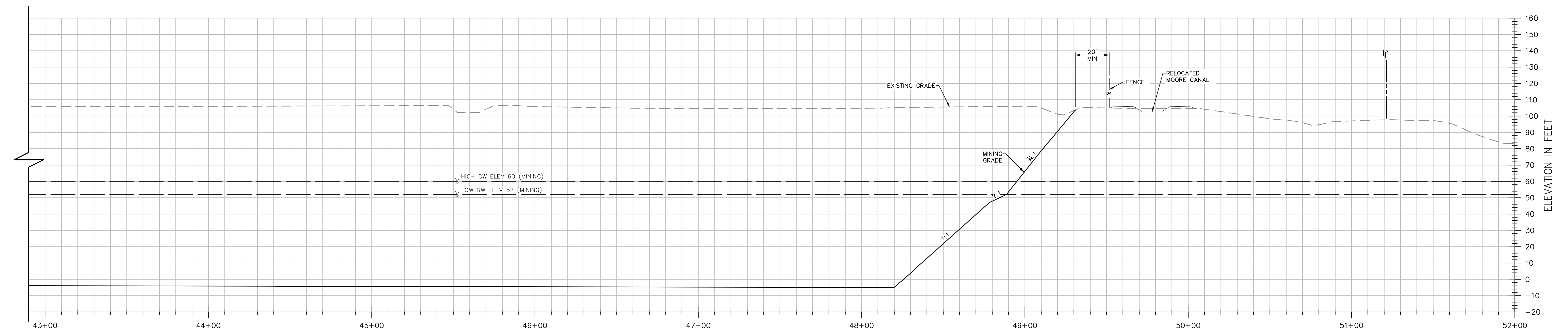
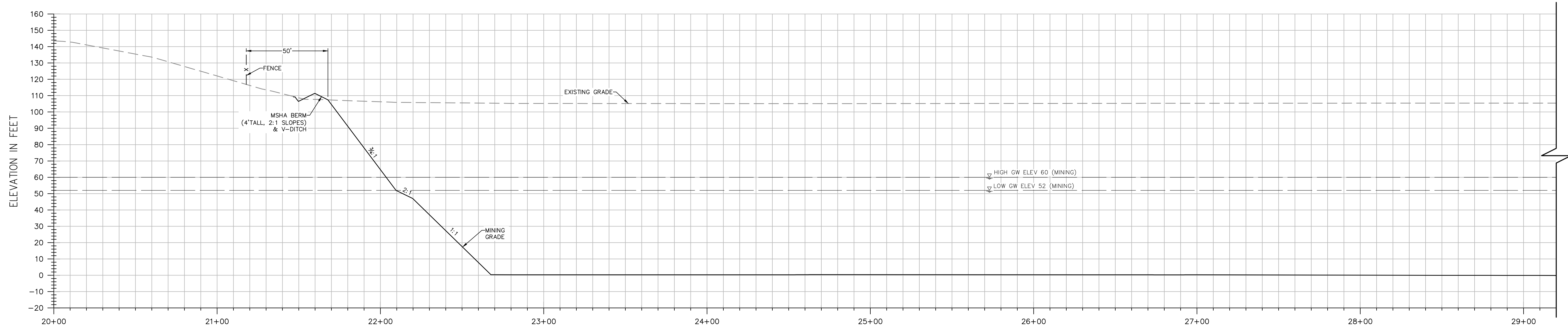

**SECTION C-C**

H: 1"=30'  
V: 1"=30'

**NOTES:**

- ELEVATIONS AND DISTANCES ARE APPROXIMATE. EXISTING GROUND IS BASED ON AERIAL TOPOGRAPHY FLOWN IN APRIL 2010 BY POINT CO. PHOTOGRAMMETRIC SERVICES.
- HIGH AND LOW AVERAGE GROUNDWATER ELEVATIONS BASED ON "GROUNDWATER CONDITIONS IN THE VICINITY OF PLANNED WETPIT MINING OPERATIONS, SHIFLER PROPERTY" AND "CONTOURS OF PREDICTED GROUNDWATER ELEVATION, AVERAGE FALL LOW, POST-RECLAMATION", BOTH BY LUHDORFF & SCALMANINI CONSULTING ENGINEERS DATED DECEMBER 22, 2015, UPDATED FEBRUARY 2016.
- BERMS OR V-DITCHES TO BE ADDED ALONG THE TOP OF SLOPES AS NECESSARY TO KEEP SURFACE RUNOFF FROM ADJACENT AREAS FROM ENTERING INTO THE DESIGNATED OPEN WATER AREAS.
- BOTTOM MINING ELEVATIONS ARE ±10' DEPENDING ON ACTUAL BOTTOM OF GRAVEL DEPTHS.

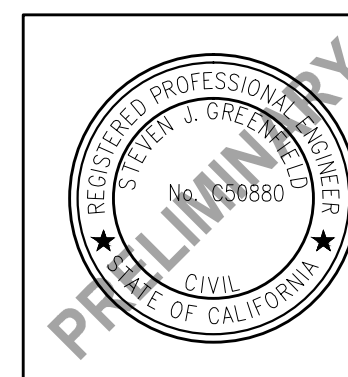
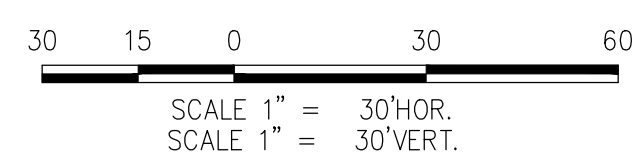

DESIGNED BY	NC	NO.	DATE	REVISIONS	BY	APPD.
DRAWN BY	NC/LR					
CHECKED BY	SG					
SCALE	AS SHOWN					

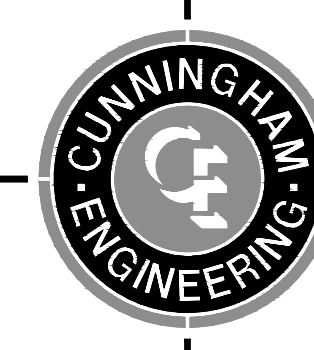

CECWEST.COM  
Project Planning ■ Civil Engineering ■ Landscape Architecture  
Sacramento Office: 2120 20th Street, Suite Three, Sacramento, CA 95818 (916) 455-2026  
Davis Office: 2940 Spafford Street, Suite 200, Davis, CA 95618 (530) 758-2026

YOLO COUNTY

**SHIFLER MINING PLAN**  
**CROSS SECTION C-C**

SHEET  
**M-05**  
OF  
**9**

DATE: 02/11/16

CALIFORNIA JOB NO: 1129.20

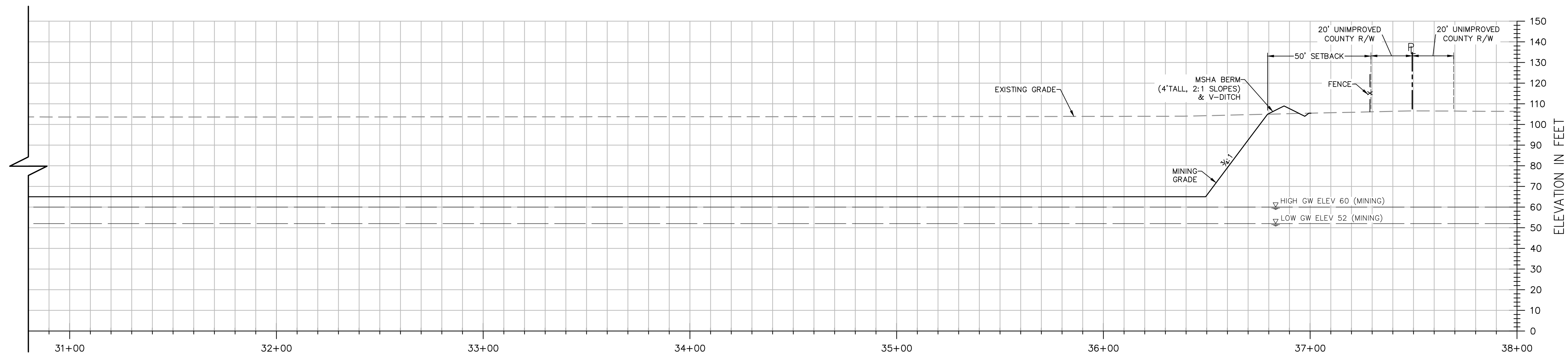
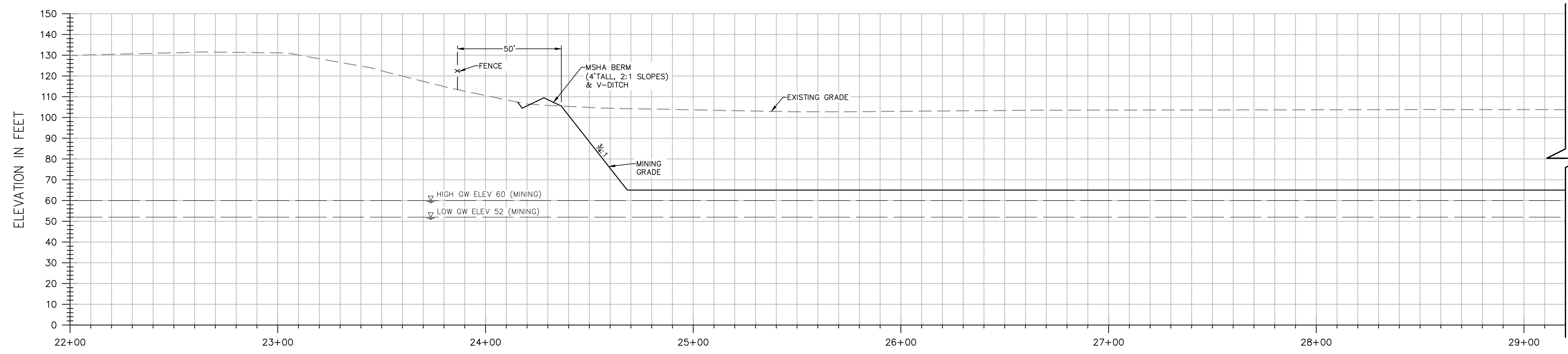

**SECTION D-D**

H: 1"=30'  
V: 1"=30'

**NOTES:**

- ELEVATIONS AND DISTANCES ARE APPROXIMATE. EXISTING GROUND IS BASED ON AERIAL TOPOGRAPHY FLOWN IN APRIL 2010 BY POINT CO. PHOTOGRAMMETRIC SERVICES.
- HIGH AND LOW AVERAGE GROUNDWATER ELEVATIONS BASED ON "GROUNDWATER CONDITIONS IN THE VICINITY OF PLANNED WETPIT MINING OPERATIONS, SHIFLER PROPERTY" AND "CONTOURS OF PREDICTED GROUNDWATER ELEVATION, AVERAGE FALL LOW, POST-RECLAMATION", BOTH BY LUHDORFF & SCALMANINI CONSULTING ENGINEERS DATED DECEMBER 22, 2015, UPDATED FEBRUARY 2016.
- BERMS OR V-DITCHES TO BE ADDED ALONG THE TOP OF SLOPES AS NECESSARY TO KEEP SURFACE RUNOFF FROM ADJACENT AREAS FROM ENTERING INTO THE DESIGNATED OPEN WATER AREAS.
- BOTTOM MINING ELEVATIONS ARE ±10' DEPENDING ON ACTUAL BOTTOM OF GRAVEL DEPTHS.

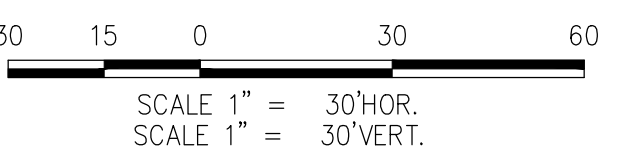

DESIGNED BY	NC	NO.	DATE	REVISIONS	BY	APPD.
DRAWN BY	NC/LR					
CHECKED BY	SG					
SCALE	AS SHOWN					



**CECWEST.COM**  
Project Planning ■ Civil Engineering ■ Landscape Architecture

■ Sacramento Office ■ Davis Office  
2120 20th Street, Suite Three 2940 Spafford Street, Suite 200  
Sacramento, CA 95818 Davis, CA 95618  
(916) 455-2026 (530) 758-2026

**SHIFLER MINING PLAN**  
**CROSS SECTION D-D**

YOLO COUNTY CALIFORNIA

SHEET  
**M-06**  
OF  
**9**  
DATE: 02/11/16  
JOB NO: 1129.20

S:\Projects\1102\1129 - Teichert - Aggregates\1129-D-D - SHIFLER MINING PLAN\1129-D-D - SHIFLER MINING PLAN - 02/11/16.dwg - ASCEC.D - 7/25/2016 10:23AM Printed by: user

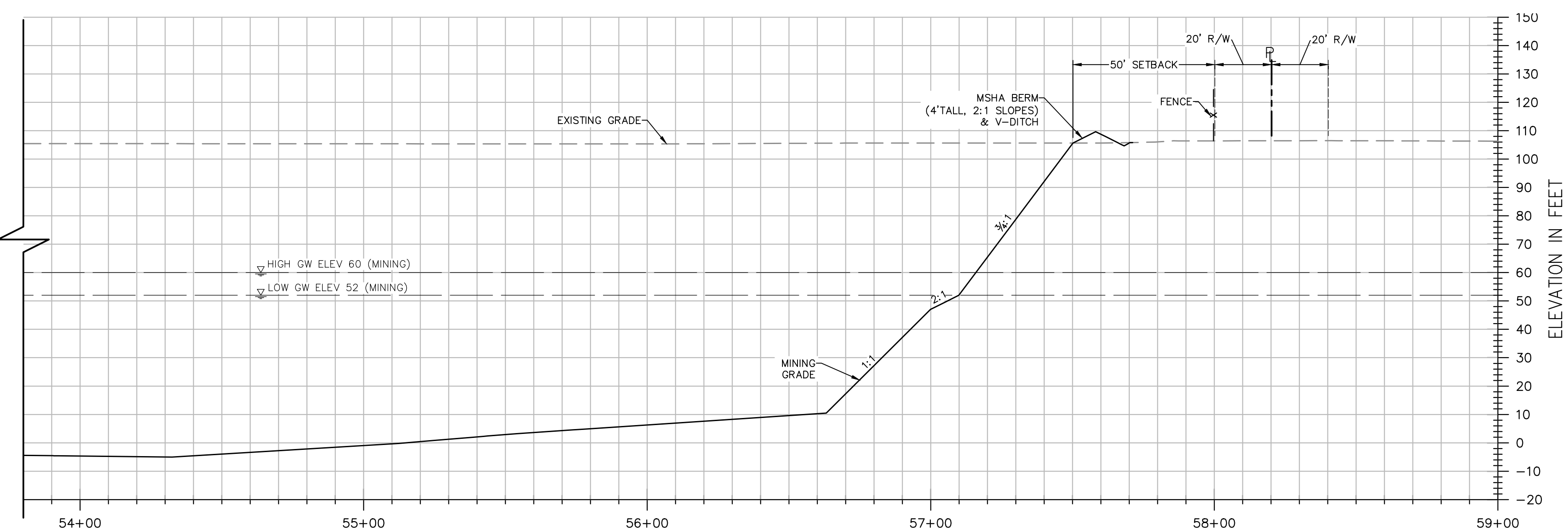
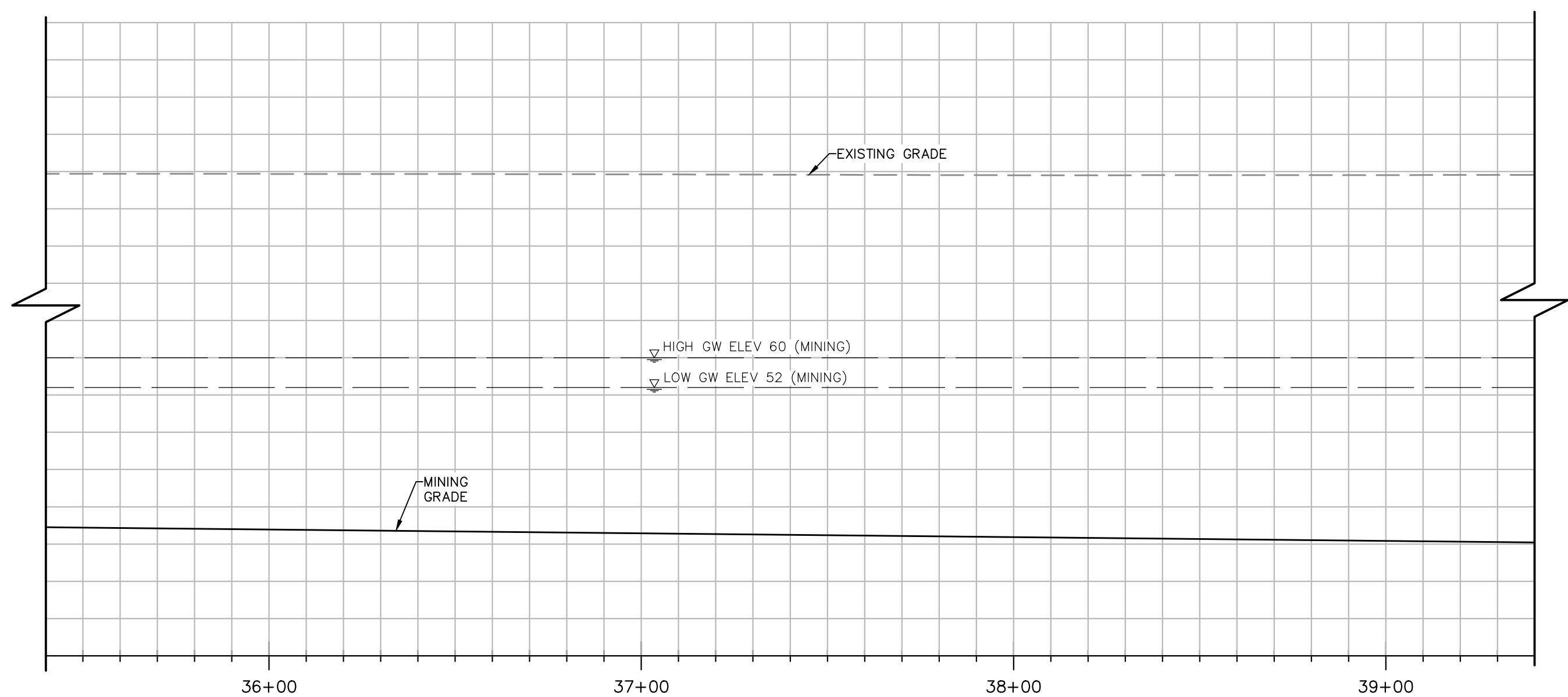
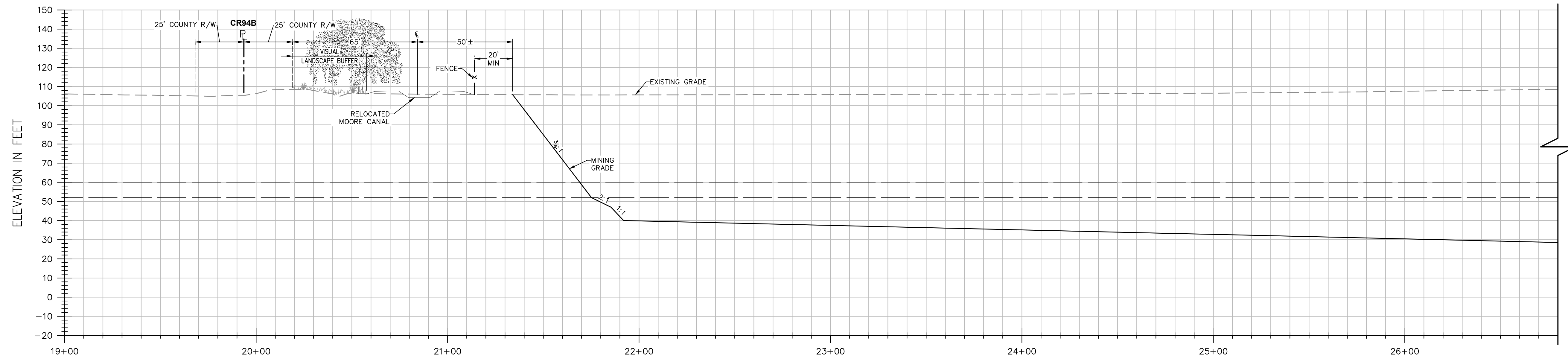

**SECTION E-E**

H: 1"=30'  
V: 1"=30'

**NOTES:**

- ELEVATIONS AND DISTANCES ARE APPROXIMATE. EXISTING GROUND IS BASED ON AERIAL TOPOGRAPHY FLOWN IN APRIL 2010 BY POINT CO. PHOTOGRAMMETRIC SERVICES.
- HIGH AND LOW AVERAGE GROUNDWATER ELEVATIONS BASED ON "GROUNDWATER CONDITIONS IN THE VICINITY OF PLANNED WETPIT MINING OPERATIONS, SHIFLER PROPERTY" AND "CONTOURS OF PREDICTED GROUNDWATER ELEVATION, AVERAGE FALL LOW, POST-RECLAMATION", BOTH BY LUHDORFF & SCALMANINI CONSULTING ENGINEERS DATED DECEMBER 22, 2015, UPDATED FEBRUARY 2016.
- BERMS OR V-DITCHES TO BE ADDED ALONG THE TOP OF SLOPES AS NECESSARY TO KEEP SURFACE RUNOFF FROM ADJACENT AREAS FROM ENTERING INTO THE DESIGNATED OPEN WATER AREAS.
- BOTTOM MINING ELEVATIONS ARE ±10' DEPENDING ON ACTUAL BOTTOM OF GRAVEL DEPTHS.

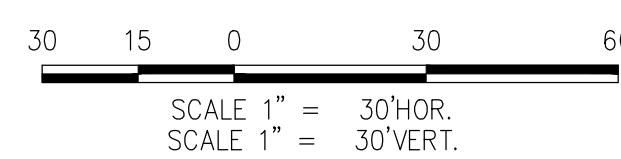

DESIGNED BY	NC	NO.	DATE	REVISIONS	BY	APPD.
DRAWN BY	NC/LR					
CHECKED BY	SG					
SCALE	AS SHOWN					

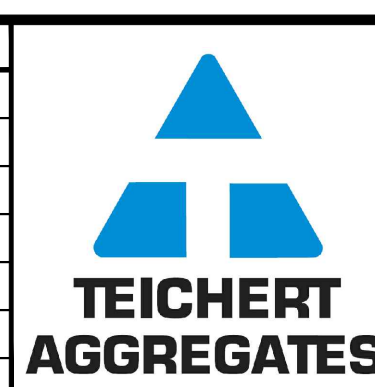

**CUNNINGHAM ENGINEERING**

CECWEST.COM

Project Planning • Civil Engineering • Landscape Architecture

■ Sacramento Office ■ Davis Office  
2120 20th Street, Suite Three 2940 Spafford Street, Suite 200  
Sacramento, CA 95818 Davis, CA 95618  
(916) 455-2026 (530) 758-2026

**SHIFLER MINING PLAN**

**CROSS SECTION E-E**

YOLO COUNTY CALIFORNIA

SHEET	M-07
OF	9
DATE:	02/11/16
JOB NO:	1129.20

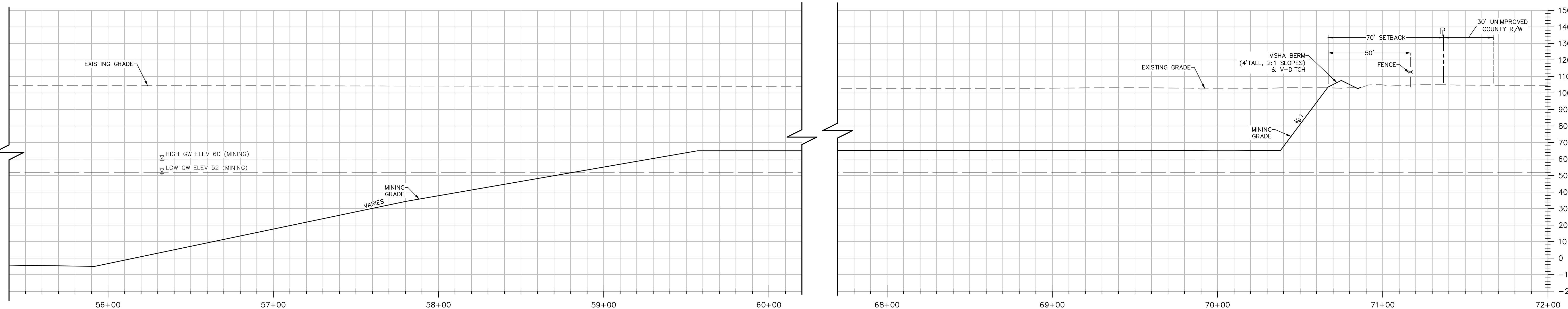
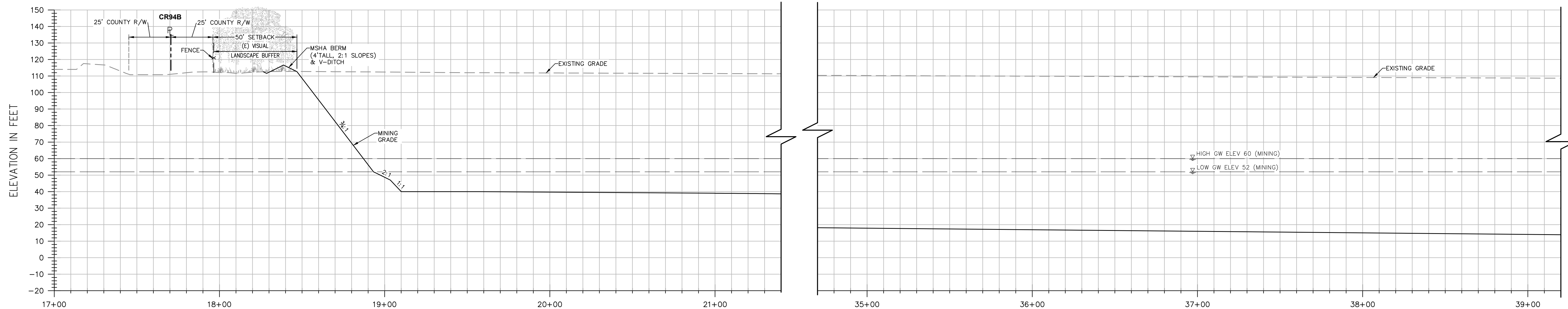

**SECTION F-F**

H: 1"=30'  
 V: 1"=30'

**NOTES:**

- ELEVATIONS AND DISTANCES ARE APPROXIMATE. EXISTING GROUND IS BASED ON AERIAL TOPOGRAPHY FLOWN IN APRIL 2010 BY POINT CO. PHOTOGRAMMETRIC SERVICES.
- HIGH AND LOW AVERAGE GROUNDWATER ELEVATIONS BASED ON "GROUNDWATER CONDITIONS IN THE VICINITY OF PLANNED WETPIT MINING OPERATIONS, SHIFLER PROPERTY" AND "CONTOURS OF PREDICTED GROUNDWATER ELEVATION, AVERAGE FALL LOW, POST-RECLAMATION", BOTH BY LUHDORFF & SCALMANINI CONSULTING ENGINEERS DATED DECEMBER 22, 2015, UPDATED FEBRUARY 2016.
- BERMS OR V-DITCHES TO BE ADDED ALONG THE TOP OF SLOPES AS NECESSARY TO KEEP SURFACE RUNOFF FROM ADJACENT AREAS FROM ENTERING INTO THE DESIGNATED OPEN WATER AREAS.
- BOTTOM MINING ELEVATIONS ARE ±10' DEPENDING ON ACTUAL BOTTOM OF GRAVEL DEPTHS.

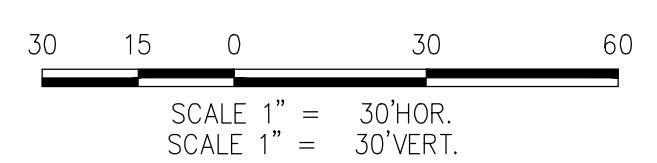

	DESIGNED BY	NC	NO.	DATE	REVISIONS	BY	APPD.			CECWEST.COM <i>Project Planning • Civil Engineering • Landscape Architecture</i> ■ Sacramento Office ■ Davis Office 2120 20th Street, Suite Three Sacramento, CA 95818 (916) 455-2026 2940 Spafford Street, Suite 200 Davis, CA 95618 (530) 758-2026	<p align="center"><b>SHIFLER MINING PLAN</b></p> <hr/> <p align="center"><b>CROSS SECTION F-F</b></p>	SHEET <b>M-08</b> OF <b>9</b>	
	DRAWN BY	NC/LR										DATE:	02/11/16
	CHECKED BY	SG											JOB NO:
SCALE		AS SHOWN											

YOLO COUNTY CALIFORNIA



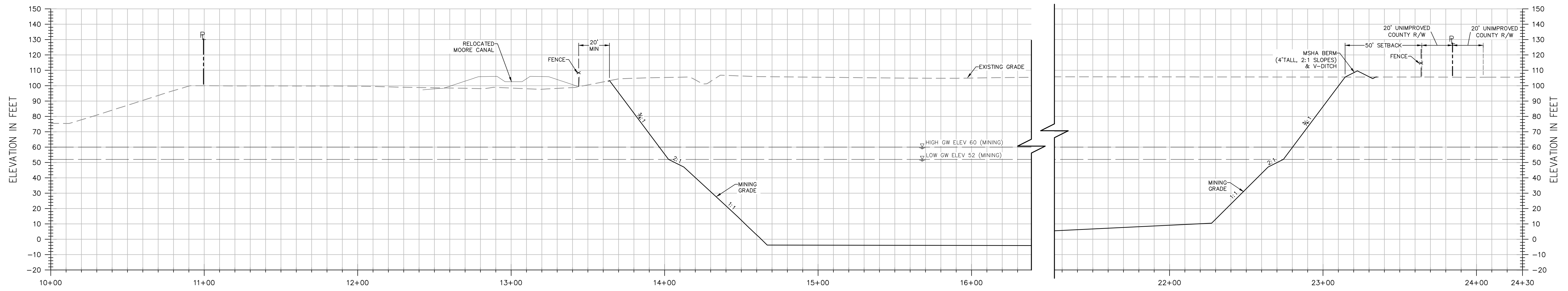

**SECTION G-G**

H: 1"=30'  
V: 1"=30'

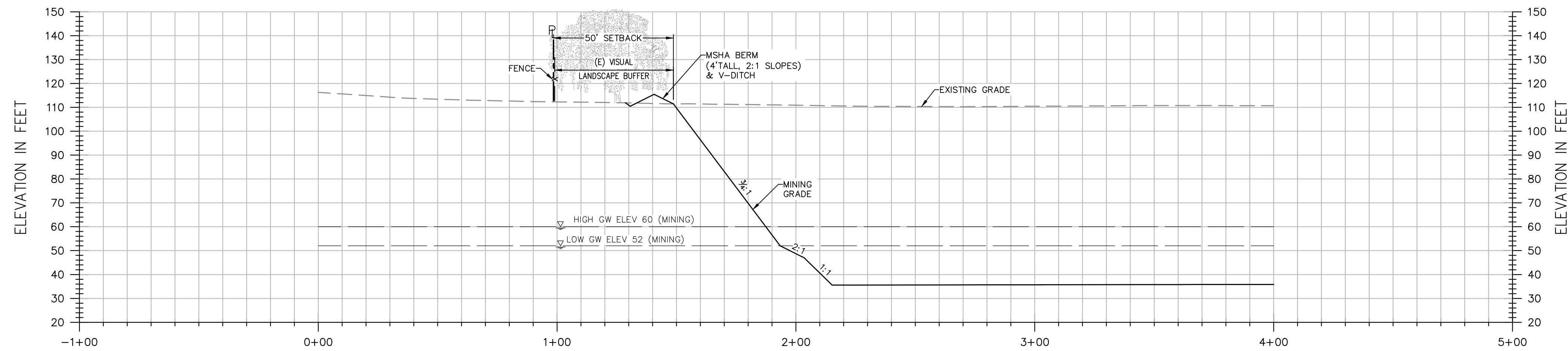

**SECTION H-H**

H: 1"=30'  
V: 1"=30'

**NOTES:**

- ELEVATIONS AND DISTANCES ARE APPROXIMATE. EXISTING GROUND IS BASED ON AERIAL TOPOGRAPHY FLOWN IN APRIL 2010 BY POINT CO. PHOTOGRAMMETRIC SERVICES.
- HIGH AND LOW AVERAGE GROUNDWATER ELEVATIONS BASED ON "GROUNDWATER CONDITIONS IN THE VICINITY OF PLANNED WETPIT MINING OPERATIONS, SHIFLER PROPERTY" AND "CONTOURS OF PREDICTED GROUNDWATER ELEVATION, AVERAGE FALL LOW, POST-RECLAMATION", BOTH BY LUHDORFF & SCALMANINI CONSULTING ENGINEERS DATED DECEMBER 22, 2015, UPDATED FEBRUARY 2016.
- BERMS OR V-DITCHES TO BE ADDED ALONG THE TOP OF SLOPES AS NECESSARY TO KEEP SURFACE RUNOFF FROM ADJACENT AREAS FROM ENTERING INTO THE DESIGNATED OPEN WATER AREAS.
- BOTTOM MINING ELEVATIONS ARE ±10' DEPENDING ON ACTUAL BOTTOM OF GRAVEL DEPTHS.

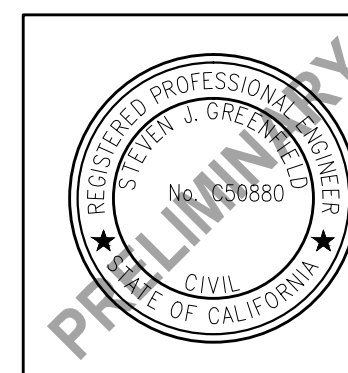
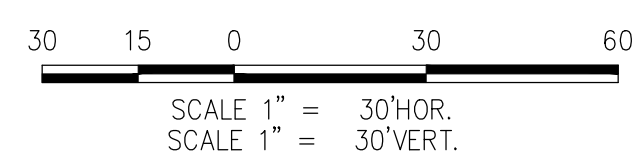

DESIGNED BY	NC	NO.	DATE	REVISIONS	BY	APPD.
DRAWN BY	NC/LR					
CHECKED BY	SG					
SCALE	AS SHOWN					

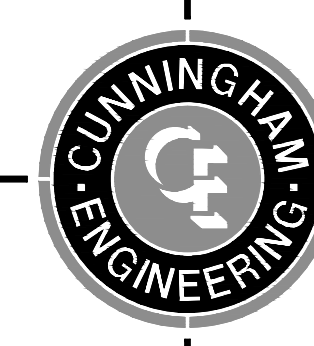

CECWEST.COM  
Project Planning • Civil Engineering • Landscape Architecture  
Sacramento Office: 2120 20th Street, Suite Three, Sacramento, CA 95818, (916) 455-2026  
Davis Office: 2940 Spafford Street, Suite 200, Davis, CA 95618, (530) 758-2026

**SHIFLER MINING PLAN**  
**CROSS SECTION G-G & H-H**

SHEET  
**M-09**  
OF  
**9**  
DATE: 02/11/16  
JOB NO: 1129.20