

CONCEPTUAL OFF-CHANNEL RECLAMATION PLAN FOR SHIFLER PROPERTY

YOLO COUNTY, CALIFORNIA
FEBRUARY 2016

GENERAL NOTES:

- ALL WORK SHALL CONFORM TO THE YOLO COUNTY SURFACE MINING RECLAMATION ORDINANCE (ORD. #1191), THE PROJECT SPECIFIC CONDITIONS OF APPROVAL, THE PROJECT STORM WATER POLLUTION PREVENTION PLAN (SWPPP), THE SURFACE MINING AND RECLAMATION ACT (SMARA), OSHA, MSHA, AND OTHER APPLICABLE LOCAL, STATE AND FEDERAL REGULATIONS.
- EXISTING TOPOGRAPHY BASED ON AERIAL TOPOGRAPHY FLOWN IN APRIL 2010 BY POINT CO. PHOTOGRAMMETRIC SERVICES; VERIFY EXISTING CONDITIONS PRIOR TO COMMENCING MINING.
- ANY WORK THAT NEEDS TO BE PERFORMED WITHIN PG&E'S OR ANY OTHER UTILITY COMPANY'S EASEMENT WILL REQUIRE A CONSENT AGREEMENT FROM THE APPROPRIATE UTILITY COMPANY. USE CAUTION WHEN OPERATING ANY VEHICLES OR EQUIPMENT NEAR OVERHEAD AND UNDERGROUND ELECTRIC FACILITIES. COMPLY WITH ALL CONDITIONS LISTED IN THE CONSENT AGREEMENT.
- THE DEPTH OF MINING AND THE LIMIT-OF-MINING LINES ARE ONLY APPROXIMATE, AND ARE SUBJECT TO CHANGE BASED ON THE AMOUNT AND QUALITY OF MATERIAL UNCOVERED, AND THE ABILITY OF THE PRODUCER TO MEET THE RECLAMATION REQUIREMENTS. THE FORESEEABLE ESTIMATE OF VARIATION IS +/- 10' IN MINING DEPTH; AND +/- 20% OF AREA FOR EACH TYPE OF RECLAMATION.
- HIGH AND LOW AVERAGE GROUNDWATER ELEVATIONS BASED ON "GROUNDWATER CONDITIONS IN THE VICINITY OF PLANNED WETPIT MINING OPERATIONS, SHIFLER PROPERTY" AND "CONTOURS OF PREDICTED GROUNDWATER ELEVATION, AVERAGE FALL LOW, POST-RECLAMATION", BY LUHDORFF & SCALMANINI CONSULTING ENGINEERS DATED DECEMBER 22, 2015, UPDATED FEBRUARY 2016.
- IF HUMAN SKELETAL REMAINS ARE ENCOUNTERED DURING EXCAVATION, ALL WORK WITHIN SEVENTY-FIVE (75) FEET SHALL IMMEDIATELY STOP, AND THE COUNTY CORONER SHALL BE NOTIFIED WITHIN TWENTY-FOUR (24) HOURS. IF ANY CULTURAL RESOURCES, SUCH AS CHIPPED OR GROUND STONE, HISTORIC DEBRIS, BUILDING FOUNDATIONS, OR PALEONTOLOGICAL MATERIALS ARE ENCOUNTERED DURING EXCAVATION, THEN ALL WORK WITHIN SEVENTY-FIVE (75) FEET SHALL IMMEDIATELY STOP AND THE DIRECTOR SHALL BE NOTIFIED AT ONCE. ANY CULTURAL RESOURCES FOUND ON THE SITE SHALL BE RECORDED BY A QUALIFIED ARCHAEOLOGIST AND THE INFORMATION SHALL BE SUBMITTED TO THE COUNTY.
- DURING OPERATIONS, THE SITE SHALL BE KEPT FREE OF DEBRIS AND MAINTAINED IN A NEAT AND ORDERLY MANNER SO AS NOT TO CREATE ANY HAZARDOUS OR UNSIGHTLY CONDITIONS. OVERBURDEN SHALL BE STOCKPILED AND STUMPS, BRUSH, OR OTHER DEBRIS RESULTING FROM EXCAVATION AND/OR PROCESSING SHALL BE PROPERLY DISPOSED.
- UNNECESSARY PERSONNEL SHALL BE EXCLUDED FROM OFF-CHANNEL EXCAVATIONS. OPEN PITS SHALL BE FENCED WITH A FOUR STRAND BARBED WIRE FENCE OR THE EQUIVALENT, PRIOR TO THE COMMENCEMENT OF EXCAVATION. FENCING MAY ENCLOSE THE PROPERTY OF WHICH THE MINING SITE IS A PART, THE MINING SITE, OR BOTH. IN ADDITION, SIGNS SHALL BE INSTALLED AT THE PROJECT SITE BOUNDARIES AND ACCESS ROAD, INDICATING THAT THE EXCAVATION AREA IS A DANGER ZONE.

ABBREVIATIONS:

AC	ACRES	IRR	IRRIGATION
AG	AGRICULTURAL	MSHA	MINE SAFETY AND HEALTH ADMINISTRATION
AGG	AGGREGATE	MW	MONITOR WELL
AMSL	ABOVE MEAN SEA LEVEL	N	NORTH
APN	ASSESSOR'S PARCEL NUMBER	N.I.C.	NOT IN CONTRACT
AVG	AVERAGE	OG	ORIGINAL GROUND ELEVATION
CFR	CODE OF FEDERAL REGULATIONS	OSHA	OCCUPATIONAL SAFETY AND HEALTH ADMINISTRATION
CL	CENTER LINE	PL	PROPERTY LINE
CY	CUBIC YARDS	R	RADIUS
E	EAST	R/W	RIGHT-OF-WAY
ELEV	ELEVATION	RECL.	RECLAMATION
FG	FINISH GRADE	S	SLOPE
FL	FLOW LINE	S&G	SAND AND GRAVEL
FT	FEET	TYP	TYPICAL
GB	GRADE BREAK	V	VERTICAL
GW	GROUND WATER	W	WEST
H	HORIZONTAL	YR	YEAR

LEGEND:

FOUND MONUMENTS AS SHOWN		EXISTING ELEV.	
POWER POLE		PROPOSED ELEV.	
EXISTING EDGE OF ROAD		HORIZONTAL TO VERTICAL SLOPE	
WATER		WATER SURFACE	
EXISTING GROUND CONTOUR		PROPERTY BOUNDARY	
PROPOSED CONTOUR		RIGHT-OF-WAY	
CROSS SECTION NUMBER AND SHEET LOCATION		EASEMENT	
APPROXIMATE YOLO COUNTY TEST 3 LINE		RECLAMATION HABITAT BOUNDARY	
APPROXIMATE 100YR WATER SURFACE LIMITS		FENCE	
TOP OF SLOPE			
BOTTOM OF SLOPE			

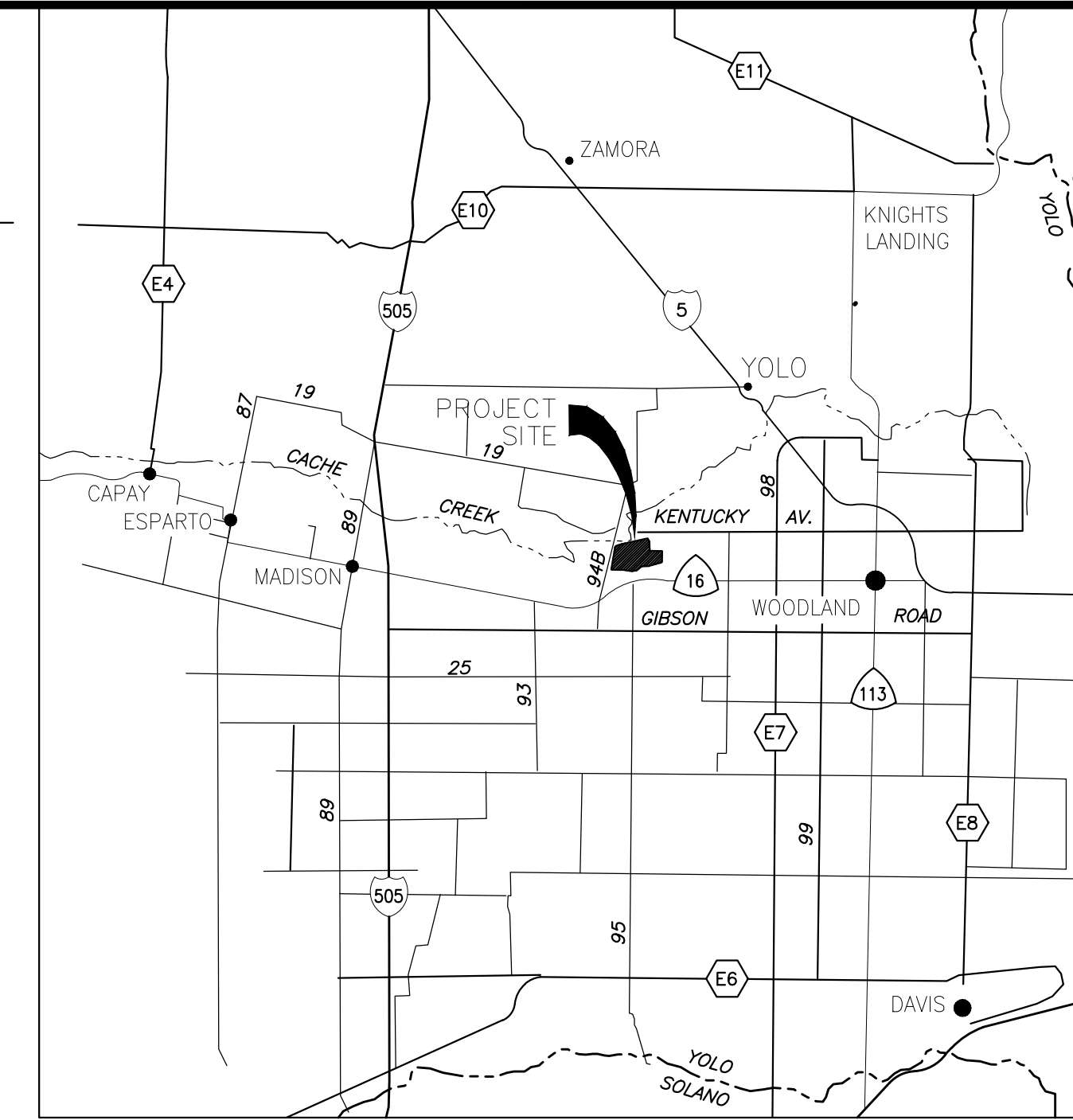
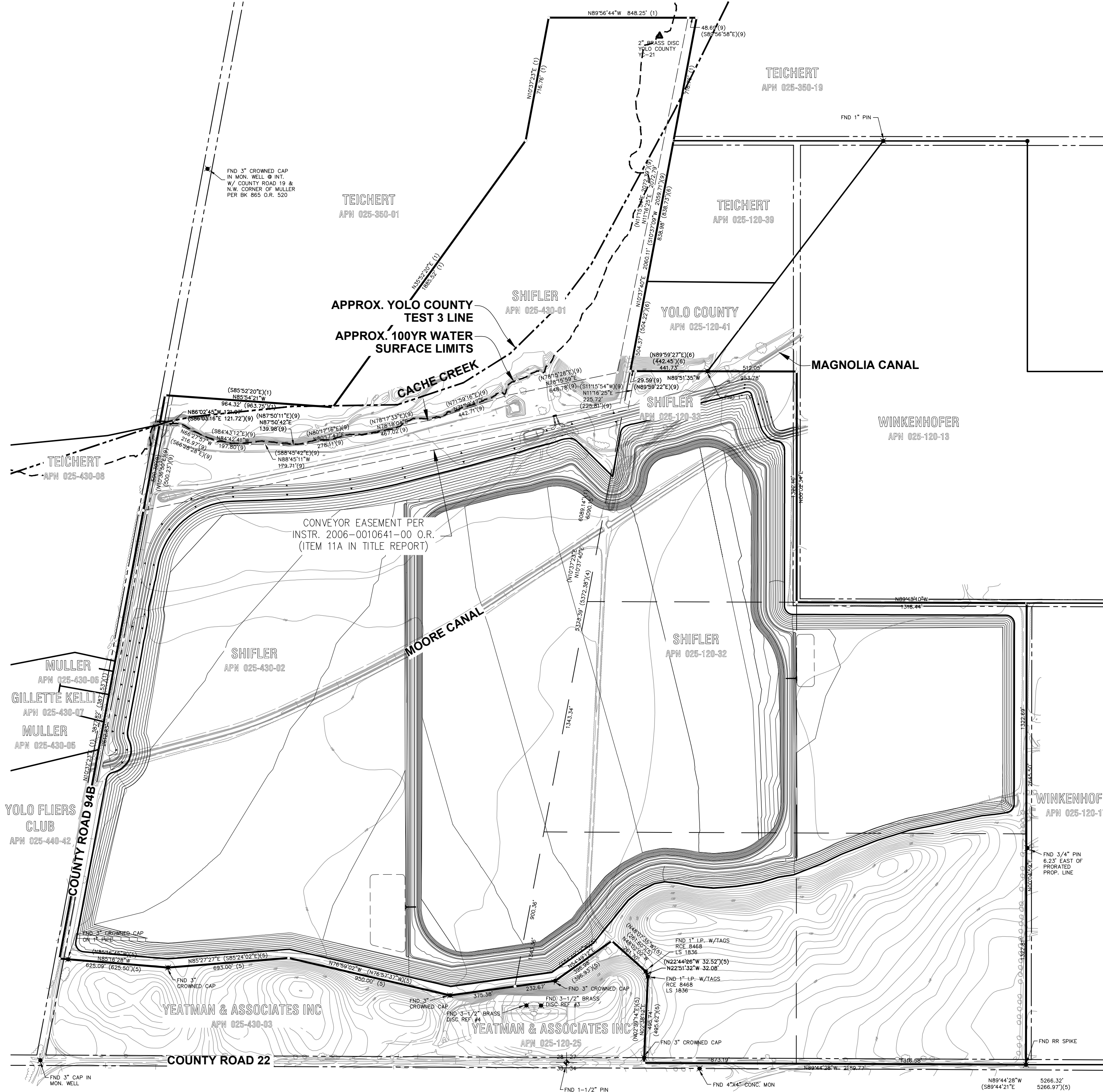

SHEET INDEX:

- R-01 TITLE SHEET
- R-02 SITE PLAN
- R-03 CROSS SECTION A-A
- R-04 CROSS SECTION B-B
- R-05 CROSS SECTION C-C
- R-06 CROSS SECTION D-D
- R-07 CROSS SECTION E-E
- R-08 CROSS SECTION F-F
- R-09 CROSS SECTION G-G & H-H

BENCHMARK:

EXISTING TOPOGRAPHY BASED ON AERIAL TOPOGRAPHY FLOWN IN APRIL 2010 BY POINT CO. PHOTOGRAMMETRIC SERVICES. AERIAL TARGETS SURVEYED BY LAUGENOUR AND MEIKLE, WOODLAND. HORIZONTAL DATUM: CA NAD83 ZONE 2 VERTICAL DATUM: NAVD 88

ASSESSORS PARCEL NO:

- 025-120-32
- 025-120-33
- 025-430-02
- 025-430-01

PROPERTY OWNER:

SHIFLER LJ FAMILY TRUST INC.
35030 COUNTY ROAD 20
WOODLAND, CA 95851

APPLICANT:

TEICHERT AGGREGATES
P.O. BOX 15002
SACRAMENTO, CA 95851
(916) 484-3319

CIVIL ENGINEER:

CUNNINGHAM ENGINEERING
2940 SPAFFORD STREET, SUITE 200
DAVIS, CALIFORNIA 95618
(530) 758-2026

DRAWING STATUS:

- PLAN REVIEW SET - NOT FOR CONSTRUCTION
- PERMIT SET



DESIGNED BY	NC	NO.	DATE	REVISIONS	BY	APPD.
DRAWN BY	NC/LR					
CHECKED BY	SG					
SCALE	AS SHOWN					



SHIFLER RECLAMATION PLAN
TITLE SHEET

SHEET
R-01
OF
9
DATE: 02/08/16
JOB NO: 1129.20

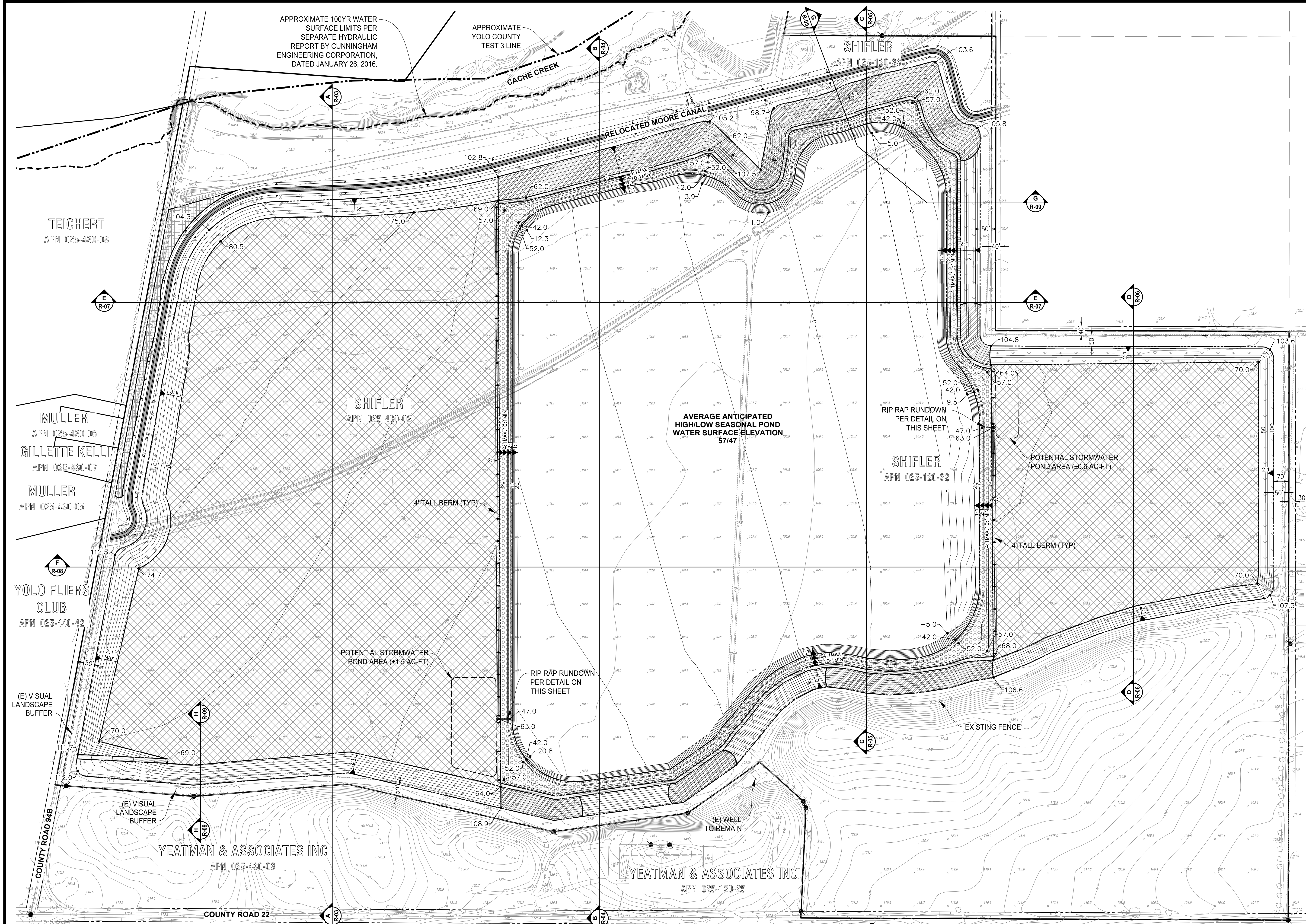

- NOTES:**
- ELEVATIONS AND DISTANCES ARE APPROXIMATE. EXISTING GROUND IS BASED ON AERIAL TOPOGRAPHY FLOWN IN APRIL 2010 BY POINT CO. PHOTOGRAMMETRIC SERVICES.
 - HIGH AND LOW AVERAGE GROUNDWATER ELEVATIONS BASED ON "GROUNDWATER CONDITIONS IN THE VICINITY OF PLANNED WETPIT MINING OPERATIONS, SHIFLER PROPERTY" AND "CONTOURS OF PREDICTED GROUNDWATER ELEVATION, AVERAGE FALL LOW, POST-RECLAMATION", BY LUHDORFF & SCALMANINI CONSULTING ENGINEERS DATED DECEMBER 22, 2015, UPDATED FEBRUARY 2016.
 - BOTTOM MINING ELEVATIONS ARE ±10' DEPENDING ON ACTUAL BOTTOM OF GRAVEL DEPTHS.
 - PROPOSED CONTOURS SHOWN AT 5' INTERVAL.
 - FOR DETAILS, SEE ACCOMPANYING RECLAMATION PLAN PREPARED BY TEICHERT AGGREGATES (AUGUST 2015).
 - WELLS TO BE ABANDONED, IF ANY, SHALL BE ABANDONED PER YOLO COUNTY DEPARTMENT OF ENVIRONMENTAL HEALTH STANDARDS.
 - AGRICULTURE ZONES TO HAVE MINIMUM OF 5' OF TOPSOIL AND SHALL BE A MINIMUM OF 5' ABOVE THE AVERAGE HIGH GROUNDWATER LEVEL.

- HABITAT ZONES:**
- SEASONAL POND (112.9 AC)
 - AGRICULTURE (116.7 AC)
 - UPPER RIPARIAN WOODLAND (10.9 AC)
 - LOWER RIPARIAN WOODLAND/WETLAND (13.0 AC)
 - GRASSLAND SLOPES (21.3 AC)
 - NATIVE LANDSCAPE (1.4 AC)
 - ACCESS ROAD (2.3 AC)

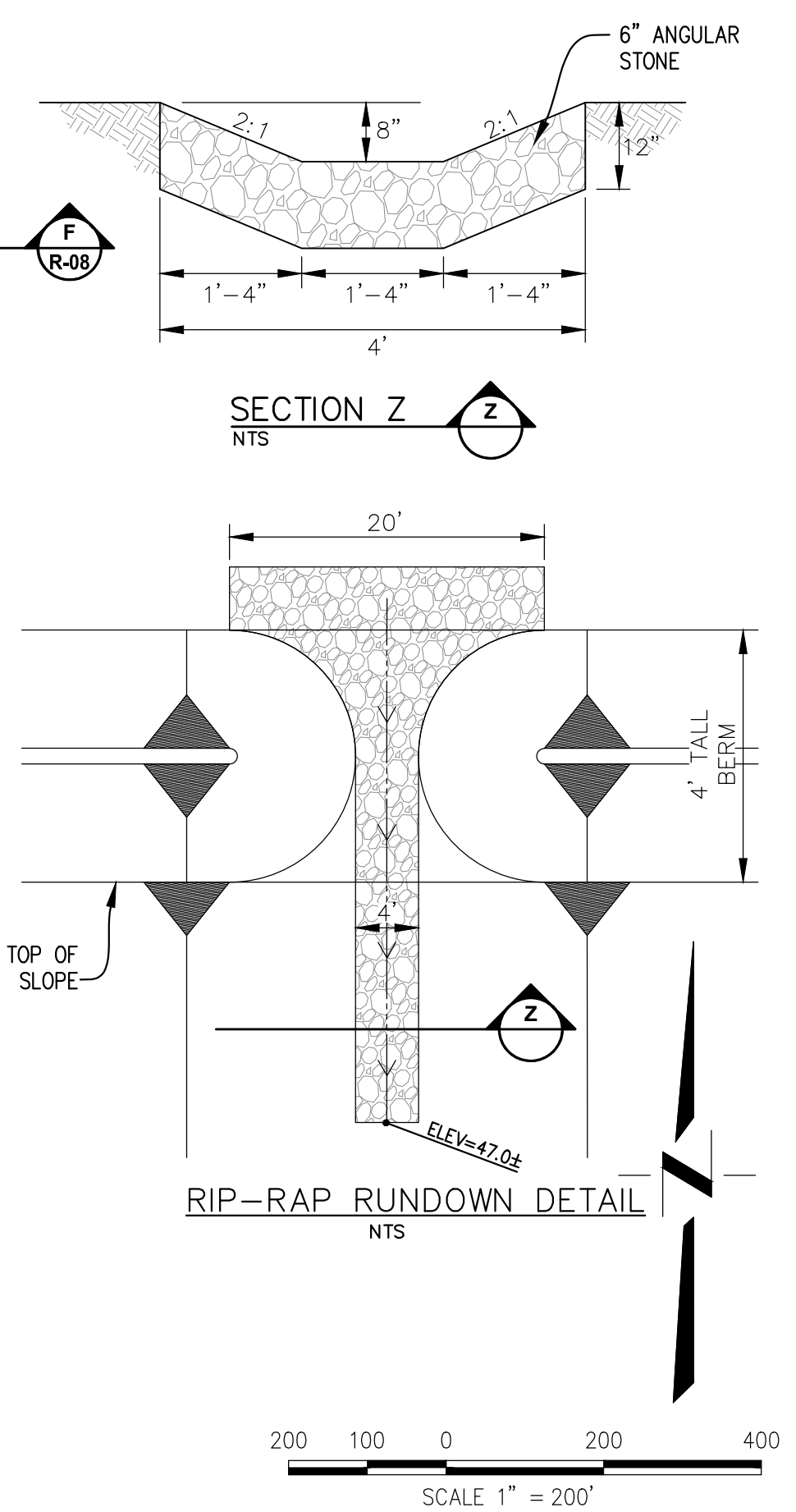

DESIGNED BY	NC	NO.	DATE	REVISIONS	BY	APPD.
DRAWN BY	NC/LR					
CHECKED BY	SG					
SCALE	AS SHOWN					

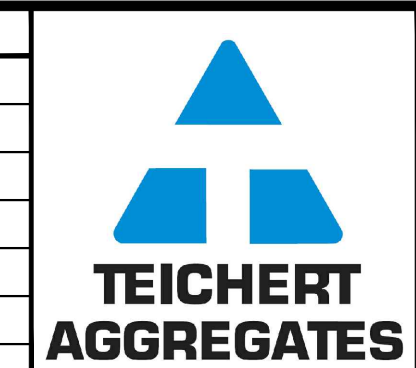

CUNNINGHAM ENGINEERING

Project Planning • Civil Engineering • Landscape Architecture

Sacramento Office: 2120 20th Street, Suite Three, Sacramento, CA 95818 (916) 455-2026

Davis Office: 2940 Spafford Street, Suite 200, Davis, CA 95618 (530) 758-2026

CECWEST.COM

SHIFLER RECLAMATION PLAN

SITE PLAN

SHEET **R-02** OF **9**

DATE: 02/08/16

YOLO COUNTY CALIFORNIA JOB NO: 1129.20

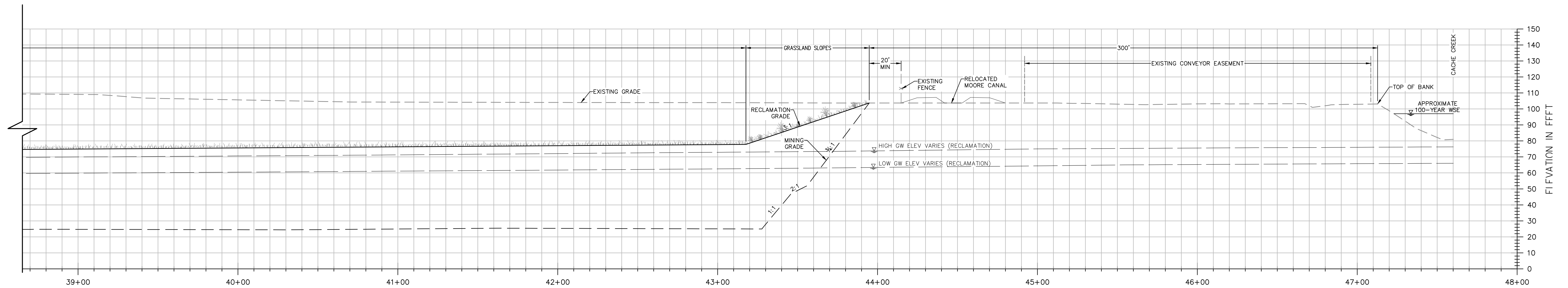
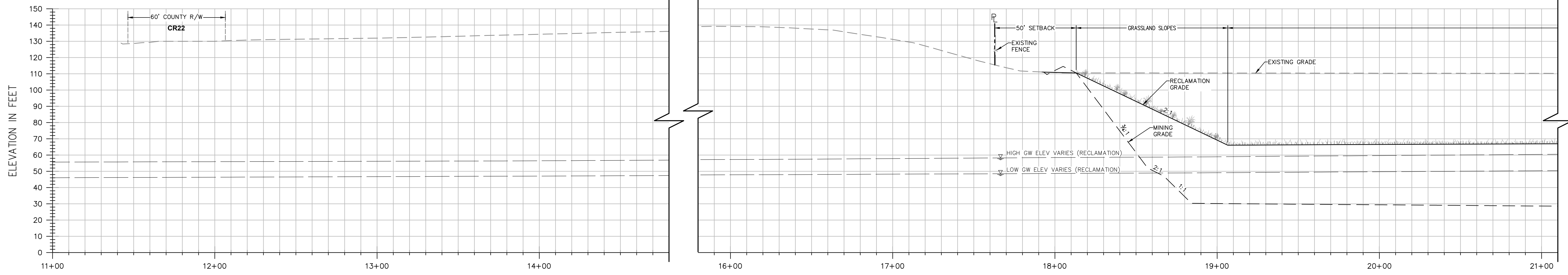

SECTION A-A

H: 1"=30'
V: 1"=30'

NOTES:

- ELEVATIONS AND DISTANCES ARE APPROXIMATE. EXISTING GROUND IS BASED ON AERIAL TOPOGRAPHY FLOWN IN APRIL 2010 BY POINT CO. PHOTOGRAMMETRIC SERVICES.
- HIGH AND LOW AVERAGE GROUNDWATER ELEVATIONS BASED ON "GROUNDWATER CONDITIONS IN THE VICINITY OF PLANNED WETPIT MINING OPERATIONS, SHIFLER PROPERTY" AND "CONTOURS OF PREDICTED GROUNDWATER ELEVATION, AVERAGE FALL LOW, POST-RECLAMATION", BOTH BY LUHDORFF & SCALMANINI CONSULTING ENGINEERS DATED DECEMBER 22, 2015, UPDATED FEBRUARY 2016.
- BERMS OR V-DITCHES TO BE ADDED ALONG THE TOP OF SLOPES AS NECESSARY TO KEEP SURFACE RUNOFF FROM ADJACENT AREAS FROM ENTERING INTO THE DESIGNATED OPEN WATER AREAS.
- BOTTOM MINING ELEVATIONS ARE ±10' DEPENDING ON ACTUAL BOTTOM OF GRAVEL DEPTHS.
- AGRICULTURE ZONES TO HAVE MINIMUM OF 5' OF TOPSOIL AND SHALL BE A MINIMUM OF 5' ABOVE THE AVERAGE HIGH GROUNDWATER LEVEL.

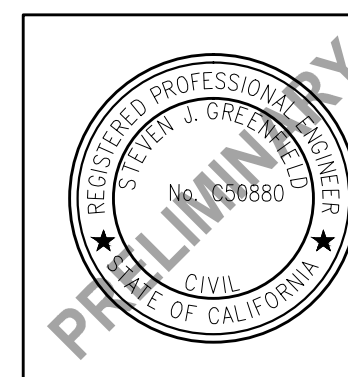
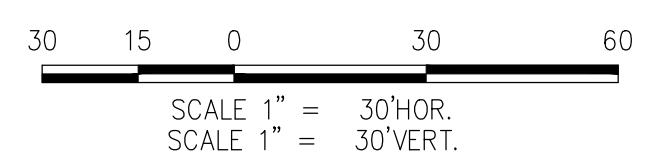

DESIGNED BY	NC	NO.	DATE	REVISIONS	BY	APPD.
DRAWN BY	NC/LR					
CHECKED BY	SG					
SCALE	AS SHOWN					



CUNNINGHAM ENGINEERING

CECWEST.COM

Project Planning • Civil Engineering • Landscape Architecture

■ Sacramento Office ■ Davis Office
2120 20th Street, Suite Three 2940 Spafford Street, Suite 200
Sacramento, CA 95818 Davis, CA 95618
(916) 455-2026 (530) 758-2026

SHIFLER RECLAMATION PLAN

CROSS SECTION A-A

SHEET	R-03
OF	9
DATE:	02/08/16
JOB NO:	1129.20

YOLO COUNTY

CALIFORNIA

S:\Projects\11029\11029 - Reclamation Plan\SHEETS\1129-20-CR-REC-A-A.dwg - ASCE CA 7/26/2016 10:07AM Plotted by: Lora

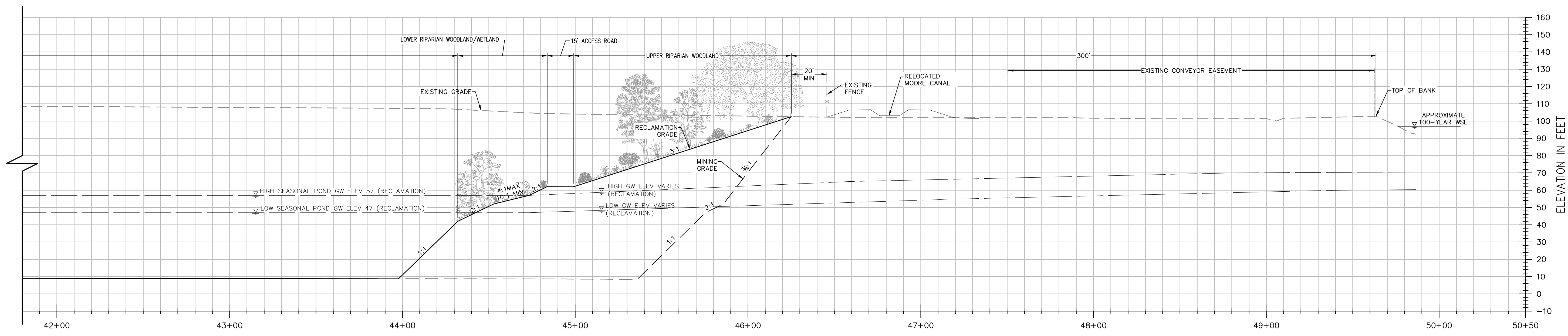
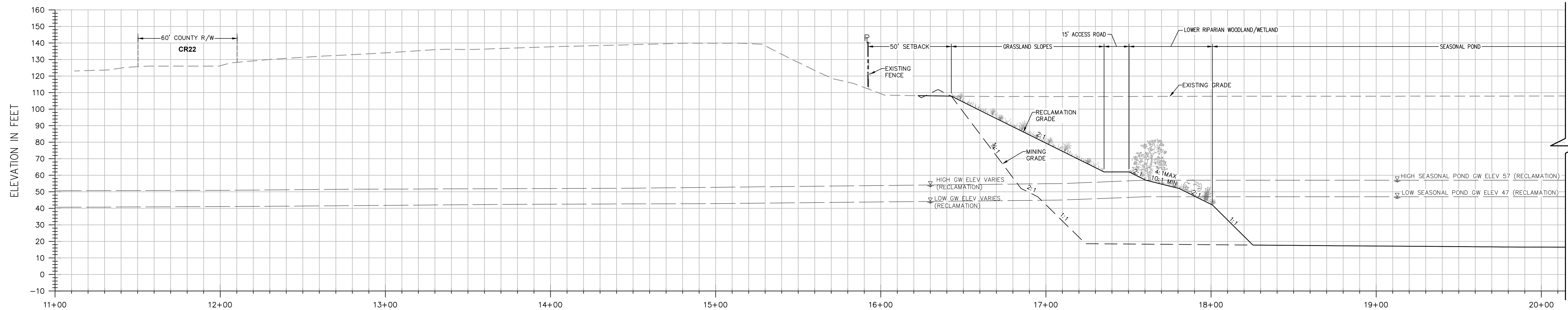

SECTION B-B

H: 1"=30'
V: 1"=30'

NOTES:

- ELEVATIONS AND DISTANCES ARE APPROXIMATE. EXISTING GROUND IS BASED ON AERIAL TOPOGRAPHY FLOWN IN APRIL 2010 BY POINT CO. PHOTOGRAMMETRIC SERVICES.
- HIGH AND LOW AVERAGE GROUNDWATER ELEVATIONS BASED ON "GROUNDWATER CONDITIONS IN THE VICINITY OF PLANNED WETPIT MINING OPERATIONS, SHIFLER PROPERTY" AND "CONTOURS OF PREDICTED GROUNDWATER ELEVATION, AVERAGE FALL LOW, POST-RECLAMATION", BOTH BY LUHDORFF & SCALMANINI CONSULTING ENGINEERS DATED DECEMBER 22, 2015, UPDATED FEBRUARY 2016.
- BERMS OR V-DITCHES TO BE ADDED ALONG THE TOP OF SLOPES AS NECESSARY TO KEEP SURFACE RUNOFF FROM ADJACENT AREAS FROM ENTERING INTO THE DESIGNATED OPEN WATER AREAS.
- BOTTOM MINING ELEVATIONS ARE ±10' DEPENDING ON ACTUAL BOTTOM OF GRAVEL DEPTHS.
- AGRICULTURE ZONES TO HAVE MINIMUM OF 5' OF TOPSOIL AND SHALL BE A MINIMUM OF 5' ABOVE THE AVERAGE HIGH GROUNDWATER LEVEL.

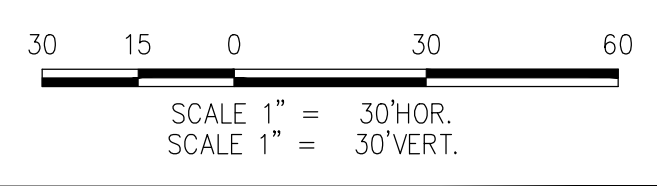

DESIGNED BY	NC	NO.	DATE	REVISIONS	BY	APPD.
DRAWN BY	NC/LR					
CHECKED BY	SG					
SCALE	AS SHOWN					



CUNNINGHAM ENGINEERING

CECWEST.COM

Project Planning • Civil Engineering • Landscape Architecture

■ Sacramento Office ■ Davis Office
2120 20th Street, Suite Three 2940 Spafford Street, Suite 200
Sacramento, CA 95818 Davis, CA 95618
(916) 455-2026 (530) 758-2026

SHIFLER RECLAMATION PLAN

CROSS SECTION B-B

SHEET	R-04
OF	9
DATE:	02/08/16
JOB NO:	1129.20

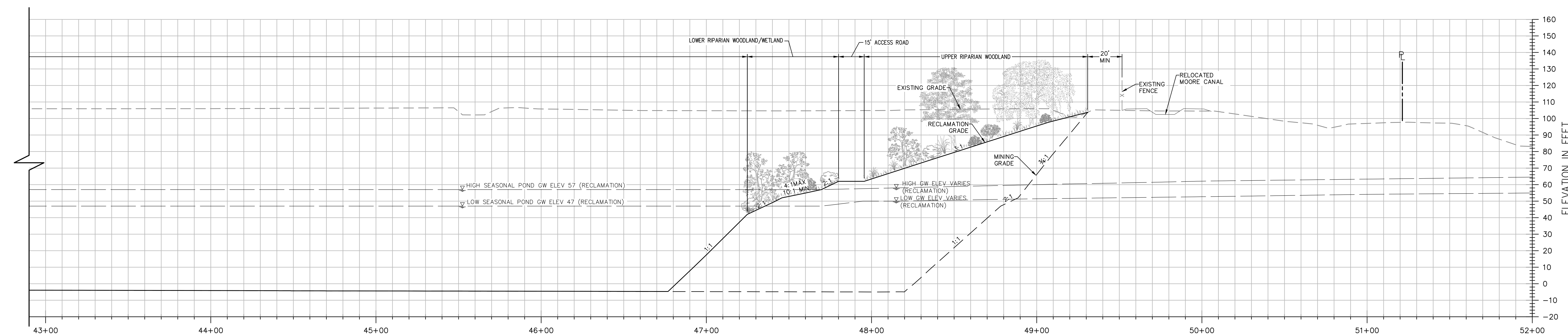
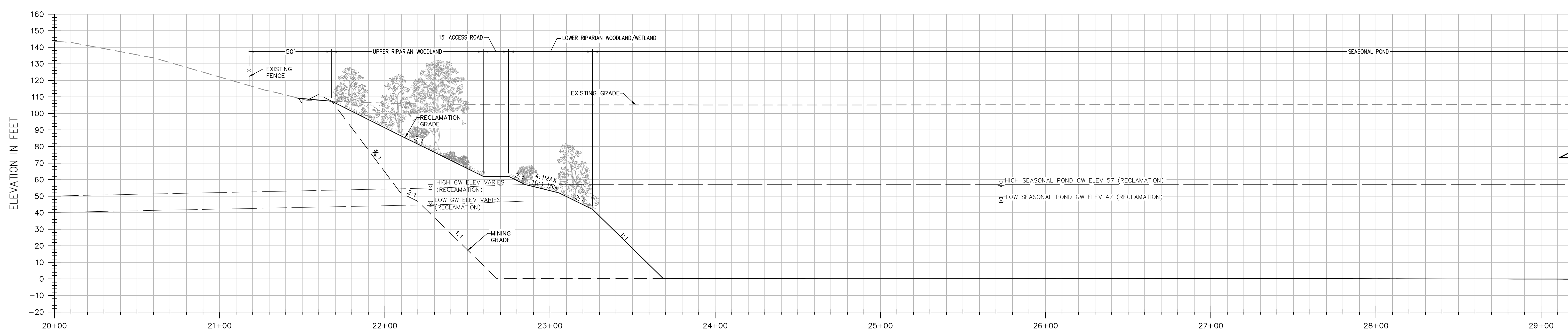

SECTION C-C

H: 1"=30'
V: 1"=30'

NOTES:

- ELEVATIONS AND DISTANCES ARE APPROXIMATE. EXISTING GROUND IS BASED ON AERIAL TOPOGRAPHY FLOWN IN APRIL 2010 BY POINT CO. PHOTOGRAMMETRIC SERVICES.
- HIGH AND LOW AVERAGE GROUNDWATER ELEVATIONS BASED ON "GROUNDWATER CONDITIONS IN THE VICINITY OF PLANNED WETPIT MINING OPERATIONS, SHIFLER PROPERTY" AND "CONTOURS OF PREDICTED GROUNDWATER ELEVATION, AVERAGE FALL LOW, POST-RECLAMATION", BOTH BY LUHDORFF & SCALMANINI CONSULTING ENGINEERS DATED DECEMBER 22, 2015, UPDATED FEBRUARY 2016.
- BERMS OR V-DITCHES TO BE ADDED ALONG THE TOP OF SLOPES AS NECESSARY TO KEEP SURFACE RUNOFF FROM ADJACENT AREAS FROM ENTERING INTO THE DESIGNATED OPEN WATER AREAS.
- BOTTOM MINING ELEVATIONS ARE ±10' DEPENDING ON ACTUAL BOTTOM OF GRAVEL DEPTHS.
- AGRICULTURE ZONES TO HAVE MINIMUM OF 5' OF TOPSOIL AND SHALL BE A MINIMUM OF 5' ABOVE THE AVERAGE HIGH GROUNDWATER LEVEL.

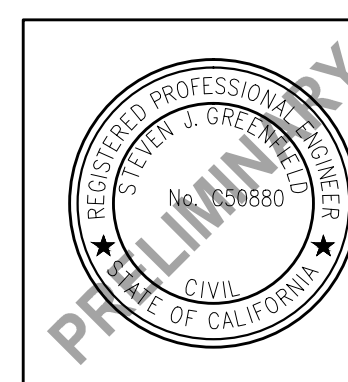
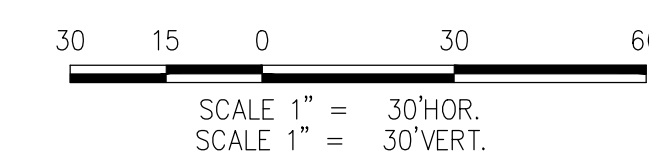

DESIGNED BY	NC	NO.	DATE	REVISIONS	BY	APPD.
DRAWN BY	NC/LR					
CHECKED BY	SG					
SCALE	AS SHOWN					

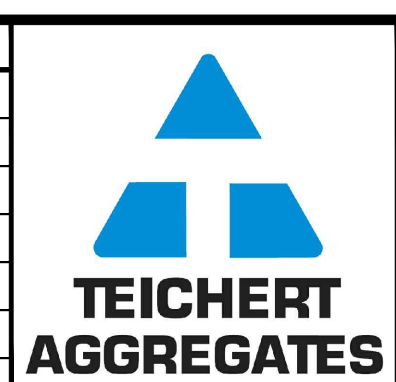

CECWEST.COM
Project Planning • Civil Engineering • Landscape Architecture

■ Sacramento Office ■ Davis Office
2120 20th Street, Suite Three 2940 Spafford Street, Suite 200
Sacramento, CA 95818 Davis, CA 95618
(916) 455-2026 (530) 758-2026

SHIFLER RECLAMATION PLAN

CROSS SECTION C-C

YOLO COUNTY CALIFORNIA

SHEET
R-05
OF
9

DATE: 02/08/16

JOB NO: 1129.20

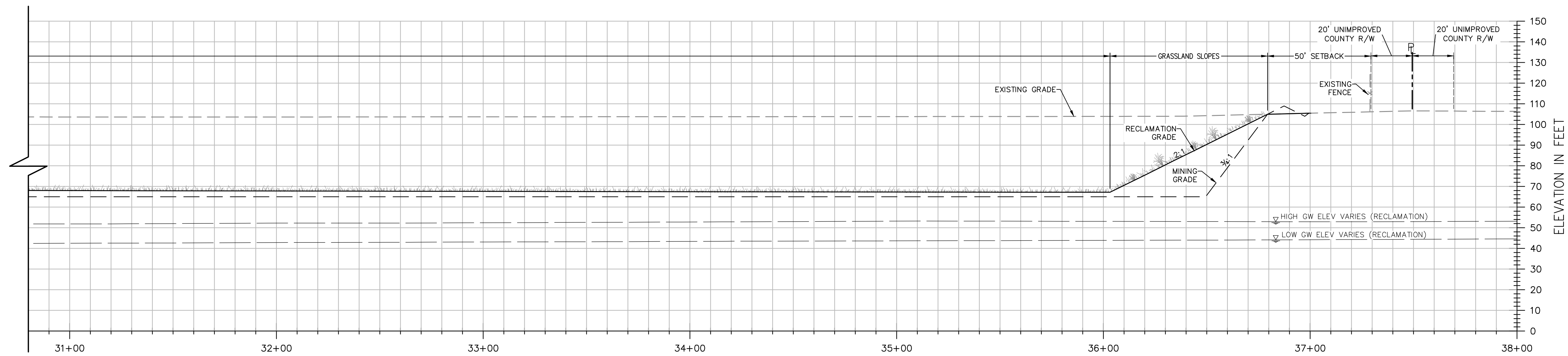
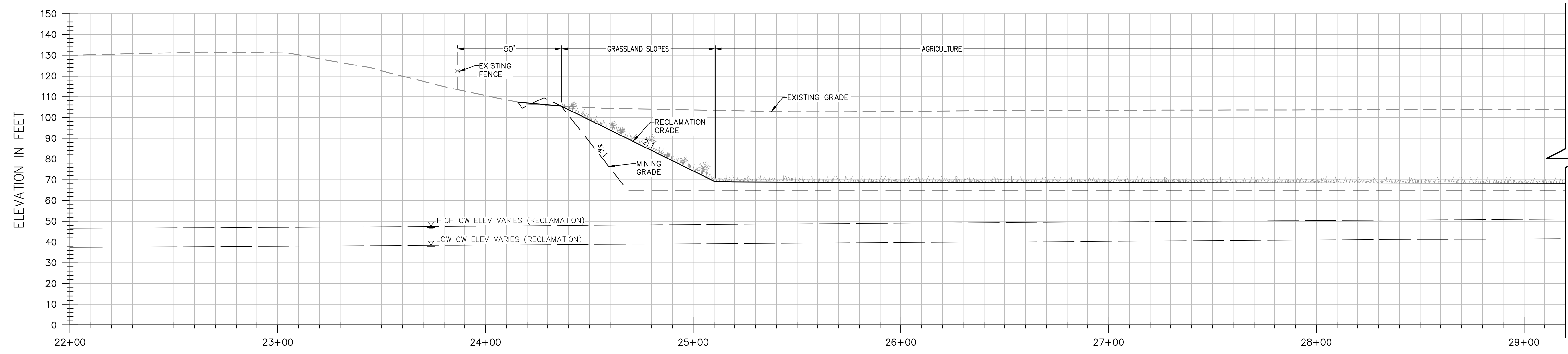

SECTION D-D

H: 1"=30'
V: 1"=30'

NOTES:

- ELEVATIONS AND DISTANCES ARE APPROXIMATE. EXISTING GROUND IS BASED ON AERIAL TOPOGRAPHY FLOWN IN APRIL 2010 BY POINT CO. PHOTOGRAMMETRIC SERVICES.
- HIGH AND LOW AVERAGE GROUNDWATER ELEVATIONS BASED ON "GROUNDWATER CONDITIONS IN THE VICINITY OF PLANNED WETPIT MINING OPERATIONS, SHIFLER PROPERTY" AND "CONTOURS OF PREDICTED GROUNDWATER ELEVATION, AVERAGE FALL LOW, POST-RECLAMATION", BOTH BY LUHDORFF & SCALMANINI CONSULTING ENGINEERS DATED DECEMBER 22, 2015, UPDATED FEBRUARY 2016.
- BERMS OR V-DITCHES TO BE ADDED ALONG THE TOP OF SLOPES AS NECESSARY TO KEEP SURFACE RUNOFF FROM ADJACENT AREAS FROM ENTERING INTO THE DESIGNATED OPEN WATER AREAS.
- BOTTOM MINING ELEVATIONS ARE ±10' DEPENDING ON ACTUAL BOTTOM OF GRAVEL DEPTHS.
- AGRICULTURE ZONES TO HAVE MINIMUM OF 5' OF TOPSOIL AND SHALL BE A MINIMUM OF 5' ABOVE THE AVERAGE HIGH GROUNDWATER LEVEL.

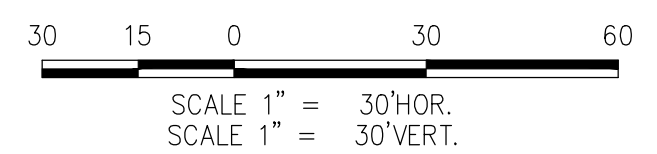

DESIGNED BY	NC	NO.	DATE	REVISIONS	BY	APPD.
DRAWN BY	NC/LR					
CHECKED BY	SG					
SCALE	AS SHOWN					



CECWEST.COM
Project Planning • Civil Engineering • Landscape Architecture

■ Sacramento Office ■ Davis Office
2120 20th Street, Suite Three 2940 Spafford Street, Suite 200
Sacramento, CA 95818 Davis, CA 95618
(916) 455-2026 (530) 758-2026

SHIFLER RECLAMATION PLAN

CROSS SECTION D-D

YOLO COUNTY CALIFORNIA

SHEET
R-06
OF
9

DATE: 02/08/16

JOB NO: 1129.20

S:\Projects\11029\1129 - Reclam - Reclam\Drawings\1129-20-Cross-Section-D-D.dwg - ASCE.D 7/25/2016 - 10:09AM Plotted by: user

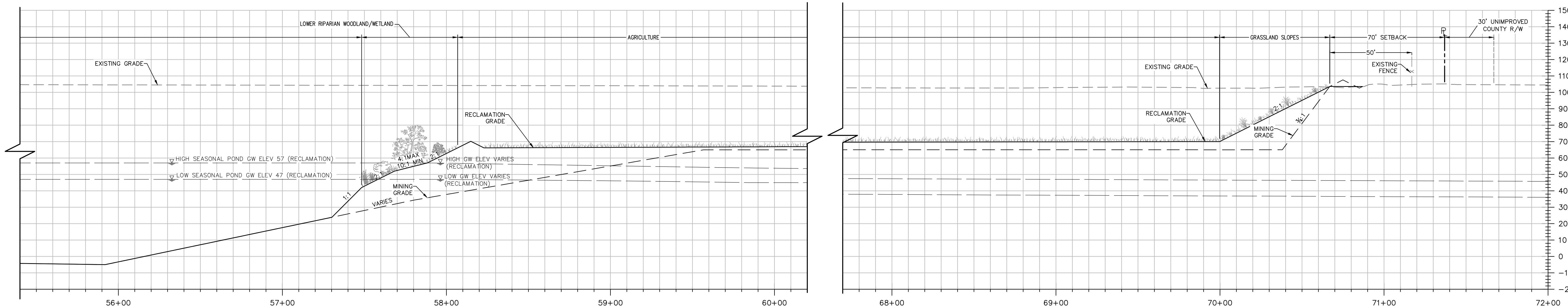
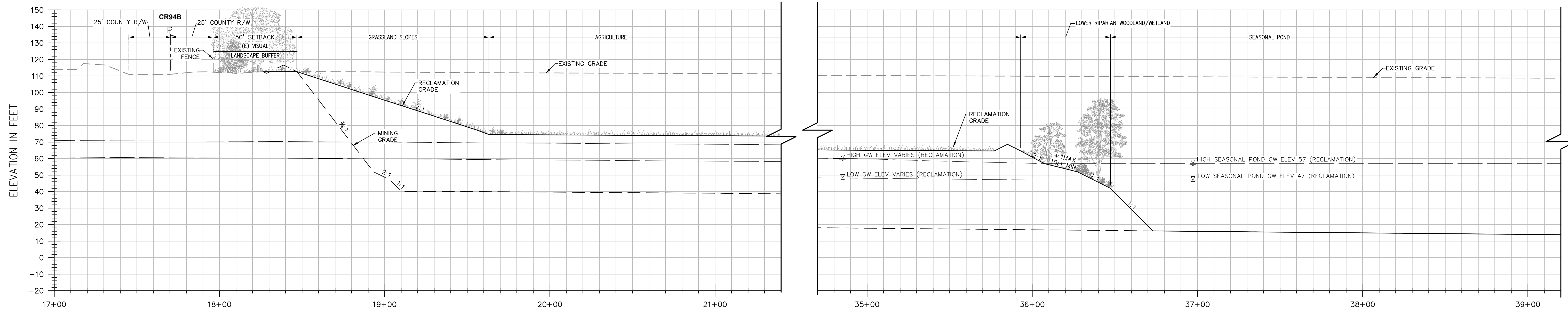

SECTION F-F

H: 1"=30'
V: 1"=30'

NOTES:

- ELEVATIONS AND DISTANCES ARE APPROXIMATE. EXISTING GROUND IS BASED ON AERIAL TOPOGRAPHY FLOWN IN APRIL 2010 BY POINT CO. PHOTOGRAMMETRIC SERVICES.
- HIGH AND LOW AVERAGE GROUNDWATER ELEVATIONS BASED ON "GROUNDWATER CONDITIONS IN THE VICINITY OF PLANNED WETPIT MINING OPERATIONS, SHIFLER PROPERTY" AND "CONTOURS OF PREDICTED GROUNDWATER ELEVATION, AVERAGE FALL LOW, POST-RECLAMATION", BOTH BY LUHDORFF & SCALMANINI CONSULTING ENGINEERS DATED DECEMBER 22, 2015, UPDATED FEBRUARY 2016.
- BERMS OR V-DITCHES TO BE ADDED ALONG THE TOP OF SLOPES AS NECESSARY TO KEEP SURFACE RUNOFF FROM ADJACENT AREAS FROM ENTERING INTO THE DESIGNATED OPEN WATER AREAS.
- BOTTOM MINING ELEVATIONS ARE ±10' DEPENDING ON ACTUAL BOTTOM OF GRAVEL DEPTHS.
- AGRICULTURE ZONES TO HAVE MINIMUM OF 5' OF TOPSOIL AND SHALL BE A MINIMUM OF 5' ABOVE THE AVERAGE HIGH GROUNDWATER LEVEL.

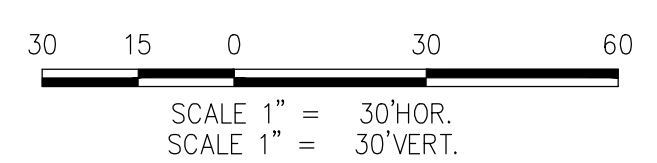

DESIGNED BY	NC	NO.	DATE	REVISIONS	BY	APPD.
DRAWN BY	NC/LR					
CHECKED BY	SG					
SCALE	AS SHOWN					



CECWEST.COM
 Project Planning • Civil Engineering • Landscape Architecture
 Sacramento Office: 2120 20th Street, Suite Three, Sacramento, CA 95818 (916) 455-2026
 Davis Office: 2940 Spafford Street, Suite 200, Davis, CA 95618 (530) 758-2026

SHIFLER RECLAMATION PLAN
CROSS SECTION F-F
 YOLO COUNTY CALIFORNIA

SHEET	R-08
OF	9
DATE:	02/08/16
JOB NO:	1129.20

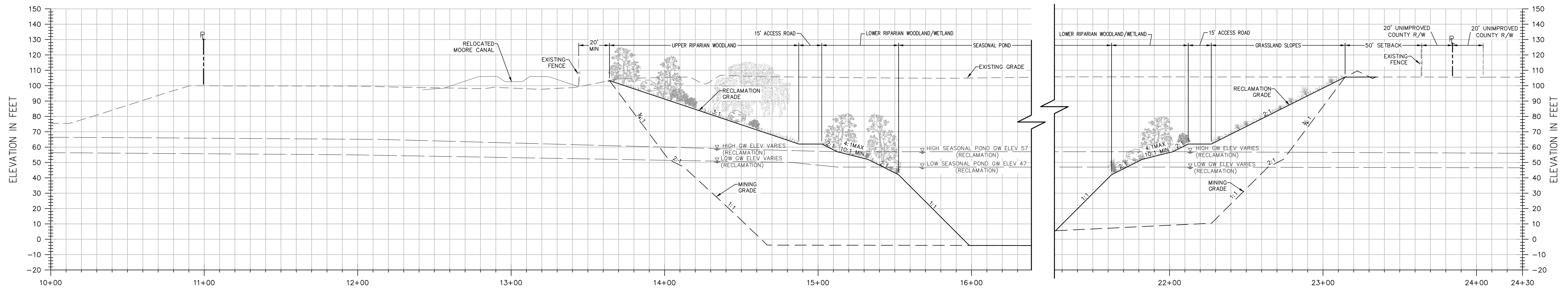

SECTION G-G
 H: 1"=30'
 V: 1"=30'

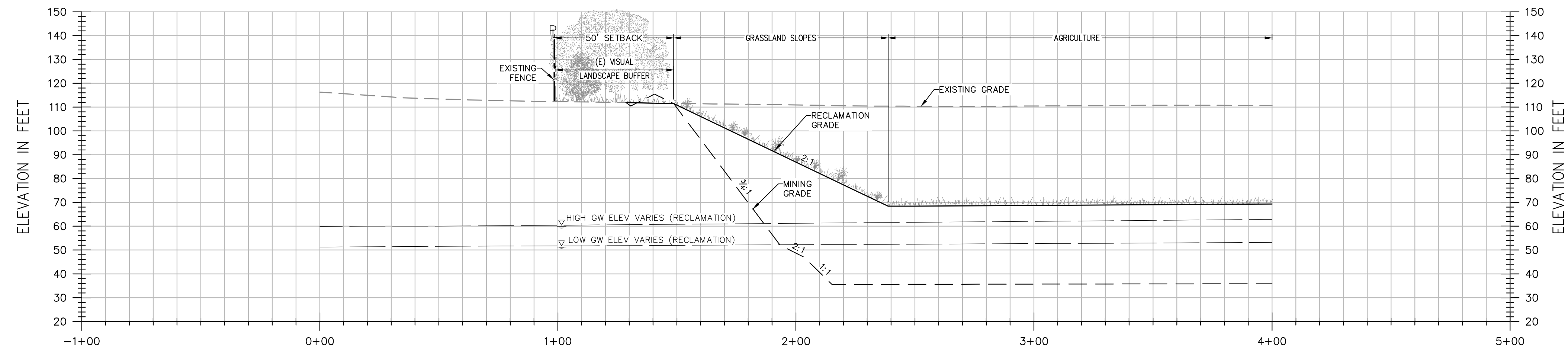

SECTION H-H
 H: 1"=30'
 V: 1"=30'

NOTES:

- ELEVATIONS AND DISTANCES ARE APPROXIMATE. EXISTING GROUND IS BASED ON AERIAL TOPOGRAPHY FLOWN IN APRIL 2010 BY POINT CO. PHOTOGRAMMETRIC SERVICES.
- HIGH AND LOW AVERAGE GROUNDWATER ELEVATIONS BASED ON "GROUNDWATER CONDITIONS IN THE VICINITY OF PLANNED WETPIT MINING OPERATIONS, SHIFLER PROPERTY" AND "CONTOURS OF PREDICTED GROUNDWATER ELEVATION, AVERAGE FALL LOW, POST-RECLAMATION", BOTH BY LUHDORFF & SCALMANINI CONSULTING ENGINEERS DATED DECEMBER 22, 2015, UPDATED FEBRUARY 2016.
- BERMS OR V-DITCHES TO BE ADDED ALONG THE TOP OF SLOPES AS NECESSARY TO KEEP SURFACE RUNOFF FROM ADJACENT AREAS FROM ENTERING INTO THE DESIGNATED OPEN WATER AREAS.
- BOTTOM MINING ELEVATIONS ARE ±10' DEPENDING ON ACTUAL BOTTOM OF GRAVEL DEPTHS.
- AGRICULTURE ZONES TO HAVE MINIMUM OF 5' OF TOPSOIL AND SHALL BE A MINIMUM OF 5' ABOVE THE AVERAGE HIGH GROUNDWATER LEVEL.

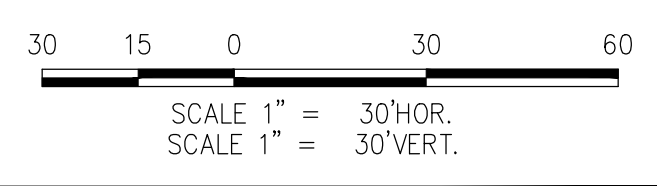

DESIGNED BY	NC	NO.	DATE	REVISIONS	BY	APPD.
DRAWN BY	NC/LR					
CHECKED BY	SG					
SCALE	AS SHOWN					

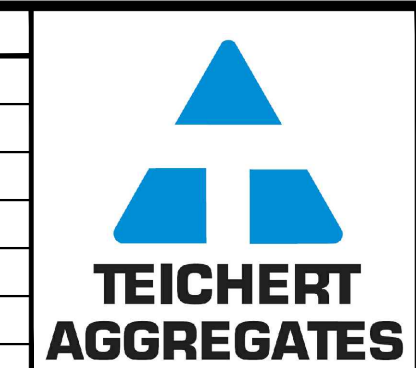

CUNNINGHAM ENGINEERING
 Project Planning • Civil Engineering • Landscape Architecture
 Sacramento Office: 2120 20th Street, Suite Three, Sacramento, CA 95818, (916) 455-2026
 Davis Office: 2940 Spafford Street, Suite 200, Davis, CA 95618, (530) 758-2026
 CECWEST.COM

SHIFLER RECLAMATION PLAN
CROSS SECTION G-G & H-H
 YOLO COUNTY CALIFORNIA

SHEET
R-09
 OF
9
 DATE: 02/08/16
 JOB NO: 1129.20

S:\Projects\1102\1129 - Reclam - Reclam\Drawings and Reclamations\Plan\SHEETS\1129-20-REC-102P-ASCE.ctb - ASCE.ctb 7/26/2016 10:10:AM Printed by: user