

YOLO COUNTY AIRPORT

AIRPORT DRAINAGE BASIN IMPROVEMENTS

WOODLAND, CA

AIP NO.:

MARCH 2019

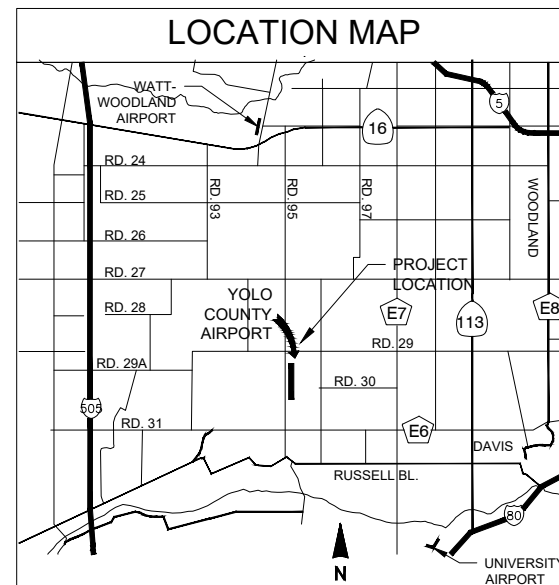
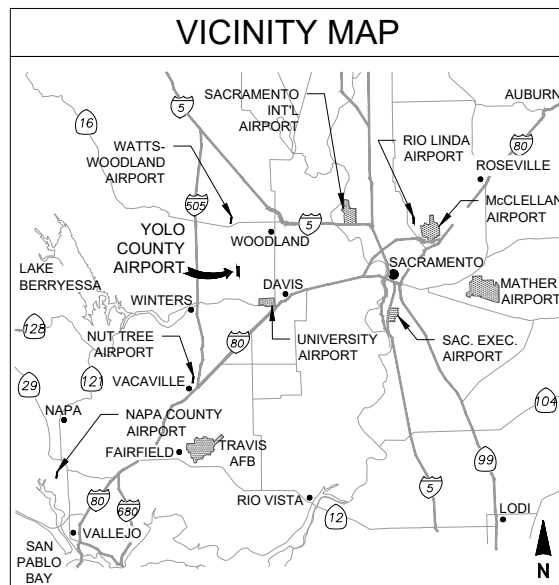

SHEET INDEX	
SHEET NUMBER	SHEET TITLE
G-001	COVER SHEET
G-002	LEGEND & ABBREVIATIONS
G-021	PROJECT LAYOUT PLAN
G-041	SURVEY CONTROL
G-081	CONSTRUCTION SAFETY AND PHASING PLANS - PHASE 1
G-082	CONSTRUCTION SAFETY AND PHASING PLANS - PHASE 2
C-021	EROSION CONTROL PLANS
C-031	EROSION CONTROL DETAILS
C-051	DEMOLITION PLANS
C-101	GRADING PLAN
C-301	TYPICAL SECTIONS
C-401	DRAINAGE PLAN & PROFILES
C-402	DRAINAGE PLAN & PROFILES
C-451	DRAINAGE DETAILS
C-901	CROSS SECTIONS
S-021	STRUCTURAL LAYOUT PLAN

PROJECT DESCRIPTION

- CONSTRUCT ONE DETENTION BASIN
- MODIFY EXISTING WATERWAY CHANNELS THAT WILL FEED INTO NEW DETENTION BASIN
- CONSTRUCT NEW CULVERTS UNDER AVIATION AVENUE IN TWO LOCATIONS

Mead & Hunt
 Mead and Hunt, Inc.
 1360 19th Hole Drive,
 Suite 200
 Windsor, CA 95492
 phone: 707-526-5010
 meadhunt.com

These documents shall not be used for any purpose or project for which it is not intended. Mead & Hunt shall be indemnified by the client and hold harmless and defend from all claims, damages, liabilities, losses, and expenses, including attorneys' fees and costs, arising out of such misuse or reuse of the documents. In addition, unauthorized reproduction of these documents, in part or as a whole, is prohibited.



**YOLO COUNTY AIRPORT
 AIRPORT DRAINAGE BASIN
 IMPROVEMENTS**
 WOODLAND, CA
 WOODLAND, CA 95695

ISSUED

NOT FOR CONSTRUCTION

MSH NO.: 2502000-170176.01
 DATE: MARCH 2019
 DESIGNED BY: XXX
 DRAWN BY: XXX
 CHECKED BY: XXX
DO NOT SCALE DRAWINGS

SHEET CONTENTS
 COVER SHEET

SHEET NO.

G-001



Know what's below.
 Call before you dig.

LEGEND:

- BENCHMARK
- CONTROL POINT
- BOLLARD
- CLEANOUT, SANITARY OR STORM
- ELECTRIC MANHOLE
- ELECTRIC PEDESTAL BOX
- ELECTRIC TRANSFORMER BOX
- ELECTRIC SERVICE PANEL
- ELECTRIC HANDHOLE (PULLBOX)
- FIRE HYDRANT
- GAS VALVE
- GATE
- HANDHOLE, GENERIC
- LIGHT BOLLARD
- LIGHT POLE (SINGLE)
- LIGHT POLE (DOUBLE)
- MARKER, CABLE
- MARKER, DUCT
- MONITORING WELL
- PIEZOMETER
- SANITARY SEPTIC TANK VALVE
- SANITARY SEWER LIFT STATION
- SANITARY SEWER MANHOLE
- SANITARY SEWER VALVE
- SANITARY SEWER WET WELL
- SIGN (SINGLE POST)
- SOIL BORING
- STORM INLET, CURB
- STORM INLET, ROUND
- STORM INLET, SQUARE
- STORM FLARED END SECTION
- STORM SEWER MANHOLE
- STORM WATER QUALITY MANHOLE
- TELECOMMUNICATIONS PEDESTAL BOX
- TRAFFIC FLOW DIRECTION
- UTILITY CROSSING / CONFLICT or CAUTION
- UNDERDRAIN FLUSHER RISER
- UNDERDRAIN MANHOLE
- WATER MANHOLE
- WATER METER
- WATER PRESSURE VALVE
- WATER REDUCER
- WATER VALVE
- WATER SHUT OFF
- WATER SURFACE
- BOUNDARY (PROJECT /CONSTRUCTION LIMITS)
- BOUNDARY 2 (PROJECT /CONSTRUCTION LIMITS)
- CON — CONDUIT, GENERIC
- G — GAS
- OHE — ELECTRIC, OVERHEAD
- E — ELECTRIC, UNDERGROUND
- xxx(xxx)---
---xxx(xxx)---
EXISTING CONTOUR LINES
- xxx(xx)---
---xxx(xx)---
PROPOSED CONTOUR LINES
- x — FENCE
- xx — FENCE (2)
- xxx — FENCE (3)
- FOC — FIBER OPTIC CABLE
- FM — FORCE MAIN
- F — FUEL LINE
- GB — GRADE BREAK
- --- ---
GRADING LIMITS
- // // // // // // //
GROUND
-
GUARDRAIL
- o — HANDRAIL
- → →
HAUL or TRAFFIC ROUTE

- - - - - PROPERTY LINE
- ROW — RIGHT-OF-WAY
- SS — SANITARY SEWER
- ~~~~~ SHEETPILE
- S — SIGNAL CABLE, UNDERGROUND
- SILT FENCE
- SSSSSSSSSSSSSSSSSSSS- SEDIMENT LOG
- STONE RETAINING WALL
- SD — STORM SEWER / CULVERT
- SWALE
- - - - - SWALE
- T — TELEPHONE, UNDERGROUND
- TV — TV CABLE
- UD — UNDERDRAIN
- W — WATER
- WB — WETLAND BOUNDARY
- Q100 — 100YR (Q100) FLOOD LINE
- RIPRAP OUTFALL
- RIPRAP
- AGGREGATE BASE COURSE
- ASPHALT
- CONCRETE
- STABILIZED CONSTRUCTION ENTRANCE
- EROSION MAT
- GROUND, EXISTING
- GROUND, PROPOSED
- RESTORATION AREA
- WELDED WIRE REINFORCEMENT
- WETLAND
- REMOVAL PATTERN
- ASPHALT REMOVAL
- SECTION REFERENCE
- ELEVATION REFERENCE
- SHEET REFERENCE
- DETAIL REFERENCE
- . 734.97' EXISTING SPOT ELEVATION
- . 738.76' FINISHED / PROPOSED SPOT ELEVATION
- 3:1 FINISHED / PROPOSED SLOPE
- 2% FINISHED / PROPOSED SLOPE

ABBREVIATIONS

AB	AGGREGATE BASE	FL	FLOW LINE	PVC	POINT OF VERTICAL CURVE
AC	ASPHALT CONCRETE	FPS	FEET PER SECOND	PVC	POLYVINYL CHLORIDE
ALT	ALTERNATE	FT	FEET	PVI	POINT OF VERTICAL INTERSECTION
AOA	AIRCRAFT OPERATIONS AREA	G	GAS LINE	PVT	POINT OF VERTICAL TANGENCY
APCH	APPROACH	GAL	GALLON	Q	RATE OF FLOW
APPROX	APPROXIMATE	GALV	GALVANIZED	QTY	QUANTITY
ASB	AGGREGATE SUB-BASE	GB	GRADE BREAK	R	RADIUS
AR	ACCESS ROAD	GND	GROUND	R&R	REMOVE AND REPLACE
ATCT	AIR TRAFFIC CONTROL TOWER	GPM	GALLONS PER MINUTE	RC	RELATIVE COMPACTION
AWG	AMERICAN WIRE GAUGE	GS	GROUND SHOT	RCP	REINFORCED CONCRETE PIPE
BC	BEGINNING OF CURVE	H	HEIGHT	REQ	REQUIRED
BIT	BITUMINOUS	HDPE	HIGH DENSITY POLYETHYLENE	ROW	RIGHT OF WAY
BLDG	BUILDING	HIRL	HIGH INTENSITY RUNWAY LIGHT	RWA	RUNWAY WORK RESTRICTED AREA
DM	BENCHMARK	HIR,THL	HIGH INTENSITY THRESHOLD LIGHT	RWY	RUNWAY
BOT	BOTTOM	HORIZ	HORIZONTAL	S	SANITARY LINE
BVC	BEGINNING OF VERTICAL CURVE	HP	HIGH POINT	SF	SQUARE FOOT
C-C	CENTER TO CENTER	HW	HEADWALL	SG	STRAIGHT GRADE
CB	CATCH BASIN	HWL	HIGH WATER LEVEL	SH	SHOULDER
CIPCP	CAST IN-PLACE CONCRETE PIPE	HWY	HIGHWAY	SIDA	SECURITY IDENTIFICATION DISPLAY AREA
CJ	CONSTRUCTION JOINT	IE	INVERT ELEVATION	SMGS	SURFACE MOVEMENT GUIDANCE AND CONTROL SYSTEM
CFS	CUBIC FEET PER SECOND	IN	INCHES	SS	STAINLESS STEEL
CL	CENTERLINE	L	LENGTH	ST	STORM LINE
CLF	CHAINLINK FENCE	LBS	POUNDS	STA	STATION
CLR	CLEAR	LF	LINEAL FEET	STD	STANDARD
CMP	CORRUGATED METAL PIPE	LWL	LOW WATER LEVEL	STL	STEEL
CO	CLEANOUT	MAX	MAXIMUM	T	TELEPHONE LINE
CONC	CONCRETE	MID	MID POINT	TC	TOP OF CURB
CONT	CONTINUOUS	MIN	MINIMUM	TG	TOP OF GRATE
CRGO	CARGO	MIRL	MEDIUM INTENSITY RUNWAY LIGHT	T/L	TAXILINE
CP	CONTROL POINT	MITL	MEDIUM INTENSITY TAXIWAY LIGHT	TOE	TOE OF BANK
CTB	CEMENT TREATED BASE	MPH	MILES PER HOUR	TOP	TOP OF BANK
DB	DIRECT BURIAL	(N)	NEW	TWY	TAXIWAY
DEG	DEGREE	NO. OR #	NUMBER	TYP	TYPICAL
DI	DROP INLET	NOTMA	NOTICE TO AIRMAN	UD	UNDERDRAIN
DIA	DIAMETER	NTS	NOT TO SCALE	UG	UNDERGROUND
DIM	DIMENSION	OC	ON CENTER	UON	UNLESS OTHERWISE NOTED
DIP	DUCTILE IRON PIPE	OH	OVERHEAD	V	VELOCITY
DP	DEPTH	OWS	OIL WATER SEPERATOR	VC	VERTICAL CURVE
(E)	EXISTING	PB	PULL BOX	VERT	VERTICAL
E	ELECTRICAL LINE	PC	POINT OF CURVATURE	VG	VALLEY GUTTER
EC	END OF CURVE	PCC	PORTLAND CEMENT CONCRETE	VIF	VERIFY IN FIELD
EG	EXISTING GRADE	PCF	POUNDS PER CUBIC FOOT	W	WATER LINE
ELEV	ELEVATION	PERF	PERFORATED	W/	WITH
EOP	EDGE OF PAVEMENT	PI	POINT OF INTERSECTION	W/O	WITHOUT
EVC	END OF VERTICAL CURVE	POB	POINT OF BEGINNING	WSE	WATER SURFACE ELEVATION
FAA	FEDERAL AVIATION ADMINISTRATION	POC	POINT OF CURVE	WSP	WELDED STEEL PIPE
FBO	FIXED BASE OPERATOR	POE	POINT OF ENDING	WV	WATER VALVE
FF	FINISHED FLOOR	PSI	POUNDS PER SQUARE INCH	WWM	WELDED WIRE MESH
FG	FINISHED GRADE	PSF	POUNDS PER SQUARE FOOT		
FH	FIRE HYDRANT	PT	POINT OF TANGENCY		

Mead & Hunt
 Mead and Hunt, Inc.
 1360 19th Hole Drive,
 Suite 200
 Windsor, CA 95492
 phone: 707-526-5010
 meadhunt.com

These documents shall not be used for any purpose or project for which it is not intended. Mead & Hunt shall be indemnified by the client and hold harmless and defend from all claims, damages, liabilities, losses, and expenses, including attorney's fees and costs, arising out of such misuse or reuse of the documents. In addition, unauthorized reproduction of these documents, in part or as a whole, is prohibited.

**YOLO COUNTY AIRPORT
 AIRPORT DRAINAGE BASIN
 IMPROVEMENTS**
 WOODLAND, CA
 WOODLAND, CA 95695

ISSUED
 NOT FOR CONSTRUCTION

MSH NO.: 2502000-170176.01
 DATE: MARCH 2019
 DESIGNED BY: XXX
 DRAWN BY: XXX
 CHECKED BY: XXX
DO NOT SCALE DRAWINGS

SHEET CONTENTS
 LEGEND &
 ABBREVIATIONS

SHEET NO.

G-002

These documents shall not be used for any purpose or project for which it is not intended. Mead & Hunt shall be indemnified by the client and hold harmless and defend from all claims, damages, liabilities, losses, and expenses, including attorney's fees and costs, arising out of such misuse or reuse of the documents. In addition, unauthorized reproduction of these documents, in part or as a whole, is prohibited.

**YOLO COUNTY AIRPORT
AIRPORT DRAINAGE BASIN
IMPROVEMENTS**
WOODLAND, CA
WOODLAND, CA 95695

ISSUED

NOT FOR CONSTRUCTION

MSH NO.: 2502000-170176.01
DATE: MARCH 2019
DESIGNED BY: XXX
DRAWN BY: XXX
CHECKED BY: XXX
DO NOT SCALE DRAWINGS

SHEET CONTENTS
PROJECT LAYOUT
PLAN

SHEET NO.

G-021

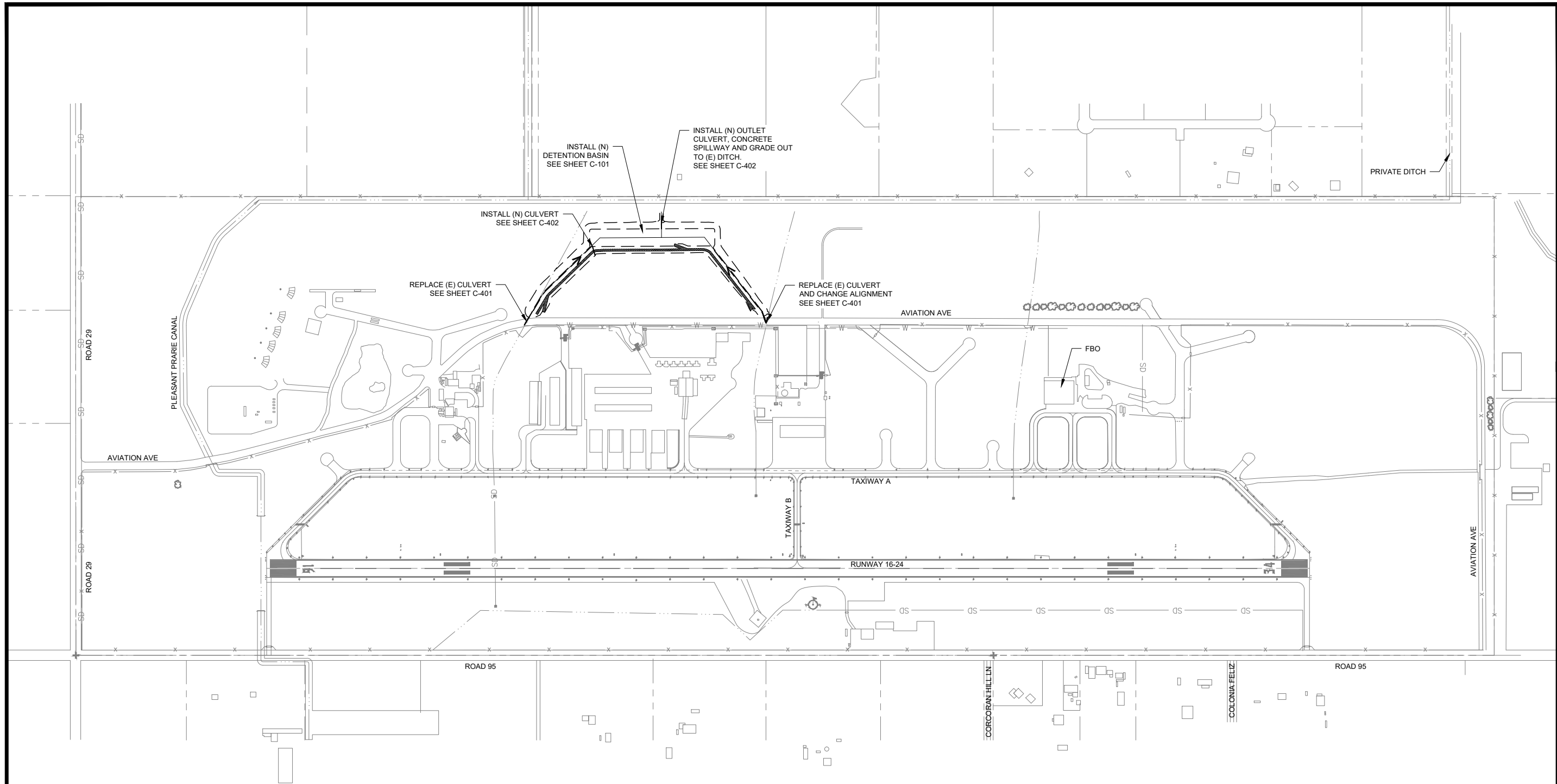

GENERAL PLAN NOTES:

1. WORK WITHIN THE RESTRICTED WORK AREA (RWA) WILL NOT BE REQUIRED OR PERMITTED FOR THE DRAINAGE BASIN CONSTRUCTION. SEE PROJECT SPECIFICATIONS AND CONSTRUCTION SAFETY AND PHASING PLAN SHEETS FOR ADDITIONAL INFORMATION ON SECURITY REQUIREMENTS, LIMITATIONS ON CONSTRUCTION AND ACCESS TO VARIOUS WORK AREAS.
2. CONTRACTOR'S ACCESS TO THE AIRPORT SHALL BE VIA THE ROUTES SHOWN UNLESS OTHERWISE APPROVED BY THE COUNTY. THE CONTRACTOR SHALL BE RESPONSIBLE FOR DAMAGE TO PAVEMENTS OR OTHER EXISTING FACILITIES CAUSED BY CONSTRUCTION ACTIVITIES. THE STAGING AND STORAGE OF CONSTRUCTION MATERIALS AND EQUIPMENT AS WELL AS VEHICLE PARKING SHALL BE AT THE LOCATION INDICATED.
3. CONSTRUCTION TRAFFIC IS LIMITED TO APPROVED HAUL AND ACCESS ROUTES. HAUL ROUTES ON PAVEMENTS SHALL BE CLEANED EACH DAY OR AS NEEDED. HAUL ROUTES OVER DIRT/GRAVEL SHALL BE SMOOTH GRADED AND OBLITERATED UPON COMPLETION OF THE PROJECT. DUST CONTROL SHALL BE MAINTAINED BY THE CONTRACTOR AT ALL TIMES.
4. THE CONTRACTOR SHALL NOT BEGIN EXCAVATION OR DEMOLITION UNTIL ALL EXISTING UNDERGROUND FACILITIES WITHIN THE AREA TO BE DISTURBED HAVE BEEN MARKED IN THE FIELD BY THE CONTRACTOR. THE CONTRACTOR SHALL POTHOLE AND VERIFY THE DEPTH OF ALL UTILITIES WITHIN THE CONSTRUCTION ZONE BEFORE TRENCHING. PLEASE CALL USA NORTH AT 811 OR 800-227-8600.
5. NO GUARANTEE IS EXPRESSED OR IMPLIED THAT ALL UNDERGROUND OBSTRUCTIONS ARE SHOWN ON THE PLANS. UNDERGROUND OBSTRUCTIONS NOT SHOWN MAY BE ENCOUNTERED. THOSE SHOWN ARE BASED ON THE BEST INFORMATION AVAILABLE AND THE CONTRACTOR IS CAUTIONED THAT THE ENGINEER AND THE COUNTY ASSUME NO RESPONSIBILITY FOR ANY OBSTRUCTIONS EITHER SHOWN OR NOT SHOWN ON THE PLANS.
6. DURING HAULING ACTIVITIES, CONTRACTOR SHALL PROVIDE TRAFFIC CONTROL ALONG AVIATION AVENUE AND KEEP ONE LANE OF TRAFFIC OPEN AT ALL TIMES.

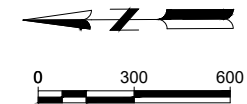

SITE SURVEY PLAN NOTE:

CONTROL POINTS AND BENCHMARKS SHOWN HEREON ARE FOR REFERENCE PURPOSES ONLY. PRIOR TO STAKING, THE CONTROL MUST BE INDEPENDENTLY VERIFIED AS UNDISTURBED. NO WARRANTY IS MADE WITH RESPECT TO THE ACCURACY OF CONTROL SHOWN HEREON AS THEY ARE SUBJECT TO POTENTIAL DISTURBANCE.

VERTICAL DATUM: USGS NAVD88
 SURVEY UNITS: US SURVEY FOOT

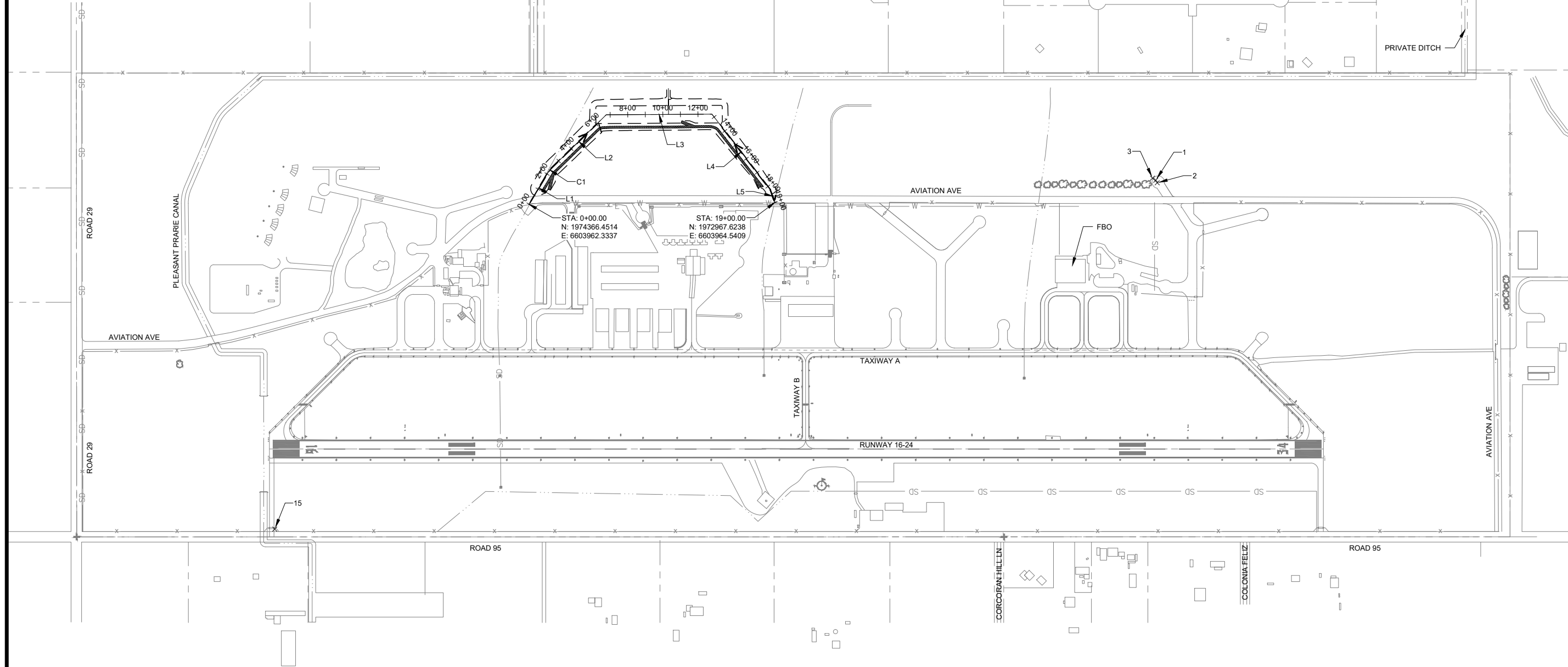

STA: 0+00.00
 N: 1974366.4514
 E: 6603962.3337

STA: 19+00.00
 N: 1972967.6238
 E: 6603964.5409

ALIGNMENT LINE DATA		
LINE #	LENGTH	BEARING
L1	214.90	S58° 52' 42.51"E
L2	436.71	S43° 52' 30.83"E
L3	601.64	S0° 00' 00.00"E
L4	543.13	S52° 38' 16.68"W
L5	77.44	S70° 50' 11.38"W

ALIGNMENT CURVE DATA											
#	RADIUS	Δ	TANGENT	LENGTH	CENTER POINT NORTHING	CENTER POINT EASTING	PC NORTHING	PC EASTING	PT NORTHING	PT EASTING	#
C1	100.00'	15° 00' 12"	13.17	26.19'	1974169.773	6604094.616	1974255.381	6604146.302	1974239.082	6604166.701	

POINT TABLE				
POINT #	NORTHING	EASTING	ELEVATION	DESCRIPTION
1	1970797.700	6604079.832	92.55	CP SET PK RH
2	1970789.558	6604064.978	92.69	CP SET SPIKE
3	1970816.269	6604091.517	91.73	YCCP2
15	1975824.632	6602120.715	96.41	SS YCCP6

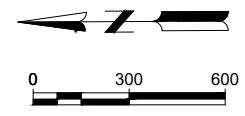

Mead & Hunt
 Mead and Hunt, Inc.
 1360 19th Hole Drive,
 Suite 200
 Windsor, CA 95492
 phone: 707-526-5010
 meadhunt.com

These documents shall not be used for any purpose or project for which it is not intended. Mead & Hunt shall be indemnified by the client and hold harmless and outendowed from all claims, damages, liabilities, losses, and expenses, including attorney's fees and costs, arising out of such misuse or reuse of the documents. In addition, unauthorized reproduction of these documents, in part or as a whole, is prohibited.

**YOLO COUNTY AIRPORT
 AIRPORT DRAINAGE BASIN
 IMPROVEMENTS**
 WOODLAND, CA
 WOODLAND, CA 95695

ISSUED

NOT FOR CONSTRUCTION

MSH NO.: 2502000-170176.01
 DATE: MARCH 2019
 DESIGNED BY: XXX
 DRAWN BY: XXX
 CHECKED BY: XXX
DO NOT SCALE DRAWINGS

SHEET CONTENTS
 SURVEY CONTROL

SHEET NO.

G-041

I:\CORP- MEADHUNT.COM\SHARED\FOLDERS\ENTR\2502000\170176.01\TECH\CAD\DRAWINGS\SURVEY CONTROL.DWG
 3/27/2019 2:43:04 PM

These documents shall not be used for any purpose or project for which it is not intended. Mead & Hunt shall be indemnified by the client and hold harmless and defend from all claims, damages, liabilities, losses, and expenses, including attorney's fees and costs, arising out of such misuse or reuse of the documents. In addition, unauthorized reproduction of these documents, in part or as a whole, is prohibited.

**YOLO COUNTY AIRPORT
AIRPORT DRAINAGE BASIN
IMPROVEMENTS**
WOODLAND, CA
WOODLAND, CA 95695

ISSUED

NOT FOR CONSTRUCTION

MSH NO.: 2502000-170176.01
DATE: MARCH 2019
DESIGNED BY: XXX
DRAWN BY: XXX
CHECKED BY: XXX
DO NOT SCALE DRAWINGS

SHEET CONTENTS
CONSTRUCTION
SAFETY AND PHASING
PLANS - PHASE 1

SHEET NO.

G-081

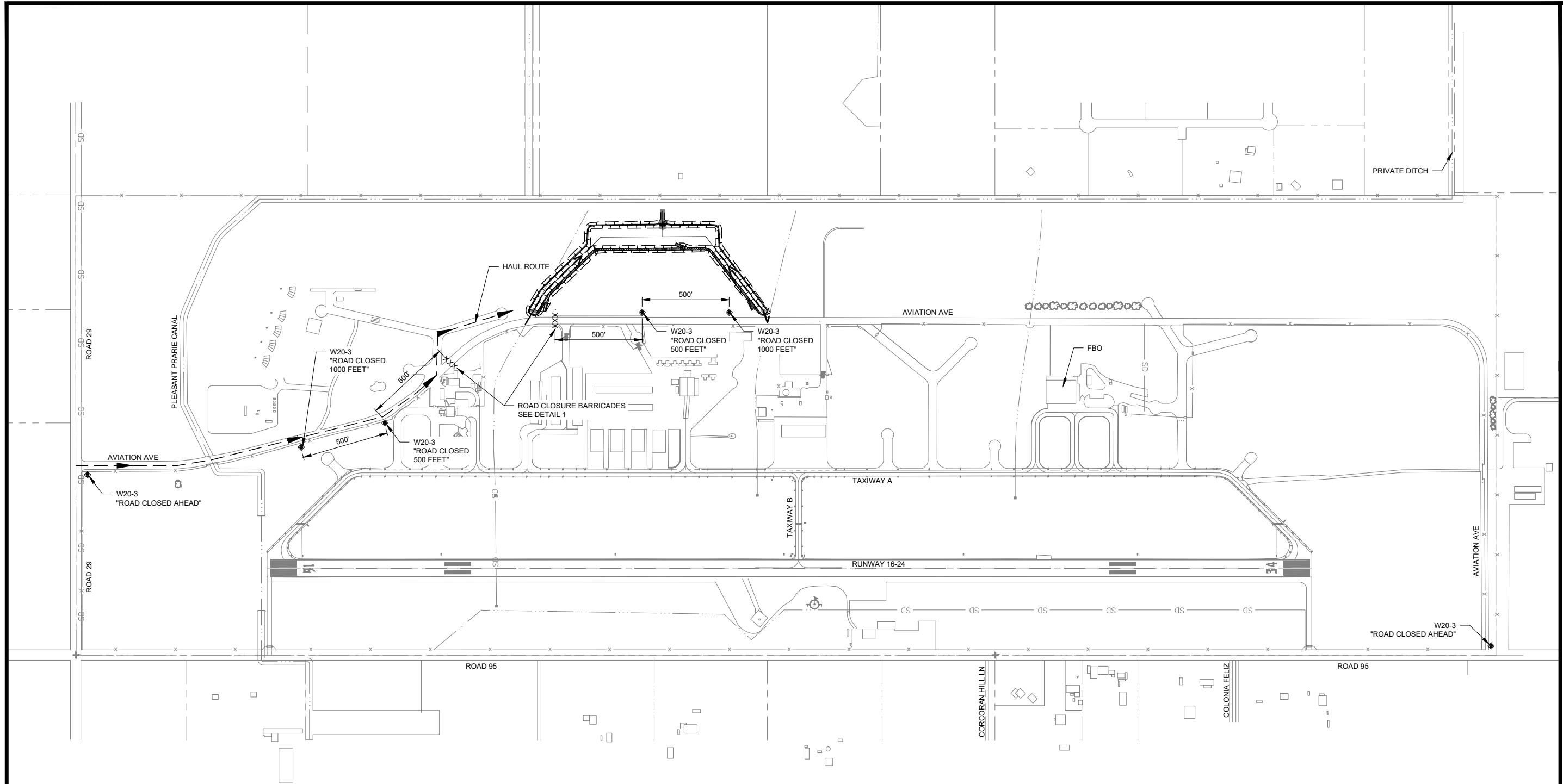

- NOTES:
1. CONSTRUCTION EQUIPMENT SHALL NOT EXTEND 25 FEET OR MORE ABOVE GROUND LEVEL. SEE 4.18.2 IN CSPP REPORT.
 2. ROADS SHALL BE SWEEPED AND CLEAR OF DEBRIS.
 3. ALL SIGNS AND TRAFFIC CONTROLS SHALL COMPLY WITH THE CALIFORNIA MUTCD AND COUNTY OF YOLO PUBLIC WORKS DIVISION.

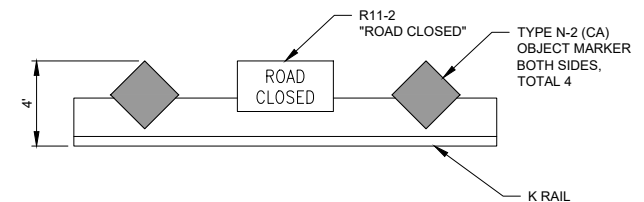

1 ROAD CLOSURE BARRICADE
NO SCALE



I:\CORP\MEADHUNT\COM\SHARED\FOLDERS\ENTP\2502000\170176.01\TECH\CAD\DRAWINGS\CONSTRUCTION SAFETY AND PHASING PLANS.DWG 3/27/2019 2:43:18 PM

These documents shall not be used for any purpose or project for which it is not intended. Mead & Hunt shall be indemnified by the client and hold harmless and defend from all claims, damages, liabilities, losses, and expenses, including attorney's fees and costs, arising out of such misuse or reuse of the documents. In addition, unauthorized reproduction of these documents, in part or as a whole, is prohibited.

**YOLO COUNTY AIRPORT
AIRPORT DRAINAGE BASIN
IMPROVEMENTS**
WOODLAND, CA
WOODLAND, CA 95695

ISSUED

NOT FOR CONSTRUCTION

MSH NO.: 2502000-170176.01
DATE: MARCH 2019
DESIGNED BY: XXX
DRAWN BY: XXX
CHECKED BY: XXX
DO NOT SCALE DRAWINGS

SHEET CONTENTS
CONSTRUCTION
SAFETY AND PHASING
PLANS - PHASE 2

SHEET NO.

G-082

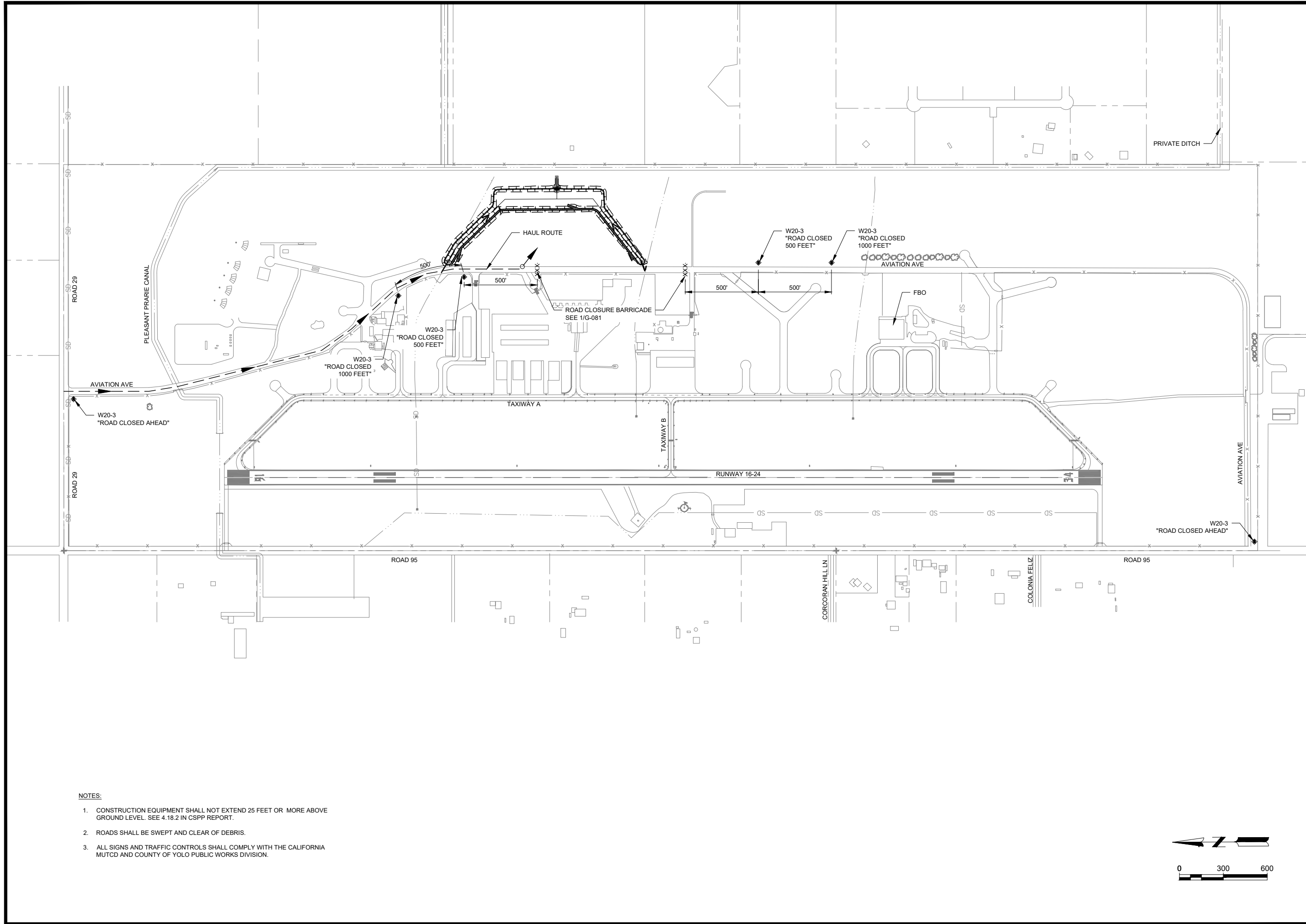

- NOTES:**
- CONSTRUCTION EQUIPMENT SHALL NOT EXTEND 25 FEET OR MORE ABOVE GROUND LEVEL. SEE 4.18.2 IN CSPP REPORT.
 - ROADS SHALL BE SWEEPED AND CLEAR OF DEBRIS.
 - ALL SIGNS AND TRAFFIC CONTROLS SHALL COMPLY WITH THE CALIFORNIA MUTCD AND COUNTY OF YOLO PUBLIC WORKS DIVISION.

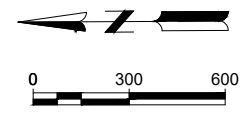

I:\CORP\MEADHUNT.COM\SHARED\FOLDERS\ENTP\2502000\170176.01\TECH\CAD\DRAWINGS\CONSTRUCTION SAFETY AND PHASING PLANS_PHE2.DWG
3/27/2019 2:43:28 PM

These documents shall not be used for any purpose or project for which it is not intended. Mead & Hunt shall be indemnified by the client and hold harmless and defend from all claims, damages, liabilities, losses, and expenses, including attorney's fees and costs, arising out of such misuse or reuse of the documents. In addition, unauthorized reproduction of these documents, in part or as a whole, is prohibited.

**YOLO COUNTY AIRPORT
AIRPORT DRAINAGE BASIN
IMPROVEMENTS**
WOODLAND, CA
WOODLAND, CA 95695

ISSUED

NOT FOR CONSTRUCTION

MSH NO.: 2502000-170176.01
DATE: MARCH 2019
DESIGNED BY: XXX
DRAWN BY: XXX
CHECKED BY: XXX
DO NOT SCALE DRAWINGS

SHEET CONTENTS
EROSION CONTROL
PLANS

SHEET NO.

C-021

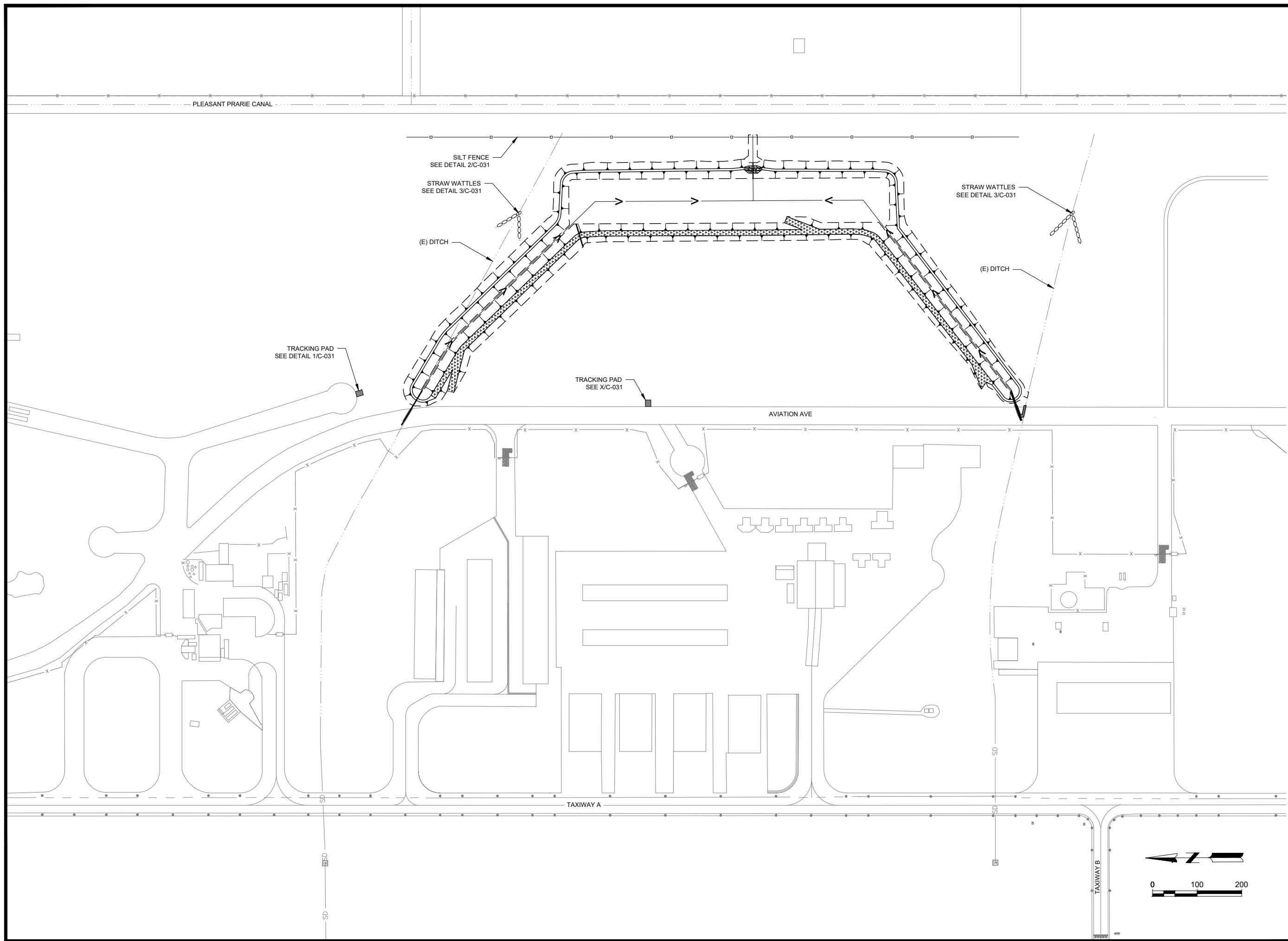

I:\CORP\MEADHUNT.COM\SHARED\FOLDERS\ENTP\2502000\170176.01\TECH\CAD\DRAWINGS\EROSION CONTROL PLANS.DWG
3/27/2019 2:43:43 PM

These documents shall not be used for any purpose or project for which it is not intended. Mead & Hunt shall be indemnified by the client and hold harmless and defend from all claims, damages, liabilities, losses, and expenses, including attorney's fees and costs, arising out of such misuse or reuse of the documents. In addition, unauthorized reproduction of these documents, in part or as a whole, is prohibited.

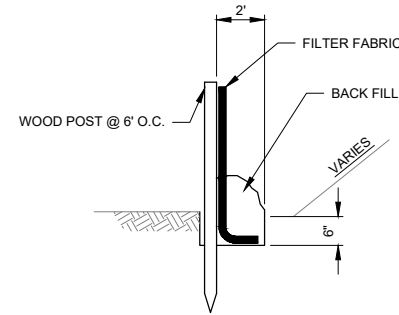

2 SILT FENCE
NO SCALE

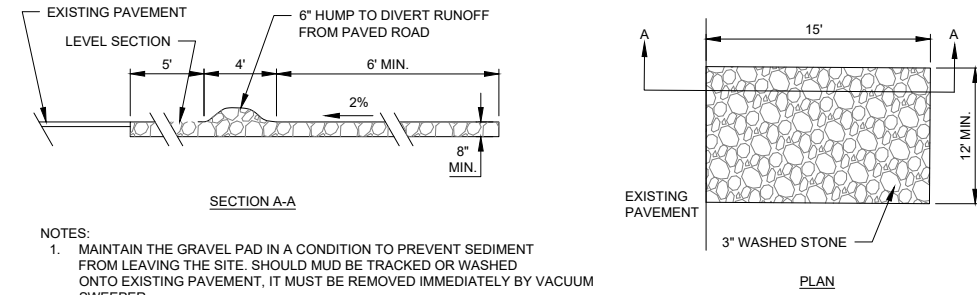

- NOTES:
1. MAINTAIN THE GRAVEL PAD IN A CONDITION TO PREVENT SEDIMENT FROM LEAVING THE SITE. SHOULD MUD BE TRACKED OR WASHED ONTO EXISTING PAVEMENT, IT MUST BE REMOVED IMMEDIATELY BY VACUUM SWEEPER.
 2. UPON COMPLETION REMOVE TRACKING PAD AND RESTORE TO ORIGINAL CONDITION.

1 TRACKING PAD
NO SCALE

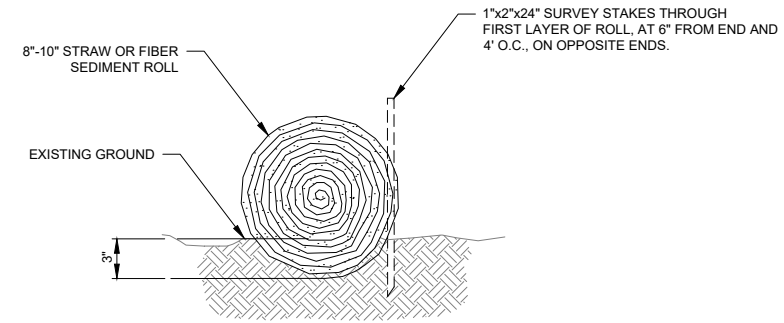

3 STRAW WATTLES
NO SCALE

**YOLO COUNTY AIRPORT
AIRPORT DRAINAGE BASIN
IMPROVEMENTS**
WOODLAND, CA
WOODLAND, CA 95695

ISSUED

NOT FOR CONSTRUCTION

MSH NO.: 2502000-170176.01
DATE: MARCH 2019
DESIGNED BY: XXX
DRAWN BY: XXX
CHECKED BY: XXX
DO NOT SCALE DRAWINGS

SHEET CONTENTS
EROSION CONTROL
DETAILS

SHEET NO.

C-031

These documents shall not be used for any purpose or project for which it is not intended. Mead & Hunt shall be indemnified by the client and hold harmless and defend from all claims, damages, liabilities, losses, and expenses, including attorney's fees and costs, arising out of such misuse or reuse of the documents. In addition, unauthorized reproduction of these documents, in part or as a whole, is prohibited.

**YOLO COUNTY AIRPORT
AIRPORT DRAINAGE BASIN
IMPROVEMENTS**
WOODLAND, CA
WOODLAND, CA 95695

ISSUED

NOT FOR CONSTRUCTION

MSH NO.: 2502000-170176.01
DATE: MARCH 2019
DESIGNED BY: XXX
DRAWN BY: XXX
CHECKED BY: XXX
DO NOT SCALE DRAWINGS

SHEET CONTENTS
DEMOLITION PLANS

SHEET NO.

C-051

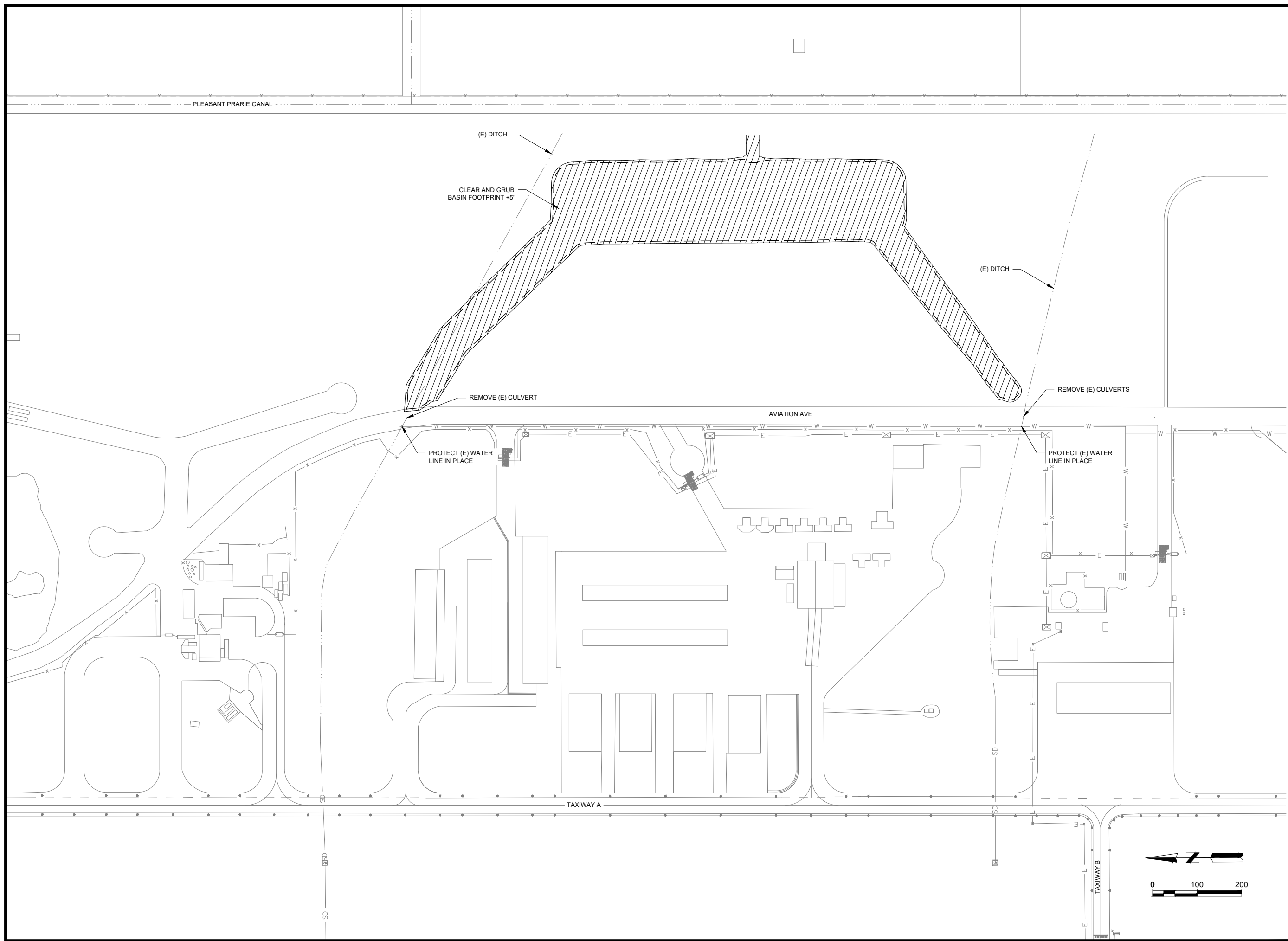

\\CORP-MEADHUNT.COM\SHARED\FOLDERS\ENTP\2502000\170176.01\TECH\CAD\DRAWINGS\DEMOLITION PLANS.DWG
3/27/2019 2:43:57 PM

These documents shall not be used for any purpose or project for which it is not intended. Mead & Hunt shall not be held liable for any damages, liabilities, losses, and expenses, including attorney's fees and costs, arising out of such misuse or reuse of the documents. In addition, unauthorized reproduction of these documents, in part or as a whole, is prohibited.

**YOLO COUNTY AIRPORT
AIRPORT DRAINAGE BASIN
IMPROVEMENTS**
WOODLAND, CA
WOODLAND, CA 95695

ISSUED

NOT FOR CONSTRUCTION

MSH NO. 2502000-170176.01
DATE MARCH 2019
DESIGNED BY: XXX
DRAWN BY: XXX
CHECKED BY: XXX
DO NOT SCALE DRAWINGS

SHEET CONTENTS
GRADING PLAN

SHEET NO.

C-101

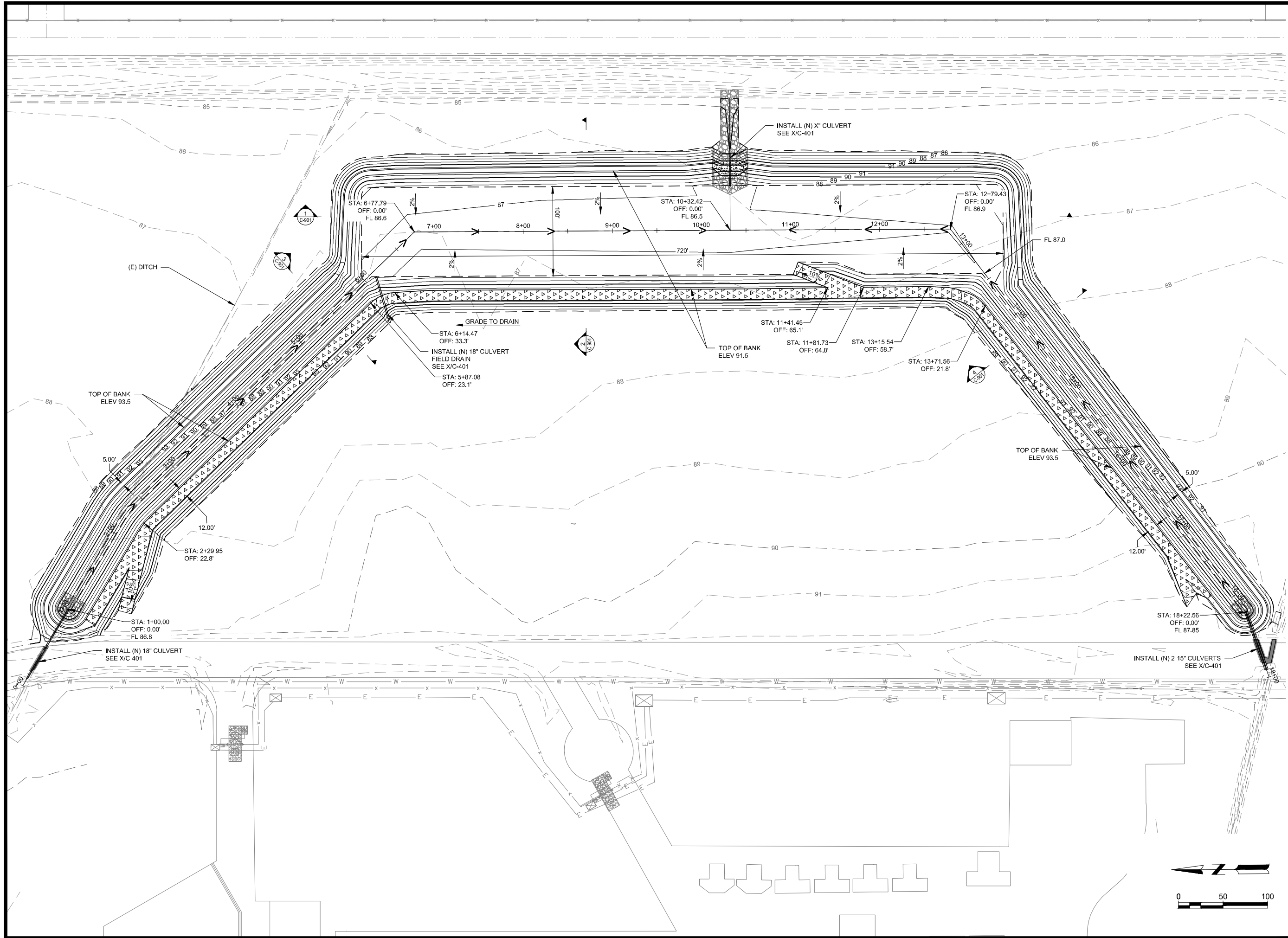

X:\2502000\170176.01\TECH\CAD\DRAWINGS\GRADING PLANS.DWG
3/27/2019 5:17:36 PM

These documents shall not be used for any purpose or project for which it is not intended. Mead & Hunt shall be indemnified by the client and hold harmless and defend from all claims, damages, liabilities, losses, and expenses, including attorney's fees and costs, arising out of such misuse or reuse of the documents. In addition, unauthorized reproduction of these documents, in part or as a whole, is prohibited.

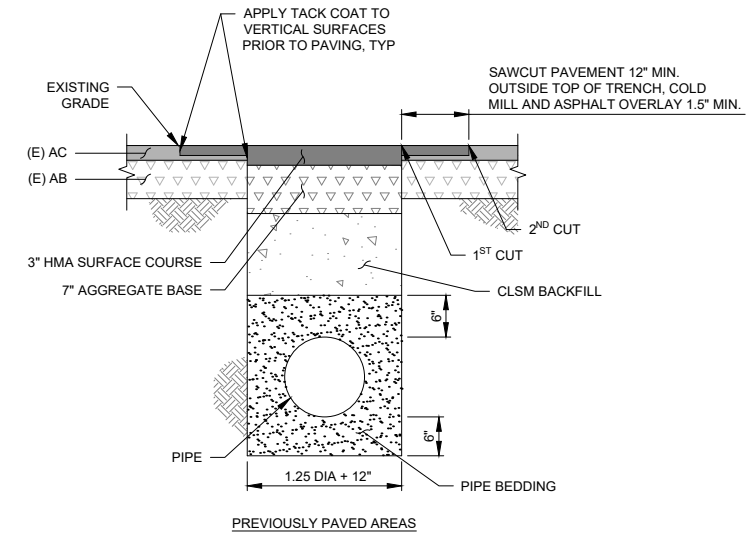

X PIPE TRENCHING
NO SCALE

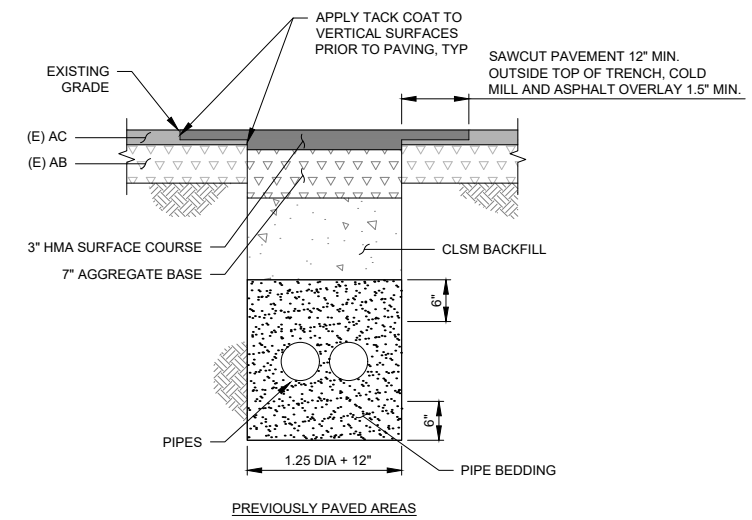

X PIPE TRENCHING
NO SCALE

**YOLO COUNTY AIRPORT
AIRPORT DRAINAGE BASIN
IMPROVEMENTS**
WOODLAND, CA
WOODLAND, CA 95695

ISSUED

NOT FOR CONSTRUCTION

MSH NO.: 2502000-170176.01
DATE: MARCH 2019
DESIGNED BY: XXX
DRAWN BY: XXX
CHECKED BY: XXX
DO NOT SCALE DRAWINGS

SHEET CONTENTS
TYPICAL SECTIONS

SHEET NO.

These documents shall not be used for any purpose or project for which it is not intended. Mead & Hunt shall be indemnified by the client and hold harmless and outendowed from all claims, damages, liabilities, losses, and expenses, including attorney's fees and costs, arising out of such misuse or reuse of the documents. In addition, unauthorized reproduction of these documents, in part or as a whole, is prohibited.

**YOLO COUNTY AIRPORT
AIRPORT DRAINAGE BASIN
IMPROVEMENTS**
WOODLAND, CA
WOODLAND, CA 95695

ISSUED

NOT FOR CONSTRUCTION

MSH NO.: 2502000-170176.01
DATE: MARCH 2019
DESIGNED BY: XXX
DRAWN BY: XXX
CHECKED BY: XXX
DO NOT SCALE DRAWINGS

SHEET CONTENTS
DRAINAGE PLAN &
PROFILES

SHEET NO.

C-401

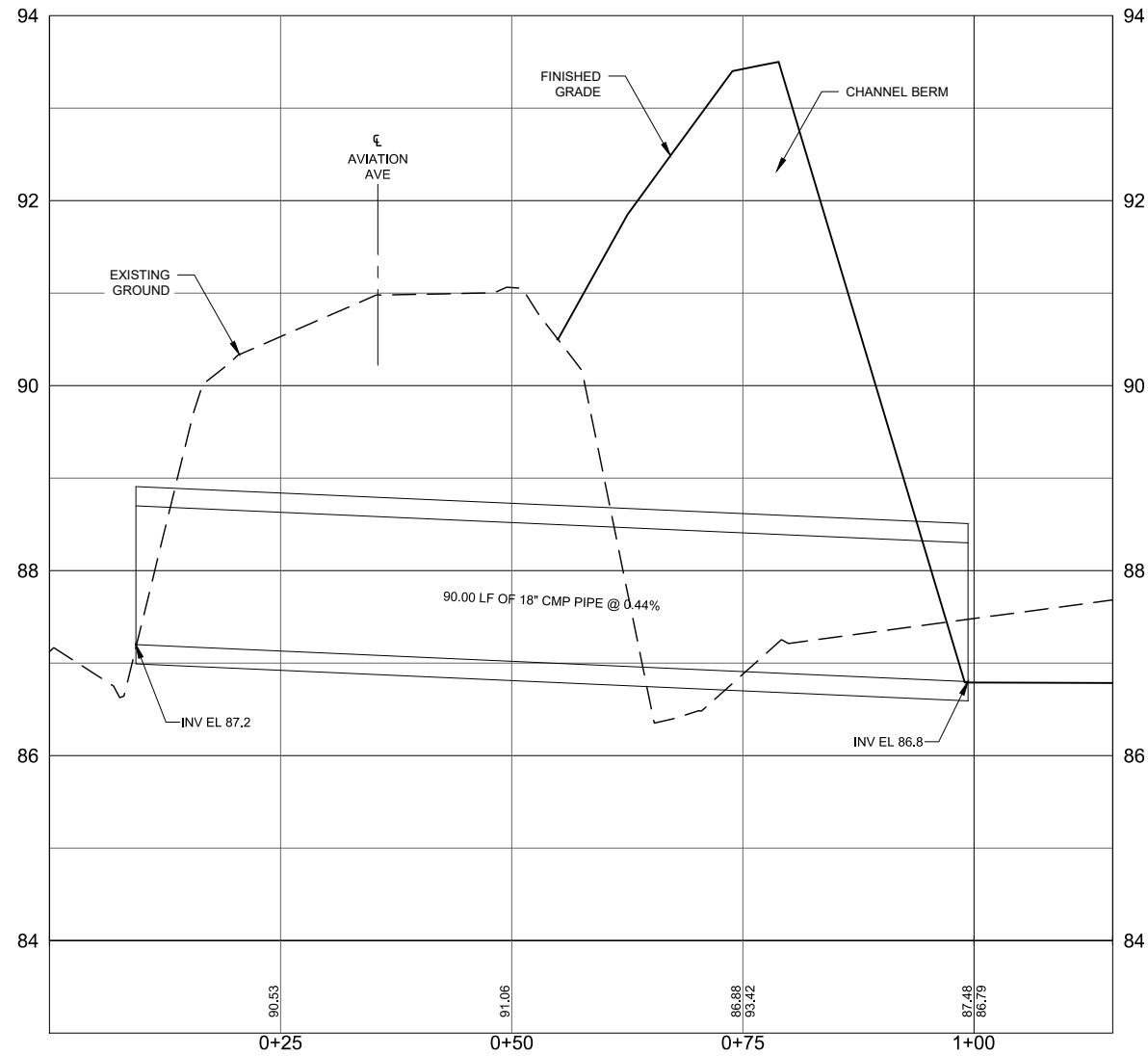
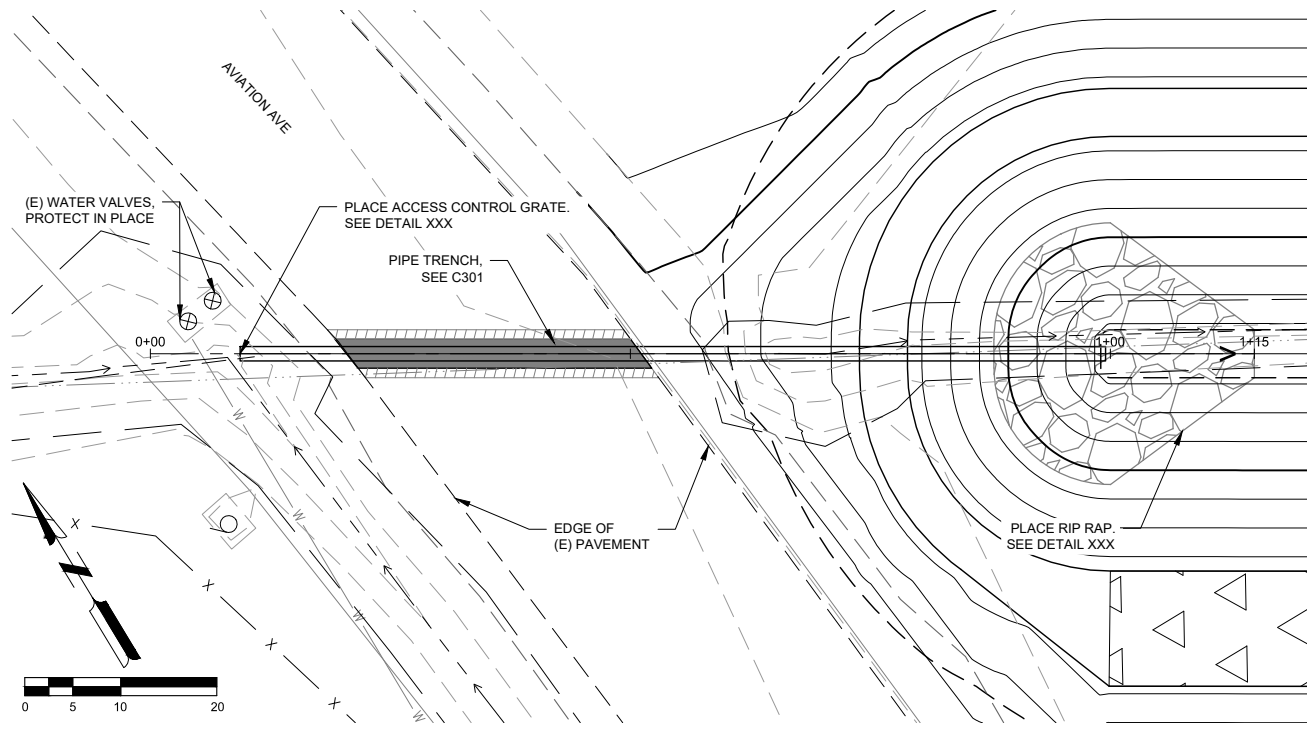
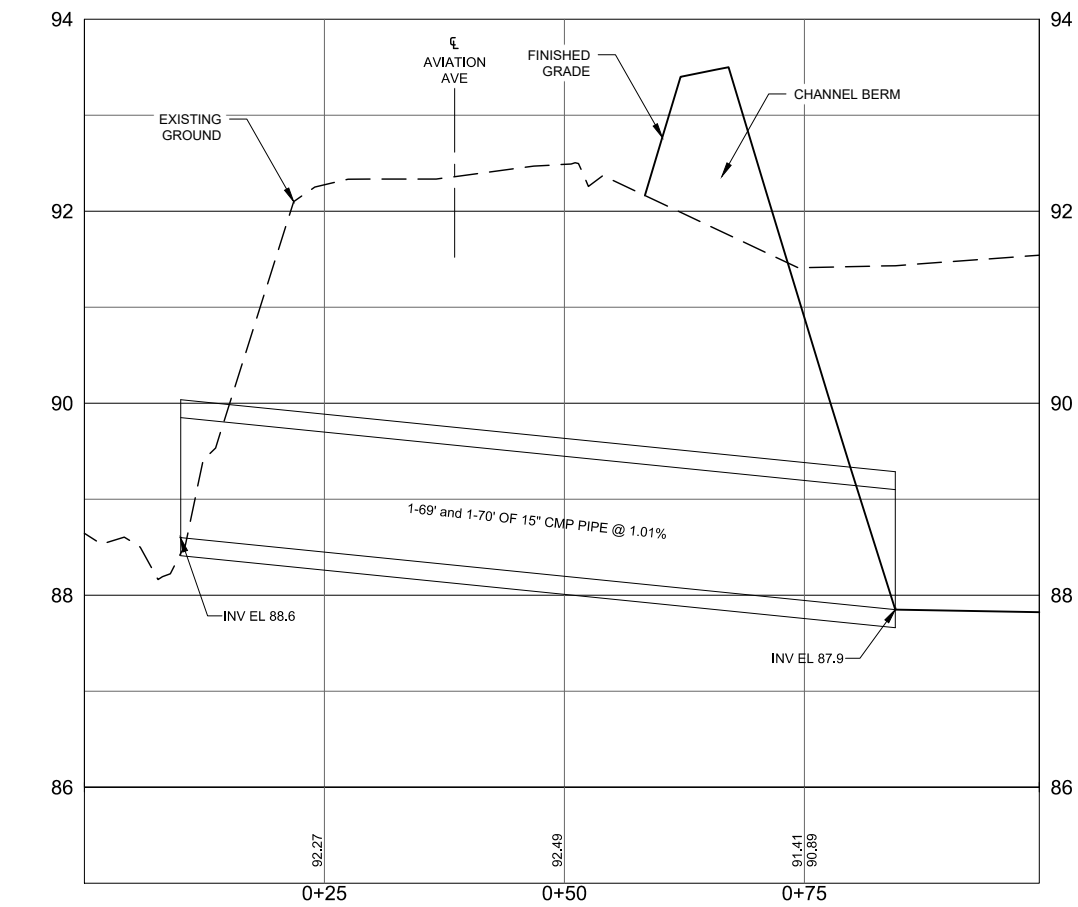
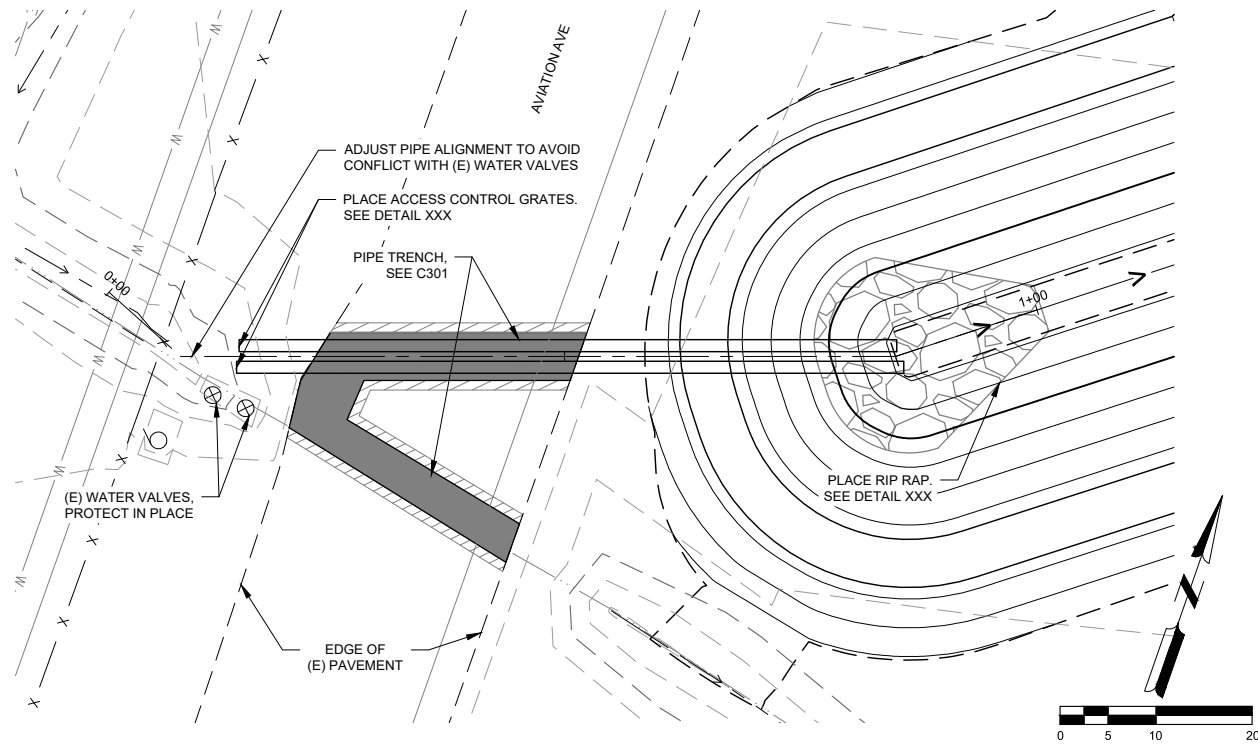

These documents shall not be used for any purpose or project for which it is not intended. Mead & Hunt shall be indemnified by the client and hold harmless and outendowed from all claims, damages, liabilities, losses, and expenses, including attorney's fees and costs, arising out of such misuse or reuse of the documents. In addition, unauthorized reproduction of these documents, in part or as a whole, is prohibited.

**YOLO COUNTY AIRPORT
AIRPORT DRAINAGE BASIN
IMPROVEMENTS**
WOODLAND, CA
WOODLAND, CA 95695

ISSUED

NOT FOR CONSTRUCTION

MSH NO.: 2502000-170176.01
DATE: MARCH 2019
DESIGNED BY: XXX
DRAWN BY: XXX
CHECKED BY: XXX
DO NOT SCALE DRAWINGS

SHEET CONTENTS
DRAINAGE PLAN &
PROFILES

SHEET NO.

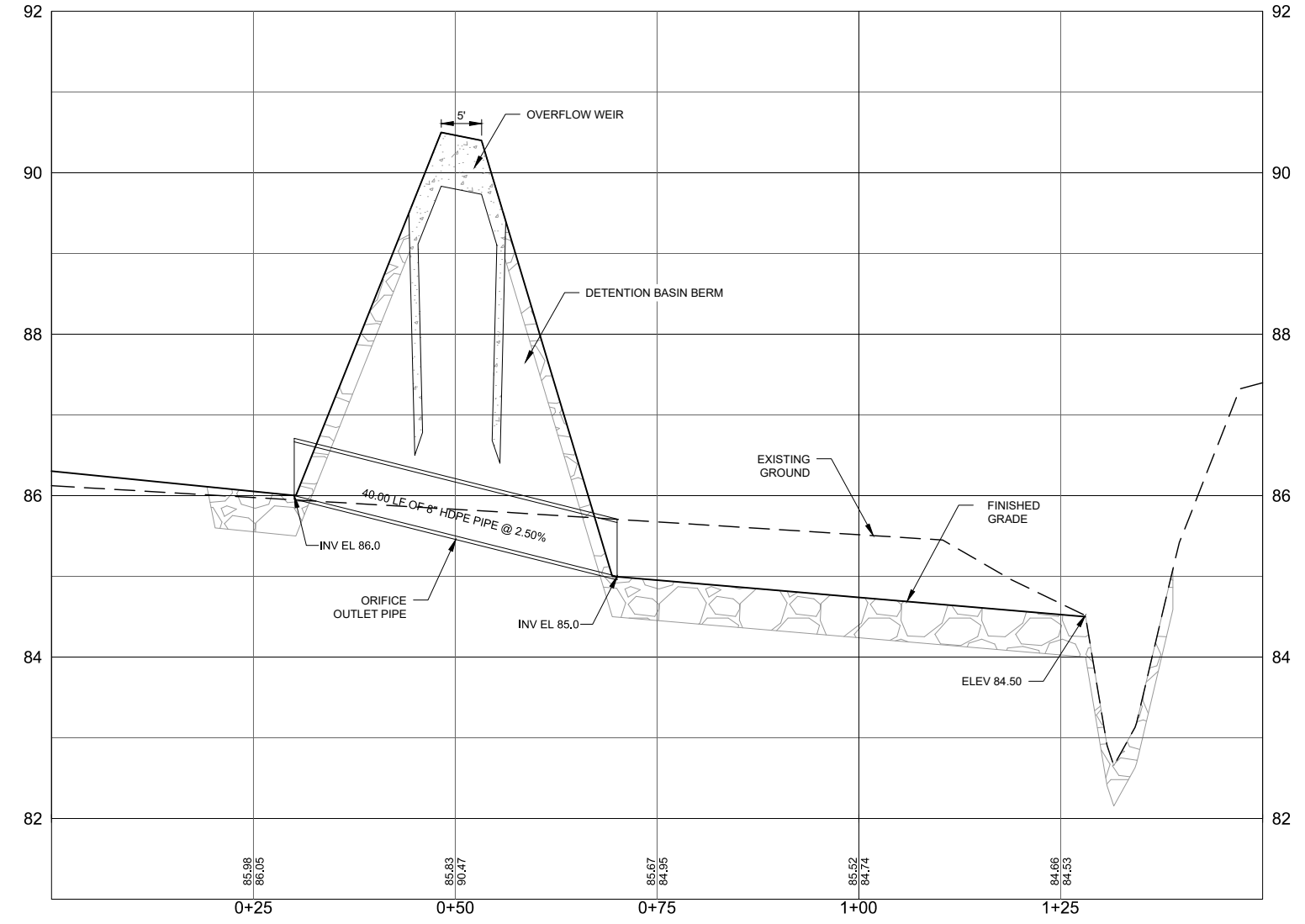
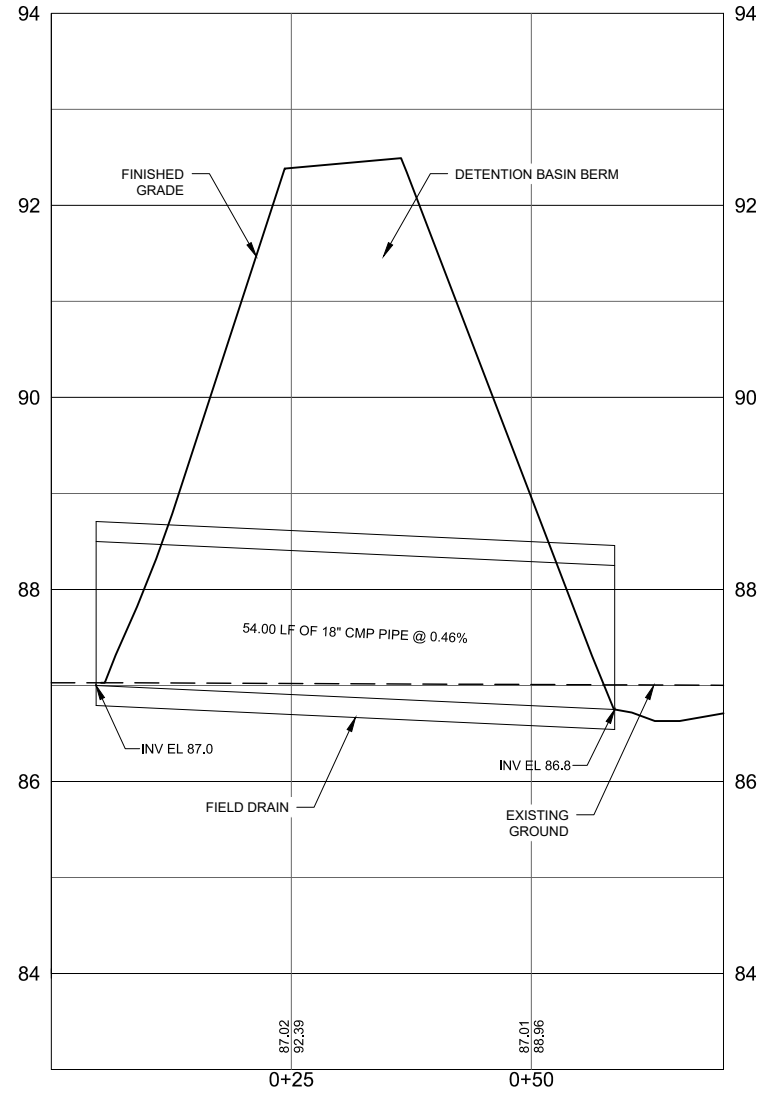
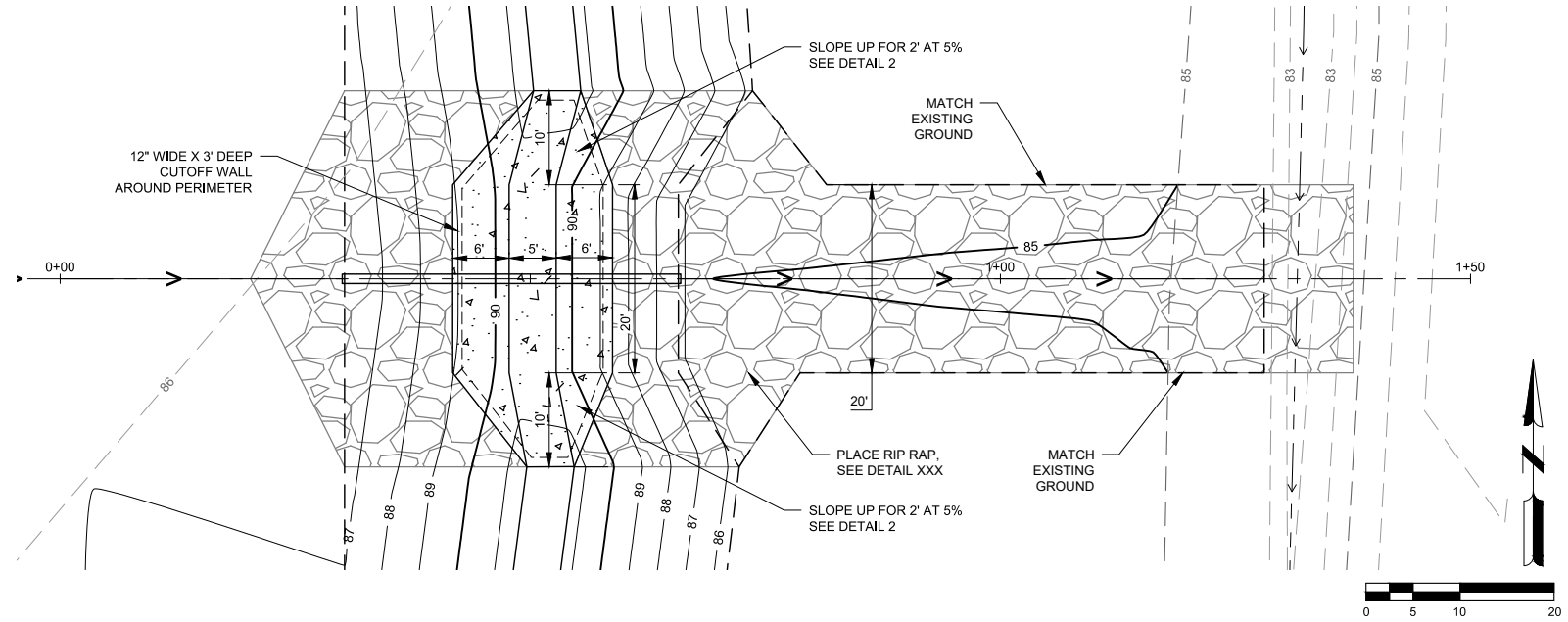
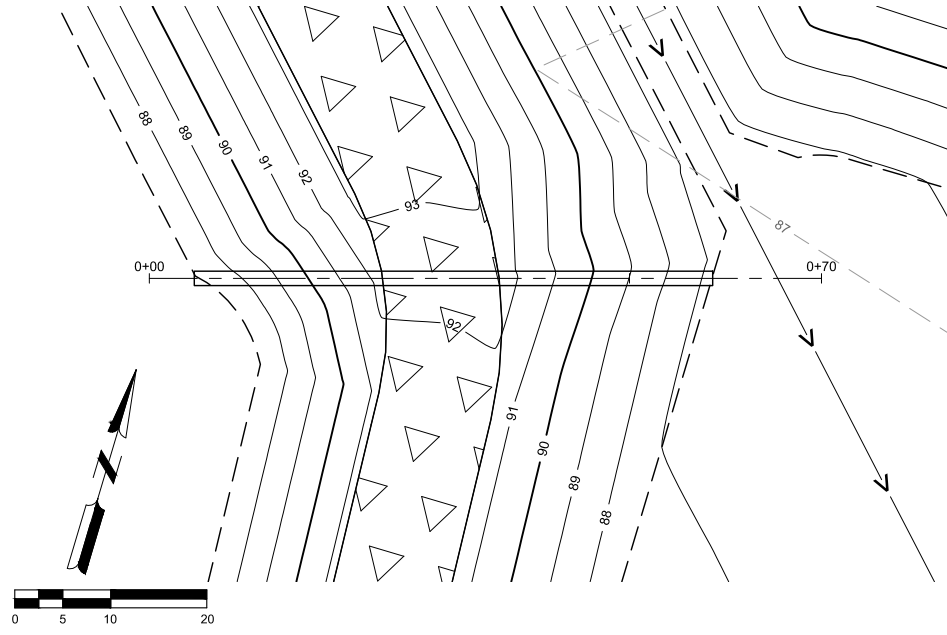

\\CORP-MEADHUNT.COM\SHARED\FOLDERS\ENR\2502000\170176.01\TECH\CAD\DRAWINGS\DRAINAGE DETAILS.DWG
3/27/2019 2:45:08 PM

These documents shall not be used for any purpose or project for which it is not intended. Mead & Hunt shall be indemnified by the client and hold harmless and defend from all claims, damages, liabilities, losses, and expenses, including attorney's fees and costs, arising out of such misuse or reuse of the documents. In addition, unauthorized reproduction of these documents, in part or as a whole, is prohibited.

**YOLO COUNTY AIRPORT
AIRPORT DRAINAGE BASIN
IMPROVEMENTS**
WOODLAND, CA
WOODLAND, CA 95695

ISSUED

NOT FOR CONSTRUCTION

MSH NO.: 2502000-170176.01
DATE: MARCH 2019
DESIGNED BY: XXX
DRAWN BY: XXX
CHECKED BY: XXX
DO NOT SCALE DRAWINGS

SHEET CONTENTS
DRAINAGE DETAILS

SHEET NO.

C-451

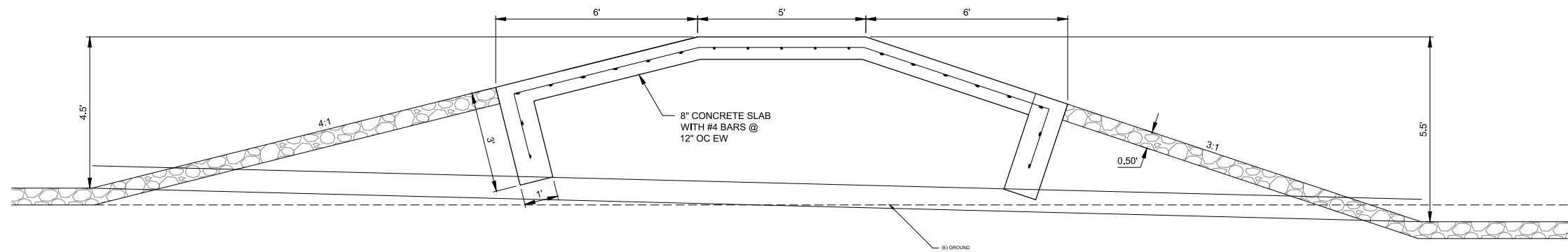
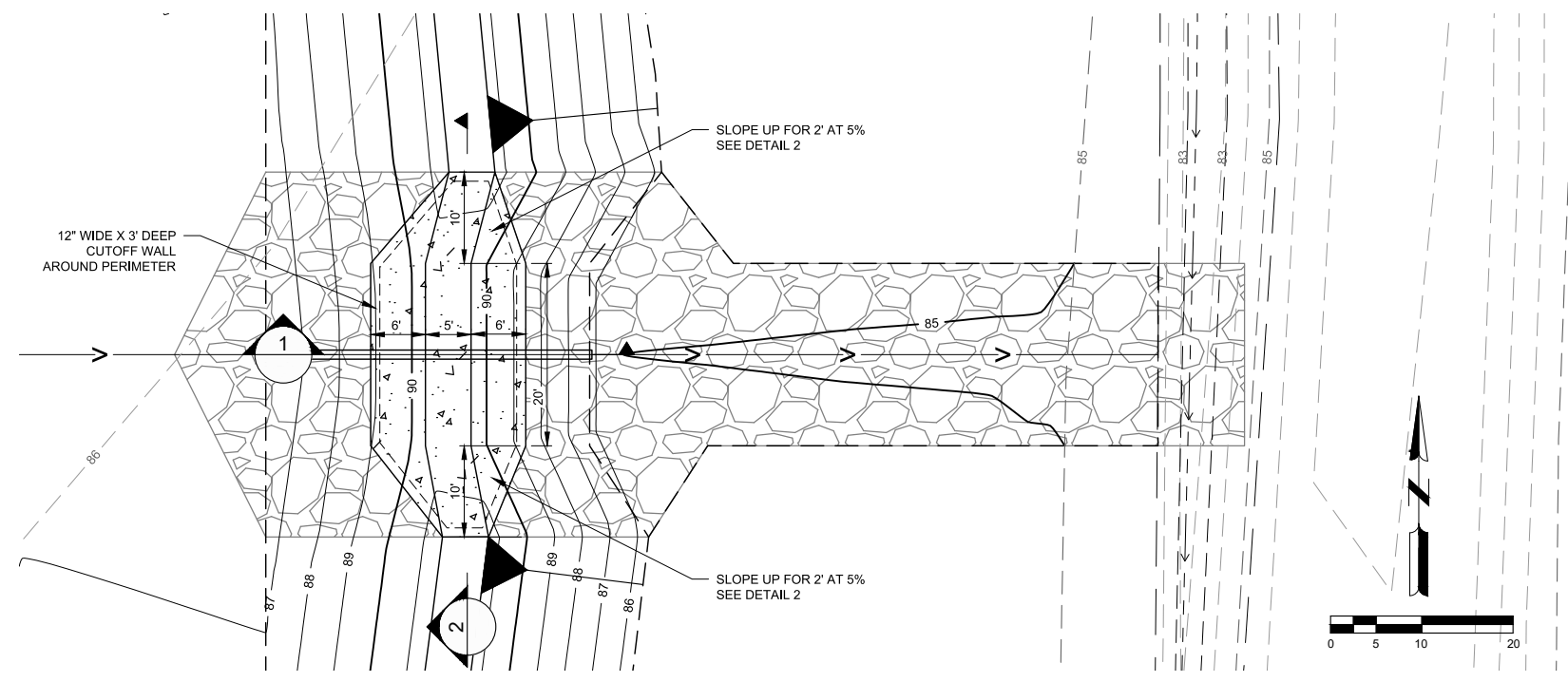

1 SPILLWAY SECTION
SCALE: 1"=2'

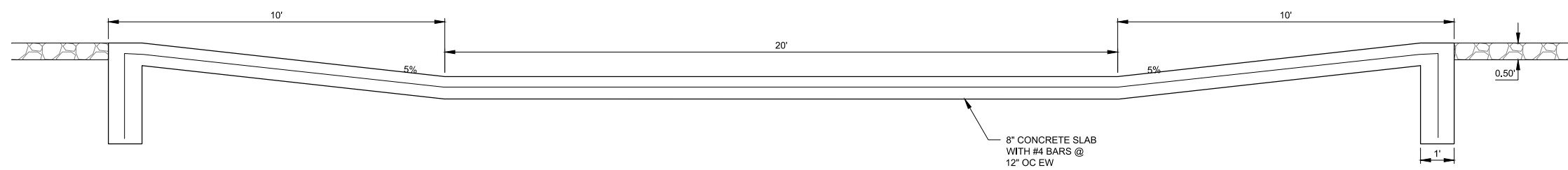

2 SPILLWAY SECTION
SCALE: 1"=2'

These documents shall not be used for any purpose or project for which it is not intended. Mead & Hunt shall not be held liable for any errors, omissions, or damages, including those caused by the use of these documents. In addition, unauthorized reproduction of these documents, in part or as a whole, is prohibited.

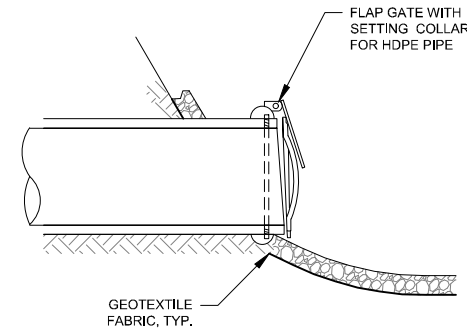

2 ORIFICE CULVERT FLAP GATE
NOT TO SCALE

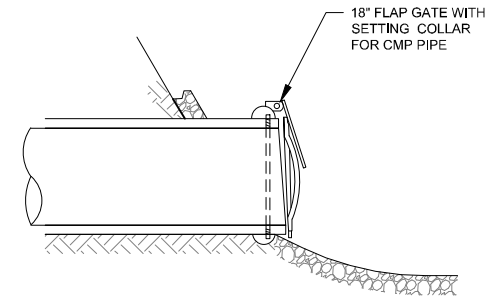

1 FIELD DRAIN CULVERT FLAP GATE
NOT TO SCALE

**YOLO COUNTY AIRPORT
AIRPORT DRAINAGE BASIN
IMPROVEMENTS**
WOODLAND, CA
WOODLAND, CA 95695

ISSUED

NOT FOR CONSTRUCTION

MSH NO. 2502000-170176.01
DATE MARCH 2019
DESIGNED BY: XXX
DRAWN BY: XXX
CHECKED BY: XXX
DO NOT SCALE DRAWINGS

SHEET CONTENTS
DRAINAGE DETAILS

SHEET NO.

C-452

These documents shall not be used for any purpose or project for which it is not intended. Mead & Hunt shall be indemnified by the client and hold harmless and outended from all claims, damages, liabilities, losses, and expenses, including attorney's fees and costs, arising out of such misuse or reuse of the documents. In addition, unauthorized reproduction of these documents, in part or as a whole, is prohibited.

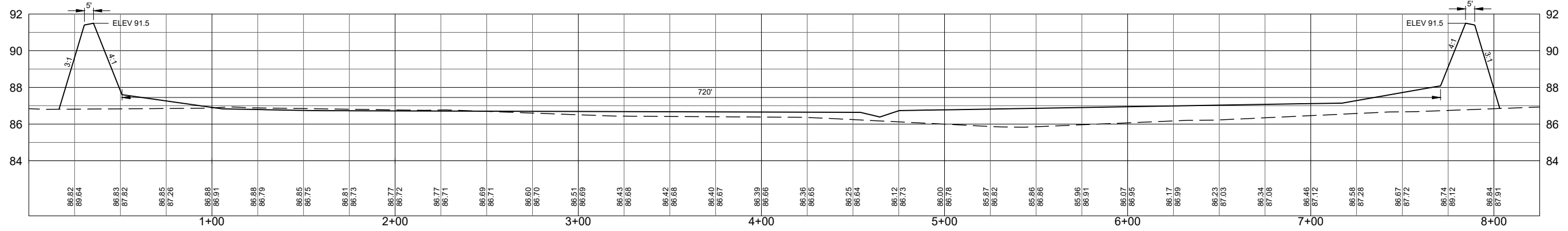

1 NORTH-SOUTH BASIN SECTION
H SCALE: 1"= 30' V SCALE: 1"= 3'

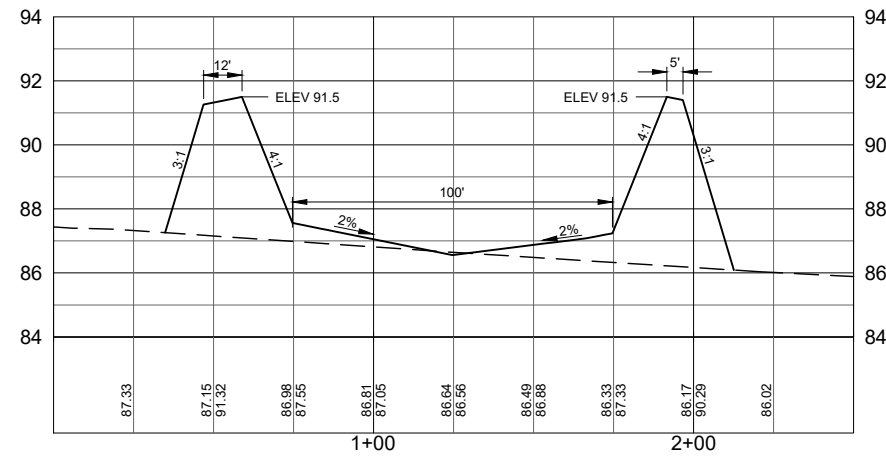

2 EAST-WEST BASIN SECTION
H SCALE: 1"= 30' V SCALE: 1"= 3'

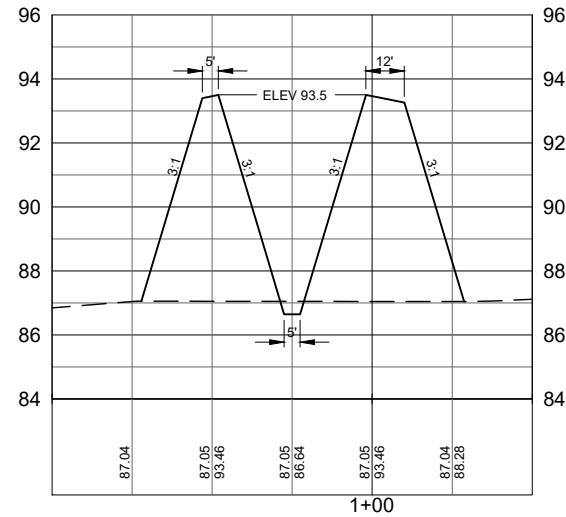

3 NORTHERN CANAL
H SCALE: 1"= 30' V SCALE: 1"= 3'

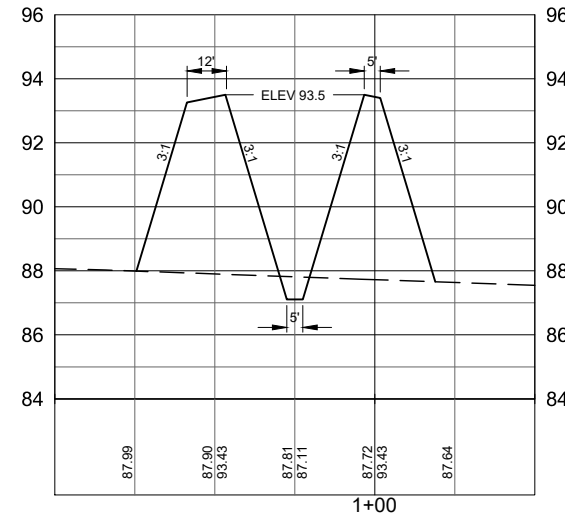

4 SOUTHERN CANAL
H SCALE: 1"= 30' V SCALE: 1"= 3'

**YOLO COUNTY AIRPORT
AIRPORT DRAINAGE BASIN
IMPROVEMENTS**
WOODLAND, CA
WOODLAND, CA 95695

ISSUED

NOT FOR CONSTRUCTION

MSH NO.: 2502000-170176.01
DATE: MARCH 2019
DESIGNED BY: XXX
DRAWN BY: XXX
CHECKED BY: XXX
DO NOT SCALE DRAWINGS

SHEET CONTENTS
CROSS SECTIONS

SHEET NO.

These documents shall not be used for any purpose or project for which it is not intended. Mead & Hunt shall be indemnified by the client and hold harmless and defend from all claims, damages, liabilities, losses, and expenses, including attorney's fees and costs, arising out of such misuse or reuse of the documents. In addition, unauthorized reproduction of these documents, in part or as a whole, is prohibited.

YOLO COUNTY AIRPORT AIRPORT DRAINAGE BASIN IMPROVEMENTS

WOODLAND, CA
WOODLAND, CA 95695

ISSUED

NOT FOR CONSTRUCTION

MSH NO.: 2502000-170176.01
DATE: MARCH 2019
DESIGNED BY: XXX
DRAWN BY: XXX
CHECKED BY: XXX
DO NOT SCALE DRAWINGS

SHEET CONTENTS
STRUCTURAL LAYOUT
PLAN

SHEET NO.

S-021

