

- NOTES:**
- ELEVATIONS AND DISTANCES ARE APPROXIMATE. EXISTING GROUND IS BASED ON AERIAL TOPOGRAPHY FLOWN IN APRIL 2010 BY POINT CO. PHOTOGRAMMETRIC SERVICES.
  - HIGH AND LOW AVERAGE GROUNDWATER ELEVATIONS BASED ON "GROUNDWATER CONDITIONS IN VICINITY OF PLANNED WET-PIT MINING OPERATIONS-SCHWARZGRUBER PROPERTY" BY LUHDORFF & SCALMANINI CONSULTING ENGINEERS DATED APRIL 25, 2011.
  - BERMS OR V-DITCHES (NOT SHOWN) TO BE ADDED ALONG THE TOP OF SLOPES AS NECESSARY TO KEEP SURFACE RUNOFF FROM ADJACENT AREAS FROM ENTERING INTO THE DESIGNATED OPEN WATER AREAS.
  - BOTTOM MINING ELEVATIONS ARE ±10' DEPENDING ON ACTUAL BOTTOM OF GRAVEL DEPTHS.
  - EXISTING STOCKPILES ARE TO BE RE-GRADED OR REMOVED FROM THE SITE. PROPOSED MINING SLOPES SHOWN ON PLAN AND SECTIONS REPRESENT CONDITIONS AFTER THE STOCKPILES HAVE BEEN REMOVED OR RE-GRADED.
  - PROPOSED CONTOURS SHOWN AT 5' INTERVAL.
  - WELLS NOTED TO BE ABANDONED SHALL BE ABANDONED PER YOLO COUNTY DEPARTMENT OF ENVIRONMENTAL HEALTH STANDARDS.
  - TOPSOIL AND OVERBURDEN STOCKPILE SHALL BE SLOPED AND VEGETATED PER SECTION 10-4.433 OF THE MINING ORDINANCE.
  - SEE RECLAMATION SUMMARY FOR LANDSCAPE EXHIBITS.

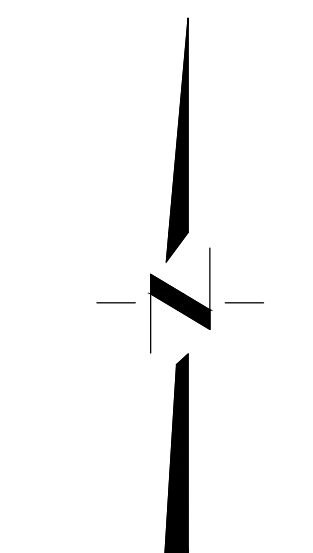

DESIGNED BY	NC	NO.	DATE	REVISIONS	BY	APPD.
DRAWN BY	LR					
CHECKED BY	SG					
SCALE	AS SHOWN					

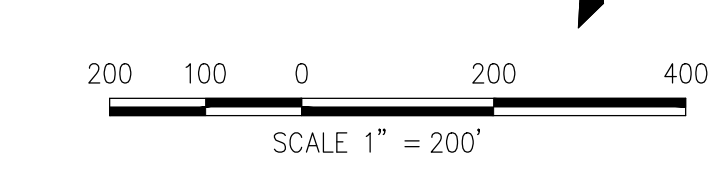
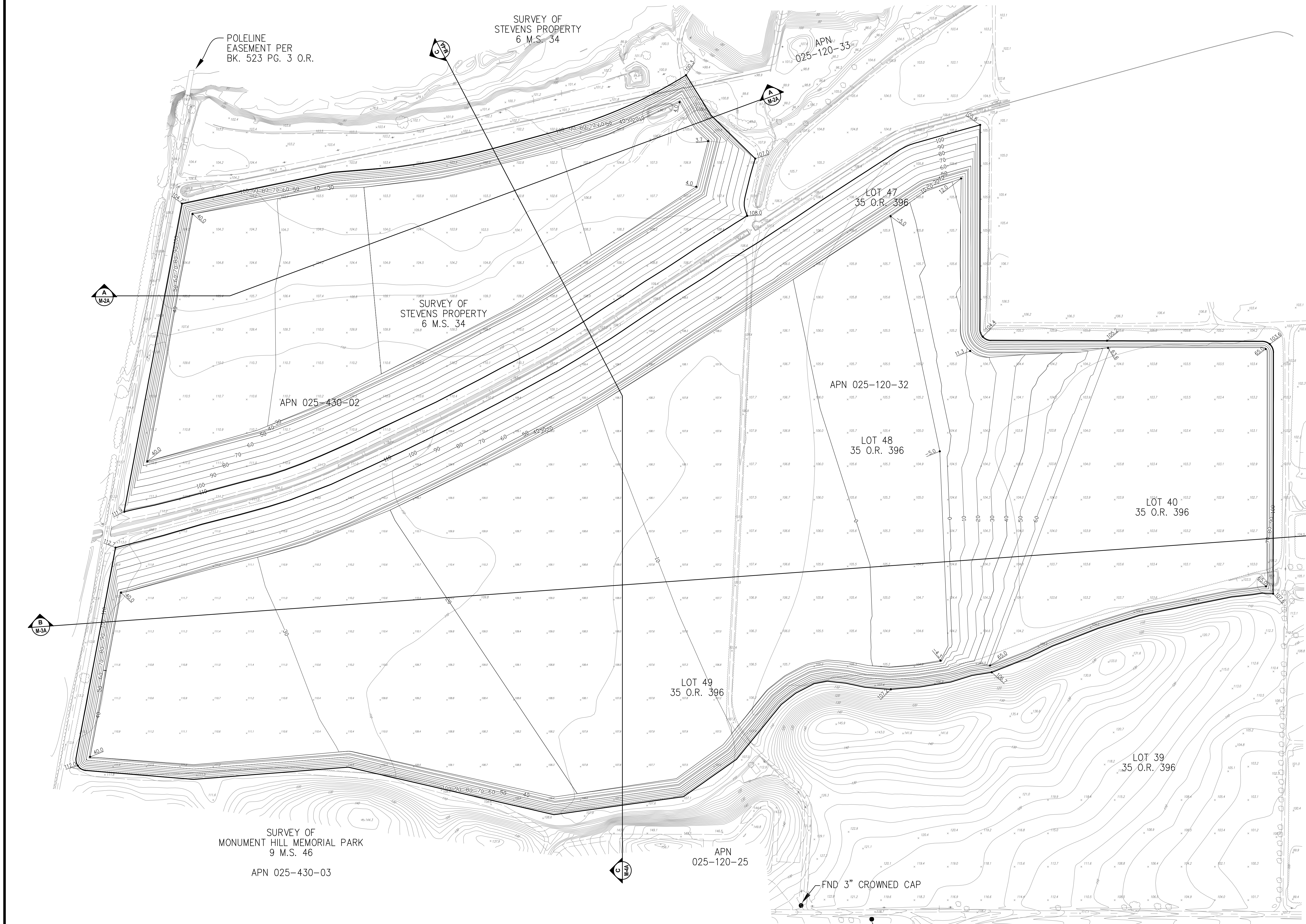
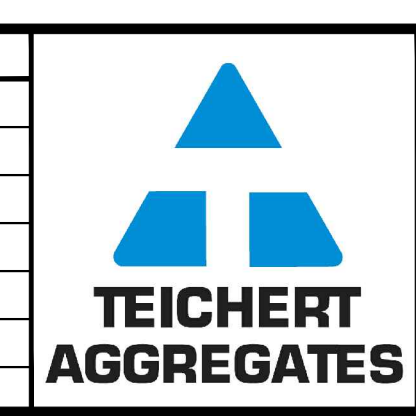

**CUNNINGHAM ENGINEERING**

Project Planning • Civil Engineering • Landscape Architecture

Sacramento Office  
2120 20th Street, Suite Three  
Sacramento, CA 95818  
(916) 455-2126

Devis Office  
2940 Spafford Street, Suite 200  
Davis, CA 95618  
(530) 758-2026

CECWEST.COM

YOLO COUNTY CALIFORNIA

**SHIFLER MINING PLAN**  
**SITE PLAN**  
**ALTERNATE A**

SHEET  
**M-1A**  
OF  
**4**

DATE: 3/25/14

JOB NO: 1129.20

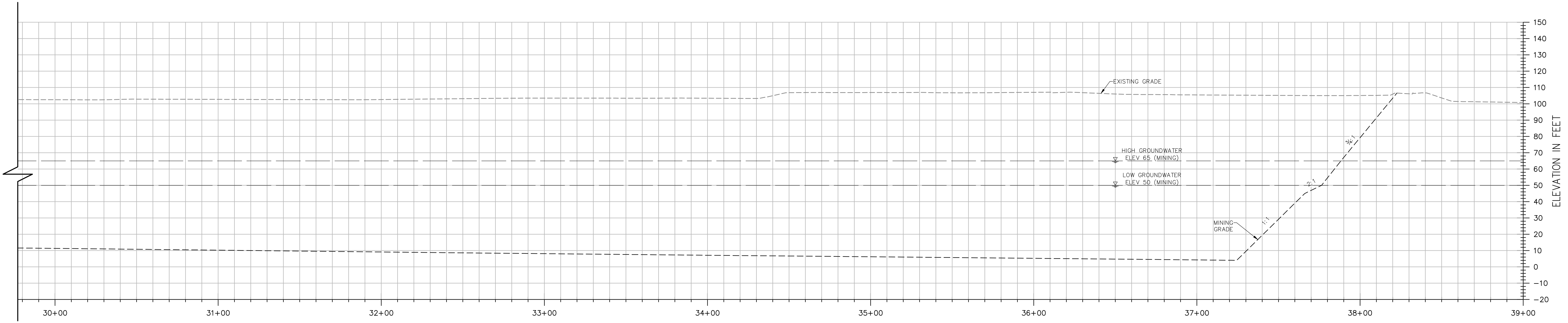
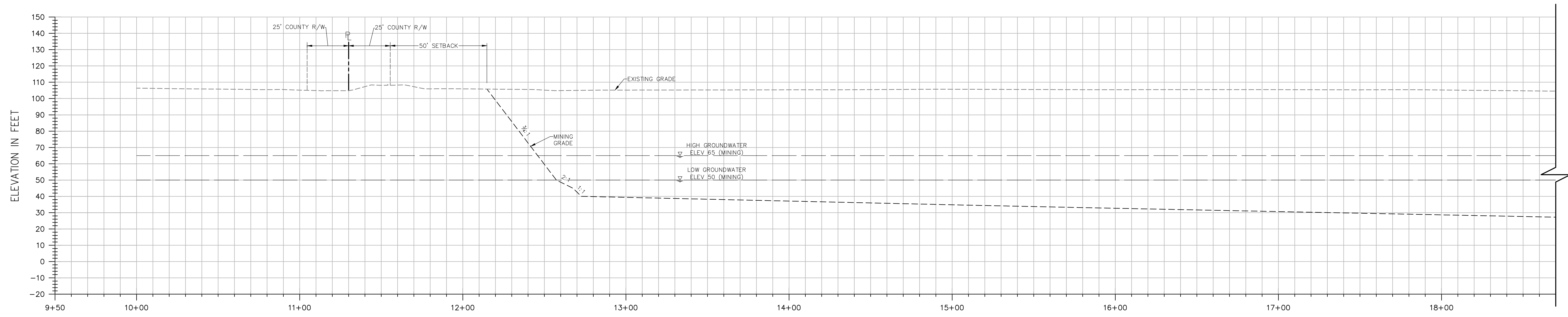

**SECTION A-A**

H: 1"=30'  
V: 1"=30'

**NOTES:**

- ELEVATIONS AND DISTANCES ARE APPROXIMATE. EXISTING GROUND IS BASED ON AERIAL TOPOGRAPHY FLOWN IN APRIL 2010 BY POINT CO. PHOTOGRAMMETRIC SERVICES.
- HIGH AND LOW AVERAGE GROUNDWATER ELEVATIONS BASED ON "GROUNDWATER CONDITIONS IN VICINITY OF PLANNED WET-PIT MINING OPERATIONS-SCHWARZGRUBER PROPERTY", BY LUHDORFF & SCALMANINI CONSULTING ENGINEERS DATED APRIL 25, 2011.
- BERMS OR V-DITCHES TO BE ADDED ALONG THE TOP OF SLOPES AS NECESSARY TO KEEP SURFACE RUNOFF FROM ADJACENT AREAS FROM ENTERING INTO THE DESIGNATED OPEN WATER AREAS.
- BOTTOM MINING ELEVATIONS ARE ±10' DEPENDING ON ACTUAL BOTTOM OF GRAVEL DEPTHS.
- EXISTING STOCKPILES ARE TO BE RE-GRADED OR REMOVED FROM THE SITE. PROPOSED MINING SLOPES SHOWN ON PLAN AND SECTIONS REPRESENT CONDITIONS AFTER THE STOCKPILES HAVE BEEN REMOVED OR RE-GRADED.

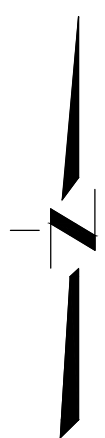
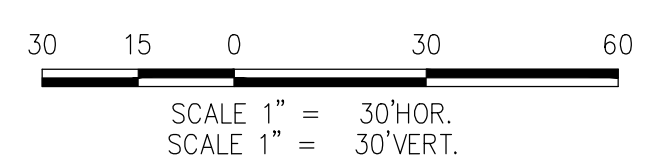

DESIGNED BY	NO.	DATE	REVISIONS	BY	APPD.
NC					
DRAWN BY					
LR					
CHECKED BY					
SG					
SCALE					
AS SHOWN					

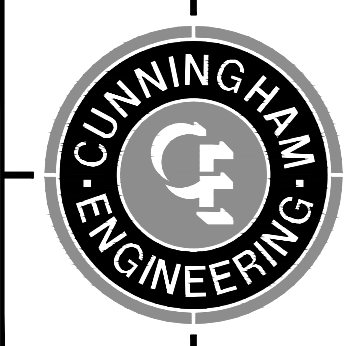

CECWEST.COM  
Project Planning ■ Civil Engineering ■ Landscape Architecture  
Sacramento Office: 2120 20th Street, Suite Three, Sacramento, CA 95818, (916) 455-2026  
Davis Office: 2940 Spafford Street, Suite 200, Davis, CA 95618, (530) 758-2026

**SHIFLER MINING PLAN  
CROSS SECTION A-A  
ALTERNATE A**

SHEET  
**M-2A**  
OF  
**4**  
DATE: 3/25/14  
JOB NO: 1129.20

YOLO COUNTY

CALIFORNIA

S:\Projects\11029\1129 - Teichert - Aggregate\AutoCAD\1129-20 SHF Mining and Reclamation Plan\SHEETS\A-A\1129-20-MIN-ALTEA-SEC-A-A.dwg - NS253 - 3/25/2014 - 10:55AM Printed by: bna

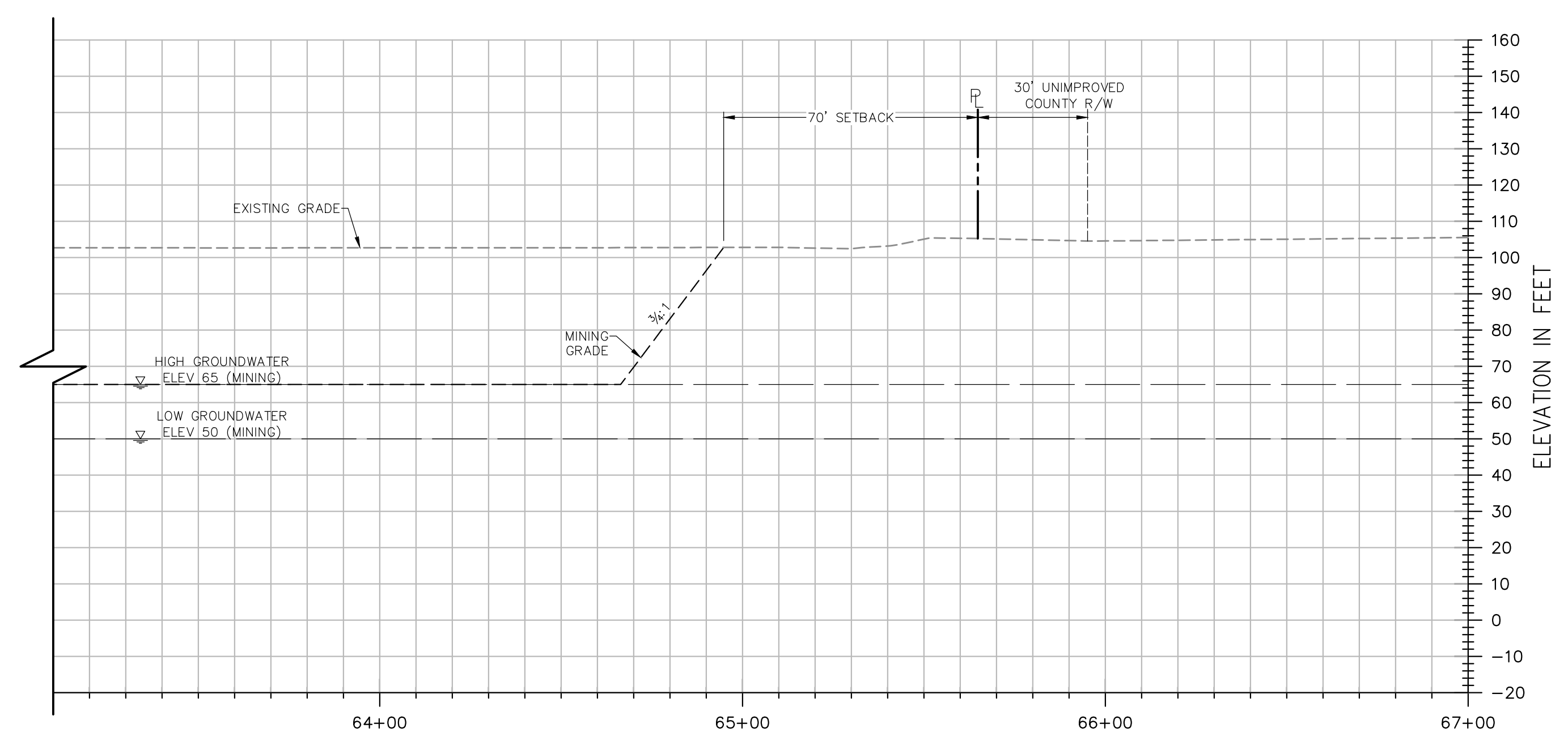
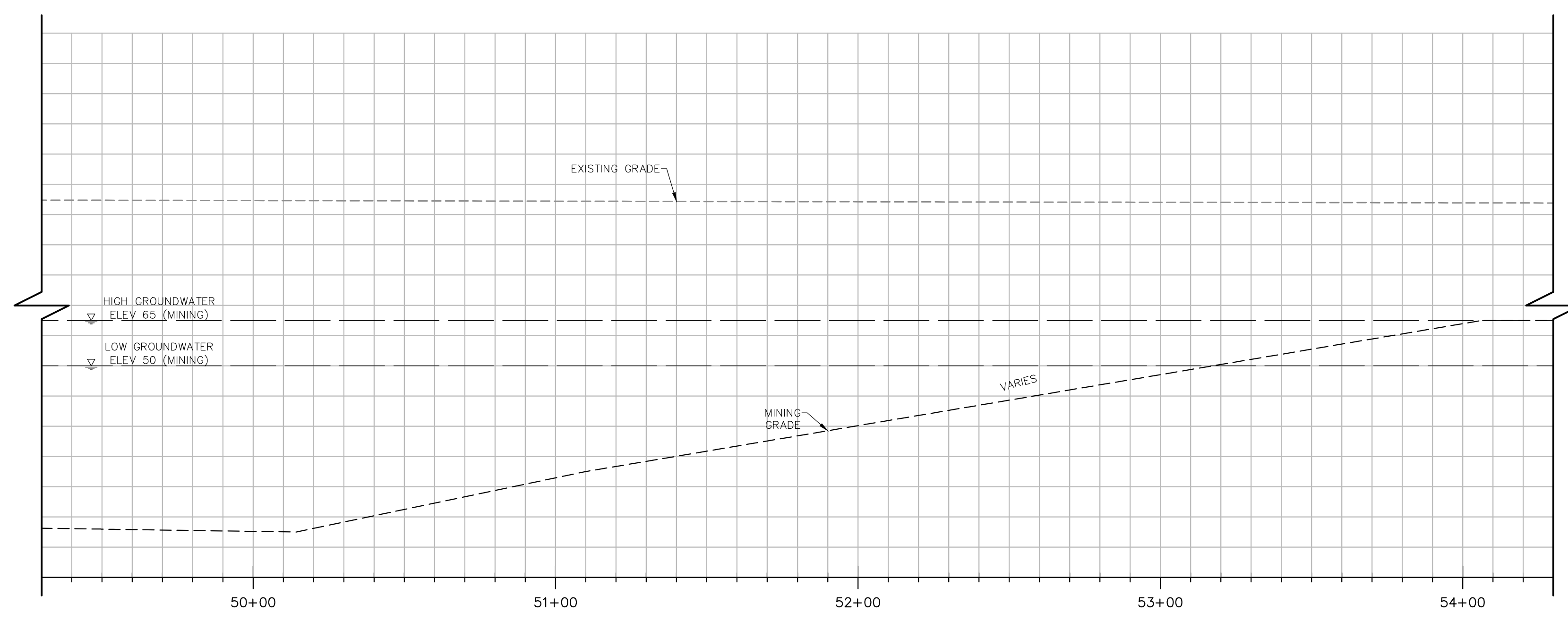
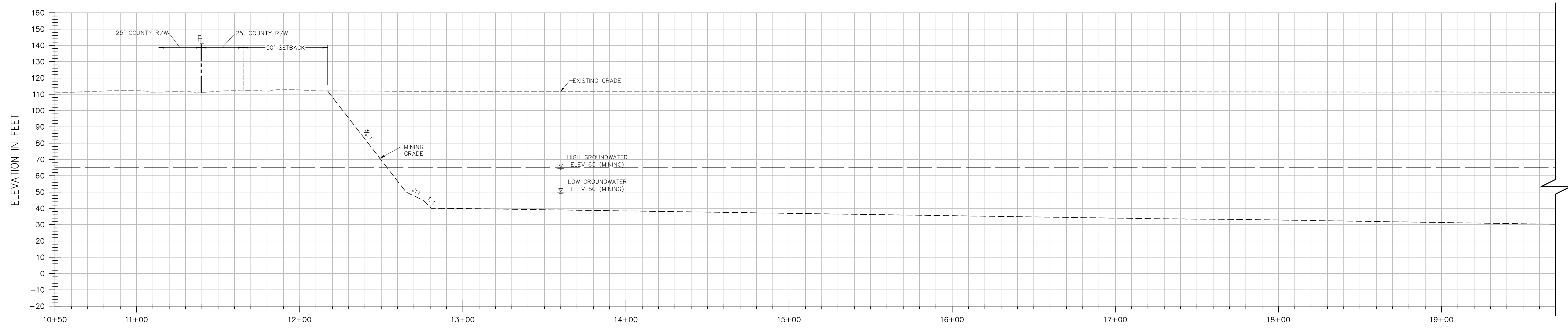

**SECTION B-B**

H: 1"=30'  
V: 1"=30'

**NOTES:**

- ELEVATIONS AND DISTANCES ARE APPROXIMATE. EXISTING GROUND IS BASED ON AERIAL TOPOGRAPHY FLOWN IN APRIL 2010 BY POINT CO. PHOTOGRAMMETRIC SERVICES.
- HIGH AND LOW AVERAGE GROUNDWATER ELEVATIONS BASED ON "GROUNDWATER CONDITIONS IN VICINITY OF PLANNED WET-PIT MINING OPERATIONS-SCHWARZGRUBER PROPERTY", BY LUHDORFF & SCALMANINI CONSULTING ENGINEERS DATED APRIL 25, 2011.
- BERMS OR V-DITCHES TO BE ADDED ALONG THE TOP OF SLOPES AS NECESSARY TO KEEP SURFACE RUNOFF FROM ADJACENT AREAS FROM ENTERING INTO THE DESIGNATED OPEN WATER AREAS.
- BOTTOM MINING ELEVATIONS ARE ±10' DEPENDING ON ACTUAL BOTTOM OF GRAVEL DEPTHS.
- EXISTING STOCKPILES ARE TO BE RE-GRADED OR REMOVED FROM THE SITE. PROPOSED MINING SLOPES SHOWN ON PLAN AND SECTIONS REPRESENT CONDITIONS AFTER THE STOCKPILES HAVE BEEN REMOVED OR RE-GRADED.

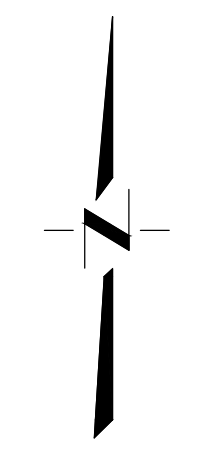
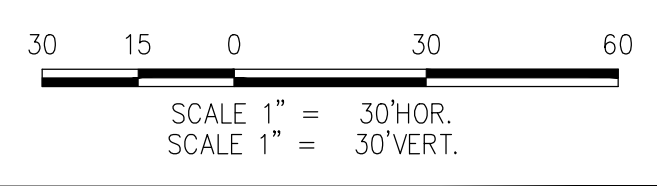

DESIGNED BY <u>NC</u>	NO.	DATE	REVISIONS	BY	APPD.
DRAWN BY <u>LR</u>					
CHECKED BY <u>SG</u>					
SCALE					
AS SHOWN					

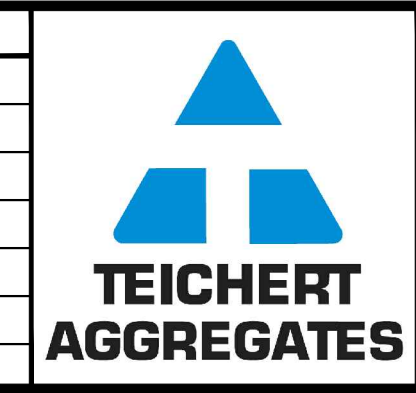

**CUNNINGHAM ENGINEERING**

Project Planning • Civil Engineering • Landscape Architecture

CECWEST.COM

■ Sacramento Office  
2120 20th Street, Suite Three  
Sacramento, CA 95818  
(916) 455-2026

■ Davis Office  
2940 Spafford Street, Suite 200  
Davis, CA 95618  
(530) 758-2026

**SHIFLER MINING PLAN**

**CROSS SECTION B-B**

**ALTERNATE A**

YOLO COUNTY CALIFORNIA

SHEET

**M-3A**

OF

**4**

DATE: 3/25/14

JOB NO: 1129.20

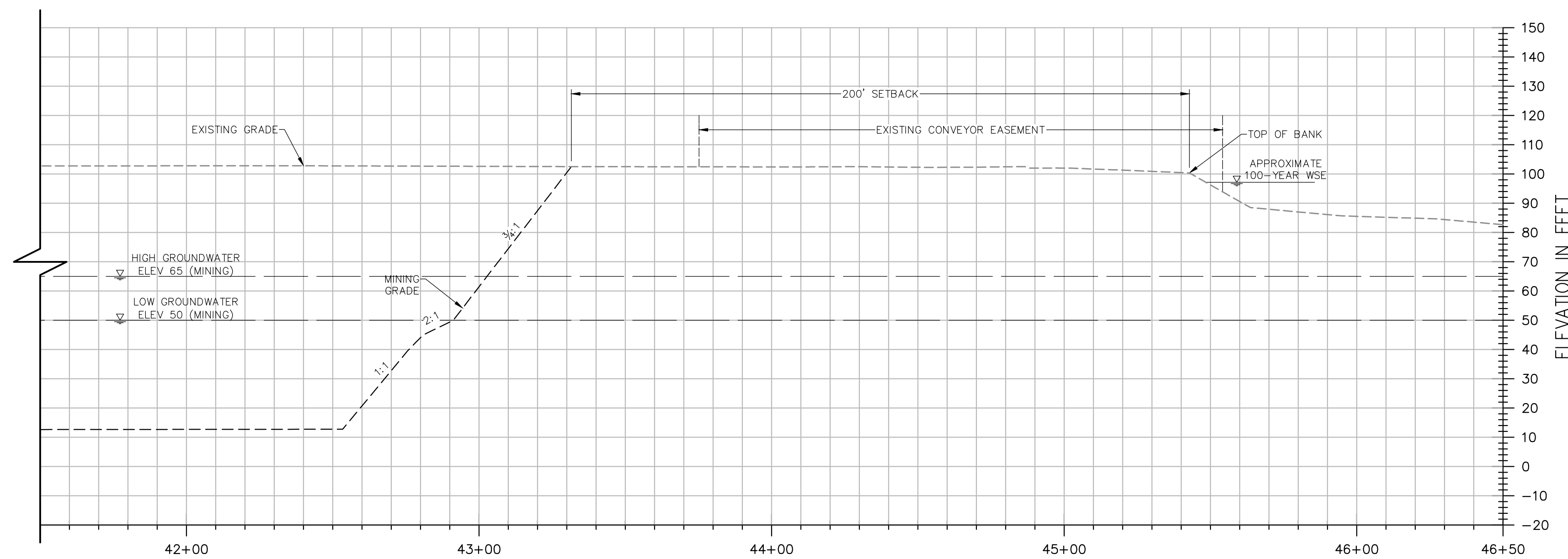
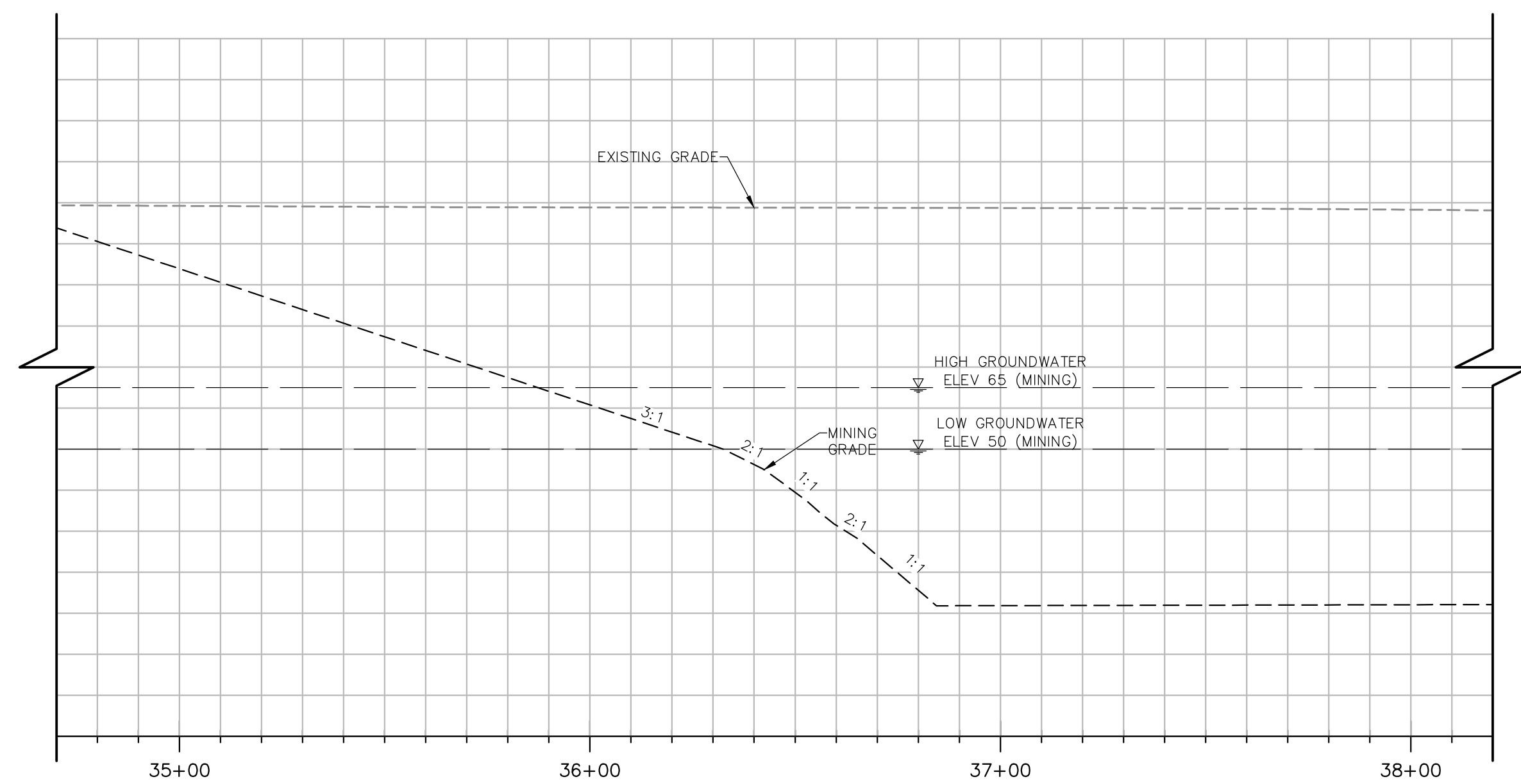
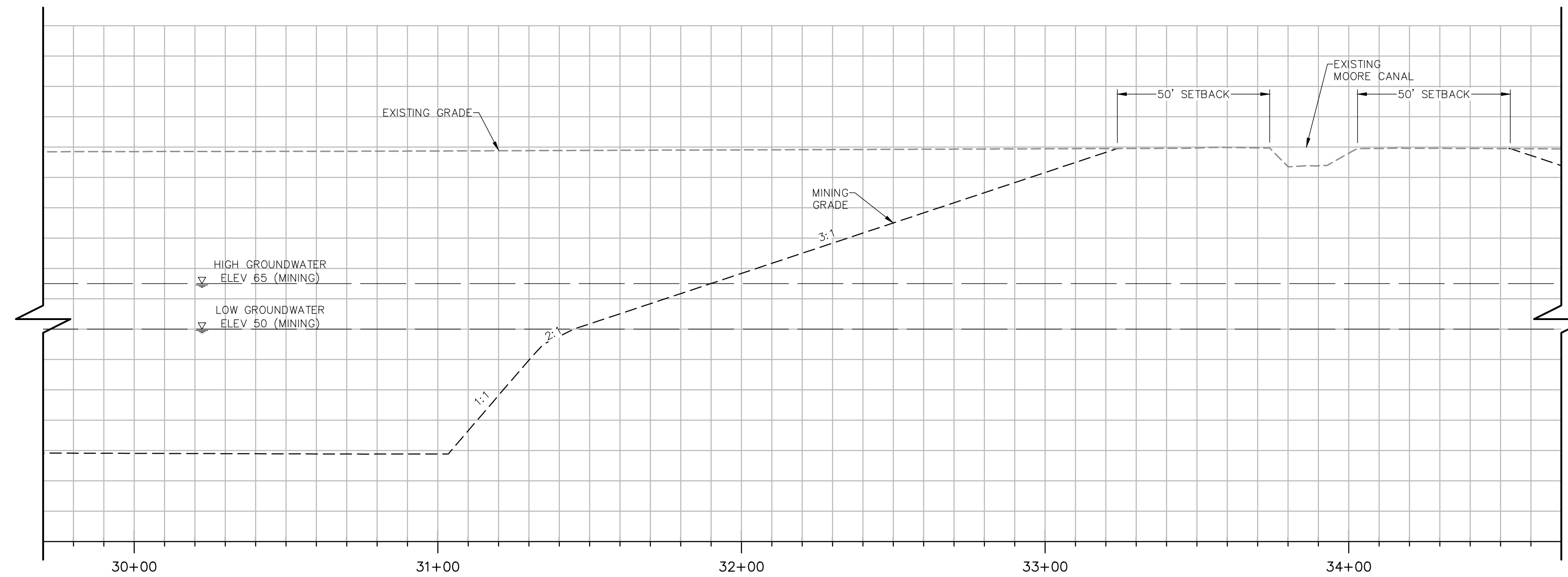
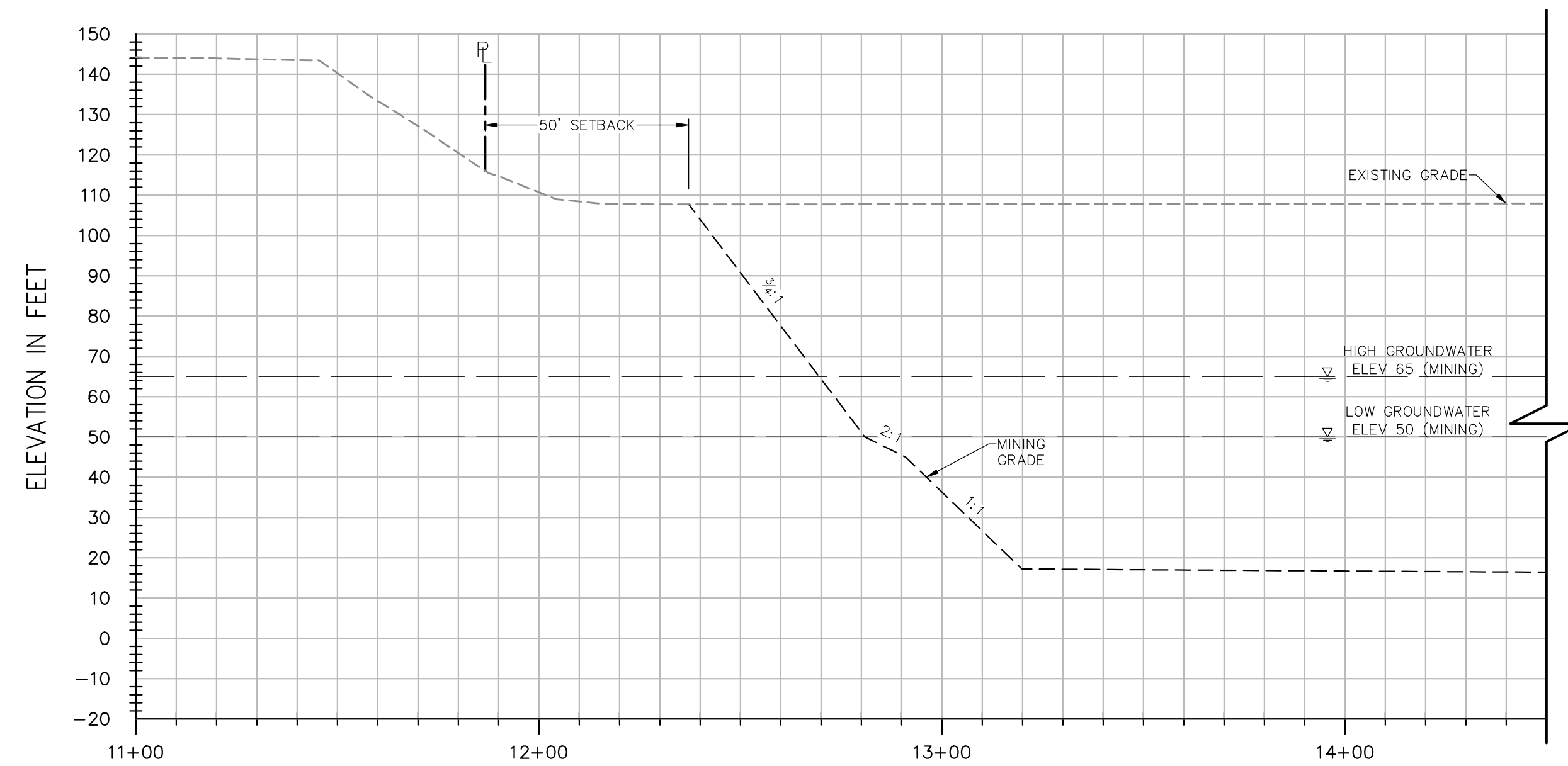

**SECTION C-C**

H: 1"=30'  
V: 1"=30'

**NOTES:**

- ELEVATIONS AND DISTANCES ARE APPROXIMATE. EXISTING GROUND IS BASED ON AERIAL TOPOGRAPHY FLOWN IN APRIL 2010 BY POINT CO. PHOTOGRAMMETRIC SERVICES.
- HIGH AND LOW AVERAGE GROUNDWATER ELEVATIONS BASED ON "GROUNDWATER CONDITIONS IN VICINITY OF PLANNED WET-PIT MINING OPERATIONS-SCHWARZGRUBER PROPERTY", BY LUHDORFF & SCALMANINI CONSULTING ENGINEERS DATED APRIL 25, 2011.
- BERMS OR V-DITCHES TO BE ADDED ALONG THE TOP OF SLOPES AS NECESSARY TO KEEP SURFACE RUNOFF FROM ADJACENT AREAS FROM ENTERING INTO THE DESIGNATED OPEN WATER AREAS.
- BOTTOM MINING ELEVATIONS ARE ±10' DEPENDING ON ACTUAL BOTTOM OF GRAVEL DEPTHS.
- EXISTING STOCKPILES ARE TO BE RE-GRADED OR REMOVED FROM THE SITE. PROPOSED MINING SLOPES SHOWN ON PLAN AND SECTIONS REPRESENT CONDITIONS AFTER THE STOCKPILES HAVE BEEN REMOVED OR RE-GRADED.

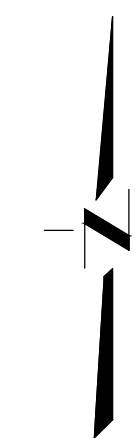
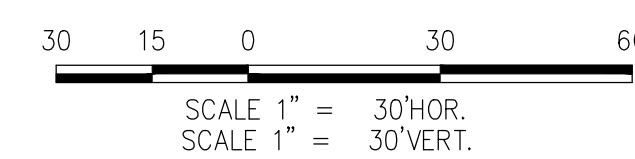

DESIGNED BY	NO.	DATE	REVISIONS	BY	APPD.
NC					
DRAWN BY					
LR					
CHECKED BY					
SG					
SCALE					
AS SHOWN					

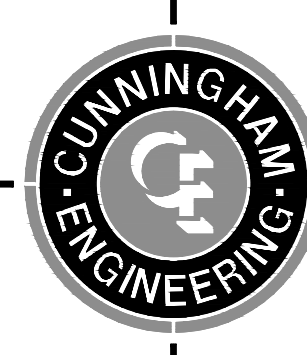

CECWEST.COM  
Project Planning • Civil Engineering • Landscape Architecture  
Sacramento Office: 2120 20th Street, Suite Three, Sacramento, CA 95818, (916) 455-2026  
Davis Office: 2940 Spafford Street, Suite 200, Davis, CA 95618, (530) 758-2026

**SHIFLER MINING PLAN  
CROSS SECTION C-C  
ALTERNATE A**

SHEET  
**M-4A**  
OF  
**4**

DATE: 3/25/14

YOLO COUNTY

CALIFORNIA

JOB NO: 1129.20

S:\Projects\11029\1129 - Teichert Aggregates\11029-20 SHIFLER MINING PLAN SHEETS\ALTERNATE A\1129-20-MIN-MOORE-NSEC-C-A1.dwg - NSEC-C - 3/25/2014 - 11:02AM Plotted by: nnc

**NOTES:**

- ELEVATIONS AND DISTANCES ARE APPROXIMATE. EXISTING GROUND IS BASED ON AERIAL TOPOGRAPHY FLOWN IN APRIL 2010 BY POINT CO. PHOTOGRAMMETRIC SERVICES.
- HIGH AND LOW AVERAGE GROUNDWATER ELEVATIONS BASED ON "GROUNDWATER CONDITIONS IN VICINITY OF PLANNED WET-PIT MINING OPERATIONS-SCHWARZGRUBER PROPERTY", BY LUHDORFF & SCALMANINI CONSULTING ENGINEERS DATED APRIL 25, 2011.
- BOTTOM MINING ELEVATIONS ARE ±10' DEPENDING ON ACTUAL BOTTOM OF GRAVEL DEPTHS.
- PROPOSED CONTOURS SHOWN AT 5' INTERVAL.
- FOR DETAILS, SEE ACCOMPANYING RECLAMATION PLAN PREPARED BY TEICHERT AGGREGATES (MAY 2011)
- WELLS NOTED TO BE ABANDONED SHALL BE ABANDONED PER YOLO COUNTY DEPARTMENT OF ENVIRONMENTAL HEALTH STANDARDS.
- SEE RECLAMATION SUMMARY FOR LANDSCAPE EXHIBITS.

**AGRICULTURAL AREA:  
48 ACRES**

**AGRICULTURAL AREA:  
31 ACRES**

**AGRICULTURAL AREA:  
34 ACRES**

**TOTAL AGRICULTURAL  
AREA: 113 ACRES**

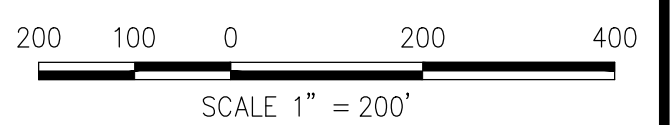
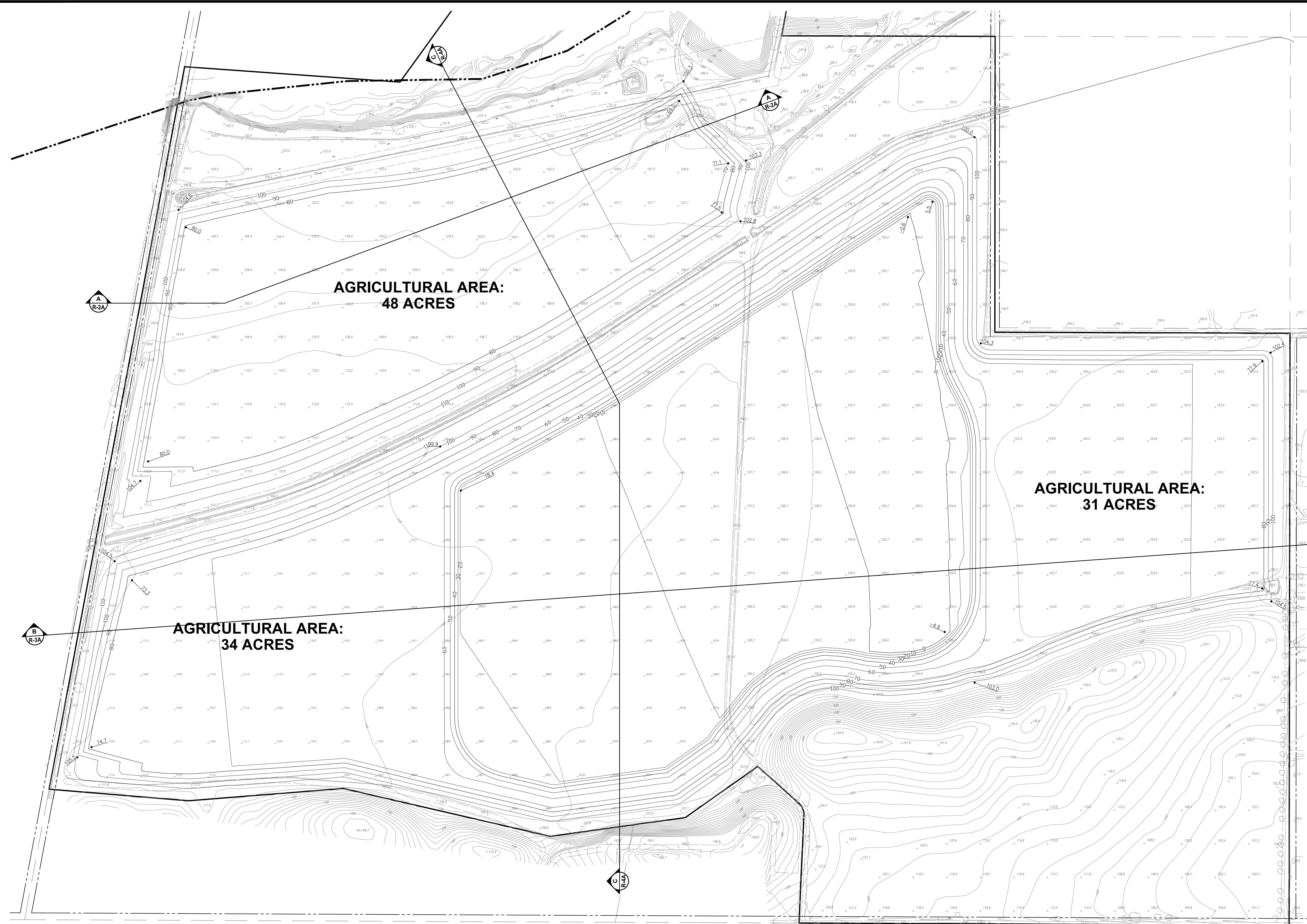

DESIGNED BY	NC	NO.	DATE	REVISIONS	BY	APPD.
DRAWN BY	LR					
CHECKED BY	SG					
SCALE	AS SHOWN					

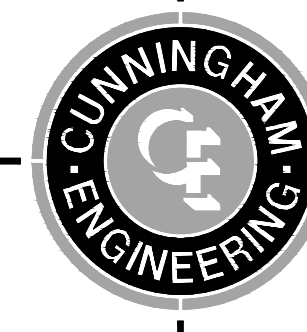
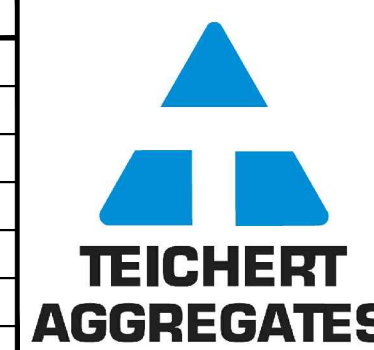

CECWEST.COM  
Project Planning ■ Civil Engineering ■ Landscape Architecture  
Sacramento Office: 2120 20th Street, Suite Three, Sacramento, CA 95818 (916) 455-2126  
Davis Office: 2940 Spafford Street, Suite 200, Davis, CA 95618 (530) 758-2026

**SHIFLER RECLAMATION PLAN  
SITE PLAN  
ALTERNATE A**

SHEET  
**R-1A**  
OF  
**4**  
DATE: 3/19/14  
JOB NO: 1129.20

YOLO COUNTY

CALIFORNIA

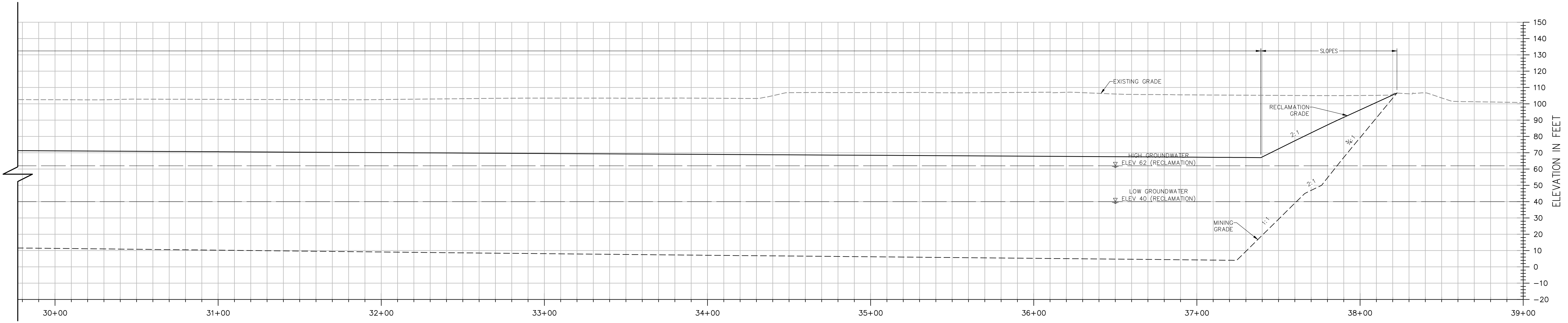
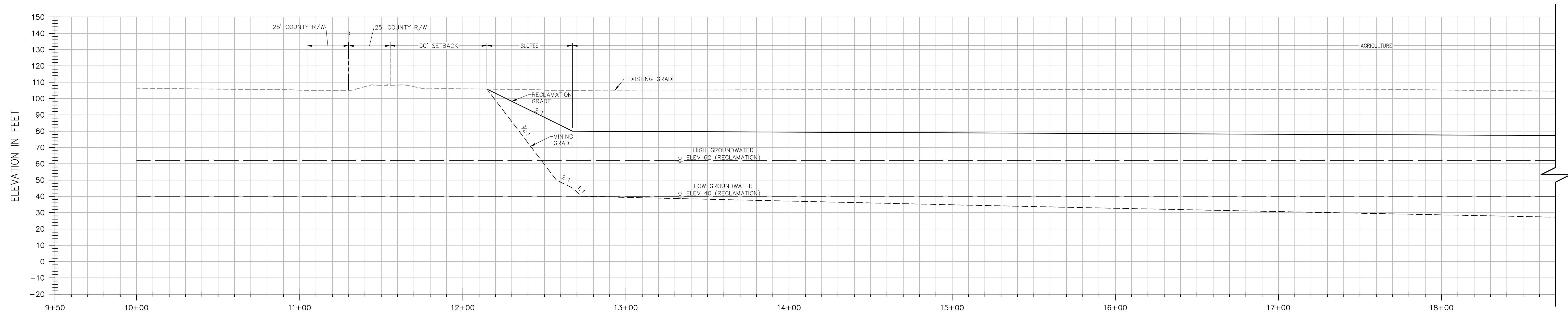

**SECTION A-A**

H: 1"=30'  
V: 1"=30'

**NOTES:**

- ELEVATIONS AND DISTANCES ARE APPROXIMATE. EXISTING GROUND IS BASED ON AERIAL TOPOGRAPHY FLOWN IN APRIL 2010 BY POINT CO. PHOTOGRAMMETRIC SERVICES.
- HIGH AND LOW AVERAGE GROUNDWATER ELEVATIONS BASED ON "GROUNDWATER CONDITIONS IN VICINITY OF PLANNED WET-PIT MINING OPERATIONS—SCHWARZGRUBER PROPERTY", BY LUHDORFF & SCALMANINI CONSULTING ENGINEERS DATED APRIL 25, 2011.
- BERMS OR V-DITCHES TO BE ADDED ALONG THE TOP OF SLOPES AS NECESSARY TO KEEP SURFACE RUNOFF FROM ADJACENT AREAS FROM ENTERING INTO THE DESIGNATED OPEN WATER AREAS.
- BOTTOM MINING ELEVATIONS ARE ±10' DEPENDING ON ACTUAL BOTTOM OF GRAVEL DEPTHS.
- EXISTING STOCKPILES ARE TO BE RE-GRADED OR REMOVED FROM THE SITE. PROPOSED MINING SLOPES SHOWN ON PLAN AND SECTIONS REPRESENT CONDITIONS AFTER THE STOCKPILES HAVE BEEN REMOVED OR RE-GRADED.

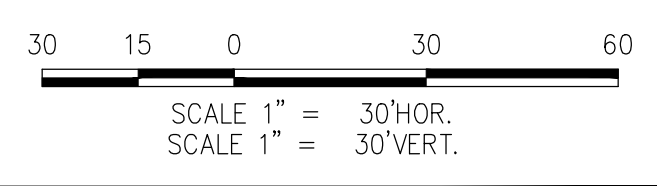

DESIGNED BY	NO.	DATE	REVISIONS	BY	APPD.
NC					
LR					
SG					
SCALE	AS SHOWN				

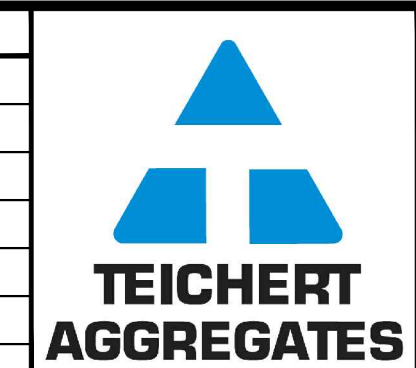

CECWEST.COM  
Project Planning • Civil Engineering • Landscape Architecture  
Sacramento Office: 2120 20th Street, Suite Three, Sacramento, CA 95818 (916) 455-2026  
Davis Office: 2940 Spafford Street, Suite 200, Davis, CA 95618 (530) 758-2026

**SHIFLER RECLAMATION PLAN  
CROSS SECTION A-A  
ALTERNATE A**

SHEET  
**R-2A**  
OF  
**4**  
DATE: 3/25/14  
JOB NO: 1129.20

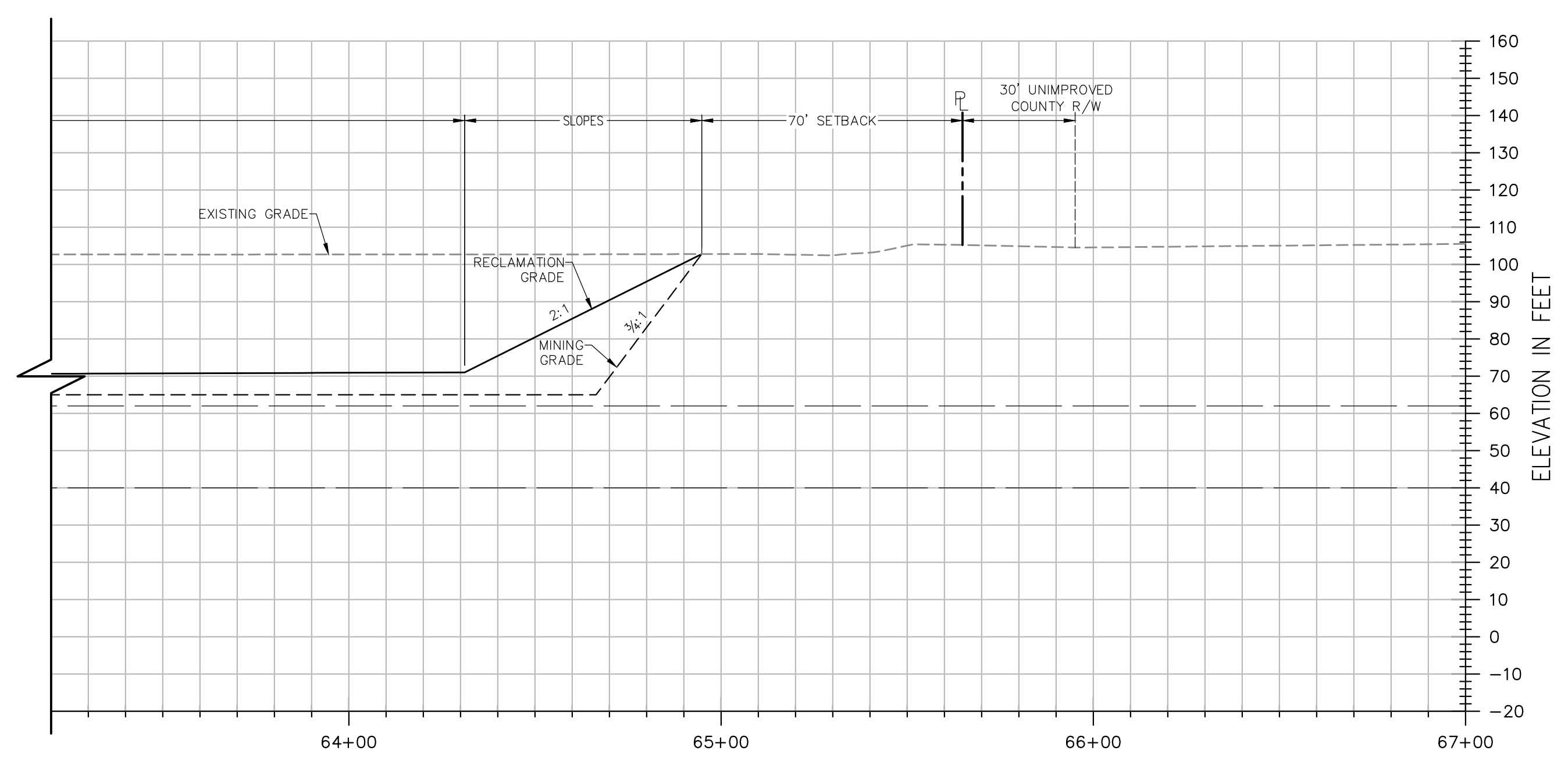
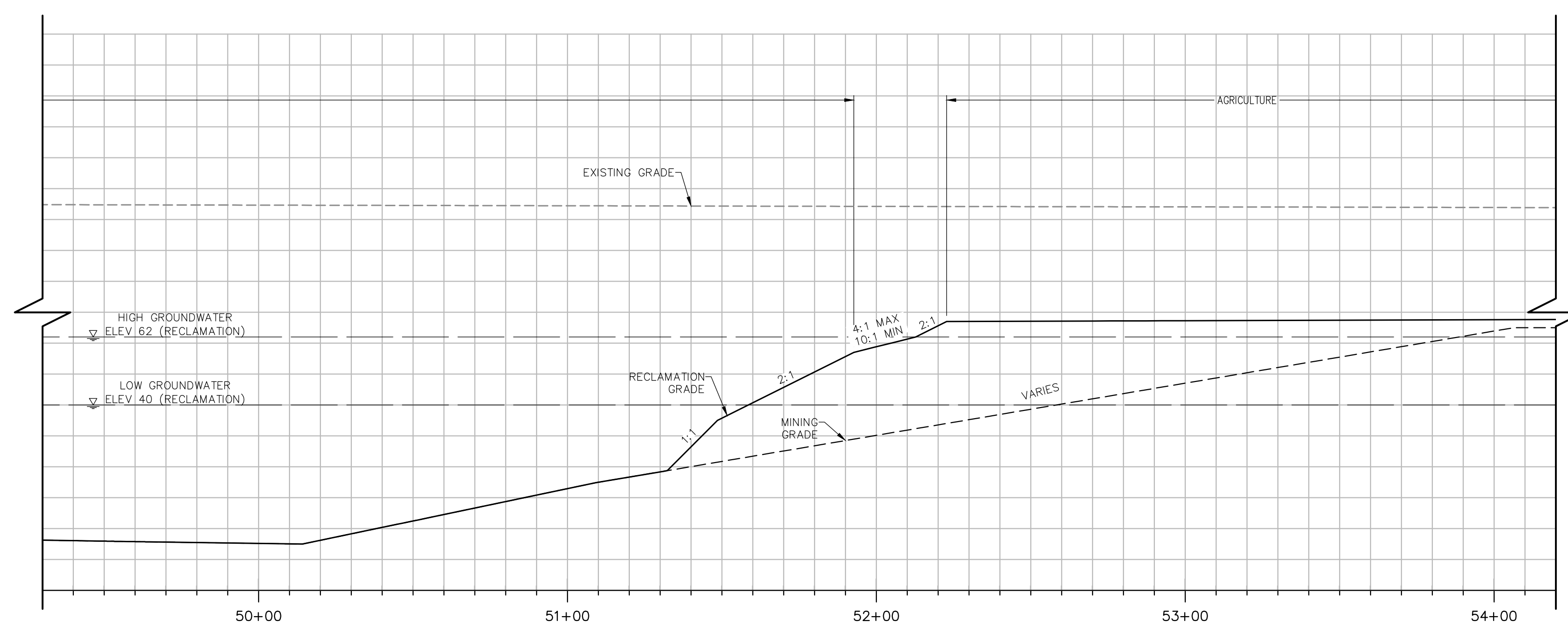
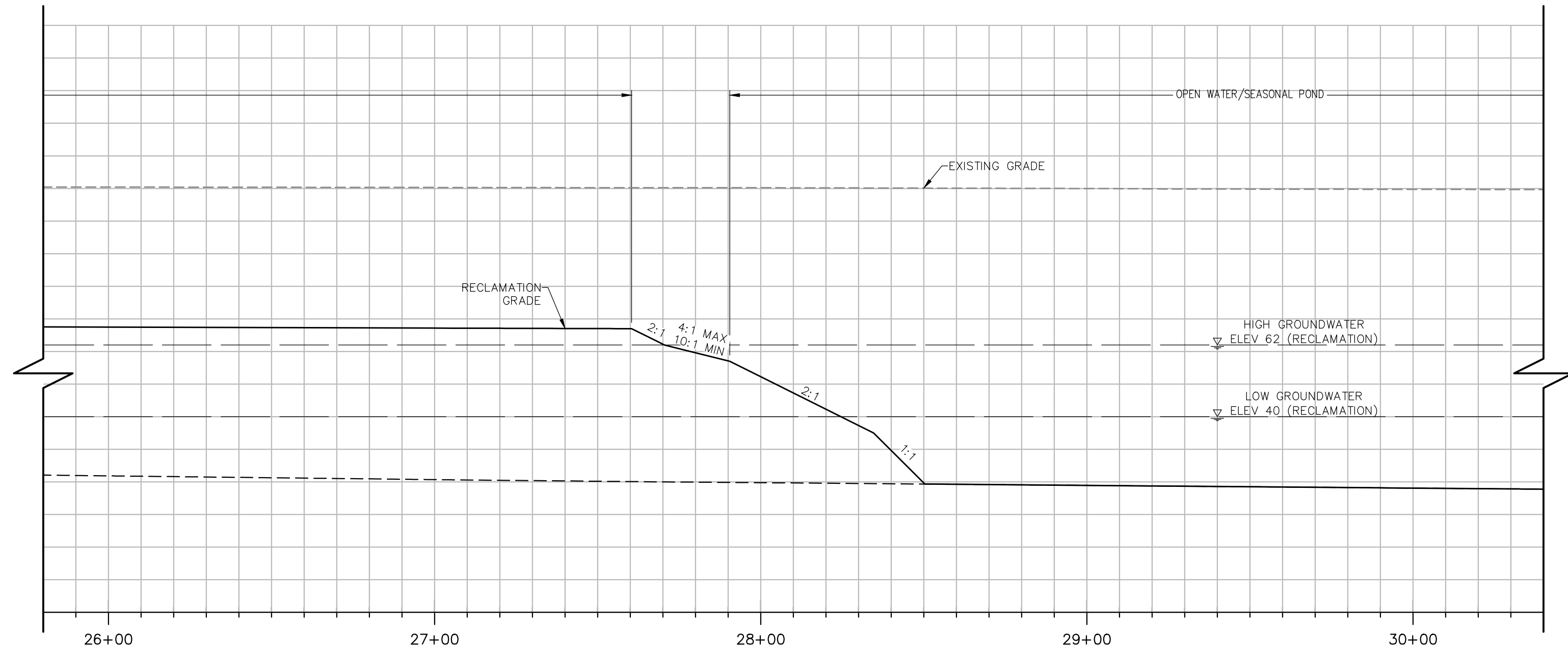
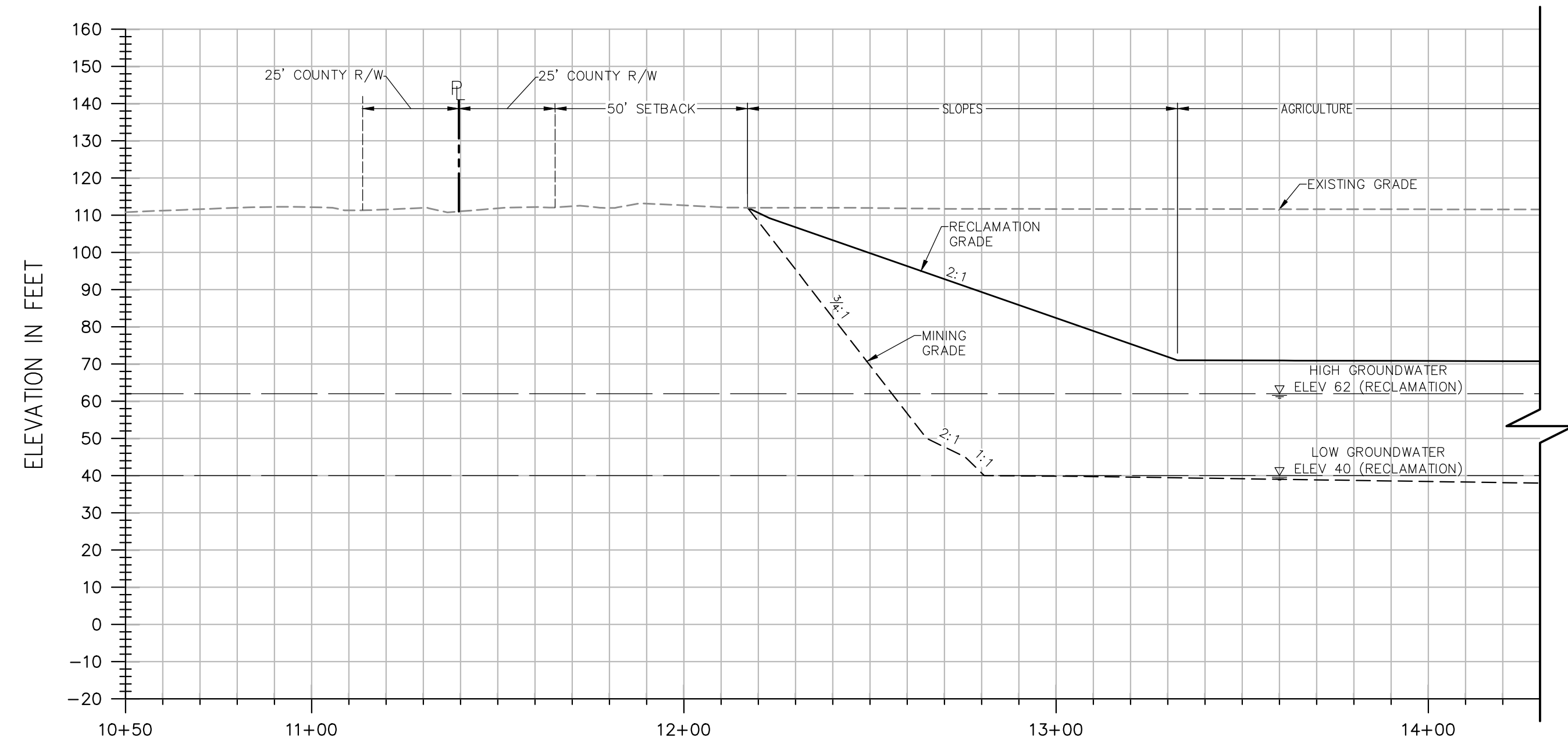

**SECTION B-B**  
H: 1"=30'  
V: 1"=30'

**NOTES:**

- ELEVATIONS AND DISTANCES ARE APPROXIMATE. EXISTING GROUND IS BASED ON AERIAL TOPOGRAPHY FLOWN IN APRIL 2010 BY POINT CO. PHOTOGRAMMETRIC SERVICES.
- HIGH AND LOW AVERAGE GROUNDWATER ELEVATIONS BASED ON "GROUNDWATER CONDITIONS IN VICINITY OF PLANNED WET-PIT MINING OPERATIONS-SCHWARZGRUBER PROPERTY", BY LUHDORFF & SCALMANINI CONSULTING ENGINEERS DATED APRIL 25, 2011.
- BERMS OR V-DITCHES TO BE ADDED ALONG THE TOP OF SLOPES AS NECESSARY TO KEEP SURFACE RUNOFF FROM ADJACENT AREAS FROM ENTERING INTO THE DESIGNATED OPEN WATER AREAS.
- BOTTOM MINING ELEVATIONS ARE ±10' DEPENDING ON ACTUAL BOTTOM OF GRAVEL DEPTHS.
- EXISTING STOCKPILES ARE TO BE RE-GRADED OR REMOVED FROM THE SITE. PROPOSED MINING SLOPES SHOWN ON PLAN AND SECTIONS REPRESENT CONDITIONS AFTER THE STOCKPILES HAVE BEEN REMOVED OR RE-GRADED.

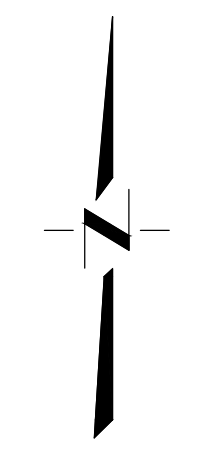
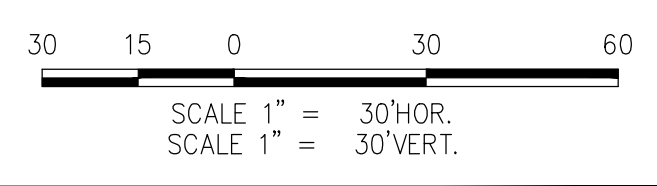

DESIGNED BY	NO.	DATE	REVISIONS	BY	APPD.
NC					
LR					
SG					
SCALE	AS SHOWN				

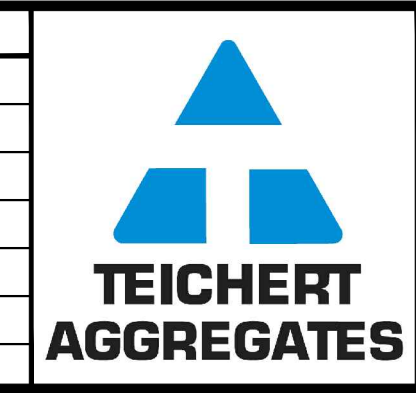

**CUNNINGHAM ENGINEERING**  
Project Planning • Civil Engineering • Landscape Architecture  
Sacramento Office: 2120 20th Street, Suite Three, Sacramento, CA 95818 (916) 455-2026  
Davis Office: 2940 Spafford Street, Suite 200, Davis, CA 95618 (530) 758-2026  
CECWEST.COM

**SHIFLER RECLAMATION PLAN**  
**CROSS SECTION B-B**  
**ALTERNATE A**  
YOLO COUNTY CALIFORNIA

SHEET  
**R-3A**  
OF  
**4**  
DATE: 3/25/14  
JOB NO: 1129.20

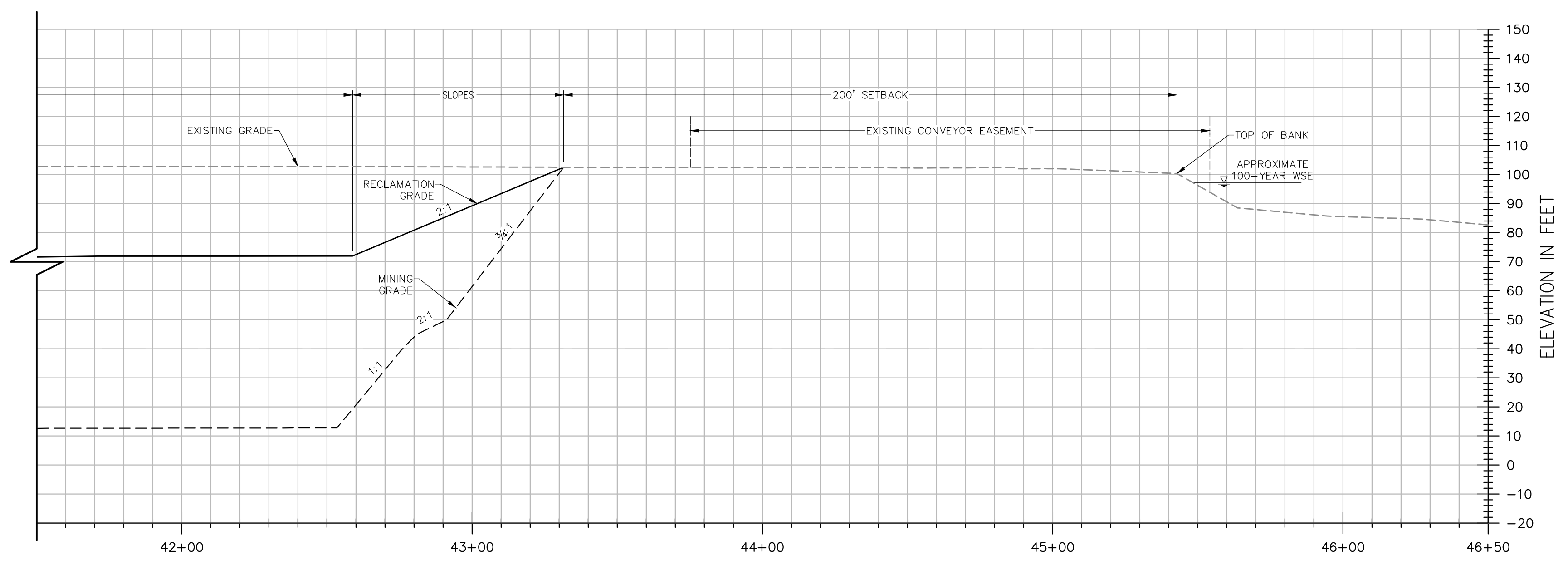
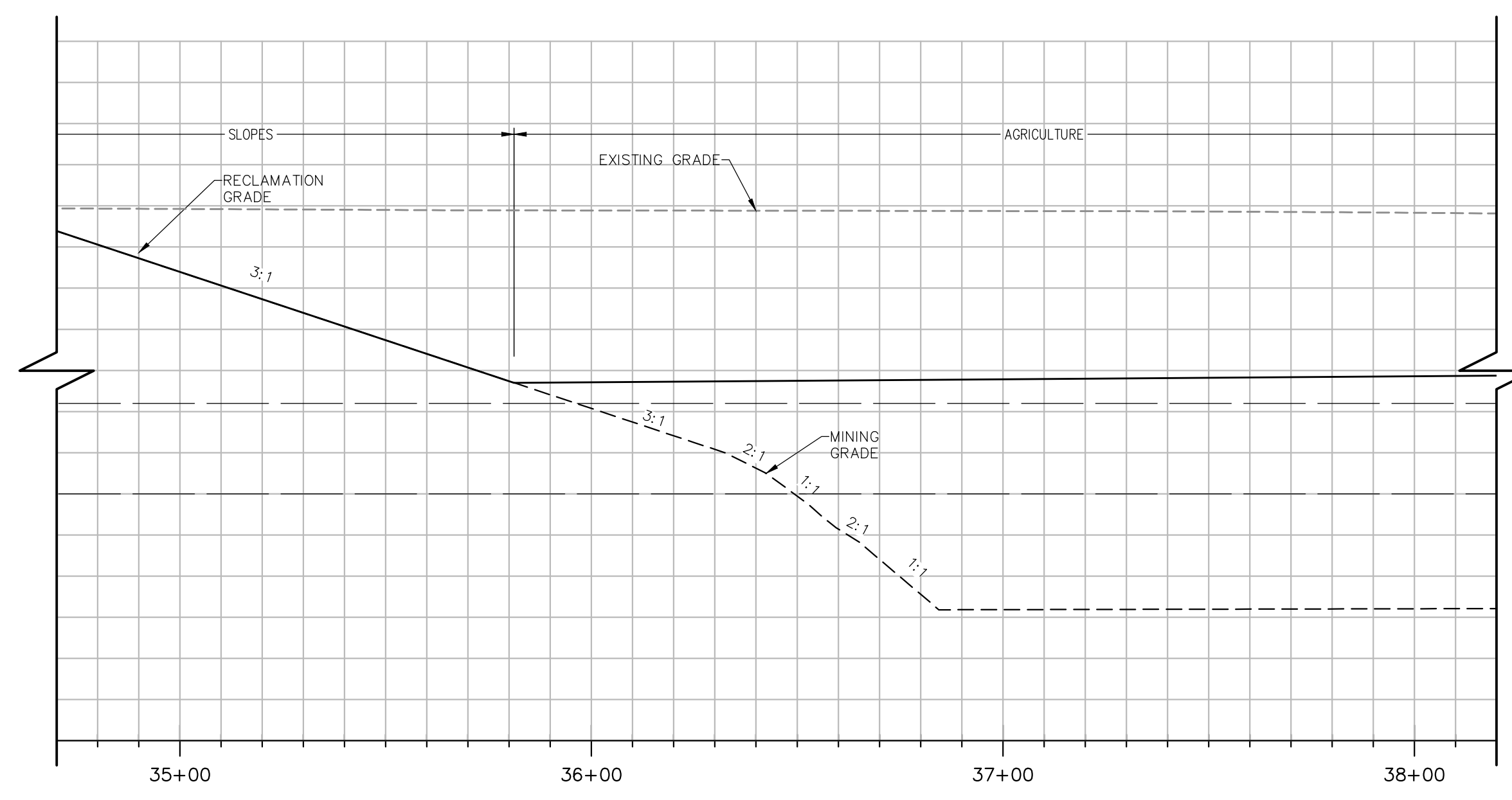
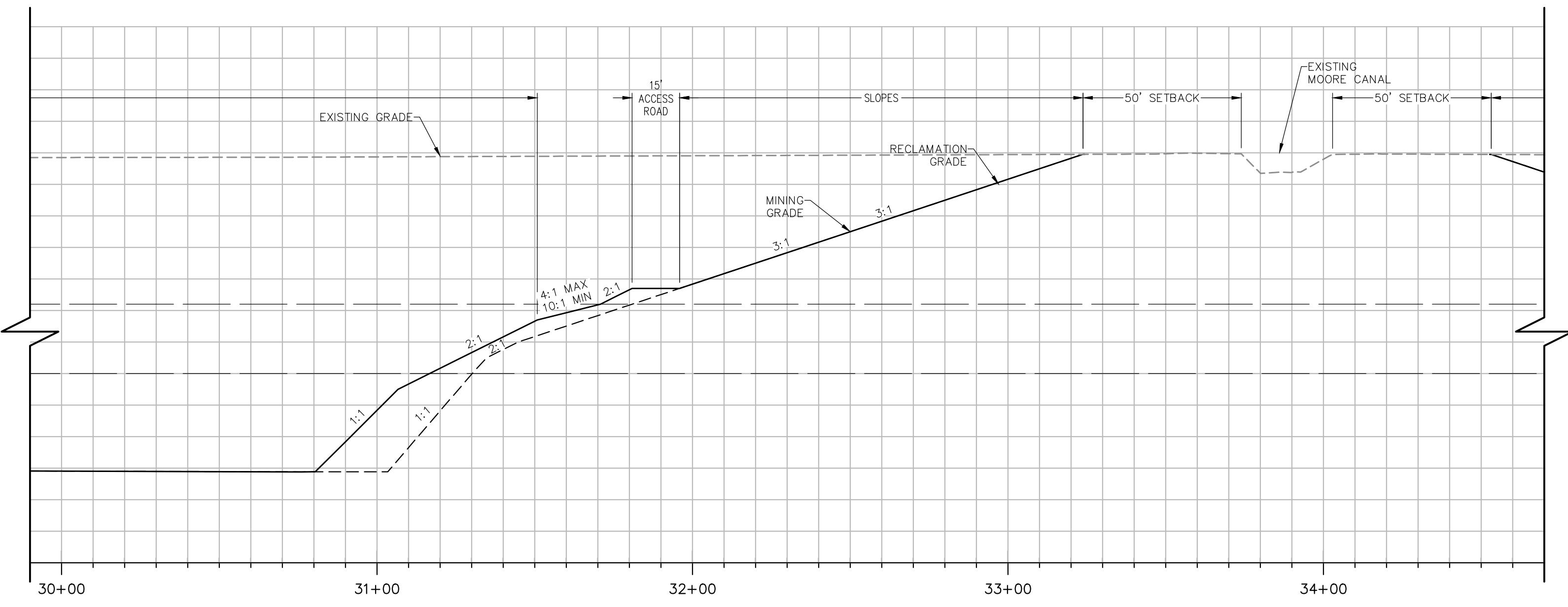
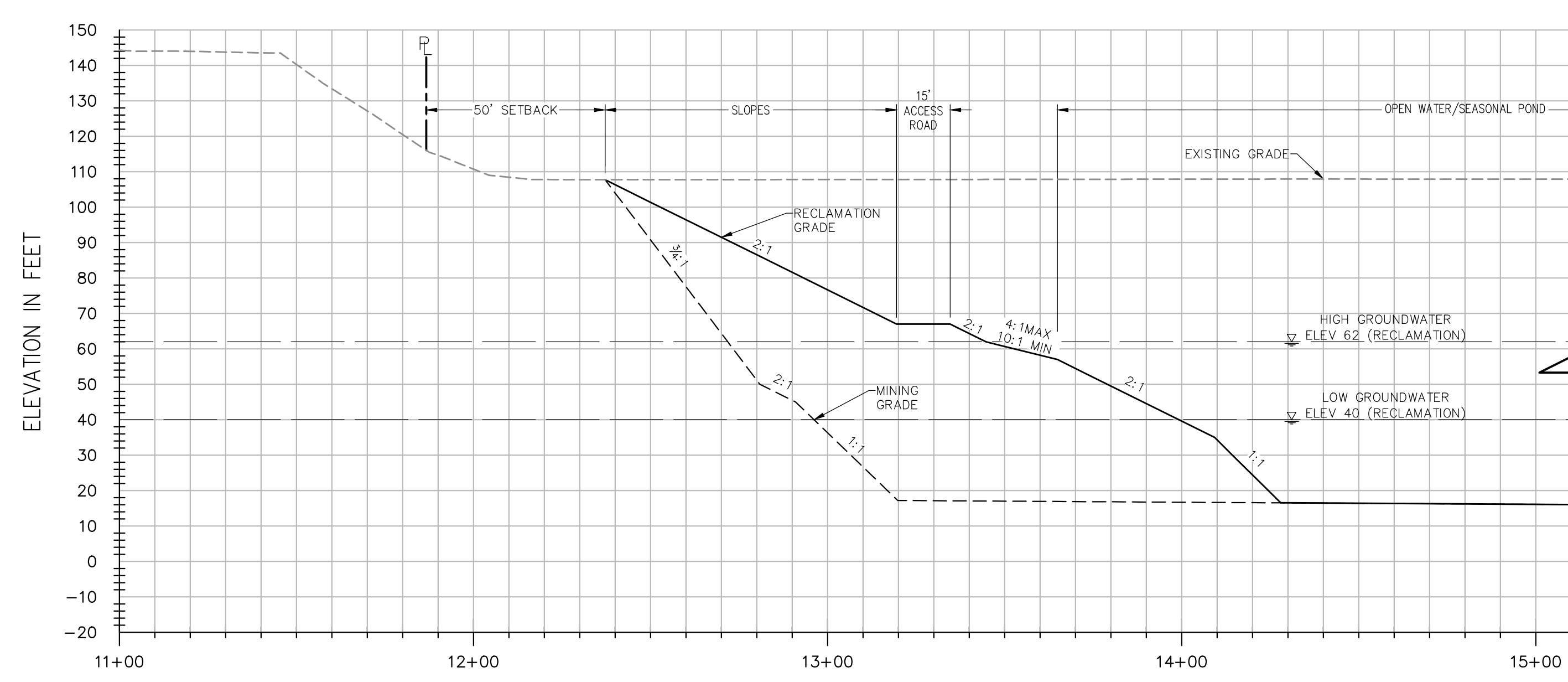

**SECTION C-C**

H: 1"=30'  
V: 1"=30'

**NOTES:**

- ELEVATIONS AND DISTANCES ARE APPROXIMATE. EXISTING GROUND IS BASED ON AERIAL TOPOGRAPHY FLOWN IN APRIL 2010 BY POINT CO. PHOTOGRAMMETRIC SERVICES.
- HIGH AND LOW AVERAGE GROUNDWATER ELEVATIONS BASED ON "GROUNDWATER CONDITIONS IN VICINITY OF PLANNED WET-PIT MINING OPERATIONS-SCHWARZGRUBER PROPERTY", BY LUHDORFF & SCALMANINI CONSULTING ENGINEERS DATED APRIL 25, 2011.
- BERMS OR V-DITCHES TO BE ADDED ALONG THE TOP OF SLOPES AS NECESSARY TO KEEP SURFACE RUNOFF FROM ADJACENT AREAS FROM ENTERING INTO THE DESIGNATED OPEN WATER AREAS.
- BOTTOM MINING ELEVATIONS ARE ±10' DEPENDING ON ACTUAL BOTTOM OF GRAVEL DEPTHS.
- EXISTING STOCKPILES ARE TO BE RE-GRADED OR REMOVED FROM THE SITE. PROPOSED MINING SLOPES SHOWN ON PLAN AND SECTIONS REPRESENT CONDITIONS AFTER THE STOCKPILES HAVE BEEN REMOVED OR RE-GRADED.

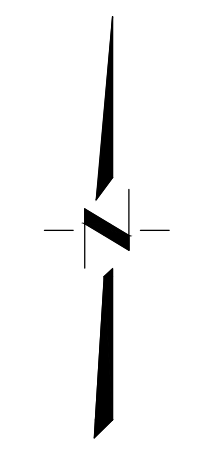
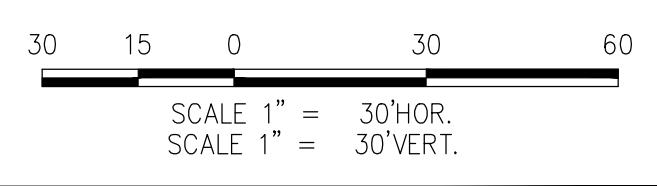

DESIGNED BY	NC	NO.	DATE	REVISIONS	BY	APPD.
DRAWN BY	LR					
CHECKED BY	SG					
SCALE	AS SHOWN					

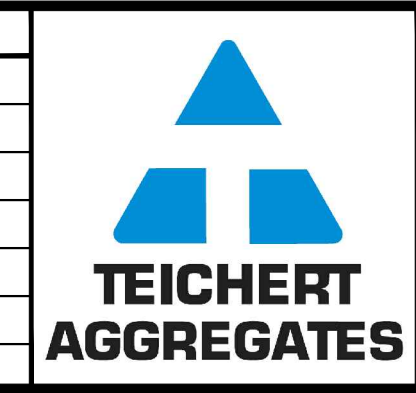

**CUNNINGHAM ENGINEERING**

Project Planning • Civil Engineering • Landscape Architecture

Sacramento Office: 2120 20th Street, Suite Three, Sacramento, CA 95818 (916) 455-2026  
 Davis Office: 2940 Spafford Street, Suite 200, Davis, CA 95618 (530) 758-2026

CECWEST.COM

**SHIFLER RECLAMATION PLAN**  
**CROSS SECTION C-C**  
**ALTERNATE A**

SHEET	<b>R-4A</b>
OF	<b>4</b>
DATE:	3/25/14
JOB NO:	1129.20

YOLO COUNTY

CALIFORNIA

S:\Projects\1102\1129 - Reclamat - Reclam\1129-20 - SHIFLER - 2014\1129-20-REC-10A-RECL-Alt A.dwg - RECL- 3/24/2014 - 10:15AM - Printed by: user