

# ELEVATION CERTIFICATE

Important: Follow the instructions on pages 1-9.

**OFFICE SET**

Copy all pages of this Elevation Certificate and all attachments for (1) community official, (2) insurance agent/company, and (3) building owner.

SECTION A – PROPERTY INFORMATION						FOR INSURANCE COMPANY USE
A1. Building Owner's Name <b>JAMES &amp; SHELLY ARCHER</b>					Policy Number:	
A2. Building Street Address (including Apt., Unit, Suite, and/or Bldg. No.) or P.O. Route and Box No. <b>13219 COUNTY ROAD 98</b>					Company NAIC Number:	
City <b>WOODLAND</b>		State <b>CA</b>		ZIP Code <b>95695</b>		
A3. Property Description (Lot and Block Numbers, Tax Parcel Number, Legal Description, etc.) <b>ASSESSOR'S PARCEL NUMBER: 027-200-030-000</b>						
A4. Building Use (e.g., Residential, Non-Residential, Addition, Accessory, etc.) <b>NON-RESIDENTIAL, AG STORAGE</b>						
A5. Latitude/Longitude: Lat. <b>38°44'48.6"</b> Long. <b>-121°48'03.2"</b> Horizontal Datum: <input type="checkbox"/> NAD 1927 <input checked="" type="checkbox"/> NAD 1983						
A6. Attach at least 2 photographs of the building if the Certificate is being used to obtain flood insurance.						
A7. Building Diagram Number <b>1B</b>						
A8. For a building with a crawlspace or enclosure(s):						
a) Square footage of crawlspace or enclosure(s) <b>N/A</b> sq ft						
b) Number of permanent flood openings in the crawlspace or enclosure(s) within 1.0 foot above adjacent grade <b>N/A</b>						
c) Total net area of flood openings in A8.b <b>N/A</b> sq in						
d) Engineered flood openings? <input type="checkbox"/> Yes <input checked="" type="checkbox"/> No						
A9. For a building with an attached garage:						
a) Square footage of attached garage <b>N/A</b> sq ft						
b) Number of permanent flood openings in the attached garage within 1.0 foot above adjacent grade <b>N/A</b>						
c) Total net area of flood openings in A9.b <b>N/A</b> sq in						
d) Engineered flood openings? <input type="checkbox"/> Yes <input checked="" type="checkbox"/> No						
SECTION B – FLOOD INSURANCE RATE MAP (FIRM) INFORMATION						
B1. NFIP Community Name & Community Number <b>YOLO COUNTY UNINCORPORATED 060423</b>			B2. County Name <b>YOLO</b>		B3. State <b>CA</b>	
B4. Map/Panel Number <b>06113C 0435</b>	B5. Suffix <b>H</b>	B6. FIRM Index Date <b>05/16/2012</b>	B7. FIRM Panel Effective/ Revised Date <b>05/16/2012</b>	B8. Flood Zone(s) <b>A</b>	B9. Base Flood Elevation(s) (Zone AO, use Base Flood Depth) <b>61.0'</b>	
B10. Indicate the source of the Base Flood Elevation (BFE) data or base flood depth entered in Item B9: <input type="checkbox"/> FIS Profile <input type="checkbox"/> FIRM <input checked="" type="checkbox"/> Community Determined <input type="checkbox"/> Other/Source: <b>SEE SECTION D</b>						
B11. Indicate elevation datum used for BFE in Item B9: <input type="checkbox"/> NGVD 1929 <input checked="" type="checkbox"/> NAVD 1988 <input type="checkbox"/> Other/Source:						
B12. Is the building located in a Coastal Barrier Resources System (CBRS) area or Otherwise Protected Area (OPA)? <input type="checkbox"/> Yes <input checked="" type="checkbox"/> No Designation Date: _____ <input type="checkbox"/> CBRS <input type="checkbox"/> OPA						

1100-1049B

**SCANNED**

RECEIVED  
 DEC 16 2016  
 NOV 30 2016  
 Planning and Public Works

# ELEVATION CERTIFICATE

OMB No. 1660-0008  
Expiration Date: November 30, 2018

<b>IMPORTANT: In these spaces, copy the corresponding information from Section A.</b>			<b>FOR INSURANCE COMPANY USE</b>
Building Street Address (including Apt., Unit, Suite, and/or Bldg. No.) or P.O. Route and Box No. <b>13219 COUNTY ROAD 98</b>			Policy Number:
City <b>WOODLAND</b>	State <b>CA</b>	ZIP Code <b>95695</b>	Company NAIC Number

## SECTION C – BUILDING ELEVATION INFORMATION (SURVEY REQUIRED)

C1. Building elevations are based on:  Construction Drawings\*  Building Under Construction\*  Finished Construction

\*A new Elevation Certificate will be required when construction of the building is complete.

C2. Elevations – Zones A1–A30, AE, AH, A (with BFE), VE, V1–V30, V (with BFE), AR, AR/A, AR/AE, AR/A1–A30, AR/AH, AR/AO. Complete Items C2.a–h below according to the building diagram specified in Item A7. In Puerto Rico only, enter meters.

Benchmark Utilized: **HPGN CA 03 08** Vertical Datum: **N.A.V.D. 88**

Indicate elevation datum used for the elevations in items a) through h) below.

NGVD 1929  NAVD 1988  Other/Source: \_\_\_\_\_

Datum used for building elevations must be the same as that used for the BFE.

Check the measurement used.

- |   |                      |  |                                 |
|---|----------------------|--|---------------------------------|
| a) Top of bottom floor (including basement, crawlspace, or enclosure floor)   | <u>67</u> . <u>5</u> | <input checked="" type="checkbox"/> feet | <input type="checkbox"/> meters |
| b) Top of the next higher floor   | <u>N/A</u>           | <input type="checkbox"/> feet            | <input type="checkbox"/> meters |
| c) Bottom of the lowest horizontal structural member (V Zones only)   | <u>N/A</u>           | <input type="checkbox"/> feet            | <input type="checkbox"/> meters |
| d) Attached garage (top of slab)  | <u>N/A</u>           | <input type="checkbox"/> feet            | <input type="checkbox"/> meters |
| e) Lowest elevation of machinery or equipment servicing the building<br>(Describe type of equipment and location in Comments) | <u>N/A</u>           | <input type="checkbox"/> feet            | <input type="checkbox"/> meters |
| f) Lowest adjacent (finished) grade next to building (LAG)  | <u>66</u> . <u>8</u> | <input checked="" type="checkbox"/> feet | <input type="checkbox"/> meters |
| g) Highest adjacent (finished) grade next to building (HAG)   | <u>67</u> . <u>3</u> | <input checked="" type="checkbox"/> feet | <input type="checkbox"/> meters |
| h) Lowest adjacent grade at lowest elevation of deck or stairs, including structural support                                  | <u>66</u> . <u>8</u> | <input checked="" type="checkbox"/> feet | <input type="checkbox"/> meters |

## SECTION D – SURVEYOR, ENGINEER, OR ARCHITECT CERTIFICATION

This certification is to be signed and sealed by a land surveyor, engineer, or architect authorized by law to certify elevation information. I certify that the information on this Certificate represents my best efforts to interpret the data available. I understand that any false statement may be punishable by fine or imprisonment under 18 U.S. Code, Section 1001.

Were latitude and longitude in Section A provided by a licensed land surveyor?  Yes  No  Check here if attachments.

Certifier's Name <b>CHRISTOPHER W. LERCH</b>	License Number <b>L.S. 7906</b>
Title <b>PRINCIPAL, SURVEYING MANAGER</b>	
Company Name <b>LAUGENOUR AND MEIKLE</b>	
Address <b>608 COURT STREET</b>	
City <b>WOODLAND</b>	State <b>CA</b>
	ZIP Code <b>95695</b>

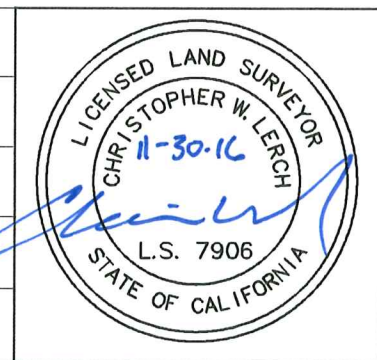

Signature <i>[Handwritten Signature]</i>	Date <b>11/29/2016</b>	Telephone <b>(530)662-1755</b>
---	---------------------------	-----------------------------------

Copy all pages of this Elevation Certificate and all attachments for (1) community official, (2) insurance agent/company, and (3) building owner.

Comments (including type of equipment and location, per C2(e), if applicable)  
**THE BASE FLOOD ELEVATION OF 61.0 FEET, N.A.V.D. 88 WAS DETERMINED FROM "THE FLOOD SAFE YOLO MAP" - A STUDY BY WOOD RODGERS IN 08/08/2012.**

**ELEVATION CERTIFICATE**

OMB No. 1660-0008  
Expiration Date: November 30, 2018

<b>IMPORTANT: In these spaces, copy the corresponding information from Section A.</b>			<b>FOR INSURANCE COMPANY USE</b>
Building Street Address (including Apt., Unit, Suite, and/or Bldg. No.) or P.O. Route and Box No. <b>13219 COUNTY ROAD 98</b>			Policy Number:
City <b>WOODLAND</b>	State <b>CA</b>	ZIP Code <b>95695</b>	Company NAIC Number

**SECTION E – BUILDING ELEVATION INFORMATION (SURVEY NOT REQUIRED)  
FOR ZONE AO AND ZONE A (WITHOUT BFE)**

For Zones AO and A (without BFE), complete Items E1–E5. If the Certificate is intended to support a LOMA or LOMR-F request, complete Sections A, B, and C. For Items E1–E4, use natural grade, if available. Check the measurement used. In Puerto Rico only, enter meters.

- E1. Provide elevation information for the following and check the appropriate boxes to show whether the elevation is above or below the highest adjacent grade (HAG) and the lowest adjacent grade (LAG).
- a) Top of bottom floor (including basement, crawlspace, or enclosure) is   **N/A**    feet  meters  above or  below the HAG.
  - b) Top of bottom floor (including basement, crawlspace, or enclosure) is   **N/A**    feet  meters  above or  below the LAG.
- E2. For Building Diagrams 6–9 with permanent flood openings provided in Section A Items 8 and/or 9 (see pages 1–2 of Instructions), the next higher floor (elevation C2.b in the diagrams) of the building is   **N/A**    feet  meters  above or  below the HAG.
- E3. Attached garage (top of slab) is   **N/A**    feet  meters  above or  below the HAG.
- E4. Top of platform of machinery and/or equipment servicing the building is   **N/A**    feet  meters  above or  below the HAG.
- E5. Zone AO only: If no flood depth number is available, is the top of the bottom floor elevated in accordance with the community's floodplain management ordinance?  Yes  No  Unknown. The local official must certify this information in Section G.

**SECTION F – PROPERTY OWNER (OR OWNER'S REPRESENTATIVE) CERTIFICATION**

The property owner or owner's authorized representative who completes Sections A, B, and E for Zone A (without a FEMA-issued or community-issued BFE) or Zone AO must sign here. The statements in Sections A, B, and E are correct to the best of my knowledge.

Property Owner or Owner's Authorized Representative's Name

<b>N/A</b>			
Address <b>N/A</b>	City <b>N/A</b>	State <b>N/A</b>	ZIP Code <b>N/A</b>
Signature	Date <b>N/A</b>	Telephone <b>N/A</b>	

Comments

**N/A**

Check here if attachments.

**ELEVATION CERTIFICATE**

OMB No. 1660-0008  
Expiration Date: November 30, 2018

<b>IMPORTANT: In these spaces, copy the corresponding information from Section A.</b>			<b>FOR INSURANCE COMPANY USE</b>
Building Street Address (including Apt., Unit, Suite, and/or Bldg. No.) or P.O. Route and Box No. <b>13219 COUNTY ROAD 98</b>			Policy Number:
City <b>WOODLAND</b>	State <b>CA</b>	ZIP Code <b>95695</b>	Company NAIC Number

**SECTION G – COMMUNITY INFORMATION (OPTIONAL)**

The local official who is authorized by law or ordinance to administer the community's floodplain management ordinance can complete Sections A, B, C (or E), and G of this Elevation Certificate. Complete the applicable item(s) and sign below. Check the measurement used in Items G8–G10. In Puerto Rico only, enter meters.

- G1.  The information in Section C was taken from other documentation that has been signed and sealed by a licensed surveyor, engineer, or architect who is authorized by law to certify elevation information. (Indicate the source and date of the elevation data in the Comments area below.)
- G2.  A community official completed Section E for a building located in Zone A (without a FEMA-issued or community-issued BFE) or Zone AO.
- G3.  The following information (Items G4–G10) is provided for community floodplain management purposes.

G4. Permit Number <b>BP2016-</b>	G5. Date Permit Issued <b>11-30-16</b>	G6. Date Certificate of Compliance/Occupancy Issued
-------------------------------------	---	---

G7. This permit has been issued for:  New Construction  Substantial Improvement

G8. Elevation of as-built lowest floor (including basement) of the building: 67.50  feet  meters Datum NAVD 88

G9. BFE or (in Zone AO) depth of flooding at the building site: 66.00  feet  meters Datum NAVD 88

G10. Community's design flood elevation: NA  feet  meters Datum \_\_\_\_\_

Local Official's Name <b>ED SHORE</b>	Title <b>CB O/ Flood Admin</b>
--	-----------------------------------

Community Name <b>Yolo County</b>	Telephone <b>(530) 666-8803</b>
--------------------------------------	------------------------------------

Signature 	Date <b>12-14-16</b>
--	-------------------------

Comments (including type of equipment and location, per C2(e), if applicable)

Check here if attachments.

# BUILDING PHOTOGRAPHS

OMB No. 1660-0008  
Expiration Date: November 30, 2018

## ELEVATION CERTIFICATE

See Instructions for Item A6.

<b>IMPORTANT: In these spaces, copy the corresponding information from Section A.</b>			<b>FOR INSURANCE COMPANY USE</b>
Building Street Address (including Apt., Unit, Suite, and/or Bldg. No.) or P.O. Route and Box No. <b>13219 COUNTY ROAD 98</b>			Policy Number:
City <b>WOODLAND</b>	State <b>CA</b>	ZIP Code <b>95695</b>	Company NAIC Number

If using the Elevation Certificate to obtain NFIP flood insurance, affix at least 2 building photographs below according to the instructions for Item A6. Identify all photographs with date taken; "Front View" and "Rear View"; and, if required, "Right Side View" and "Left Side View." When applicable, photographs must show the foundation with representative examples of the flood openings or vents, as indicated in Section A8. If submitting more photographs than will fit on this page, use the Continuation Page.



Photo One Caption **WEST & SOUTH SIDE VIEWS (TAKEN 11/29/2016)**



Photo Two Caption **EAST & NORTH SIDE VIEWS (TAKEN 11/29/2016)**

**BUILDING PHOTOGRAPHS**

Continuation Page

OMB No. 1660-0008  
Expiration Date: November 30, 2018

**ELEVATION CERTIFICATE**

<b>IMPORTANT: In these spaces, copy the corresponding information from Section A.</b>			<b>FOR INSURANCE COMPANY USE</b>
Building Street Address (including Apt., Unit, Suite, and/or Bldg. No.) or P.O. Route and Box No. <b>13219 COUNTY ROAD 98</b>			Policy Number:
City <b>WOODLAND</b>	State <b>CA</b>	ZIP Code <b>95695</b>	Company NAIC Number

If submitting more photographs than will fit on the preceding page, affix the additional photographs below. Identify all photographs with: date taken; "Front View" and "Rear View"; and, if required, "Right Side View" and "Left Side View." When applicable, photographs must show the foundation with representative examples of the flood openings or vents, as indicated in Section A8.

Photo One

Photo One Caption

Photo Two

Photo Two Caption

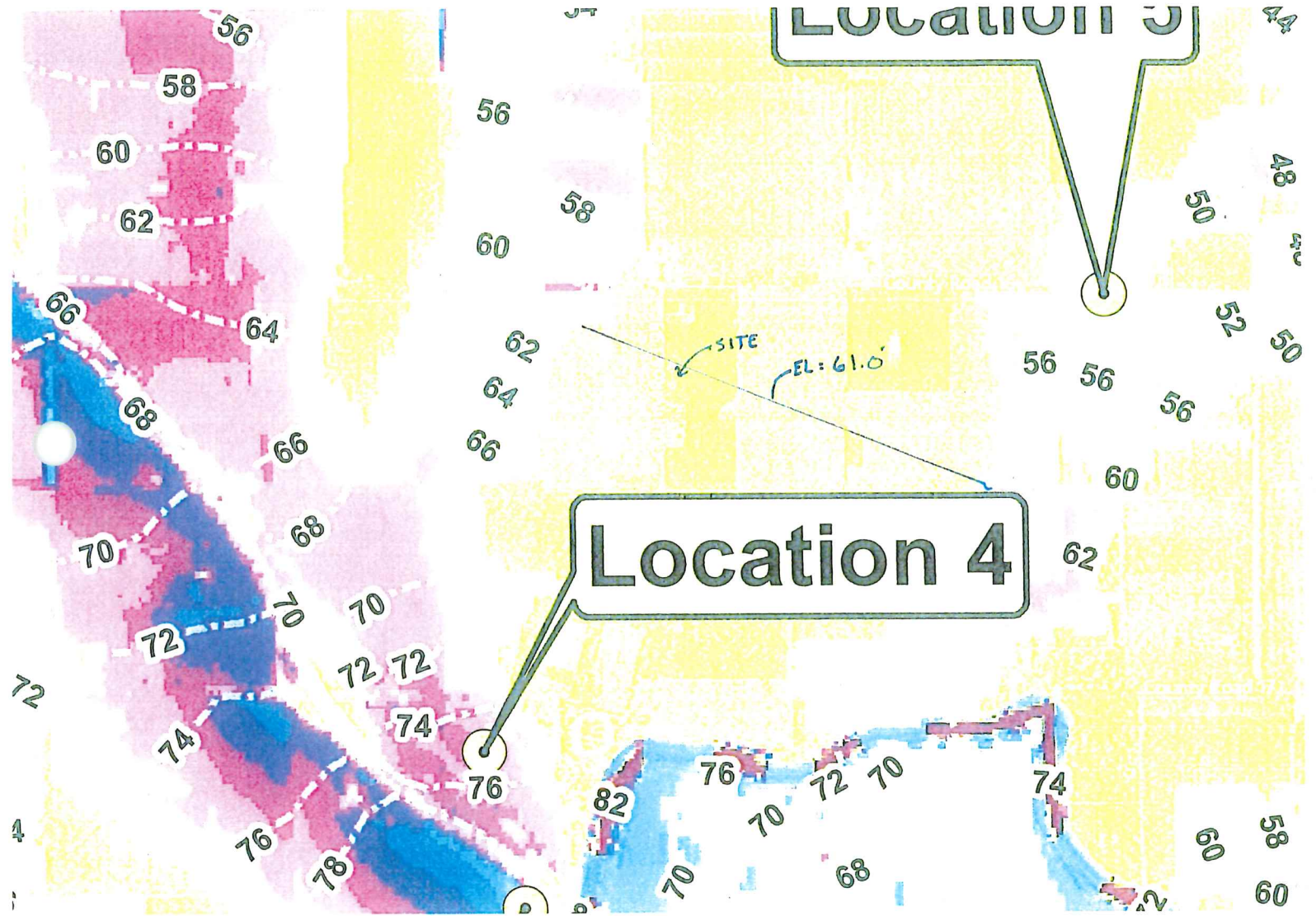



MAP SCALE 1" = 1000'

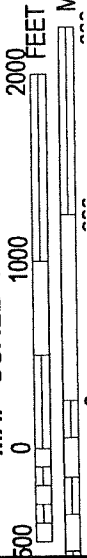

NOTE: MAP AREA SHOWN  
WITHIN TOWNSHIP 10 NORTH,  
RANGE 12 WEST

1

SITE

98

16A

99A

17

Cache Creek

ZONE AE

JACKSON RD

WASHINGTON ST

SACRAMENTO ST

CLAY STREET

MAIN

2ND STREET

CASA BLINDA BLVD

5TH STREET

6TH STREET

81

82

83

84

85

86

87

88

89

90

91

92

93

94

95

96

97

98

99

100

NATIONAL FLOOD INSURANCE PROGRAM

PANEL 0435H

# FIRM FLOOD INSURANCE RATE MAP YOLO COUNTY, CALIFORNIA AND INCORPORATED AREAS

PANEL 435 OF 785

(SEE MAP INDEX FOR FIRM PANEL LAYOUT)

CONTAINS:

COMMUNITY

YOLO COUNTY

WOODLAND, CITY OF

NUMBER

060423

060426

PANEL

0435

0435

SUFFIX

H

H

Notice to User: The Map Number shown below should be used on all insurance applications for the subject community. The map shown above should be used on insurance applications for the subject community.

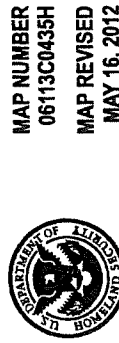

Federal Emergency Management Agency

MAP NUMBER  
06113C0435H  
MAP REVISED  
MAY 16, 2012

This is an official copy of a portion of the above referenced flood map. It was extracted using F-MIT On-Line. This map does not reflect changes or amendments which may have been made subsequent to the data on the title block. For the latest product information about National Flood Insurance Program flood maps check the FEMA Flood Map Store at [www.msc.fema.gov](http://www.msc.fema.gov)