

ELEVATION CERTIFICATE

OMB No. 1660-0008
Expires February 28, 2009

Important: Read the instructions on pages 1-8.

SECTION A - PROPERTY INFORMATION

1. Building Owner's Name Ted Wilson and Brenda Cedarblade		For Insurance Company Use:
2. Building Street Address (including Apt., Unit, Suite, and/or Bldg. No.) or P.O. 41070 County Road 18C		Policy Number
City Woodland	State CA	Company NAIC Number
3. Property Description (Lot and Block Numbers, Tax Parcel Number, Legal Description, etc.) APN 27-0220-021		ZIP Code 95695
4. Building Use (e.g., Residential, Non-Residential, Addition, Accessory, etc.) Non-residential and barn		
5. Latitude/Longitude: Lat. _____ Long. _____ Horizontal Datum: <input type="checkbox"/> NAD 1927 <input type="checkbox"/> NAD 1983		
6. Attach at least 2 photographs of the building if the Certificate is being used to obtain flood insurance.		
7. Building Diagram Number: 1		
8. For a building with a crawl space or enclosure(s), provide:		
a) Square footage of crawl space or enclosure(s) _____ sq ft	9. For a building with an attached garage, provide:	
b) No. of permanent flood openings in the crawl space or enclosure(s) walls within 1.0 foot above adjacent grade _____	a) Square footage of attached garage _____ sq ft	
c) Total net area of flood openings in A8.b _____ sq in	b) No. of permanent flood openings in the attached garage walls within 1.0 foot above adjacent grade _____	
	c) Total net area of flood openings in A9.b _____ sq in	

SECTION B - FLOOD INSURANCE RATE MAP (FIRM) INFORMATION

B1. NEIP Community Name & Community Number Yolo County unincorporated 000973		B2. County Name Yolo		B3. State CA	
B4. Map/Panel Number 0450 060423	B5. Suffix E	B6. FIRM Index Date 7/16/98	B7. FIRM Panel Effective/Revised Date 7/08/98-7/16/98	B8. Flood Zone(s) C	B9. Flood Elevation(s) (Zone AO, use base flood depth) 45.4
B10. Indicate the source of the Base Flood Elevation (BFE) data or base flood depth entered in Item B9. <input type="checkbox"/> FIS Profile <input checked="" type="checkbox"/> FIRM <input type="checkbox"/> Community Determined <input type="checkbox"/> Other (Describe) _____					
B11. Indicate elevation datum used for BFE in Item B9: <input checked="" type="checkbox"/> NGVD 1929 <input type="checkbox"/> NAVD 1988 <input type="checkbox"/> Other (Describe) _____					
B12. Is the building located in a Coastal Barrier Resources System (CBRS) area or Otherwise Protected Area (OPA)? Designation Date _____ <input type="checkbox"/> CBRS <input type="checkbox"/> OPA <input type="checkbox"/> Yes <input checked="" type="checkbox"/> No					

SECTION C - BUILDING ELEVATION INFORMATION (SURVEY REQUIRED)

C1. Building elevations are based on: Construction Drawings* Building Under Construction* Finished Construction
*A new Elevation Certificate will be required when construction of the building is complete.

C2. Elevations - Zones A1-A30, AE, AH, A (with BFE), VE, V1-V30, V (with BFE), AR, AR/A, AR/AE, AR/A1-A30, AR/AH, AR/AO. Complete Items C2 a-g below according to the building diagram specified in Item A7.

Benchmark Utilized _____ Vertical Datum _____

Conversion/Comments _____

COMMERCIAL COACH Check the measurement used.

a) Top of bottom floor (including basement, crawl space, or enclosure floor)	51.18	<input checked="" type="checkbox"/> feet	<input type="checkbox"/> meters (Puerto Rico only)
b) Top of the next higher floor	NA	<input type="checkbox"/> feet	<input type="checkbox"/> meters (Puerto Rico only)
c) Bottom of the lowest horizontal structural member (V Zones only)	NA	<input type="checkbox"/> feet	<input type="checkbox"/> meters (Puerto Rico only)
d) Attached garage (top of slab)	NA	<input type="checkbox"/> feet	<input type="checkbox"/> meters (Puerto Rico only)
e) Lowest elevation of machinery or equipment servicing the building (Describe type of equipment in Comments)	NA	<input type="checkbox"/> feet	<input type="checkbox"/> meters (Puerto Rico only)
f) Lowest adjacent (finished) grade (LAG)	49.1	<input type="checkbox"/> feet	<input type="checkbox"/> meters (Puerto Rico only)
g) Highest adjacent (finished) grade (HAG)	49.4	<input type="checkbox"/> feet	<input type="checkbox"/> meters (Puerto Rico only)

SECTION D - SURVEYOR, ENGINEER, OR ARCHITECT CERTIFICATION

This certification is to be signed and sealed by a land surveyor, engineer, or architect authorized by law to certify elevation information. I certify that the information on this Certificate represents my best efforts to interpret the data available.

I understand that any false statement may be punishable by fine or imprisonment under 18 U.S. Code, Section 1001.

Check here if comments are provided on back of form.

Certifier's Name **Gary K. Sheldon** License Number **PLS 4327**

Title Company **President** Name **Sheldon Land Surveying, Inc.**

Address City State **1005 Persifer Street, Folsom, CA** ZIP Code **95630**

Signature *Gary K. Sheldon* Date _____ Telephone **(916) 985-1875**



IMPORTANT: In these spaces, copy the corresponding information from Section A.			For Insurance Company Use:	
Building Street Address (including Apt., Unit, Suite, and/or Bldg. No.) or P.O. Route and Box No. 41070 County Road 18C			Policy Number <u>5</u>	
City	Woodland	State	CA	ZIP Code 95695
			Company NAIC Number	

SECTION D - SURVEYOR, ENGINEER, OR ARCHITECT CERTIFICATION (CONTINUED)

Copy both sides of this Elevation Certificate for (1) community official, (2) insurance agent/company, and (3) building owner.

Comments

Signature [Handwritten Signature] Date 11-03-08 Check here if attachments

SECTION E - BUILDING ELEVATION INFORMATION (SURVEY NOT REQUIRED) FOR ZONE AO AND ZONE A (WITHOUT BFE)

For Zones AO and A (without BFE), complete Items E1-E5. If the Certificate is intended to support a LOMA or LOMR-F request, complete Sections A, B, and C. For Items E1-E4, use natural grade, if available. Check the measurement used. In Puerto Rico only, enter meters.

- E1. Provide elevation information for the following and check the appropriate boxes to show whether the elevation is above or below the highest adjacent grade (HAG) and the lowest adjacent grade (LAG).
- a) Top of bottom floor (including basement, crawl space, or enclosure) is NA feet meters above or below the HAG.
- b) Top of bottom floor (including basement, crawl space, or enclosure) is NA feet meters above or below the LAG.
- E2. For Building Diagrams 6-8 with permanent flood openings provided in Section A Items 8 and/or 9 (see page 8 of Instructions), the next higher floor (elevation C2.b in the diagrams) of the building is NA feet meters above or below the HAG.
- E3. Attached garage (top of slab) is NA feet meters above or below the HAG.
- E4. Top of platform of machinery and/or equipment servicing the building is NA feet meters above or below the HAG.
- E5. Zone AO only: If no flood depth number is available, is the top of the bottom floor elevated in accordance with the community's floodplain management ordinance? Yes No Unknown. The local official must certify this information in Section G.

SECTION F - PROPERTY OWNER (OR OWNER'S REPRESENTATIVE) CERTIFICATION

The property owner or owner's authorized representative who completes Sections A, B, and E for Zone A (without a FEMA-issued or community-issued BFE) or Zone AO must sign here. The statements in Sections A, B, and E are correct to the best of my knowledge.

Property Owner's or Owner's Authorized Representative's Name Ted Wilson and Brenda Cedarblade

Address City 41070 County Road 18C State CA ZIP Code 95695

Signature Date [Handwritten Signature] 10/31/08 Telephone 530-304-0140

Comments

Check here if attachments

SECTION G - COMMUNITY INFORMATION (OPTIONAL)

The local official who is authorized by law or ordinance to administer the community's floodplain management ordinance can complete Sections A, B, C (or E), and G of this Elevation Certificate. Complete the applicable item(s) and sign below. Check the measurement used in Items G8. and G9.

- G1. The information in Section C was taken from other documentation that has been signed and sealed by a licensed surveyor, engineer, or architect who is authorized by law to certify elevation information. (Indicate the source and date of the elevation data in the Comments area below.)
- G2. A community official completed Section E for a building located in Zone A (without a FEMA-issued or community-issued BFE) or Zone AO.
- G3. The following information (Items G4.-G9.) is provided for community floodplain management purposes.

G4. Permit Number <u>208-0428</u>	G5. Date Permit Issued <u>11-17-2008</u>	G6. Date Certificate Of Compliance/Occupancy Issued <u>4-6-2009</u>
--------------------------------------	---	--

- G7. This permit has been issued for: New Construction Substantial Improvement
- G8. Elevation of as-built lowest floor (including basement) of the building: 51 . 18 feet meters (PR) Datum _____
- G9. BFE or (in Zone AO) depth of flooding at the building site: 45 . 4 feet meters (PR) Datum _____

Local Official's Name LONELL BUTLER Title CHIEF BUILDINGS OFFICIAL

Community Name YOLO COUNTY Telephone (530) 666-8775

Signature [Handwritten Signature] Date 11-6-08

Comments

Check here if attachments

Important: Read the instructions on pages 1-8.

SECTION A - PROPERTY INFORMATION

A1. Building Owner's Name <u>Ted Wilson and Brenda Cedarblade</u>	For Insurance Company Use:
	Policy Number
A2. Building Street Address (including Apt., Unit, Suite, and/or Bldg. No.) or P.O. Route and Box No. <u>41070 County Road 18C</u>	Company NAIC Number
City <u>Woodland</u> State <u>CA</u> ZIP Code <u>95695</u>	

A3. Property Description (Lot and Block Numbers, Tax Parcel Number, Legal Description, etc.)
APN 27-0220-21

A4. Building Use (e.g., Residential, Non-Residential, Addition, Accessory, etc.) Large Barn

A5. Latitude/Longitude: Lat. _____ Long. _____ Horizontal Datum: NAD 1927 NAD 1983

A6. Attach at least 2 photographs of the building if the Certificate is being used to obtain flood insurance.

A7. Building Diagram Number 1

A8. For a building with a crawl space or enclosure(s), provide

a) Square footage of crawl space or enclosure(s)	<u>0</u> sq ft	A9. For a building with an attached garage, provide:	
b) No. of permanent flood openings in the crawl space or enclosure(s) walls within 1.0 foot above adjacent grade	<u>0</u>	a) Square footage of attached garage	_____ sq ft
c) Total net area of flood openings in A8.b	<u>0</u> sq in	b) No. of permanent flood openings in the attached garage walls within 1.0 foot above adjacent grade	_____
		c) Total net area of flood openings in A9.b	_____ sq in

SECTION B - FLOOD INSURANCE RATE MAP (FIRM) INFORMATION

B1. NFIP Community Name & Community Number <u>Yolo County, CA (Unincorporated Areas)</u>		B2. County Name <u>Yolo</u>		B3. State <u>CA</u>	
B4. Map/Panel Number <u>060423</u>	B5. Suffix <u>F</u>	B6. FIRM Index Date	B7. FIRM Panel Effective/Revised Date	B8. Flood Zone(s) <u>AE</u>	B9. Base Flood Elevation(s) (Zone AO, use base flood depth) <u>47.4</u>

B10. Indicate the source of the Base Flood Elevation (BFE) data or base flood depth entered in Item B9.
 FIS Profile FIRM Community Determined Other (Describe) _____

B11. Indicate elevation datum used for BFE in Item B9: NGVD 1929 NAVD 1988 Other (Describe) _____

B12. Is the building located in a Coastal Barrier Resources System (CBRS) area or Otherwise Protected Area (OPA)?
 Designation Date _____ CBRS OPA Yes No

SECTION C - BUILDING ELEVATION INFORMATION (SURVEY REQUIRED)

C1. Building elevations are based on: Construction Drawings* Building Under Construction* Finished Construction
 *A new Elevation Certificate will be required when construction of the building is complete.

C2. Elevations - Zones A1-A30, AE, AH, A (with BFE), VE, V1-V30, V (with BFE), AR, AR/A, AR/AE, AR/A1-A30, AR/AH, AR/AO. Complete Items C2 a-g below according to the building diagram specified in Item A7.
 Benchmark Utilized _____ Vertical Datum _____
 Conversion/Comments _____

Check the measurement used.

a) Top of bottom floor (including basement, crawl space, or enclosure floor)	<u>54.1</u>	<input checked="" type="checkbox"/> feet	<input type="checkbox"/> meters (Puerto Rico only)
b) Top of the next higher floor	_____	<input type="checkbox"/> feet	<input type="checkbox"/> meters (Puerto Rico only)
c) Bottom of the lowest horizontal structural member (V Zones only)	_____	<input type="checkbox"/> feet	<input type="checkbox"/> meters (Puerto Rico only)
d) Attached garage (top of slab)	<u>NA</u>	<input type="checkbox"/> feet	<input type="checkbox"/> meters (Puerto Rico only)
e) Lowest elevation of machinery or equipment servicing the building (Describe type of equipment in Comments)	<u>NA</u>	<input type="checkbox"/> feet	<input type="checkbox"/> meters (Puerto Rico only)
f) Lowest adjacent (finished) grade (LAG)	<u>53.7</u>	<input checked="" type="checkbox"/> feet	<input type="checkbox"/> meters (Puerto Rico only)
g) Highest adjacent (finished) grade (HAG)	<u>54.0</u>	<input checked="" type="checkbox"/> feet	<input type="checkbox"/> meters (Puerto Rico only)

SECTION D - SURVEYOR, ENGINEER, OR ARCHITECT CERTIFICATION

This certification is to be signed and sealed by a land surveyor, engineer, or architect authorized by law to certify elevation information. I certify that the information on this Certificate represents my best efforts to interpret the data available. I understand that any false statement may be punishable by fine or imprisonment under 18 U.S. Code, Section 1001.

Check here if comments are provided on back of form.

Certifier's Name <u>Gary K. Sheldon</u>	License Number <u>PLS 4327</u>
Title <u>President</u>	Company Name <u>Sheldon Land Surveying, Inc.</u>
Address <u>1005 Persifer Street</u>	City <u>Folsom</u> State <u>CA</u> ZIP Code <u>95630</u>
Signature <u>Gary K. Sheldon</u>	Date <u>11/18/08</u> Telephone <u>(916) 985-1875</u>

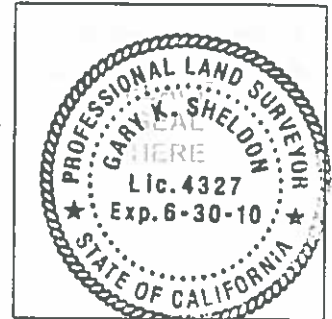

IMPORTANT: In these spaces, copy the corresponding information from Section A.	For Insurance Company Use:
Building Street Address (including Apt., Unit, Suite, and/or Bldg. No.) or P.O. Route and Box No. 41070 County Road 18C	Policy Number
City Woodland State CA ZIP Code 95695	Company NAIC Number

SECTION D - SURVEYOR, ENGINEER, OR ARCHITECT CERTIFICATION (CONTINUED)

Copy both sides of this Elevation Certificate for (1) community official, (2) insurance agent/company, and (3) building owner.

Comments This certificate held RM#4 (EL = 49.89 NAVD 1988) and revised Community Panel received from Marshall Merrick, FEMA, on October 29, 2008.

Signature *Gary Whelan* Date 11/18/08 Check here if attachments
PLS 4327

SECTION E - BUILDING ELEVATION INFORMATION (SURVEY NOT REQUIRED) FOR ZONE AO AND ZONE A (WITHOUT BFE)

For Zones AO and A (without BFE), complete Items E1-E5. If the Certificate is intended to support a LOMA or LOMR-F request, complete Sections A, B, and C. For Items E1-E4, use natural grade, if available. Check the measurement used. In Puerto Rico only, enter meters.

- E1. Provide elevation information for the following and check the appropriate boxes to show whether the elevation is above or below the highest adjacent grade (HAG) and the lowest adjacent grade (LAG).
 a) Top of bottom floor (including basement, crawl space, or enclosure) is _____ feet meters above or below the HAG.
 b) Top of bottom floor (including basement, crawl space, or enclosure) is _____ feet meters above or below the HAG.
- E2. For Building Diagrams 6-8 with permanent flood openings provided in Section A Items 8 and/or 9 (see page 8 of Instructions), the next higher floor (elevation C2.b in the diagrams) of the building is _____ feet meters above or below the HAG.
- E3. Attached garage (top of slab) is _____ feet meters above or below the HAG.
- E4. Top of platform of machinery and/or equipment servicing the building is _____ feet meters above or below the HAG.
- E5. Zone AO only: If no flood depth number is available, is the top of the bottom floor elevated in accordance with the community's floodplain management ordinance? Yes No Unknown. The local official must certify this information in Section G.

SECTION F - PROPERTY OWNER (OR OWNER'S REPRESENTATIVE) CERTIFICATION

The property owner or owner's authorized representative who completes Sections A, B, and E for Zone A (without a FEMA-issued or community-issued BFE) or Zone AO must sign here. *The statements in Sections A, B, and E are correct to the best of my knowledge.*

Property Owner's or Owner's Authorized Representative's Name
Ted Wilson and Brenda Cedarblade
 Address 41070 County Road 18C City Woodland State CA ZIP Code 95695

Signature _____ Date _____ Telephone _____
 Comments _____

Check here if attachments

SECTION G - COMMUNITY INFORMATION (OPTIONAL)

The local official who is authorized by law or ordinance to administer the community's floodplain management ordinance can complete Sections A, B, C (or E), and G of this Elevation Certificate. Complete the applicable item(s) and sign below. Check the measurement used in Items G8. and G9.

- G1. The information in Section C was taken from other documentation that has been signed and sealed by a licensed surveyor, engineer, or architect who is authorized by law to certify elevation information. (Indicate the source and date of the elevation data in the Comments area below.)
- G2. A community official completed Section E for a building located in Zone A (without a FEMA-issued or community-issued BFE) or Zone AO.
- G3. The following information (Items G4.-G9.) is provided for community floodplain management purposes.

G4. Permit Number	G5. Date Permit Issued	G6. Date Certificate Of Compliance/Occupancy Issued
-------------------	------------------------	---

- G7. This permit has been issued for: New Construction Substantial Improvement
- G8. Elevation of as-built lowest floor (including basement) of the building: _____ feet meters (PR) Datum _____
- G9. BFE or (in Zone AO) depth of flooding at the building site: _____ feet meters (PR) Datum _____

Local Official's Name _____ Title _____
 Community Name _____ Telephone _____
 Signature _____ Date _____
 Comments _____