

YY 2012 - 0014  
BP 2012 - 0325

U.S. DEPARTMENT OF HOMELAND SECURITY  
Federal Emergency Management Agency  
National Flood Insurance Program

# ELEVATION CERTIFICATE OFFICE SET

OMB No. 1660-0008  
Expires March 31, 2012

Important: Read the instructions on pages 1-9.

SECTION A - PROPERTY INFORMATION			For Insurance Company Use
A1. Building Owner's Name Charles P. Tyson			Policy Number
A2. Building Street Address (including Apt., Unit, Suite, and/or Bldg. No.) or P.O. Route and Box No. NA			Company NAIS Number
City	State	ZIP Code	
A3. Property Description (Lot and Block Numbers, Tax Parcel Number, Legal Description, etc.) YOLO COUNTY APN: 033-220-049			
A4. Building Use (e.g., Residential, Non-Residential, Addition, Accessory, etc.) <u>NON-RESIDENTIAL</u>			
A5. Latitude/Longitude: Lat. <u>38.37929</u> Long. <u>-121.64817</u> Horizontal Datum: <input type="checkbox"/> NAD 1927 <input checked="" type="checkbox"/> NAD 1983			
A6. Attach at least 2 photographs of the building if the Certificate is being used to obtain flood insurance.			
A7. Building Diagram Number <u>NA</u>			
A8. For a building with a crawspace or enclosure(s):		A9. For a building with an attached garage:	
a) Square footage of crawspace or enclosure(s)	<u>NA</u> sq ft	a) Square footage of attached garage	<u>NA</u> sq ft
b) No. of permanent flood openings in the crawspace or enclosure(s) within 1.0 foot above adjacent grade	<u>NA</u>	b) No. of permanent flood openings in the attached garage within 1.0 foot above adjacent grade	<u>NA</u>
c) Total net area of flood openings in A8.b	<u>NA</u> sq in	c) Total net area of flood openings in A9.b	<u>NA</u> sq in
d) Engineered flood openings? <input type="checkbox"/> Yes <input checked="" type="checkbox"/> No		d) Engineered flood openings? <input type="checkbox"/> Yes <input checked="" type="checkbox"/> No	

## SECTION B - FLOOD INSURANCE RATE MAP (FIRM) INFORMATION

B1. NFIP Community Name & Community Number YOLO COUNTY UNINC. 060423		B2. County Name YOLO		B3. State CA	
B4. Map/Panel Number 0604230720	B5. Suffix G	B6. FIRM Index Date 6-18-10	B7. FIRM Panel Effective/Revised Date 6-18-10	B8. Flood Zone(s) AE	B9. Base Flood Elevation(s) (Zone AO, use base flood depth) <u>22.0</u>

B10. Indicate the source of the Base Flood Elevation (BFE) data or base flood depth entered in Item B9.  
 FIS Profile  FIRM  Community Determined  Other (Describe) \_\_\_\_\_

B11. Indicate elevation datum used for BFE in Item B9:  NGVD 1929  NAVD 1988  Other (Describe) \_\_\_\_\_

B12. Is the building located in a Coastal Barrier Resources System (CBRS) area or Otherwise Protected Area (OPA)?  Yes  No  
 Designation Date \_\_\_\_\_  CBRS  OPA

## SECTION C - BUILDING ELEVATION INFORMATION (SURVEY REQUIRED)

C1. Building elevations are based on:  Construction Drawings\*  Building Under Construction\*  Finished Construction  
 \*A new Elevation Certificate will be required when construction of the building is complete.

C2. Elevations - Zones A1-A30, AE, AH, A (with BFE), VE, V1-V30, V (with BFE), AR, AR/A, AR/AE, AR/A1-A30, AR/AH, AR/AO. Complete items C2.a-h below according to the building diagram specified in Item A7. Use the same datum as the BFE.  
 Benchmark Utilized AE9864 Vertical Datum NAVD 88  
 Conversion/Comments \_\_\_\_\_

Check the measurement used.

a) Top of bottom floor (including basement, crawspace, or enclosure floor)	<u>NA</u>	<input type="checkbox"/> feet <input type="checkbox"/> meters (Puerto Rico only)
b) Top of the next higher floor	<u>NA</u>	<input type="checkbox"/> feet <input type="checkbox"/> meters (Puerto Rico only)
c) Bottom of the lowest horizontal structural member (V Zones only)	<u>NA</u>	<input type="checkbox"/> feet <input type="checkbox"/> meters (Puerto Rico only)
d) Attached garage (top of slab)	<u>NA</u>	<input type="checkbox"/> feet <input type="checkbox"/> meters (Puerto Rico only)
e) Lowest elevation of machinery or equipment servicing the building (Describe type of equipment and location in Comments)	<u>27.6</u>	<input checked="" type="checkbox"/> feet <input type="checkbox"/> meters (Puerto Rico only)
f) Lowest adjacent (finished) grade next to building (LAG)	<u>NA</u>	<input type="checkbox"/> feet <input type="checkbox"/> meters (Puerto Rico only)
g) Highest adjacent (finished) grade next to building (HAG)	<u>NA</u>	<input type="checkbox"/> feet <input type="checkbox"/> meters (Puerto Rico only)
h) Lowest adjacent grade at lowest elevation of deck or stairs, including structural support	<u>NA</u>	<input type="checkbox"/> feet <input type="checkbox"/> meters (Puerto Rico only)

RECEIVED  
Yolo County  
JUN 21 2012  
Planning and  
Public Works

## SECTION D - SURVEYOR, ENGINEER, OR ARCHITECT CERTIFICATION

This certification is to be signed and sealed by a land surveyor, engineer, or architect authorized by law to certify elevation information. I certify that the information on this Certificate represents my best efforts to interpret the data available. I understand that any false statement may be punishable by fine or imprisonment under 18 U.S. Code, Section 1001.   
 Check here if comments are provided on back of form. Were latitude and longitude in Section A provided by a licensed land surveyor?  Yes  No

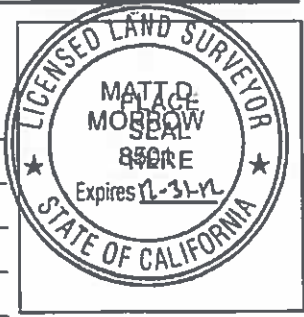

Certifier's Name MATT D. MORROW		License Number 8501	
Title LICENSED LAND SURVEYOR	Company Name MORROW SURVEYING, INC.		
Address 1256 STARBOARD DR.	City WEST SACRAMENTO	State CA	ZIP Code 95691
Signature <u>[Signature]</u>	Date 11-29-11	Telephone 916-372-8124	

**IMPORTANT: In these spaces, copy the corresponding information from Section A.**

Building Street Address (including Apt., Unit, Suite, and/or Bldg. No.) or P.O. Route and Box No.

CHARLES P. TYSON PROPERTY, YOLO COUNTY

City State ZIP Code



**SECTION D - SURVEYOR, ENGINEER, OR ARCHITECT CERTIFICATION (CONTINUED)**

Copy both sides of this Elevation Certificate for (1) community official, (2) insurance agent/company, and (3) building owner.

Comments **LOWEST ELEVATION OF MACHINERY REFERS TO BOTTOM OF LOWER OF TWO ELECTRIC PANELS LOCATED NEAR ELEVATED PUMP PLATFORM. SEE PICTURES.**

*[Handwritten signature]*

Signature

Date 11-29-11

Check here if attachments

**SECTION E - BUILDING ELEVATION INFORMATION (SURVEY NOT REQUIRED) FOR ZONE AO AND ZONE A (WITHOUT BFE)**

For Zones AO and A (without BFE), complete Items E1-E5. If the Certificate is intended to support a LOMA or LOMR-F request, complete Sections A, B, and C. For Items E1-E4, use natural grade, if available. Check the measurement used. In Puerto Rico only, enter meters.

- E1. Provide elevation information for the following and check the appropriate boxes to show whether the elevation is above or below the highest adjacent grade (HAG) and the lowest adjacent grade (LAG).
  - a) Top of bottom floor (including basement, crawlspace, or enclosure) is \_\_\_\_\_  feet  meters  above or  below the HAG.
  - b) Top of bottom floor (including basement, crawlspace, or enclosure) is \_\_\_\_\_  feet  meters  above or  below the LAG.
- E2. For Building Diagrams 6-9 with permanent flood openings provided in Section A Items 8 and/or 9 (see pages 8-9 of Instructions), the next higher floor (elevation C2.b in the diagrams) of the building is \_\_\_\_\_  feet  meters  above or  below the HAG.
- E3. Attached garage (top of slab) is \_\_\_\_\_  feet  meters  above or  below the HAG.
- E4. Top of platform of machinery and/or equipment servicing the building is \_\_\_\_\_  feet  meters  above or  below the HAG.
- E5. Zone AO only: If no flood depth number is available, is the top of the bottom floor elevated in accordance with the community's floodplain management ordinance?  Yes  No  Unknown. The local official must certify this information in Section G.

**SECTION F - PROPERTY OWNER (OR OWNER'S REPRESENTATIVE) CERTIFICATION**

The property owner or owner's authorized representative who completes Sections A, B, and E for Zone A (without a FEMA-issued or community-issued BFE) or Zone AO must sign here. *The statements in Sections A, B, and E are correct to the best of my knowledge.*

Property Owner's or Owner's Authorized Representative's Name

Address *N/A* City State ZIP Code

Signature Date Telephone

Comments

Check here if attachments

**SECTION G - COMMUNITY INFORMATION (OPTIONAL)**

The local official who is authorized by law or ordinance to administer the community's floodplain management ordinance can complete Sections A, B, C (or E), and G of this Elevation Certificate. Complete the applicable item(s) and sign below. Check the measurement used in Items G8 and G9.

- G1.  The information in Section C was taken from other documentation that has been signed and sealed by a licensed surveyor, engineer, or architect who is authorized by law to certify elevation information. (Indicate the source and date of the elevation data in the Comments area below.)
- G2.  A community official completed Section E for a building located in Zone A (without a FEMA-issued or community-issued BFE) or Zone AO.
- G3.  The following information (Items G4-G9) is provided for community floodplain management purposes.

G4. Permit Number <i>BP2012-0325</i>	G5. Date Permit Issued <i>8/9/2012</i>	G6. Date Certificate Of Compliance/Occupancy Issued <i>11/19/2013</i>
---	---	--

- G7. This permit has been issued for:  New Construction  Substantial Improvement
- G8. Elevation of as-built lowest floor (including basement) of the building: *27.6*  feet  meters (PR) Datum *NAVD88*
- G9. BFE or (in Zone AO) depth of flooding at the building site: *22.0*  feet  meters (PR) Datum \_\_\_\_\_
- G10. Community's design flood elevation \_\_\_\_\_  feet  meters (PR) Datum \_\_\_\_\_

Local Official's Name *LONELL BUTLER*

Title *CHIEF BUILDING OFFICIAL*

Community Name *YOLO COUNTY*

Telephone *530-666-8003*

Signature *Lonell Butler*

Date *7-2-12*

Comments

Check here if attachments

## Building Photographs

See Instructions for Item A6.

Building Street Address (including Apt., Unit, Suite, and/or Bldg. No.) or P.O. Route and Box No. CHARLES P. TYSON PROPERTY, YOLO COUNTY			For Insurance Company Use:
			Policy Number
City	State	ZIP Code	Company NAIC Number

If using the Elevation Certificate to obtain NFIP flood insurance, affix at least two building photographs below according to the instructions for Item A6. Identify all photographs with: date taken; "Front View" and "Rear View", and, if required, "Right Side View" and "Left Side View." If submitting more photographs than will fit on this page, use the Continuation Page, following.

**FRONT VIEW:**

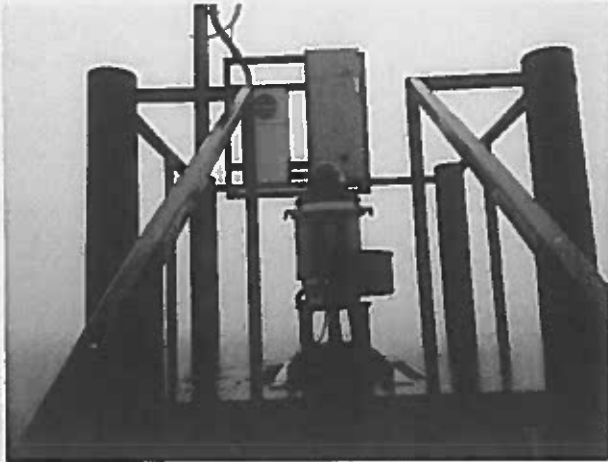

**SIDE VIEW:**



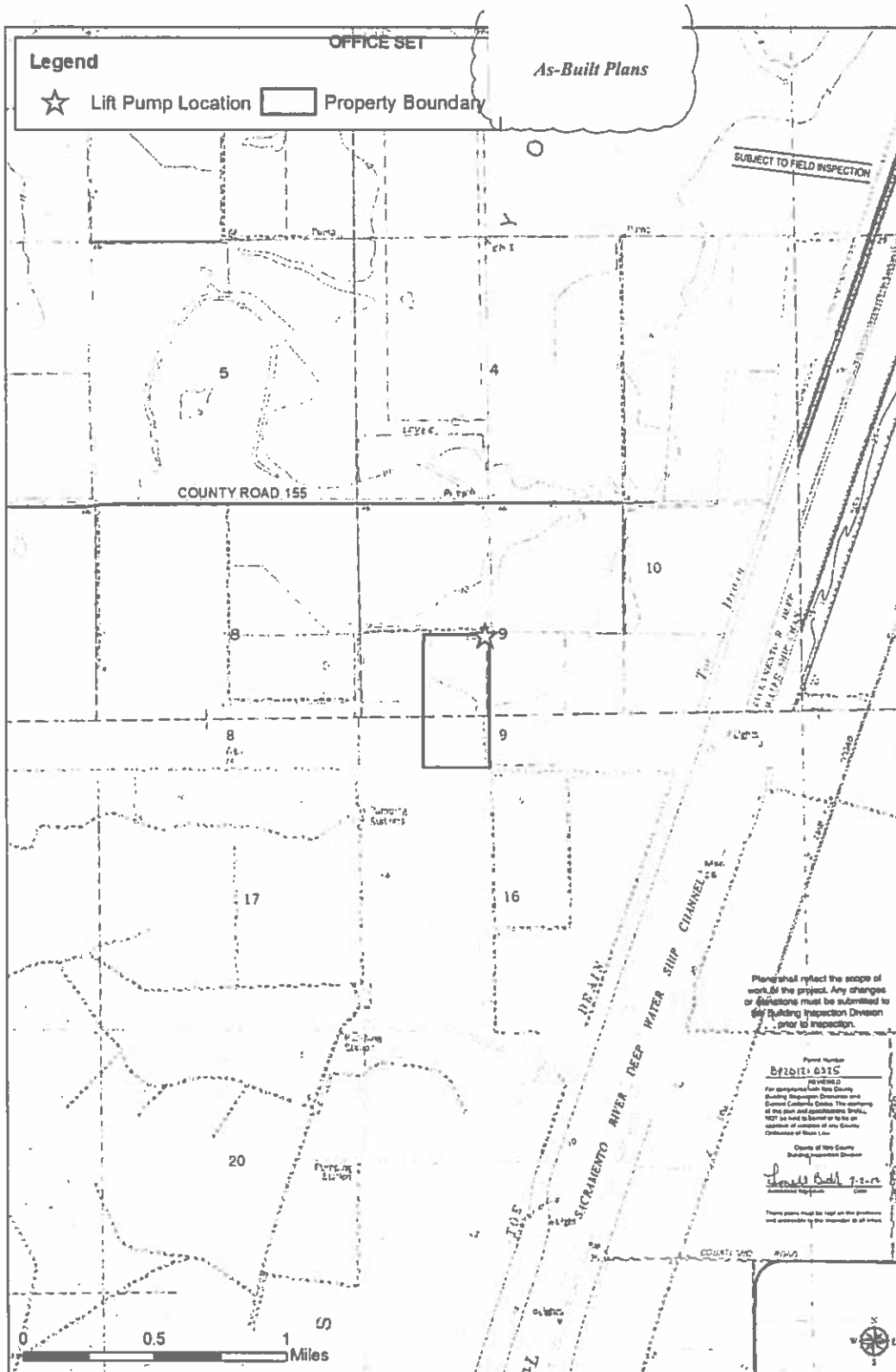

**Yolo Flyway Farms Lift Pump Installation**

Applicant: Charles Tyson  
 APN # 033 220 047

Sheet 1 of 3  
 Drawing prepared 2-29-2012

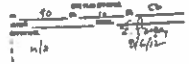

- The following APPROVALS are required prior to a final inspection:
- \_\_\_ Environmental Health Department
  - \_\_\_ Public Works Division
  - \_\_\_ Planning Division
  - \_\_\_ Service District
  - \_\_\_ Local Fire District
  - \_\_\_ The Sycamores
  - Other: George Valley Farm Pumps
  - \_\_\_ Other: \_\_\_\_\_

FLOODPLAIN PERMIT REQUIRED

**FLOOD ZONE**

Wildland-Urban Interface  
 Fire Hazard Severity Zone  
 Very High

OFFICE SET

**Legend**  
☆ Lift Pump Location    □ Property Boundary

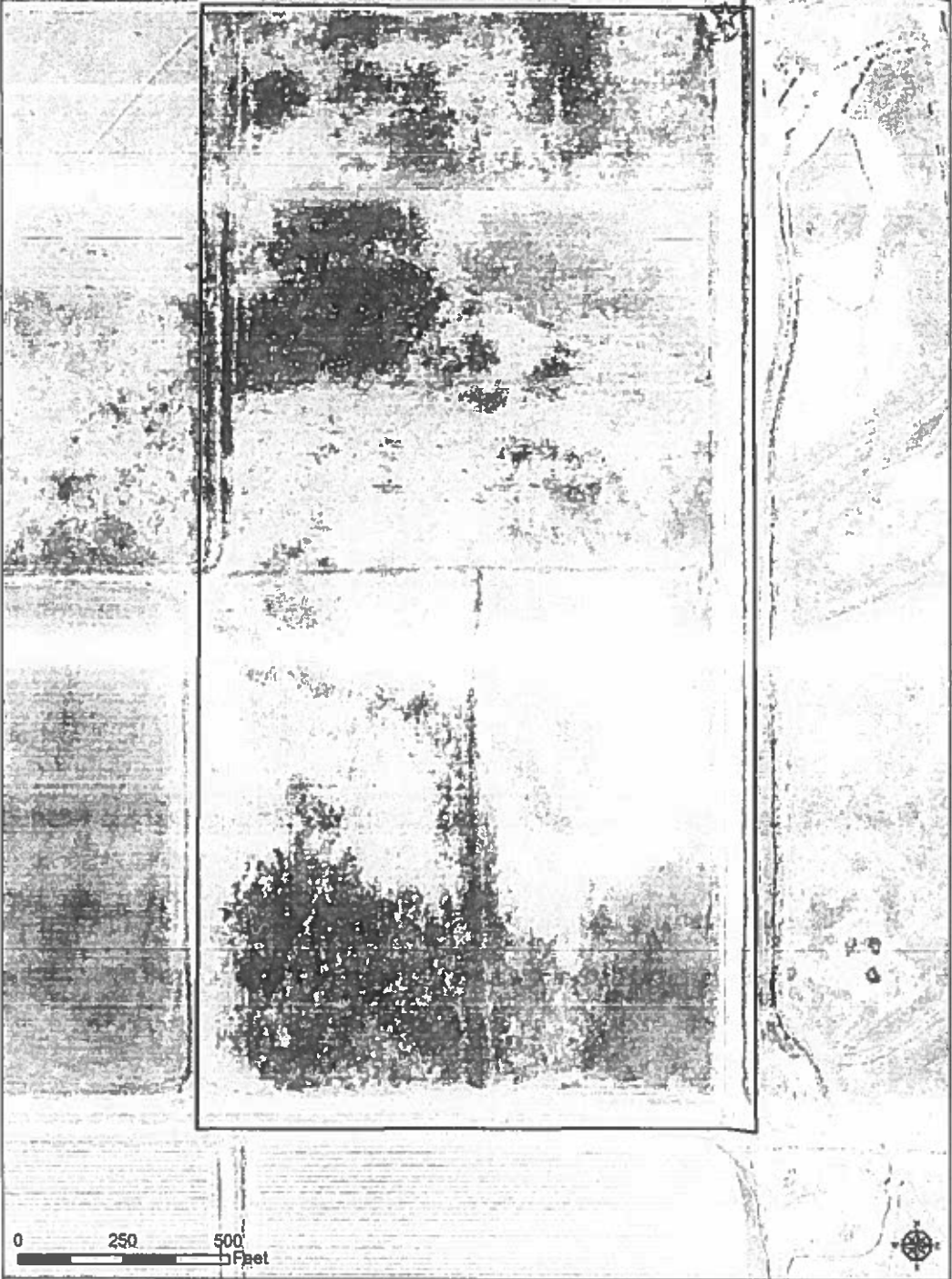

OFFICE SET

**Yolo Flyway Farms Lift Pump Installation**

Applicant: Charles Tyson

APN 4 033 220 049

Sheet 2 of 3

Drawing prepared 2-29-2012

All levee & Field grade elevations are based on LIDAR survey completed in 1997. Elevations are given in NAVD88 Feet.

Pump platform elevation is from survey completed in 2011 by licensed surveyor.

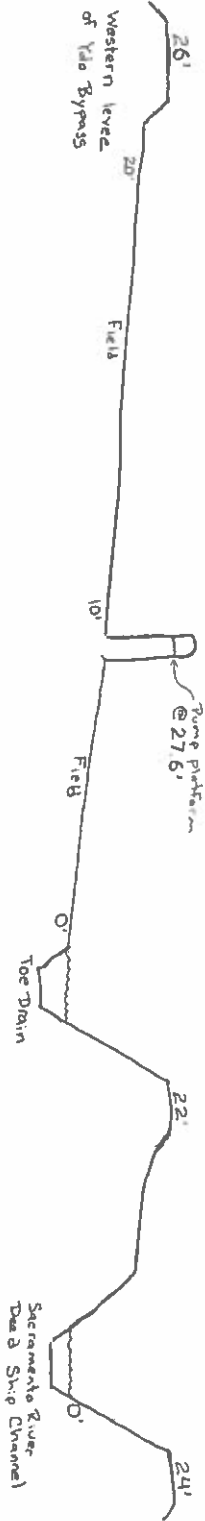

Yolo Bypass Water Levels  
@ Lisbon Weir which is 7 miles upstream from Pump location  
13' = Monitor Stage  
19' = Flood Stage  
24.37' = High water level on January 3, 2006

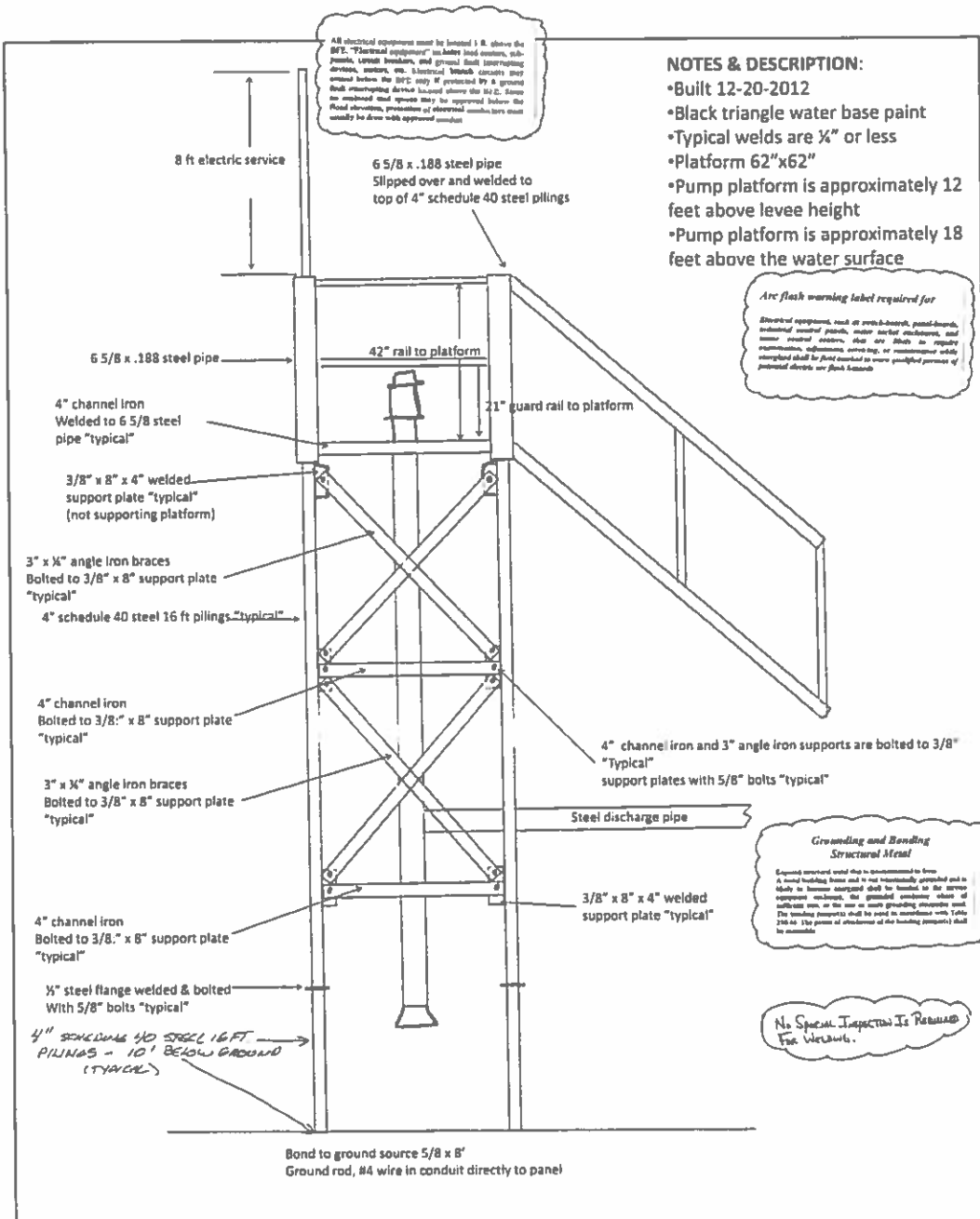

OFFICE SET

### Yolo Flyway Farms Lift Pump Station

Applicant: Charles Tyson  
 APN # 033 220 047  
 Sheet: 1 of 5

Drawing prepared: 6-8-2012

RECEIVED  
 Yolo County  
 Planning and  
 Public Works

### DITCH PLAN VIEW

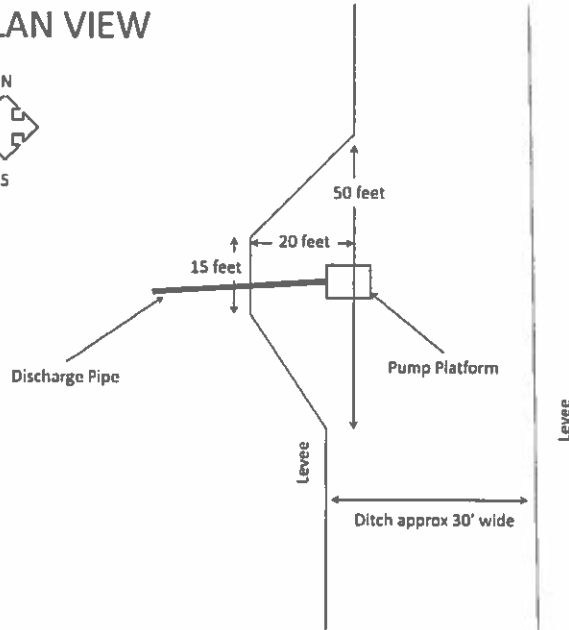

### DITCH CROSSSECTION

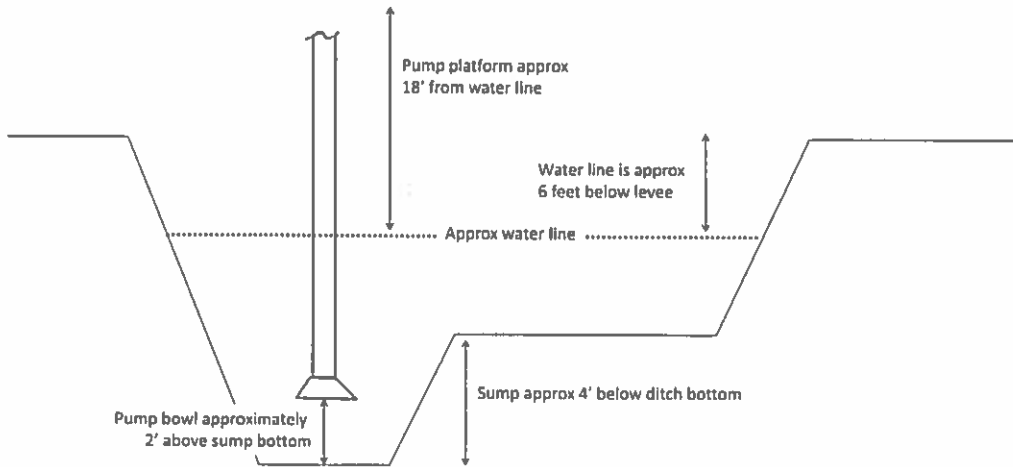

### Yolo Flyway Farms Lift Pump Station

Applicant: Charles Tyson

APN # 033 220 047

Sheet: 2 of 5

Drawing prepared: 6-8-2012

OFFICE SET



**BEYMER WELL SERVICE**

FAX # 530-671-0700  
PHONE (530) 671-3330  
CALIFORNIA CONTRACTORS LIC. NO. 80990  
3226 LIVE OAK BLVD. P.O. BOX 1212, YUBA CITY, CALIFORNIA 95991

**STAND DECK**

Stand deck is 26.7 square feet

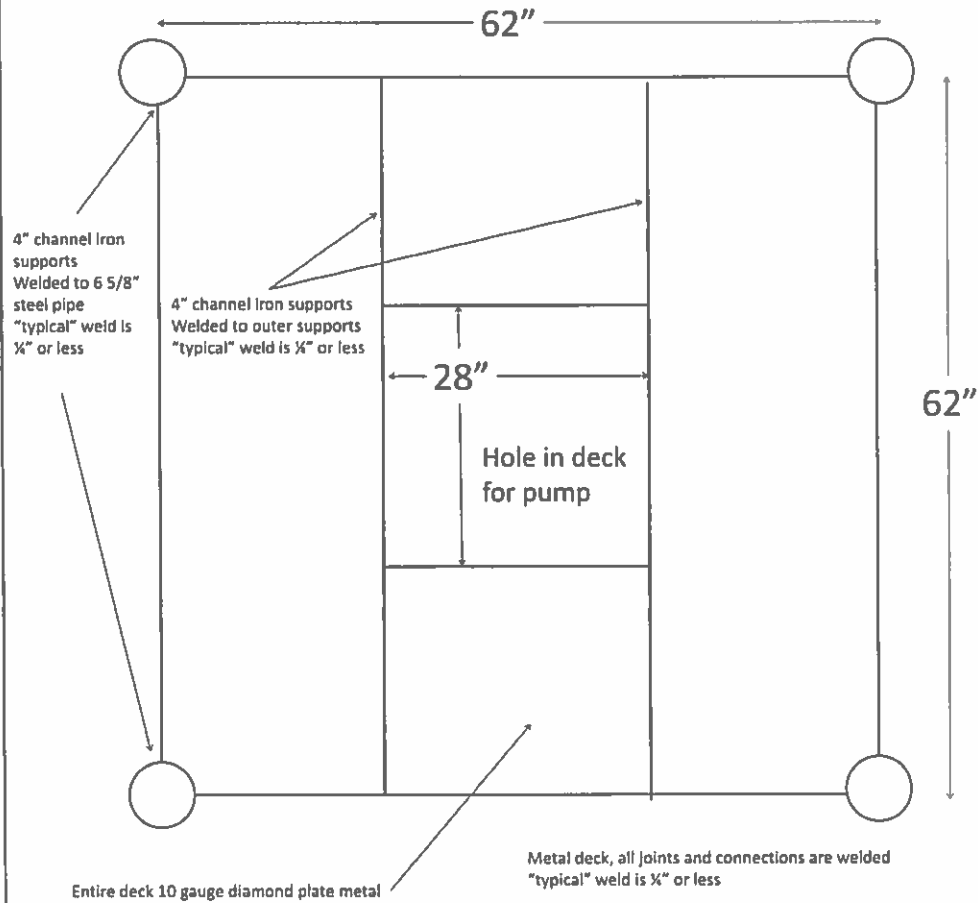

OFFICE SET

**Yolo Flyway Farms Lift Pump Station**

Applicant: Charles Tyson

APN # 033 220 049

Sheet: 3 of 5

Drawing prepared: 6-8-2012

**BEYMER WELL SERVICE**

FAX # 925-671-798  
PHONE (925) 671-4339  
CALIFORNIA CONTRACTORS LIC. NO. 80994  
2826 LIVE OAK BLVD. P.O. BOX 1212, YUBA CITY, CALIFORNIA 95991

**DECK RAIL & ENTRANCE**

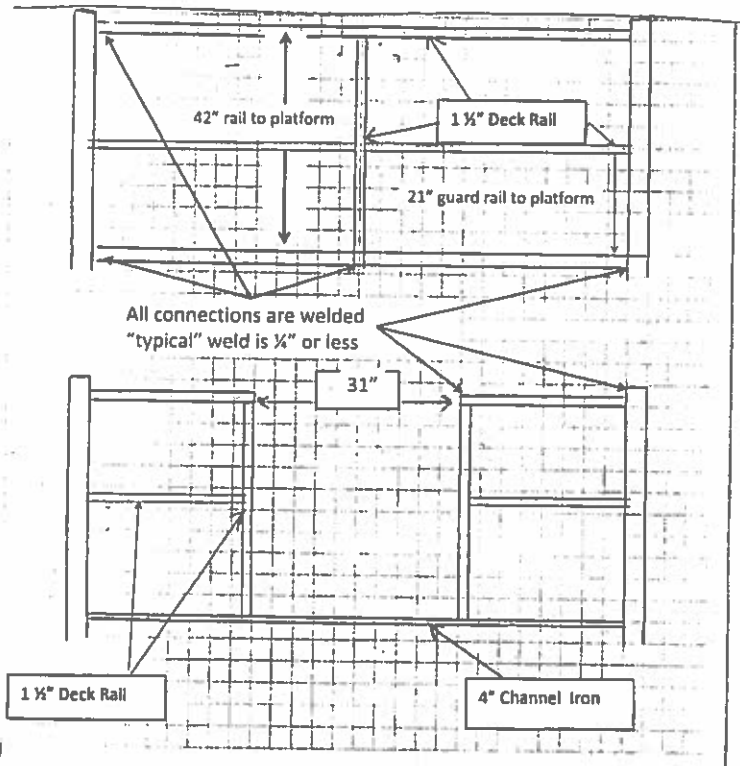

OFFICE SET

**Yolo Flyway Farms Lift Pump Station**

Applicant: Charles Tyson

ADN # 033 220 049

Sheet: 4 of 5

Drawing prepared: 6-8-2012

**HEYMER WELLS SERVICE**

708 6 880-4147  
PHONE 800-971-5100  
CALIFORNIA CONTRACTORS LIC. NO. 80006  
1825 LIVE OAK BLVD. P.O. BOX 1222, YUBA CITY, CALIFORNIA 95991

**STAIRS & RAIL**

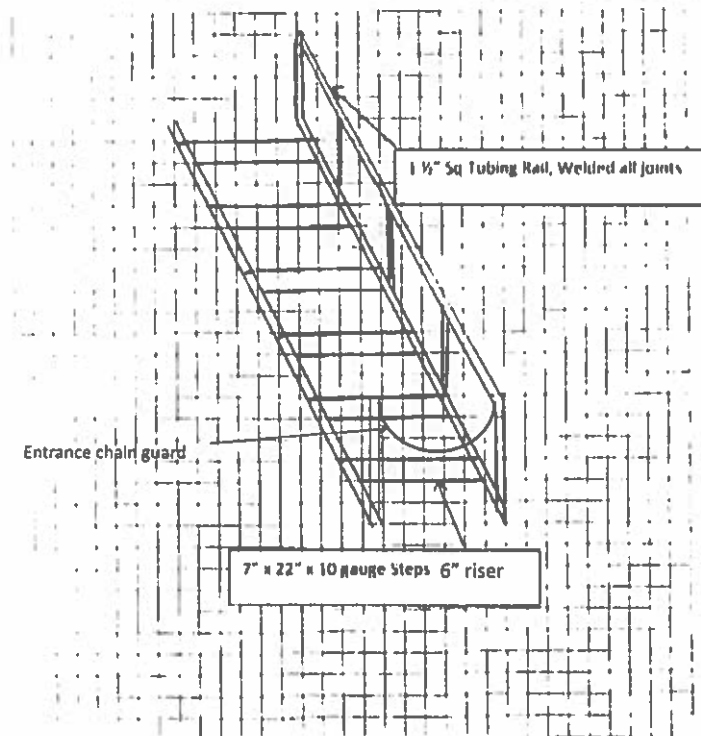

OFFICE SET

**Yolo Flyway Farms Lift Pump Station**

Applicant: Charles Tyson

APN # 033 220 049

Sheet: 5 of 5

Drawing prepared: 6-8-2012