

ELEVATION CERTIFICATE SET

OMB No. 1660-0008
Expires March 31, 2012

Important: Read the instructions on pages 1-9.

SECTION A - PROPERTY INFORMATION		For Insurance Company Use:
A1. Building Owner's Name LYMAN LAND COMPANY, LLC		Policy Number
A2. Building Street Address (including Apt., Unit, Suite, and/or Bldg. No.) or P.O. Route and Box No. 35410 JEFFERSON BLVD		Company NAIC Number
City CLARKSBURG State CA ZIP Code 95612		
A3. Property Description (Lot and Block Numbers, Tax Parcel Number, Legal Description, etc.) A.P.N. 043-200-006		
A4. Building Use (e.g., Residential, Non-Residential, Addition, Accessory, etc.) <u>AG STORAGE</u>		
A5. Latitude/Longitude: Lat. <u>38°25'30"N</u> Long. <u>121°34'30"W</u>		Horizontal Datum: <input type="checkbox"/> NAD 1927
<input checked="" type="checkbox"/> NAD 1983		
A6. Attach at least 2 photographs of the building if the Certificate is being used to obtain flood insurance.		
A7. Building Diagram Number <u>1B</u>		
A8. For a building with a crawlspace or enclosure(s):		A9. For a building with an attached garage:
a) Square footage of crawlspace or enclosure(s) <u>4865</u> sq ft		a) Square footage of attached garage <u>N/A</u> sq ft
b) No. of permanent flood openings in the crawlspace or enclosure(s) within 1.0 foot above adjacent grade <u>4</u>		b) No. of permanent flood openings in the attached garage within 1.0 foot above adjacent grade <u>N/A</u>
c) Total net area of flood openings in A8.b <u>5184</u> sq in		c) Total net area of flood openings in A9.b <u>N/A</u> sq in
d) Engineered flood openings? <input type="checkbox"/> Yes <input checked="" type="checkbox"/> No		d) Engineered flood openings? <input type="checkbox"/> Yes <input checked="" type="checkbox"/> No

Final Certificate

SECTION B - FLOOD INSURANCE RATE MAP (FIRM) INFORMATION

B1. NFIP Community Name & Community Number YOLO COUNTY 06113		B2. County Name YOLO		B3. State CA	
B4. Map/Panel Number 06113C0740	B5. Suffix G	B6. FIRM Index Date 06/18/2010	B7. FIRM Panel Effective/Revised Date 06/18/2010	B8. Flood Zone(s) ZONE A	B9. Base Flood Elevation(s) (Zone AO, use base flood depth) 24.00'

B10. Indicate the source of the Base Flood Elevation (BFE) data or base flood depth entered in Item B9.
 FIS Profile FIRM Community Determined Other (Describe) _____

B11. Indicate elevation datum used for BFE in Item B9: NGVD 1929 NAVD 1988 Other (Describe) _____

B12. Is the building located in a Coastal Barrier Resources System (CBRS) area or Otherwise Protected Area (OPA)? Yes No
 Designation Date _____ CBRS OPA

SECTION C - BUILDING ELEVATION INFORMATION (SURVEY REQUIRED)

C1. Building elevations are based on: Construction Drawings* Building Under Construction* Finished Construction
 *A new Elevation Certificate will be required when construction of the building is complete.

C2. Elevations - Zones A1-A30, AE, AH, A (with BFE), VE, V1-V30, V (with BFE), AR, AR/A, AR/AE, AR/A1-A30, AR/AH, AR/AO. Complete Items C2.a-h below according to the building diagram specified in Item A7. Use the same datum as the BFE.
 Benchmark Utilized GAFNEY Vertical Datum NAVD88
 Conversion/Comments NONE

Check the measurement used.

a) Top of bottom floor (including basement, crawlspace, or enclosure floor) 5.25 feet meters (Puerto Rico only)

b) Top of the next higher floor N/A feet meters (Puerto Rico only)

c) Bottom of the lowest horizontal structural member (V Zones only) N/A feet meters (Puerto Rico only)

d) Attached garage (top of slab) N/A feet meters (Puerto Rico only)

e) Lowest elevation of machinery or equipment servicing the building (Describe type of equipment and location in Comments) NONE feet meters (Puerto Rico only)

f) Lowest adjacent (finished) grade next to building (LAG) 4.50 feet meters (Puerto Rico only)

g) Highest adjacent (finished) grade next to building (HAG) 4.60 feet meters (Puerto Rico only)

h) Lowest adjacent grade at lowest elevation of deck or stairs, including structural support N/A feet meters (Puerto Rico only)

SECTION D - SURVEYOR, ENGINEER, OR ARCHITECT CERTIFICATION

This certification is to be signed and sealed by a land surveyor, engineer, or architect authorized by law to certify elevation information. I certify that the information on this Certificate represents my best efforts to interpret the data available. I understand that any false statement may be punishable by fine or imprisonment under 18 U.S. Code, Section 1001.

Check here if comments are provided on back of form. Were latitude and longitude in Section A provided by a licensed land surveyor? Yes No

Certifier's Name MICHAEL D. FARLEY License Number L.S. 6939

Title LAND SURVEYOR Company Name FARLEY SURVEYING

Address 7500 N. WEST LN City STOCKTON State CA ZIP Code 95210

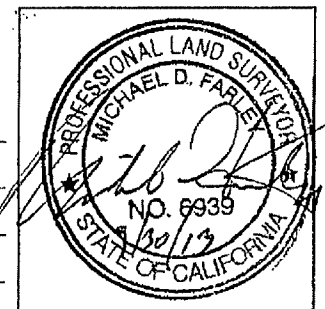

Michael D. Farley 3-26-2013 209-649-9905

IMPORTANT: In these spaces, copy the corresponding information from Section A.	For Insurance Company Use:
Building Street Address (including Apt., Unit, Suite, and/or Bldg. No.) or P.O. Route and Box No. 35410 JEFFERSON BLVD	Policy Number
City CLARKSBURG State CA ZIP Code 95612	Company NAIC Number

SECTION D - SURVEYOR, ENGINEER, OR ARCHITECT CERTIFICATION (CONTINUED)

Copy both sides of this Elevation Certificate for (1) community official, (2) insurance agent/company, and (3) building owner.

Comments THIS CERTIFICATE IS FOR A NEW AGRICULTURE STORAGE BUILDING. THE BASE FLOOD ELEVATION WAS DETERMINED WITH THE ASSISTANCE OF LONELL BUTLER, CHIEF BUILDING OFFICIAL WITH YOLO COUNTY. THIS BASE FLOOD ELEVATION IS BASED UPON A MAP FURNISHED BY FEMA TITLED "NORTHERN CALIFORNIA FLOOD ZONES OF SACRAMENTO, SAN JOAQUIN, SOLANO & YOLO COUNTIES", DATED AUG. 8, 2012. A COPY OF SAID MAP CAN BE OBTAINED AT PUBLIC WORKS DEPARTMENT OF YOLO COUNTY.

Signature [Handwritten Signature] Date 2-26-13 Final Certificate
 Check here if attachments

SECTION E - BUILDING ELEVATION INFORMATION (SURVEY NOT REQUIRED) FOR ZONE AO AND ZONE A (WITHOUT BFE)

For Zones AO and A (without BFE), complete Items E1-E5. If the Certificate is intended to support a LOMA or LOMR-F request, complete Sections A, B, and C. For Items E1-E4, use natural grade, if available. Check the measurement used. In Puerto Rico only, enter meters.

- E1. Provide elevation information for the following and check the appropriate boxes to show whether the elevation is above or below the highest adjacent grade (HAG) and the lowest adjacent grade (LAG).
 - a) Top of bottom floor (including basement, crawlspace, or enclosure) is 0.65 feet meters above or below the HAG.
 - b) Top of bottom floor (including basement, crawlspace, or enclosure) is 0.75 feet meters above or below the LAG.
- E2. For Building Diagrams 6-9 with permanent flood openings provided in Section A Items 8 and/or 9 (see pages 8-9 of Instructions), the next higher floor (elevation C2.b in the diagrams) of the building is _____ feet meters above or below the HAG.
- E3. Attached garage (top of slab) is N/A feet meters above or below the HAG.
- E4. Top of platform of machinery and/or equipment servicing the building is N/A feet meters above or below the HAG.
- E5. Zone AO only: If no flood depth number is available, is the top of the bottom floor elevated in accordance with the community's floodplain management ordinance? Yes No Unknown. The local official must certify this information in Section G. N/A

SECTION F - PROPERTY OWNER (OR OWNER'S REPRESENTATIVE) CERTIFICATION

The property owner or owner's authorized representative who completes Sections A, B, and E for Zone A (without a FEMA-issued or community-issued BFE) or Zone AO must sign here. The statements in Sections A, B, and E are correct to the best of my knowledge.

Property Owner's or Owner's Authorized Representative's Name N/A
 Address N/A City N/A State N/A ZIP Code N/A
 Signature N/A Date N/A Telephone N/A
 Comments N/A

Check here if attachments

SECTION G - COMMUNITY INFORMATION (OPTIONAL)

The local official who is authorized by law or ordinance to administer the community's floodplain management ordinance can complete Sections A, B, C (or E), and G of this Elevation Certificate. Complete the applicable item(s) and sign below. Check the measurement used in Items G8 and G9.

- 31. The information in Section C was taken from other documentation that has been signed and sealed by a licensed surveyor, engineer, or architect who is authorized by law to certify elevation information. (Indicate the source and date of the elevation data in the Comments area below.)
- 32. A community official completed Section E for a building located in Zone A (without a FEMA-issued or community-issued BFE) or Zone AO.
- 33. The following information (Items G4-G9) is provided for community floodplain management purposes.

G4. Permit Number <u>B220120593</u>	G5. Date Permit Issued <u>12/11/12</u>	G6. Date Certificate Of Compliance/Occupancy Issued
--	---	---

- 37. This permit has been issued for: New Construction Substantial Improvement
- 38. Elevation of as-built lowest floor (including basement) of the building: N/A feet meters (PR) Datum N/A
- 39. BFE or (in Zone AO) depth of flooding at the building site: N/A feet meters (PR) Datum N/A
- 310. Community's design flood elevation 24.0 feet meters (PR) Datum N.A.V.D. 88

Local Official's Name LONELL BUTLER Title BUILDING OFFICIAL
 Community Name YOLO COUNTY Telephone 666-8803
 Signature [Handwritten Signature] Date 2/27/13

Comments A MINOR FLOOD VARIANCE WAS ISSUED FOR AG EXEMPT PERMIT. AG BARN.

Check here if attachments