

ELEVATION CERTIFICATE

Important: Follow the instructions on pages 1-9.

Copy all pages of this Elevation Certificate and all attachments for (1) community official, (2) insurance agent/company, and (3) building owner.

SECTION A - PROPERTY INFORMATION						FOR INSURANCE COMPANY USE
A1. Building Owner's Name ERIC & ERIKA WILLIAMS					Policy Number:	
A2. Building Street Address (including Apt., Unit, Suite, and/or Bldg. No.) or P.O. Route and Box No. 27890 COUNTY ROAD 19 (SHOP #2)					Company NAIC Number:	
City ESPARTO		State CA		ZIP Code 95627		
A3. Property Description (Lot and Block Numbers, Tax Parcel Number, Legal Description, etc.) ASSESSOR'S PARCEL NUMBER: 048-200-002-000						
A4. Building Use (e.g., Residential, Non-Residential, Addition, Accessory, etc.) NON-RESIDENTIAL (SHOP #2)						
A5. Latitude/Longitude: Lat 38°43'56.9" Long. -121°59'20.2" Horizontal Datum: <input type="checkbox"/> NAD 1927 <input checked="" type="checkbox"/> NAD 1983						
A6. Attach at least 2 photographs of the building if the Certificate is being used to obtain flood insurance.						
A7. Building Diagram Number 1B						
A8. For a building with a crawlspace or enclosure(s):						
a) Square footage of crawlspace or enclosure(s) N/A sq ft						
b) Number of permanent flood openings in the crawlspace or enclosure(s) within 1.0 foot above adjacent grade N/A						
c) Total net area of flood openings in A8.b N/A sq in						
d) Engineered flood openings? <input type="checkbox"/> Yes <input checked="" type="checkbox"/> No						
A9. For a building with an attached garage:						
a) Square footage of attached garage N/A sq ft						
b) Number of permanent flood openings in the attached garage within 1.0 foot above adjacent grade N/A						
c) Total net area of flood openings in A9.b N/A sq in						
d) Engineered flood openings? <input type="checkbox"/> Yes <input checked="" type="checkbox"/> No						
SECTION B - FLOOD INSURANCE RATE MAP (FIRM) INFORMATION						
B1. NFIP Community Name & Community Number YOLO COUNTY UNINCORPORATED 060423			B2. County Name YOLO		B3. State CA	
B4. Map/Panel Number 06113C 0401	B5. Suffix G	B6. FIRM Index Date 05/16/2012	B7. FIRM Panel Effective/ Revised Date 06/18/2010	B8. Flood Zone(s) A	B9. Base Flood Elevation(s) (Zone AO, use Base Flood Depth) 171.0'	
B10. Indicate the source of the Base Flood Elevation (BFE) data or base flood depth entered in Item B9: <input type="checkbox"/> FIS Profile <input type="checkbox"/> FIRM <input checked="" type="checkbox"/> Community Determined <input type="checkbox"/> Other/Source: SEE SECTION D						
B11. Indicate elevation datum used for BFE in Item B9: <input checked="" type="checkbox"/> NGVD 1929 <input type="checkbox"/> NAVD 1988 <input type="checkbox"/> Other/Source:						
B12. Is the building located in a Coastal Barrier Resources System (CBRS) area or Otherwise Protected Area (OPA)? <input type="checkbox"/> Yes <input checked="" type="checkbox"/> No Designation Date _____ <input type="checkbox"/> CBRS <input type="checkbox"/> OPA						

ELEVATION CERTIFICATE

OMB No. 1660-0008
Expiration Date: November 30, 2018

IMPORTANT: In these spaces, copy the corresponding information from Section A.			FOR INSURANCE COMPANY USE	
Building Street Address (including Apt., Unit, Suite, and/or Bldg. No.) or P.O. Route and Box No. 27890 COUNTY ROAD 19 (SHOP #2)			Policy Number:	
City ESPARTO	State CA	ZIP Code 95627	Company NAIC Number	

SECTION C – BUILDING ELEVATION INFORMATION (SURVEY REQUIRED)

C1. Building elevations are based on: Construction Drawings* Building Under Construction* Finished Construction

*A new Elevation Certificate will be required when construction of the building is complete.

C2. Elevations – Zones A1–A30, AE, AH, A (with BFE), VE, V1–V30, V (with BFE), AR, AR/A, AR/AE, AR/A1–A30, AR/AH, AR/AO. Complete Items C2 a–h below according to the building diagram specified in Item A7. In Puerto Rico only, enter meters.

Benchmark Utilized: **ELEVATION FROM QUAD MAP** Vertical Datum: **N.G.V.D. 29**

Indicate elevation datum used for the elevations in items a) through h) below.

NGVD 1929 NAVD 1988 Other/Source: _____

Datum used for building elevations must be the same as that used for the BFE.

		Check the measurement used.
a) Top of bottom floor (including basement, crawlspace, or enclosure floor)	172 0	<input checked="" type="checkbox"/> feet <input type="checkbox"/> meters
b) Top of the next higher floor	N/A	<input type="checkbox"/> feet <input type="checkbox"/> meters
c) Bottom of the lowest horizontal structural member (V Zones only)	N/A	<input type="checkbox"/> feet <input type="checkbox"/> meters
d) Attached garage (top of slab)	N/A	<input type="checkbox"/> feet <input type="checkbox"/> meters
e) Lowest elevation of machinery or equipment servicing the building (Describe type of equipment and location in Comments)	173 8	<input checked="" type="checkbox"/> feet <input type="checkbox"/> meters
f) Lowest adjacent (finished) grade next to building (LAG)	171 8	<input checked="" type="checkbox"/> feet <input type="checkbox"/> meters
g) Highest adjacent (finished) grade next to building (HAG)	171 9	<input checked="" type="checkbox"/> feet <input type="checkbox"/> meters
h) Lowest adjacent grade at lowest elevation of deck or stairs, including structural support	171 8	<input checked="" type="checkbox"/> feet <input type="checkbox"/> meters

SECTION D – SURVEYOR, ENGINEER, OR ARCHITECT CERTIFICATION

This certification is to be signed and sealed by a land surveyor, engineer, or architect authorized by law to certify elevation information. I certify that the information on this Certificate represents my best efforts to interpret the data available. I understand that any false statement may be punishable by fine or imprisonment under 18 U.S. Code, Section 1001.

Were latitude and longitude in Section A provided by a licensed land surveyor? Yes No Check here if attachments.

Certifier's Name **CHRISTOPHER W. LERCH** License Number **L.S. 7906**

Title **PRINCIPAL/SENIOR SURVEYOR**

Company Name **LAUGENOUR AND MEIKLE**

Address **608 COURT STREET**

City **WOODLAND** State **CA** ZIP Code **95695**

Signature  Date **01/17/2020** Telephone **(530)662-1755**

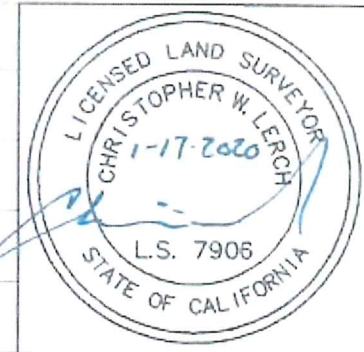

Copy all pages of this Elevation Certificate and all attachments for (1) community official, (2) insurance agent/company, and (3) building owner.

Comments (including type of equipment and location, per C2(e), if applicable)

BASE FLOOD ELEVATION WAS DETERMINED FROM ENGINEERING GRADING PLANS AND SEVERAL PREVIOUS ELEVATION CERTIFICATES APPROVED ON THIS PAD SINCE 2003. LOWEST MACHINERY IS AN ELECTRICAL PANEL.

ELEVATION CERTIFICATE

OMB No. 1660-0008
Expiration Date: November 30, 2018

IMPORTANT: In these spaces, copy the corresponding information from Section A.			FOR INSURANCE COMPANY USE
Building Street Address (including Apt., Unit, Suite, and/or Bldg. No.) or P.O. Route and Box No. 27890 COUNTY ROAD 19 (SHOP #2)			Policy Number:
City ESPARTO	State CA	ZIP Code 95627	Company NAIC Number

SECTION E – BUILDING ELEVATION INFORMATION (SURVEY NOT REQUIRED) FOR ZONE AO AND ZONE A (WITHOUT BFE)

For Zones AO and A (without BFE), complete Items E1–E5. If the Certificate is intended to support a LOMA or LOMR-F request, complete Sections A, B, and C. For Items E1–E4, use natural grade, if available. Check the measurement used. In Puerto Rico only, enter meters.

- E1 Provide elevation information for the following and check the appropriate boxes to show whether the elevation is above or below the highest adjacent grade (HAG) and the lowest adjacent grade (LAG).
- a) Top of bottom floor (including basement, crawlspace, or enclosure) is N/A feet meters above or below the HAG.
- b) Top of bottom floor (including basement, crawlspace, or enclosure) is N/A feet meters above or below the LAG.
- E2 For Building Diagrams 6–9 with permanent flood openings provided in Section A Items 8 and/or 9 (see pages 1–2 of Instructions), the next higher floor (elevation C2.b in the diagrams) of the building is N/A feet meters above or below the HAG.
- E3 Attached garage (top of slab) is N/A feet meters above or below the HAG.
- E4 Top of platform of machinery and/or equipment servicing the building is N/A feet meters above or below the HAG.
- E5. Zone AO only: If no flood depth number is available, is the top of the bottom floor elevated in accordance with the community's floodplain management ordinance? Yes No Unknown. The local official must certify this information in Section G.

SECTION F – PROPERTY OWNER (OR OWNER'S REPRESENTATIVE) CERTIFICATION

The property owner or owner's authorized representative who completes Sections A, B, and E for Zone A (without a FEMA-issued or community-issued BFE) or Zone AO must sign here. The statements in Sections A, B, and E are correct to the best of my knowledge.

Property Owner or Owner's Authorized Representative's Name N/A			
Address N/A	City N/A	State N/A	ZIP Code N/A
Signature	Date N/A	Telephone N/A	

Comments
N/A

Check here if attachments

ELEVATION CERTIFICATE

OMB No. 1660-0008
Expiration Date: November 30, 2018

IMPORTANT: In these spaces, copy the corresponding information from Section A.

Building Street Address (including Apt., Unit, Suite, and/or Bldg. No.) or P.O. Route and Box No.
27890 COUNTY ROAD 19 (SHOP #2)

City: **ESPARTO** State: **CA** ZIP Code: **95627**

FOR INSURANCE COMPANY USE

Policy Number:

Company NAIC Number:

SECTION G - COMMUNITY INFORMATION (OPTIONAL)

The local official who is authorized by law or ordinance to administer the community's floodplain management ordinance can complete Sections A, B, C (or E), and G of this Elevation Certificate. Complete the applicable item(s) and sign below. Check the measurement used in Items G8-G10. In Puerto Rico only, enter meters.

- G1. The information in Section C was taken from other documentation that has been signed and sealed by a licensed surveyor, engineer, or architect who is authorized by law to certify elevation information. (Indicate the source and date of the elevation data in the Comments area below.)
- G2. A community official completed Section E for a building located in Zone A (without a FEMA-issued or community-issued BFE) or Zone AO.
- G3. The following information (Items G4-G10) is provided for community floodplain management purposes.

G4. Permit Number	G5. Date Permit Issued	G6. Date Certificate of Compliance/Occupancy Issued

G7. This permit has been issued for: New Construction Substantial Improvement

G8. Elevation of as-built lowest floor (including basement) of the building: _____ feet meters Datum _____

G9. BFE or (in Zone AO) depth of flooding at the building site: _____ feet meters Datum _____

G10. Community's design flood elevation: _____ feet meters Datum _____

Local Official's Name _____ Title _____

Community Name _____ Telephone _____

Signature _____ Date _____

Comments (including type of equipment and location, per C2(e), if applicable)

Check here if attachments.

BUILDING PHOTOGRAPHS

See Instructions for Item A6.

OMB No. 1660-0008

Expiration Date: November 30, 2018

ELEVATION CERTIFICATE

IMPORTANT: In these spaces, copy the corresponding information from Section A.

Building Street Address (including Apt., Unit, Suite, and/or Bldg. No.) or P.O. Route and Box No.
27890 COUNTY ROAD 19 (SHOP #2)

City

ESPARTO

State

CA

ZIP Code

95627

FOR INSURANCE COMPANY USE

Policy Number:

Company NAIC Number

If using the Elevation Certificate to obtain NFIP flood insurance, affix at least 2 building photographs below according to the instructions for Item A6. Identify all photographs with date taken; "Front View" and "Rear View"; and, if required, "Right Side View" and "Left Side View." When applicable, photographs must show the foundation with representative examples of the flood openings or vents, as indicated in Section A8. If submitting more photographs than will fit on this page, use the Continuation Page.

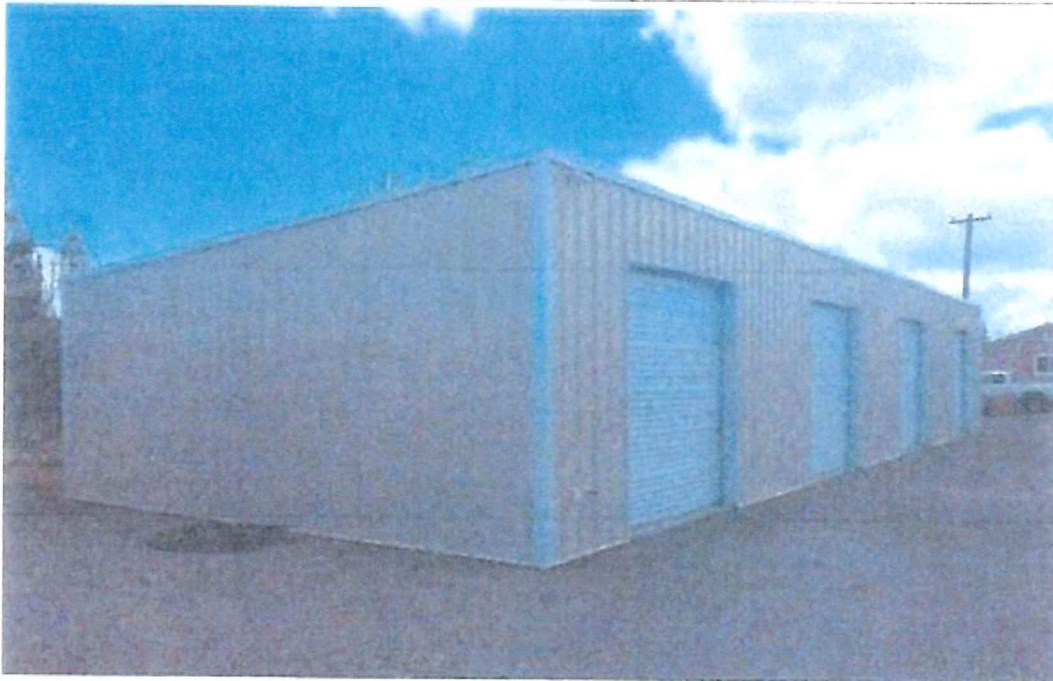

Photo One Caption **FRONT & LEFT SIDE VIEWS (TAKEN 03/26/2018)**

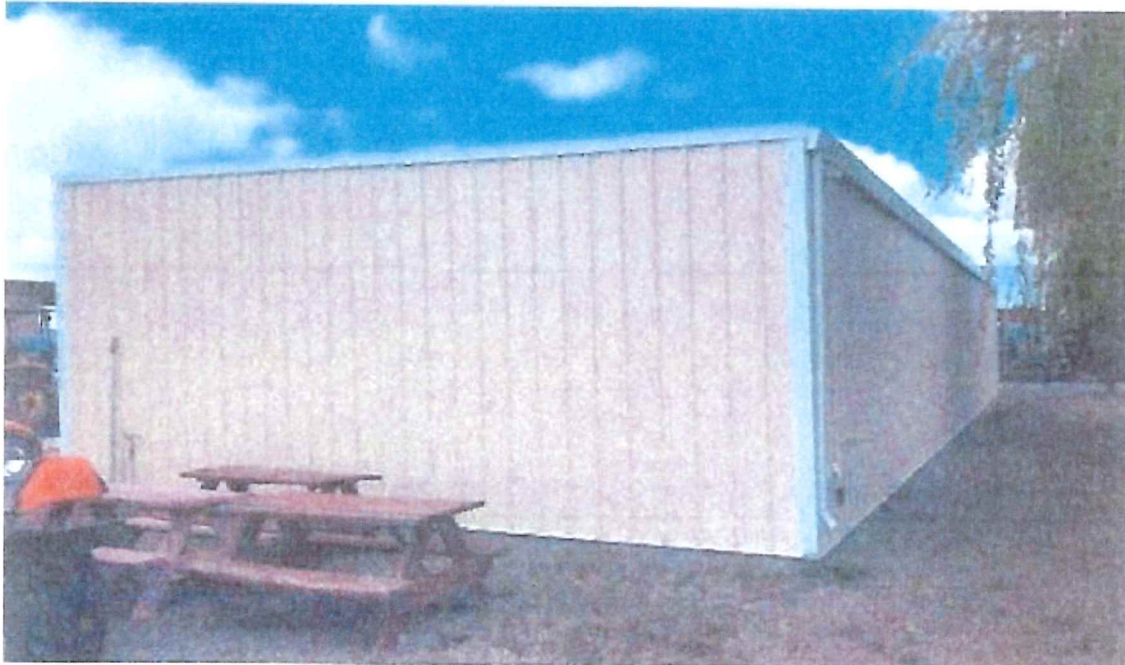

Photo Two Caption **REAR & RIGHT SIDE VIEWS (TAKEN 03/26/2018)**

ELEVATION CERTIFICATE

BUILDING PHOTOGRAPHS

Continuation Page

OMB No. 1660-0008
Expiration Date: November 30, 2018

IMPORTANT: In these spaces, copy the corresponding information from Section A.			FOR INSURANCE COMPANY USE
Building Street Address (including Apt., Unit, Suite, and/or Bldg. No.) or P.O. Route and Box No. 27890 COUNTY ROAD 19 (SHOP #2)			Policy Number:
City ESPARTO	State CA	ZIP Code 95627	Company NAIC Number

If submitting more photographs than will fit on the preceding page, affix the additional photographs below. Identify all photographs with: date taken; "Front View" and "Rear View"; and, if required, "Right Side View" and "Left Side View." When applicable, photographs must show the foundation with representative examples of the flood openings or vents, as indicated in Section A8.

Photo One Caption

Photo Two Caption

WILLIAMS

2864

Legend

 Polyline [A5B2]:0



19

300 ft

Google Earth

© 2015 Google