

FEDERAL EMERGENCY MANAGEMENT AGENCY  
NATIONAL FLOOD INSURANCE PROGRAM

O.M.B. No. 3067-0077  
Expires December 31, 2005

ELEVATION CERTIFICATE

Important: Read the instructions on pages 1 - 7.

205-0945

SECTION A - PROPERTY OWNER INFORMATION

BUILDING OWNER'S NAME ABRAHAM ARELLANO

BUILDING STREET ADDRESS (Including Apt., Unit, Suite, and/or Bldg. No.) OR P.O. ROUTE AND BOX NO. 29984 CO. RD. 19

CITY WOODLAND STATE CA ZIP CODE 95695

PROPERTY DESCRIPTION (Lot and Block Numbers, Tax Parcel Number, Legal Description, etc.) APN 049-030-07

BUILDING USE (e.g., Residential, Non-residential, Addition, Accessory, etc. Use a Comments area, if necessary.) RESIDENTIAL

LATITUDE/LONGITUDE (OPTIONAL) (##° - ##' - ##" or ##.#####)

HORIZONTAL DATUM:  NAD 1927  NAD 1983 SOURCE:  GPS (Type):  USGS Quad Map  Other

SECTION B - FLOOD INSURANCE RATE MAP (FIRM) INFORMATION

B1. NFIP COMMUNITY NAME & COMMUNITY NUMBER

B2. COUNTY NAME YOLO

B3. STATE CA

B4. MAP AND PANEL NUMBER <u>060423-0377</u>	B5. SUFFIX <u>B.</u>	B6. FIRM INDEX DATE <u>12-16-80</u>	B7. FIRM PANEL EFFECTIVE/REVISED DATE	B8. FLOOD ZONE(S) <u>A</u>	B9. BASE FLOOD ELEVATION(S) (Zone AO, use depth of flooding) <u>155.6</u>
--	-------------------------	--	---------------------------------------	-------------------------------	--

B10. Indicate the source of the Base Flood Elevation (BFE) data or base flood depth entered in B9.  FIS Profile  FIRM  Community Determined  Other (Describe): INTERPOLATED FROM USGS QUAD. PER BM 169 AT RTE 505 AND CO. R

B11. Indicate the elevation datum used for the BFE in B9:  NGVD 1929  NAVD 1988  Other (Describe): AND CO. R

B12. Is the building located in a Coastal Barrier Resources System (CBRS) area or Otherwise Protected Area (OPA)?  Yes  No  
Designation Date: \_\_\_\_\_

SECTION C - BUILDING ELEVATION INFORMATION (SURVEY REQUIRED)

C1. Building elevations are based on:  Construction Drawings\*  Building Under Construction\*  Finished Construction  
\*A new Elevation Certificate will be required when construction of the building is complete.

C2. Building Diagram Number 8 (Select the building diagram most similar to the building for which this certificate is being completed - see pages 6 and 7. If no diagram accurately represents the building, provide a sketch or photograph.)

C3. Elevations - Zones A1-A30, AE, AH, A (with BFE), VE, V1-V30, V (with BFE), AR, AR/A, AR/AE, AR/A1-A30, AR/AH, AR/AO  
Complete Items C3.a-i below according to the building diagram specified in Item C2. State the datum used. If the datum is different from the datum used for the BFE in Section B, convert the datum to that used for the BFE. Show field measurements and datum conversion calculation. Use the space provided or the Comments area of Section D or Section G, as appropriate, to document the datum conversion.  
Datum NGVD 1929 Conversion/Comments \_\_\_\_\_  
Elevation reference mark used BM 169 - USGS Does the elevation reference mark used appear on the FIRM?  Yes  No

a) Top of bottom floor (including basement or enclosure) 159.1 (ft)(m)

b) Top of next higher floor \_\_\_\_\_ ft.(m)

c) Bottom of lowest horizontal structural member (V zones only) \_\_\_\_\_ ft.(m)

d) Attached garage (top of slab) 158.1 (ft)(m)

e) Lowest elevation of machinery and/or equipment servicing the building (Describe in a Comments area.) 157.1 (ft)(m)

f) Lowest adjacent (finished) grade (LAG) 155.0 (ft)(m)

g) Highest adjacent (finished) grade (HAG) 156.8 (ft)(m)

h) No. of permanent openings (flood vents) within 1 ft. above adjacent grade 22

i) Total area of all permanent openings (flood vents) in C3.h 1980 sq. in. (sq. cm)

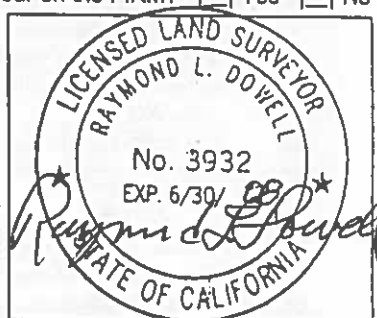

SECTION D - SURVEYOR, ENGINEER, OR ARCHITECT CERTIFICATION

This certification is to be signed and sealed by a land surveyor, engineer, or architect authorized by law to certify elevation information. I certify that the information in Sections A, B, and C on this certificate represents my best efforts to interpret the data available. I understand that any false statement may be punishable by fine or imprisonment under 18 U.S. Code, Section 1001.

CERTIFIER'S NAME RAYMOND L. DOWELL LICENSE NUMBER LS 3932

TITLE OWNER COMPANY NAME RAYMOND DOWELL LAND SURVEYOR

ADDRESS 17873 CO. RD. 97 CITY WOODLAND STATE CA ZIP CODE 95695

SIGNATURE Raymond L. Dowell DATE 7/29/06 TELEPHONE 530-662-0807

DP # 205-0945

IMPORTANT: In these spaces, copy the corresponding information from Section A.

BUILDING STREET ADDRESS (Including Apt., Unit, Suite, and/or Bldg. No.) OR P.O. ROUTE AND BOX NO.

29984 CO. RD. 19

CITY

WOODLAND

STATE

CA.

ZIP CODE

95695

Insurance Company Use
Policy Number
Company NAIC Number

SECTION D - SURVEYOR, ENGINEER, OR ARCHITECT CERTIFICATION (CONTINUED)

Copy both sides of this Elevation Certificate for (1) community official, (2) insurance agent/company, and (3) building owner.

COMMENTS

THIS HOUSE SITE DOES NOT CREATE ANY SIGNIFICANT BLOCKAGE TO THE FLOW OF DRAINAGE WATER ACROSS THIS OVERFLOW AREA

Check here if attachments

SECTION E - BUILDING ELEVATION INFORMATION (SURVEY NOT REQUIRED) FOR ZONE AO AND ZONE A (WITHOUT BFE)

For Zone AO and Zone A (without BFE), complete Items E1. through E5. If the Elevation Certificate is intended for use as supporting information for a LOMA or LOMR-F, Section C must be completed.

- E1. Building Diagram Number (Select the building diagram most similar to the building for which this certificate is being completed - see pages 6 and 7. If no diagram accurately represents the building, provide a sketch or photograph.)
- E2. The top of the bottom floor (including basement or enclosure) of the building is ft. (m) in. (cm) above or below (check one) the highest adjacent grade. (Use natural grade, if available.)
- E3. For Building Diagrams 6-8 with openings (see page 7), the next higher floor or elevated floor (elevation b) of the building is ft. (m) in. (cm) above the highest adjacent grade. Complete Items C3.h and C3.i on front of form.
- E4. The top of the platform of machinery and/or equipment servicing the building is ft. (m) in. (cm) above or below (check one) the highest adjacent grade. (Use natural grade, if available.)
- E5. For Zone AO only: If no flood depth number is available, is the top of the bottom floor elevated in accordance with the community's floodplain management ordinance? Yes No Unknown. The local official must certify this information in Section G.

SECTION F - PROPERTY OWNER (OR OWNER'S REPRESENTATIVE) CERTIFICATION

The property owner or owner's authorized representative who completes Sections A, B, C (Items C3.h and C3.i only), and E for Zone A (without a FEMA-issued or community-issued BFE) or Zone AO must sign here. The statements in Sections A, B, C, and E are correct to the best of my knowledge.

PROPERTY OWNER'S OR OWNER'S AUTHORIZED REPRESENTATIVE'S NAME

RAYMOND L. DOWELL LS. 3932

ADDRESS

17873 CO. RD 97

CITY

WOODLAND

STATE

CA.

ZIP CODE

95695

SIGNATURE

Raymond L. Dowell

DATE

7/29/06

TELEPHONE

530-662-0807

COMMENTS

Check here if attachments

SECTION G - COMMUNITY INFORMATION (OPTIONAL)

The local official who is authorized by law or ordinance to administer the community's floodplain management ordinance can complete Sections A, B, C (or E), and G of this Elevation Certificate. Complete the applicable item(s) and sign below.

- G1. The information in Section C was taken from other documentation that has been signed and embossed by a licensed surveyor, engineer, or architect who is authorized by state or local law to certify elevation information. (Indicate the source and date of the elevation data in the Comments area below.)
- G2. A community official completed Section E for a building located in Zone A (without a FEMA-issued or community-issued BFE) or Zone AO.
- G3. The following information (Items G4-G9) is provided for community floodplain management purposes.

G4. PERMIT NUMBER 205-0945	G5. DATE PERMIT ISSUED NOVEMBER 8, 2005	G6. DATE CERTIFICATE OF COMPLIANCE/OCCUPANCY ISSUED AUGUST 8, 2006
-------------------------------	--	---

G7. This permit has been issued for: New Construction Substantial Improvement

G8. Elevation of as-built lowest floor (including basement) of the building is:

159 . 1 ft. (m) Datum:

G9. BFE or (in Zone AO) depth of flooding at the building site is:

155 . 6 ft. (m) Datum:

LOCAL OFFICIAL'S NAME

Lonell Butler

TITLE

CHIEF BUILDING OFFICIAL

COMMUNITY NAME

YOLO COUNTY

TELEPHONE

(530) 666-8775

SIGNATURE

Lonell Butler

DATE

AUGUST 11, 2006

COMMENTS

Check here if attachments

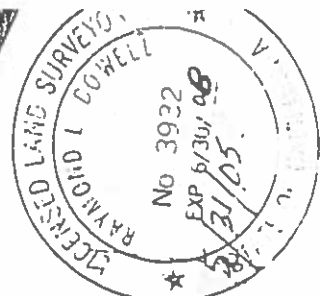
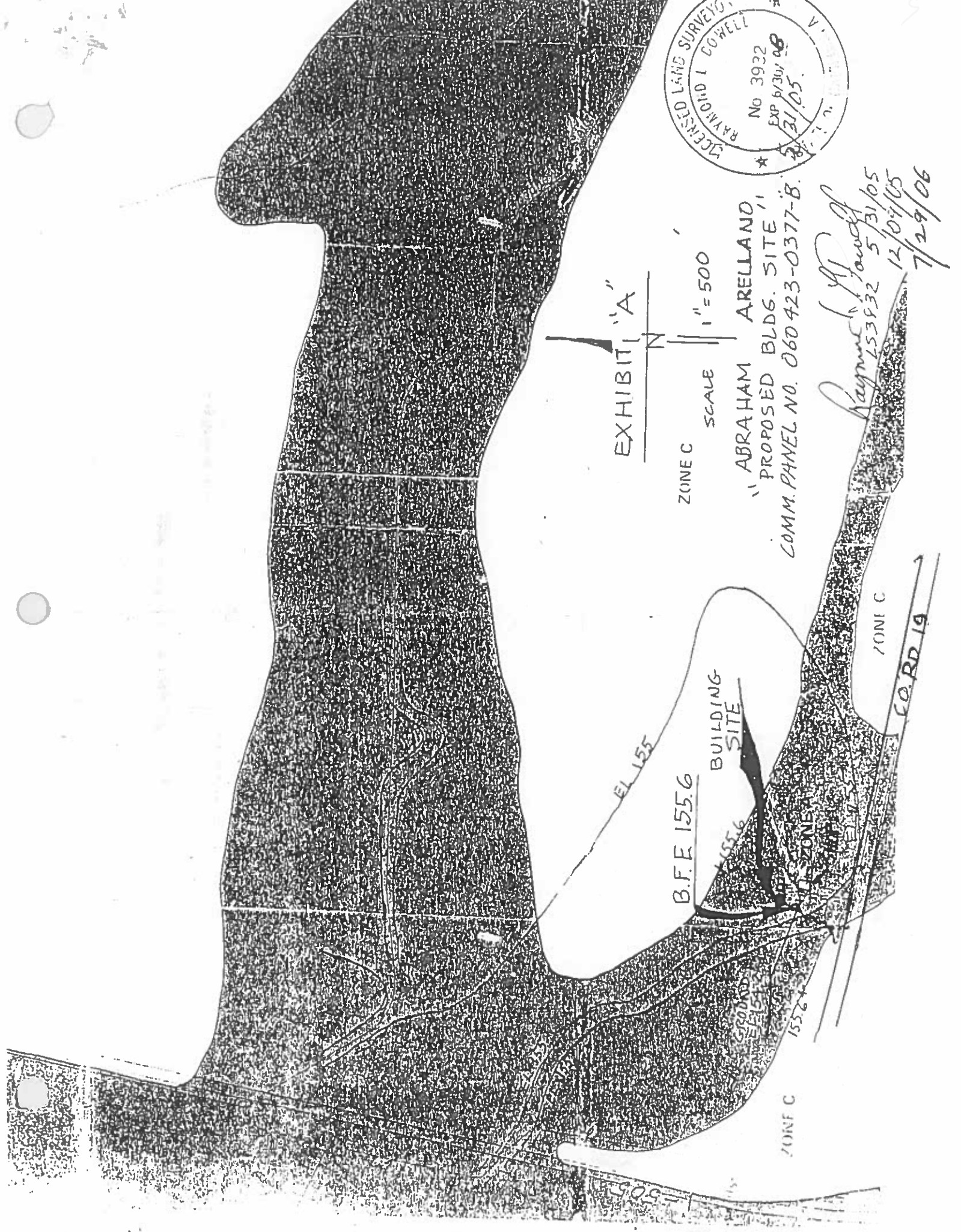

EXHIBIT "A"

ZONE C SCALE 1" = 500'

ABRAHAM ARELLANO  
" PROPOSED BLDG. SITE "  
COMM. PANEL NO. 060423-0377-B.

*Raymond L. Cowell*  
153432 5/31/05  
12/04/05  
7/29/06



EL 155

B.F.E 155.6

BUILDING SITE

155.6

GROUND ELEV 155.6

ZONE C

ZONE C

CO. RD 19

