

FEDERAL EMERGENCY MANAGEMENT AGENCY
NATIONAL FLOOD INSURANCE PROGRAM

O.M.B. No. 3067-0077
Expires December 31, 2005

ELEVATION CERTIFICATE

Important: Read the instructions on pages 1 - 7.

SECTION A - PROPERTY OWNER INFORMATION		For Insurance Company Use:
BUILDING OWNER'S NAME ERENT STEPHENS		Policy Number
BUILDING STREET ADDRESS (Including Apt., Unit, Suite, and/or Bldg. No.) OR P.O. ROUTE AND BOX NO. 17785 COUNTY ROAD 86A		Company NAIC Number
CITY ESPARTO	STATE CA	ZIP CODE 95627
PROPERTY DESCRIPTION (Lot and Block Numbers, Tax Parcel Number, Legal Description, etc.) A.P.N. 049-110-16		
BUILDING USE (e.g., Residential, Non-residential, Addition, Accessory, etc. Use a Comments area, if necessary.) RESIDENTIAL		
LATITUDE/LONGITUDE (OPTIONAL) (##° - ##' - ##.###" or ##.#####")	HORIZONTAL DATUM: <input type="checkbox"/> NAD 1927 <input type="checkbox"/> NAD 1983	SOURCE: <input type="checkbox"/> GPS (Type): _____ <input type="checkbox"/> USGS Quad Map <input type="checkbox"/> Other: _____

SECTION B - FLOOD INSURANCE RATE MAP (FIRM) INFORMATION

B1. NFIP COMMUNITY NAME & COMMUNITY NUMBER YOLO COUNTY UNINCORPORATED 060423		B2. COUNTY NAME YOLO	B3. STATE CA
B4. MAP AND PANEL NUMBER 060423 0367	B5. SUFFIX B	B6. FIRM INDEX DATE 04/02/02	B7. FIRM PANEL EFFECTIVE/REVISED DATE 12/16/80
B8. FLOOD ZONE(S) A		B9. BASE FLOOD ELEVATION(S) (Zone AO, use depth of flooding) 180.5 (SEE SECTION D)	

B10. Indicate the source of the Base Flood Elevation (BFE) data or base flood depth entered in B9.
 FIS Profile FIRM Community Determined Other (Describe): **(SEE SECTION D)**

B11. Indicate the elevation datum used for the BFE in B9: NGVD 1929 NAVD 1988 Other (Describe): _____

B12. Is the building located in a Coastal Barrier Resources System (CBRS) area or Otherwise Protected Area (OPA)? Yes No Designation Date _____

SECTION C - BUILDING ELEVATION INFORMATION (SURVEY REQUIRED)

C1. Building elevations are based on: Construction Drawings* Building Under Construction* Finished Construction
 *A new Elevation Certificate will be required when construction of the building is complete.

C2. Building Diagram Number **8** (Select the building diagram most similar to the building for which this certificate is being completed - see pages 6 and 7. If no diagram accurately represents the building, provide a sketch or photograph.)

C3. Elevations - Zones A1-A30, AE, AH, A (with BFE), VE, V1-V30, V (with BFE), AR, AR/A, AR/AE, AR/A1-A30, AR/AH, AR/AO
 Complete Items C3.-a-i below according to the building diagram specified in Item C2. State the datum used. If the datum is different from the datum used for the BFE in Section B, convert the datum to that used for the BFE. Show field measurements and datum conversion calculation. Use the space provided or the Comments area of Section D or Section G, as appropriate, to document the datum conversion.

Datum **NAVD 88** Conversion/Comments **NONE**

Elevation reference mark used **RM 7, PANEL 0386C**. Does the elevation reference mark used appear on the FIRM? Yes No

a) Top of bottom floor (including basement or enclosure)(CRAWL SPACE) **179.7** ft.(m)

b) Top of next higher floor **(FINISHED FLOOR) 182.4** ft.(m)

c) Bottom of lowest horizontal structural member (V zones only) **N/A** ft.(m)

d) Attached garage (top of slab) **N/A** ft.(m)

e) Lowest elevation of machinery and/or equipment servicing the building (Describe in a Comments area) **179.4** ft.(m)

f) Lowest adjacent (finished) grade (LAG) **179.7** ft.(m)

g) Highest adjacent (finished) grade (HAG) **179.7** ft.(m)

h) No. of permanent openings (flood vents) within 1 ft. above adjacent grade **14**

i) Total area of all permanent openings (flood vents) in C3.h **1,470** sq. in. (sq. cm)

PREVIOUSLY
SEP 15 2010
SCANNED

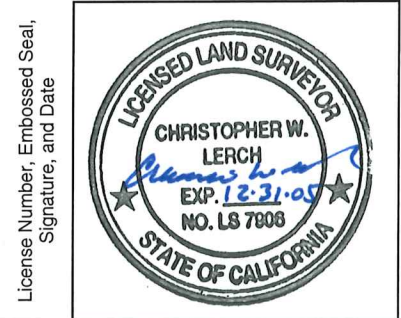

SECTION D - SURVEYOR, ENGINEER, OR ARCHITECT CERTIFICATION

This certification is to be signed and sealed by a land surveyor, engineer, or architect authorized by law to certify elevation information.
 I certify that the information in Sections A, B, and C on this certificate represents my best efforts to interpret the data available.
 I understand that any false statement may be punishable by fine or imprisonment under 18 U.S. Code, Section 1001.

CERTIFIER'S NAME CHRISTOPHER W. LERCH	LICENSE NUMBER L.S. 7906, EXPIRES 12/31/05
TITLE SENIOR SURVEYOR	COMPANY NAME LAUGENOUR AND MEIKLE
ADDRESS 3 COURT STREET	CITY WOODLAND
SIGNATURE <i>Christopher W. Lerch</i>	STATE CA
	ZIP CODE 95695
	DATE JULY 6, 2004
	TELEPHONE (530)662-1755

IMPORTANT: In these spaces, copy the corresponding information from Section A.			For Insurance Company Use:
BUILDING STREET ADDRESS (Including Apt., Unit, Suite, and/or Bldg. No.) OR P.O. ROUTE AND BOX NO. 17785 COUNTY ROAD 86A			Policy Number
CITY ESPARTO	STATE CA	ZIP CODE 95627	Company NAIC Number

SECTION D - SURVEYOR, ENGINEER, OR ARCHITECT CERTIFICATION (CONTINUED)

Both sides of this Elevation Certificate for (1) community official, (2) insurance agent/company, and (3) building owner.

COMMENTS

B.F.E. WAS DETERMINED FROM A TOPOGRAPHIC SURVEY COMPARING ELEVATIONS OUTSIDE OF FLOOD AREA NEAR THE SITE.

→ THE LOWEST MACHINERY IS THE PROPANE TANK.

Check here if attachments

SECTION E - BUILDING ELEVATION INFORMATION (SURVEY NOT REQUIRED) FOR ZONE AO AND ZONE A (WITHOUT BFE)

For Zone AO and Zone A (without BFE), complete Items E1 through E4. If the Elevation Certificate is intended for use as supporting information for a LOMA or LOMR-F, Section C must be completed.

- E1. Building Diagram Number 8 (Select the building diagram most similar to the building for which this certificate is being completed – see pages 6 and 7. If no diagram accurately represents the building, provide a sketch or photograph.)
- E2. The top of the bottom floor (including basement or enclosure) of the building is 0 ft.(m) 0 in.(cm) above or below (check one) the highest adjacent grade. (Use natural grade, if available).
- E3. For Building Diagrams 6-8 with openings (see page 7), the next higher floor or elevated floor (elevation b) of the building is 2 ft.(m) 8 in.(cm) above the highest adjacent grade. Complete items C3.h and C3.i on front of form.
- E4. The top of the platform of machinery and/or equipment servicing the building is 0 ft.(m) 4 in.(cm) above or below (check one) the highest adjacent grade. (Use natural grade, if available).
- E5. For Zone AO only: If no flood depth number is available, is the top of the bottom floor elevated in accordance with the community's floodplain management ordinance?
 Yes No Unknown. The local official must certify this information in Section G.

SECTION F - PROPERTY OWNER (OR OWNER'S REPRESENTATIVE) CERTIFICATION

The property owner or owner's authorized representative who completes Sections A, B, C (Items C3.h and C3.i only), and E for Zone A (without a FEMA-issued or community-issued BFE) or Zone AO must sign here. *The statements in Sections A, B, C, and E are correct to the best of my knowledge.*

PROPERTY OWNER'S OR OWNER'S AUTHORIZED REPRESENTATIVE'S NAME

STEPHER W. LERCH, LAUGENOUR AND MEIKLE

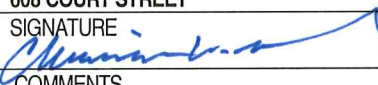
ADDRESS 608 COURT STREET	CITY WOODLAND	STATE CA	ZIP CODE 95695
SIGNATURE 	DATE JULY 6, 2004	TELEPHONE (530)662-1755	
COMMENTS			

Check here if attachments

SECTION G - COMMUNITY INFORMATION (OPTIONAL)

The local official who is authorized by law or ordinance to administer the community's floodplain management ordinance can complete Sections A, B, C (or E), and G of this Elevation Certificate. Complete the applicable item(s) and sign below.

- G1. The information in Section C was taken from other documentation that has been signed and embossed by a licensed surveyor, engineer, or architect who is authorized by state or local law to certify elevation information. (Indicate the source and date of the elevation data in the Comments area below.)
- G2. A community official completed Section E for a building located in Zone A (without a FEMA-issued or community-issued BFE) or Zone AO.
- G3. The following information (Items G4-G9) is provided for community floodplain management purposes.

G4. PERMIT NUMBER	G5. DATE PERMIT ISSUED	G6. DATE CERTIFICATE OF COMPLIANCE/OCCUPANCY ISSUED
-------------------	------------------------	---

G7. This permit has been issued for: New Construction Substantial Improvement

G8. Elevation of as-built lowest floor (including basement) of the building is: _____ ft.(m) Datum: _____

G9. BFE or (in Zone AO) depth of flooding at the building site is: _____ ft.(m) Datum: _____

LOCAL OFFICIAL'S NAME	TITLE
COMMUNITY NAME	TELEPHONE
SIGNATURE	DATE

COMMENTS

Check here if attachments

ZONE C

ZONE B

ZONE A0
(DEPTH 1)

ZONE

ZONE A

SITE



South Fork

Willow Slough

PREVIOUS
SEP 15 2010
SCANNED

86 A

23