

ELEVATION CERTIFICATE

OMB No. 1660-0008
Expires February 28, 2009

Important: Read the instructions on pages 1-8.

SECTION A - PROPERTY INFORMATION		For Insurance Company Use:
A1. Building Owner's Name JACK & LEVADA MCDOWELL	Policy Number	
A2. Building Street Address (including Apt., Unit, Suite, and/or Bldg. No.) or P.O. Route and Box No. 29812 & 29828 COUNTY ROAD 25	Company NAIC Number	
City MADISON	State CA	ZIP Code 95653
A3. Property Description (Lot and Block Numbers, Tax Parcel Number, Legal Description, etc.) A.P.N. 050-030-014		
A4. Building Use (e.g., Residential, Non-Residential, Addition, Accessory, etc.) RESIDENTIAL		
A5. Latitude/Longitude: Lat. 38°39'03.9" Long. -121°57'23.8" Horizontal Datum: <input type="checkbox"/> NAD 1927 <input checked="" type="checkbox"/> NAD 1983		
A6. Attach at least 2 photographs of the building if the Certificate is being used to obtain flood insurance.		
A7. Building Diagram Number 8		
A8. For a building with a crawl space or enclosure(s), provide:		
a) Square footage of crawl space or enclosure(s) N/A sq ft	A9. For a building with an attached garage, provide:	
b) No. of permanent flood openings in the crawl space or enclosure(s) walls within 1.0 foot above adjacent grade N/A	a) Square footage of attached garage 500± sq ft	b) No. of permanent flood openings in the attached garage walls within 1.0 foot above adjacent grade 0
c) Total net area of flood openings in A8.b N/A sq in	c) Total net area of flood openings in A9.b 0 sq in	

SECTION B - FLOOD INSURANCE RATE MAP (FIRM) INFORMATION					
B1. NFIP Community Name & Community Number YOLO COUNTY UNINCORPORATED 060423		B2. County Name YOLO		B3. State CA	
B4. Map/Panel Number 060423 0389	B5. Suffix B	B6. FIRM Index Date 04/02/02	B7. FIRM Panel Effective/Revised Date 12/16/80	B8. Flood Zone(s) A	B9. Base Flood Elevation(s) (Zone AO, use base flood depth) 147.9 (SEE SECTION D)
B10. Indicate the source of the Base Flood Elevation (BFE) data or base flood depth entered in Item B9. <input type="checkbox"/> FIS Profile <input type="checkbox"/> FIRM <input type="checkbox"/> Community Determined <input checked="" type="checkbox"/> Other (Describe) SEE SECTION D					
B11. Indicate elevation datum used for BFE in Item B9: <input checked="" type="checkbox"/> NGVD 1929 <input type="checkbox"/> NAVD 1988 <input type="checkbox"/> Other (Describe)					
B12. Is the building located in a Coastal Barrier Resources System (CBRS) area or Otherwise Protected Area (OPA)? Designation Date <input type="checkbox"/> CBRS <input type="checkbox"/> OPA <input type="checkbox"/> Yes <input checked="" type="checkbox"/> No					

SECTION C - BUILDING ELEVATION INFORMATION (SURVEY REQUIRED)	
C1. Building elevations are based on: <input type="checkbox"/> Construction Drawings* <input type="checkbox"/> Building Under Construction* <input checked="" type="checkbox"/> Finished Construction *A new Elevation Certificate will be required when construction of the building is complete.	
C2. Elevations - Zones A1-A30, AE, AH, A (with BFE), VE, V1-V30, V (with BFE), AR, AR/A, AR/AE, AR/A1-A30, AR/AH, AR/AO. Complete Items C2.a-g below according to the building diagram specified in Item A7. Benchmark Utilized ELEVATIONS SHOWN ON USGS QUAD MADISON Vertical Datum N.G.V.D. 29 Conversion/Comments NONE	
Check the measurement used.	
a) Top of bottom floor (including basement, crawl space, or enclosure floor) 149.5 <input checked="" type="checkbox"/> feet <input type="checkbox"/> meters (Puerto Rico only)	
b) Top of the next higher floor N/A <input type="checkbox"/> feet <input type="checkbox"/> meters (Puerto Rico only)	
c) Bottom of the lowest horizontal structural member (V Zones only) N/A <input type="checkbox"/> feet <input type="checkbox"/> meters (Puerto Rico only)	
d) Attached garage (top of slab) 149.1 <input checked="" type="checkbox"/> feet <input type="checkbox"/> meters (Puerto Rico only)	
e) Lowest elevation of machinery or equipment servicing the building (Describe type of equipment in Comments) 149.1 <input checked="" type="checkbox"/> feet <input type="checkbox"/> meters (Puerto Rico only)	
f) Lowest adjacent (finished) grade (LAG) 148.8 <input checked="" type="checkbox"/> feet <input type="checkbox"/> meters (Puerto Rico only)	
g) Highest adjacent (finished) grade (HAG) 149.3 <input checked="" type="checkbox"/> feet <input type="checkbox"/> meters (Puerto Rico only)	

SECTION D - SURVEYOR, ENGINEER, OR ARCHITECT CERTIFICATION	
This certification is to be signed and sealed by a land surveyor, engineer, or architect authorized by law to certify elevation information. I certify that the information on this Certificate represents my best efforts to interpret the data available. I understand that any false statement may be punishable by fine or imprisonment under 18 U.S. Code, Section 1001.	
<input checked="" type="checkbox"/> Check here if comments are provided on back of form.	
Certifier's Name CHRISTOPHER W. LERCH	License Number L.S. 7906
Title PRINCIPAL/SR. SURVEYOR	Company Name LAUGENOUR AND MEIKLE
Address P.O. BOX 828	City WOODLAND
State CA	ZIP Code 95776
Signature <i>Christopher W. Lerch</i>	Date 01/09/2009
Telephone (530)662-1755	

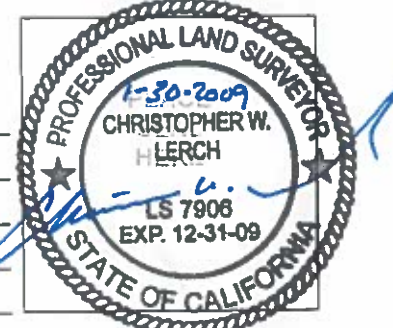

RECEIVED
Yolo County
FEB 03 2009
Planning and
Public Works

BP# 207-0534

IMPORTANT: In these spaces, copy the corresponding information from Section A.			For Insurance Company Use:	
Building Street Address (including Apt., Unit, Suite, and/or Bldg. No.) or P.O. Route and Box No. 29812 & 29828 COUNTY ROAD 25			Policy Number	
City MADISON	State CA	ZIP Code 95653	Company NAIC Number	

SECTION D - SURVEYOR, ENGINEER, OR ARCHITECT CERTIFICATION (CONTINUED)

Copy both sides of this Elevation Certificate for (1) community official, (2) insurance agent/company, and (3) building owner.

Comments **THE B.F.E. WAS DETERMINED BY AVERAGING NATURAL GROUND ELEVATIONS SHOWN OUTSIDE OF ZONE "A" NEAR BUILDING SITE SEE ATTACHMENT. LOWEST MACHINERY IS THE AIR CONDITIONING**

UNIT.
Signature  Date **01/09/2009** Check here if attachments

SECTION E - BUILDING ELEVATION INFORMATION (SURVEY NOT REQUIRED) FOR ZONE AO AND ZONE A (WITHOUT BFE)

For Zones AO and A (without BFE), complete Items E1-E5. If the Certificate is intended to support a LOMA or LOMR-F request, complete Sections A, B, and C. For Items E1-E4, use natural grade, if available. Check the measurement used. In Puerto Rico only, enter meters.

- E1. Provide elevation information for the following and check the appropriate boxes to show whether the elevation is above or below the highest adjacent grade (HAG) and the lowest adjacent grade (LAG).
 - a) Top of bottom floor (including basement, crawl space, or enclosure) is _____ feet meters above or below the HAG.
 - b) Top of bottom floor (including basement, crawl space, or enclosure) is _____ feet meters above or below the LAG.
- E2. For Building Diagrams 6-8 with permanent flood openings provided in Section A Items 8 and/or 9 (see page 8 of Instructions), the next higher floor (elevation C2.b in the diagrams) of the building is _____ feet meters above or below the HAG.
- E3. Attached garage (top of slab) is _____ feet meters above or below the HAG.
- E4. Top of platform of machinery and/or equipment servicing the building is _____ feet meters above or below the HAG.
- E5. Zone AO only: If no flood depth number is available, is the top of the bottom floor elevated in accordance with the community's floodplain management ordinance? Yes No Unknown. The local official must certify this information in Section G.

SECTION F - PROPERTY OWNER (OR OWNER'S REPRESENTATIVE) CERTIFICATION

The property owner or owner's authorized representative who completes Sections A, B, and E for Zone A (without a FEMA-issued or community-issued BFE) or Zone AO must sign here. *The statements in Sections A, B, and E are correct to the best of my knowledge.*

Property Owner's or Owner's Authorized Representative's Name _____

Address	City	State	ZIP Code
Signature	Date	Telephone	
Comments			

Check here if attachments

SECTION G - COMMUNITY INFORMATION (OPTIONAL)

The local official who is authorized by law or ordinance to administer the community's floodplain management ordinance can complete Sections A, B, C (or E), and G of this Elevation Certificate. Complete the applicable item(s) and sign below. Check the measurement used in Items G8. and G9.

- G1. The information in Section C was taken from other documentation that has been signed and sealed by a licensed surveyor, engineer, or architect who is authorized by law to certify elevation information. (Indicate the source and date of the elevation data in the Comments area below.)
- G2. A community official completed Section E for a building located in Zone A (without a FEMA-issued or community-issued BFE) or Zone AO.
- G3. The following information (Items G4.-G9.) is provided for community floodplain management purposes.

G4. Permit Number	G5. Date Permit Issued	G6. Date Certificate Of Compliance/Occupancy Issued
-------------------	------------------------	---

- G7. This permit has been issued for: New Construction Substantial Improvement
- G8. Elevation of as-built lowest floor (including basement) of the building: 149 5 feet meters (PR) Datum _____
- G9. BFE or (in Zone AO) depth of flooding at the building site: 141 9 feet meters (PR) Datum _____

Local Official's Name LONELL BUTLER	Title CHIEF BUILDING OFFICIAL
Community Name YOLO COUNTY	Telephone (530) 666-8775
Signature 	Date 1-4-09

Comments _____

Check here if attachments

W

ZONE C

AVERAGE ELEVATIONS
OUTSIDE OF FLOOD
ZONE A=147.9' N.G.V.D.
B.F.E.<147.9'

COUNTY ROAD 25

COUNTY ROAD 90

*148.52
*148.16
*148.17
*148.05
*148.00
*147.80
*147.71
*147.58
*147.50

90 A

Building Photographs

See Instructions for Item A6.

S

Building Street Address (including Apt., Unit, Suite, and/or Bldg. No.) or P.O. Route and Box No. 29812 & 29828 COUNTY ROAD 28			For Insurance Company Use: Policy Number
City WOODLAND	State CA	ZIP Code 95653	Company NAIC Number

If using the Elevation Certificate to obtain NFIP flood insurance, affix at least two building photographs below according to the instructions for Item A6. Identify all photographs with: date taken; "Front View" and "Rear View"; and, if required, "Right Side View" and "Left Side View." If submitting more photographs than will fit on this page, use the Continuation Page, following.



FRONT VIEW - HOUSE
01/09/2009

Building Photographs

Continuation Page

9

Building Street Address (including Apt., Unit, Suite, and/or Bldg. No.) or P.O. Route and Box No. 29812 & 29828 COUNTY ROAD 28			For Insurance Company Use: Policy Number
City MADISON	State CA	ZIP Code 95653	Company NAIC Number

If submitting more photographs than will fit on the preceding page, affix the additional photographs below. Identify all photographs with: date taken; "Front View" and "Rear View"; and, if required, "Right Side View" and "Left Side View."



REAR VIEW - HOUSE
01/09/2009