



# Yolo County Environmental Health

## Site Map and Table Required to Support the Agricultural Well Permit Application Yolo County Ordinance 1569

Reference: Agricultural Well Permit Urgency Ordinance No. 1569

Prepared for Well Drillers and Well Owners

Date Updated: October 23, 2024

### Requirements:

For all permit applications not exempt from YC Ordinance 1569, the applicant must submit a map and a table of known active wells within a radial distance equal to the minimum separation distance required for the well (as presented in Table 1) plus 500 feet.

The map should include the proposed well site with known nearby active domestic, public supply, agricultural/irrigation, industrial, or other groundwater production wells. Active wells include wells recently operated (within last five years) as production wells and equipped with an operational pumping and discharge assembly, or wells in the process of being prepared to be operated.

The table listing known nearby wells must include the well type, latitude/longitude coordinates, distance from the proposed well site (in feet), and Assessor's Parcel Number (APN).

**Table 1. Minimum Well Separation Distances**

Pumping Capacity (gallons per minute)	Minimum Well Separation Distance (feet)
<b>Wells Within the Valley Floor Areas of the County</b>	
<500	250
500-1000	500
1000-1500	1000
1500-2000	2000
>2000	Report Required
<b>Wells in the Upland Areas of the County</b>	
<15	500
15-100	1000
>100	Report Required

**Example of a Site Map for a Well Application with Pumping Capacity at <500'**

*(For Illustration Only, Not to Scale):*

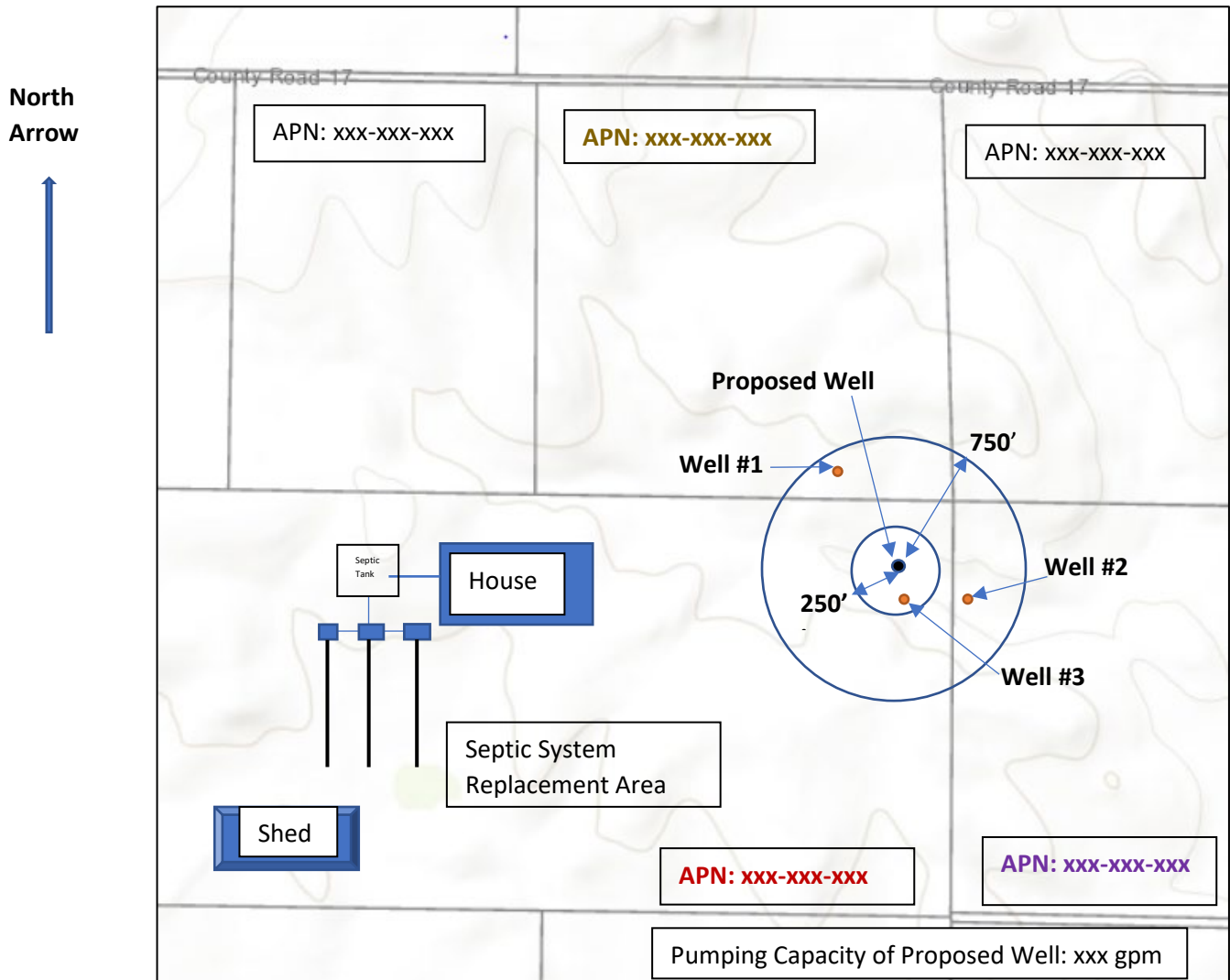

**Example of a Table for a Well Application with Pumping Capacity at <500'**

*(For Illustration Only):*

	Well Type	GIS Coordinates	Distance to the Proposed Well in Feet	APN
Well #1	Ag well	Latitude: Longitude:	700'	xxx-xxx-xxx
Well #2	Ag well	Latitude: Longitude:	370'	xxx-xxx-xxx
Well #3	Ag Wel	Lat/Long:	230'	xxx-xxx-xxx